

AUG 14 1986

ORDINANCE NO. 881

AN ORDINANCE EXTENDING THE CORPORATE LIMITS OF THE CITY OF WILLMAR, A MUNICIPAL CORPORATION OF THE STATE OF MINNESOTA, TO INCLUDE CERTAIN LANDS NOT EXCEEDING 200 ACRES.

WHEREAS, a Petition has been filed with the governing body of the City of Willmar, a municipal corporation in the State of Minnesota, by a majority of the owners having an interest therein, to have certain real estate hereinafter described included within the limits of the City of Willmar, Minnesota; and

WHEREAS, Willmar Township has filed a Written Waiver, waiving the ninety (90) day period to submit written objections to the proposed annexation; and

WHEREAS, it is proposed to annex by virtue hereof to the said City of Willmar, said property, all of which said property is in Kandiyohi County, Minnesota; and

WHEREAS, pursuant to Minnesota law, said land may be annexed by ordinance; and

WHEREAS, the said real estate to be annexed is described as follows, to-wit:

All of the plats of Country Club Terrace; Lakewood and First Addition to Lakewood;

ALSO

All that part of Government Lot 6, Section 2, Township 119, Range 35, lying East of the following described line: Beginning at the Southwest corner of Lot 8 of Block 2 of First Addition to Lakewood on Willmar Lake, according to the recorded plat thereof now on file and of record in the Office of the Kandiyohi County Recorder; thence South on and along the line parallel to the West line of Section 2, to the South line of Government Lot 6 and there ending;

ALSO

All that part of Government Lot 4 in Section 2, Township 119, Range 35, lying East of a line distant 2449 feet East from and parallel with the West line of said Section 2;

NOW, THEREFORE, the City Council of the City of Willmar hereby determines, ordains and declares as follows:

Section 1. BEST INTEREST OF THE CITY OF WILLMAR AND AREA TO BE ANNEXED. That the annexation will be in the best interest of the City of Willmar, Minnesota, and of the territory affected.

Section 2. ABUTS ON CITY LIMITS. That the real estate above described abuts on the city limits, and is so conditioned as such property to be subject to city government.

Section 3. ANNEXATION. That the said real estate is hereby annexed to, and included within, the City of Willmar, Minnesota, as effectually as if it had originally been a part hereof.

Section 4. ZONING. The parcels above described shall be zoned R-1, Single Family Residential.

Section 5. ACREAGE. The parcels have a combined area of 40 acres.

Section 6. EFFECTIVE DATE. This Ordinance shall be filed and shall take effect and be in full force and effect from and after filing a certificate thereof with the Minnesota Municipal Commission, the County of Kandiyohi, Minnesota, and the Secretary of State of the State of Minnesota, and from and after its adoption and publication.

This Ordinance introduced by Councilman:	<u>Halterman</u>	.
This Ordinance introduced on:	<u>June 16, 1986</u>	.
This Ordinance published on:	<u>July 3, 1986</u>	.
This Ordinance given a hearing on:	<u>August 6, 1986</u>	.
This Ordinance adopted on:	<u>August 6, 1986</u>	.
This Ordinance published on:	<u>August 12, 1986</u>	.

REC'D. BY JUN 11 1986

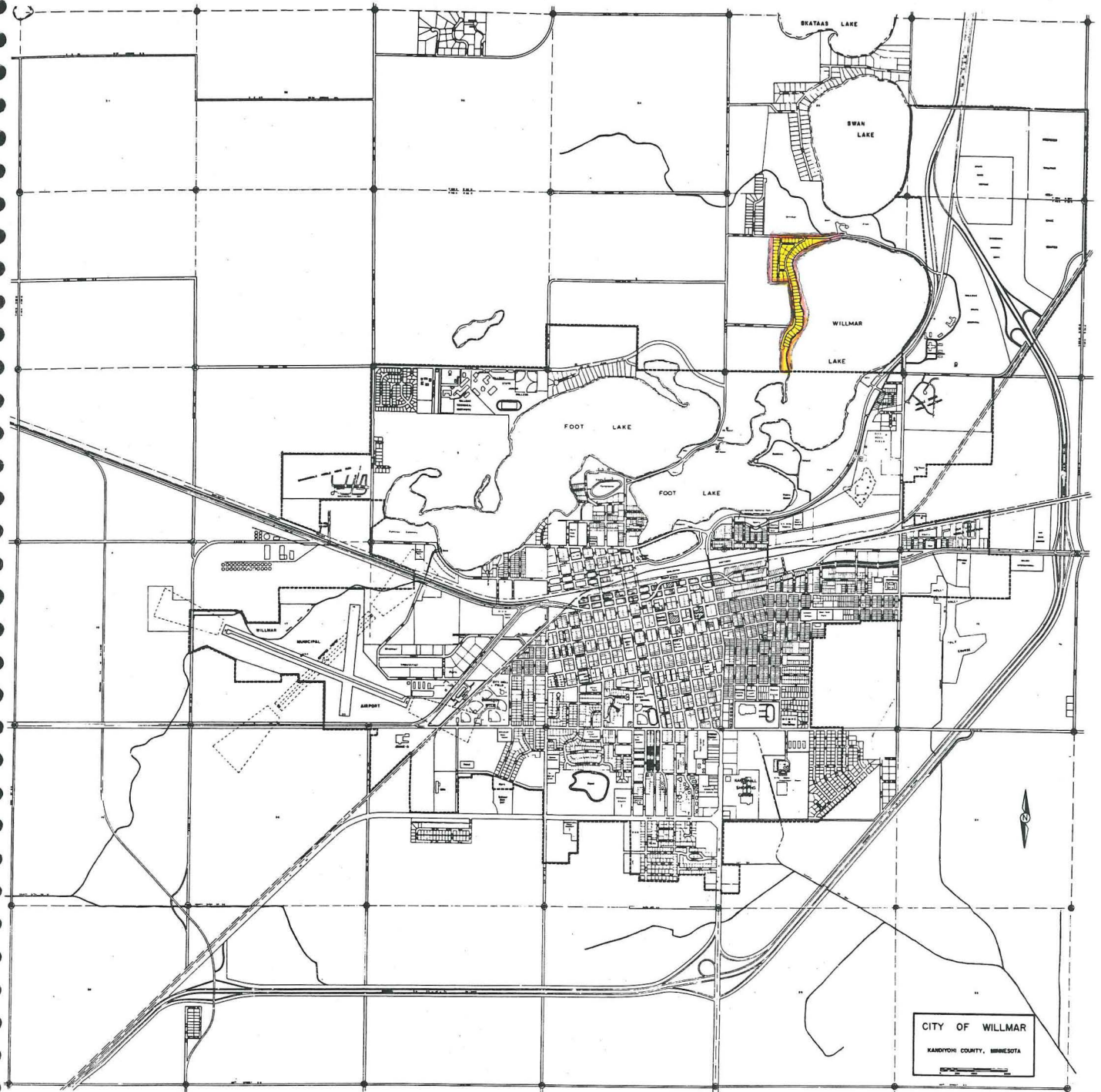

CITY PLATS