

MAY 9 1986



# City of Willmar

Office of CLERK TREASURER  
Phone 612/235-4913

January 7, 1986

Lester Holmquist, Clerk  
Willmar Township Board  
Country Club Terrace  
Willmar, MN 56201

RE: LOGE PROPERTY

Dear Leb:

This is to officially notify the Willmar Township Board of the City's intention to annex the Oscar and Verna Loge property along East Highway 12. In accordance with State law, the ordinance shall not be introduced until the Willmar Township Board has been given ninety (90) days notice of the intention to annex the area by ordinance.

If you should have any questions, please do not hesitate to contact me.

Sincerely,

CITY OF WILLMAR

Michael C. Schmit  
City Clerk-Treasurer

MCS:aep

Alan Loge  
308 SE 23rd Street  
Willmar, Minnesota 56201

Legal description of property owned by the above that  
is being annexed into the City of Willmar.

WHEREAS, the real estate to be annexed is described  
as follows, to-wit:

That part of the SW 1/4 of the SE 1/4 of Section 12,  
Township 119, Range 119, Range 35, described as follows:  
Commencing at the Southwest corner of said SW 1/4 of  
SE 1/4; thence East 198', to point of beginning; thence  
East 279', thence North 912.4', thence South 79 degrees,  
20 feet, 54 inches West 283.6'; thence South 859.98'  
to point of beginning, consisting of 5.70 Acres, more or  
less.

REC'D. BY  
MMB MAY 9 1986

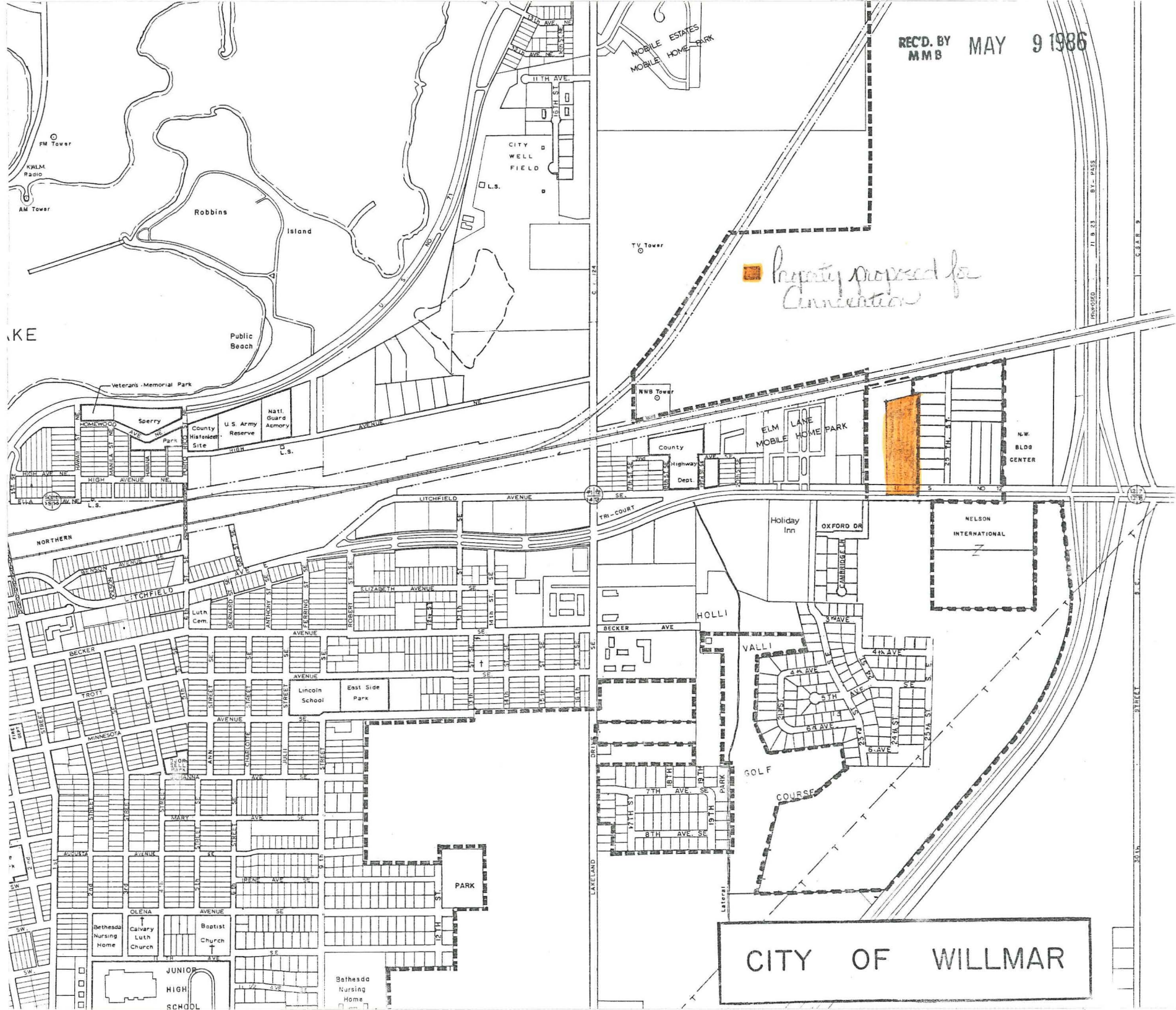

CITY OF WILLMAR