

ORDINANCE

REC'D. BY
MMR

NOV 19 1984

AN ORDINANCE EXTENDING THE CORPORATE LIMITS OF THE CITY OF MAHNOMEN TO INCLUDE CERTAIN UNINCORPORATED PROPERTY OWNED BY BRADLEY ATHMANN ABUTTING UPON THE LIMITS OF THE CITY

WHEREAS, the territory described below is not presently within the corporate limits of any incorporated City:

WHEREAS, this territory abutts the corporate limits of the City and is deemed to be urban or surburban in character: and

WHEREAS, Bradley Athmann has petitioned the City of Mahnomen to annex said property:

The City Council of Mahnomen, Minnesotae ordains:

Section 1. Territory Annexed. The corporate limits of the City of Mahnomen, Minnesota are hereby extended to include the unplatted property described as follows:

Beginning at point 33 feet West and 748 feet North of the Southeast Corner of the Northeast Quarter of the Southeast Quarter (NE $\frac{1}{4}$ SE $\frac{1}{4}$), Section Three (3), Township One Hundred Forty Four (144), Range Forty Two (42) West of the Fifth Principal Meridian in Minnesota this point being the point of beginning of the tract to be described; thence West along and upon the North line of a tract conveyed by Warranty Deed and recorded in Book 92 of Deeds, page 319 a distance of 209 feet, thence North a distance of 125 feet, thence East a distance of 209 feet, more or less to the West boundary line of County Road therebeing, thence South along and upon the West right of way line of said County Road a distance of 125 feet, more or less to the point of beginning.

(Said Tract being in the NE $\frac{1}{4}$ SE $\frac{1}{4}$ Sec. 3-144-42)

Section 2. Filing. The City Clerk if directed to file certified copies of this Ordinance with the Secretary of State, the County Auditor of Mahnomen County; the Town Clerk of Pembina Township and the Minnesota Municipal Board.

Section 3. Effective Date Of Annexation. This Ordinance takes effect upon passage and publication and the filing of certified copies as directed in Section 2.

Adopted by the City of Mahanomen, Minnesota, this 4th day of September, 1984.

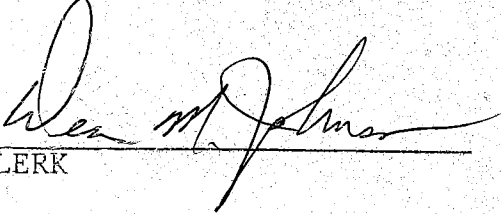
CLERK

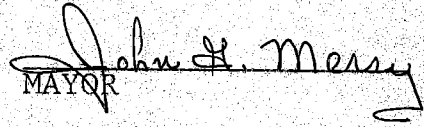
MAYOR

REC'D. BY
MMB SEP 14 1984

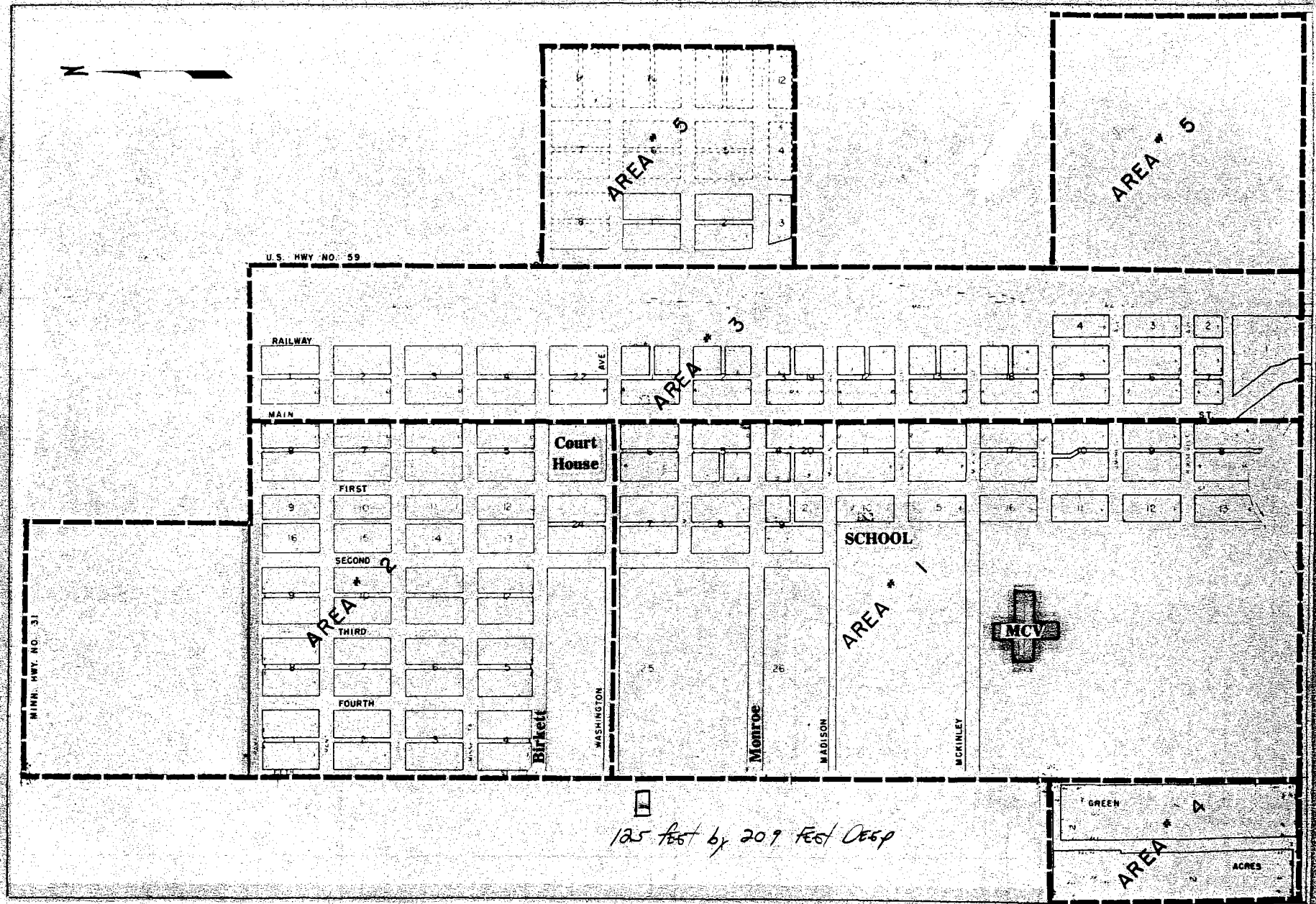

* AREA to be ANNEXED by BRADLEY ALTMAN

U.S. HWY NO 59

U.S. HWY NO 59

MINN. HWY NO. 31

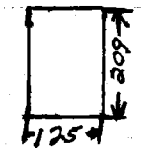
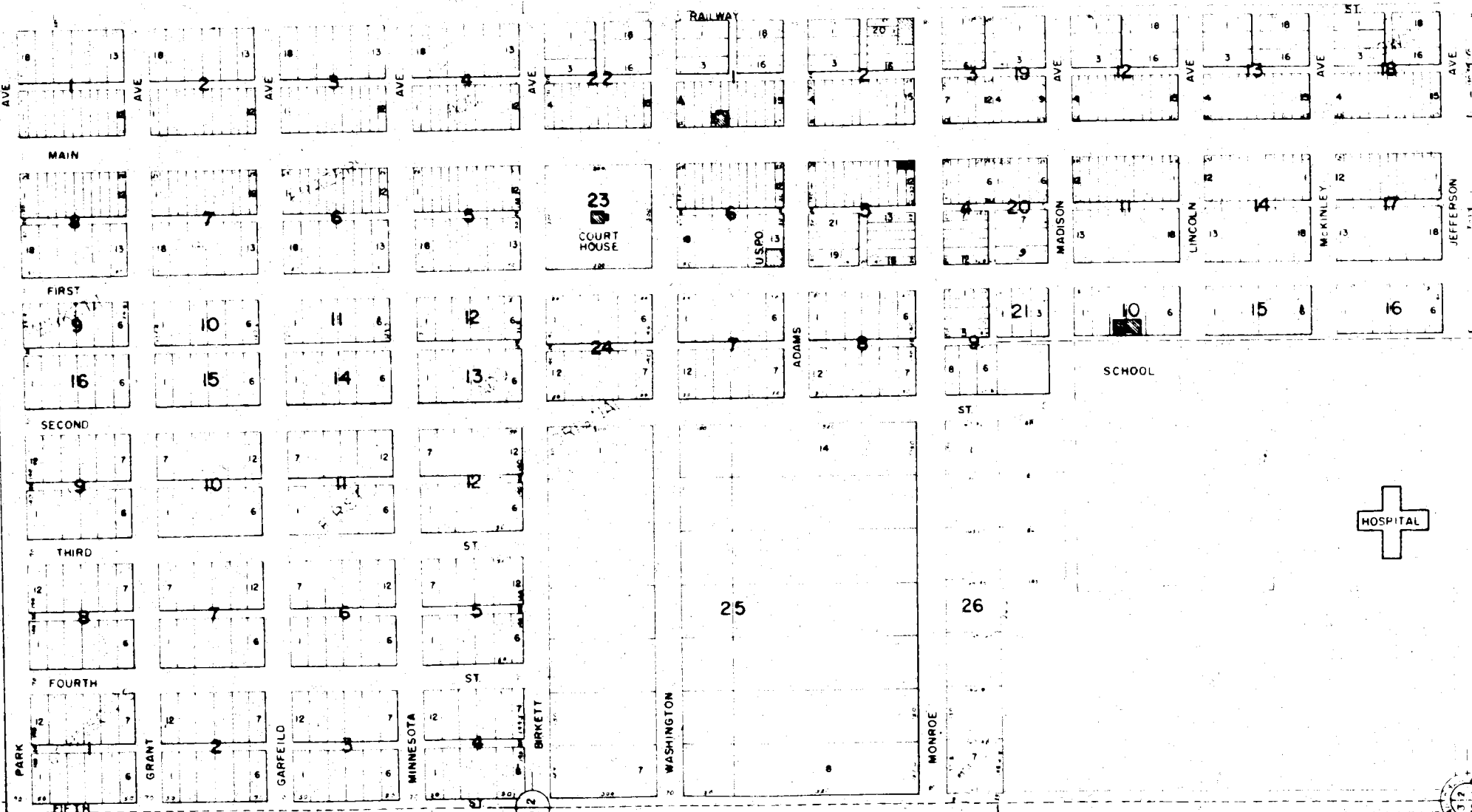

lot to be annexed by
BRADLEY ALTMAN