

STATE OF MINNESOTA

COUNTY OF MAHNOMEN

REC'D BY
AUG 8 SEP 14 1984

IN THE MATTER OF THE RESOLUTION FOR THE
ANNEXATION OF CERTAIN LANDS TO THE CITY
OF MAHNOMEN BY BRADLEY ATHMANN

PETITION

Bradley Athmann states that he is the owner of less than 200 acres
of land abutting the City of Mahnomen and legally described as follows:

Beginning at a point 33 feet West and 748 feet North of the Southeast
Corner of the Northeast Quarter of the Southeast Quarter (NE $\frac{1}{4}$ SE $\frac{1}{4}$)
Section Three (3) Township One Hundred Forty Four (144) Range Forty Two
(42) West of the 5th P.M. in Minnesota, this point being the point of
beginning of the tract to be described, thence West along and upon the
North line of a tract conveyed by Warranty Deed and recorded in Book 92
of Deeds, Page 319 a distance of 209 feet, thence North a distance of
125 feet, thence East a distance of 209 feet, more or less, to the West
boundary line of a County Road therebeing, thence South along and upon
the West right-of-way line of said County Road a distance of 125 feet,
more or less to the point of beginning.

(Said Tract being in the NE $\frac{1}{4}$ SE $\frac{1}{4}$ Sec. 3-144-42)

That your Petitioner desires his lands to be annexed to the City of
Mahnomen and your Petitioner believes that there will be no objection to
the Annexation on the part of Pembina Township.

Brad Athmann
BRADLEY ATHMANN

Subscribed and sworn to before me
this 4th day of September
1984.

Wen M. Johnson
NOTARY PUBLIC
Mahnomen 8-14-87

REC'D. BY
MMB SEP 14 1984

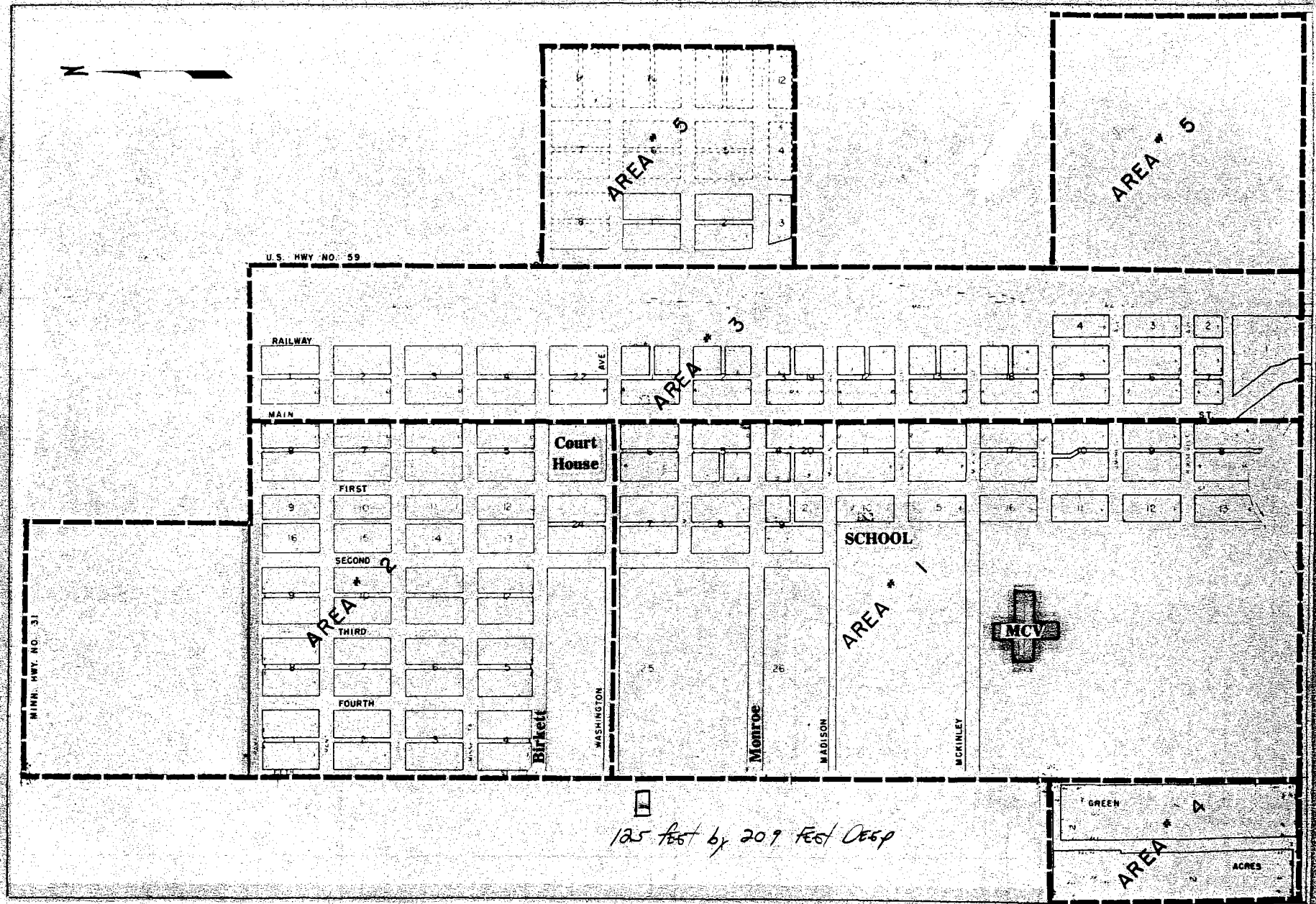

125 feet by 209 feet Deep

* AREA to be ANNEXED by BRADLEY ALTMAN

U.S. HWY NO 59

U.S. HWY NO 59

MINN. HWY NO. 31

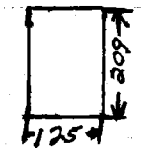
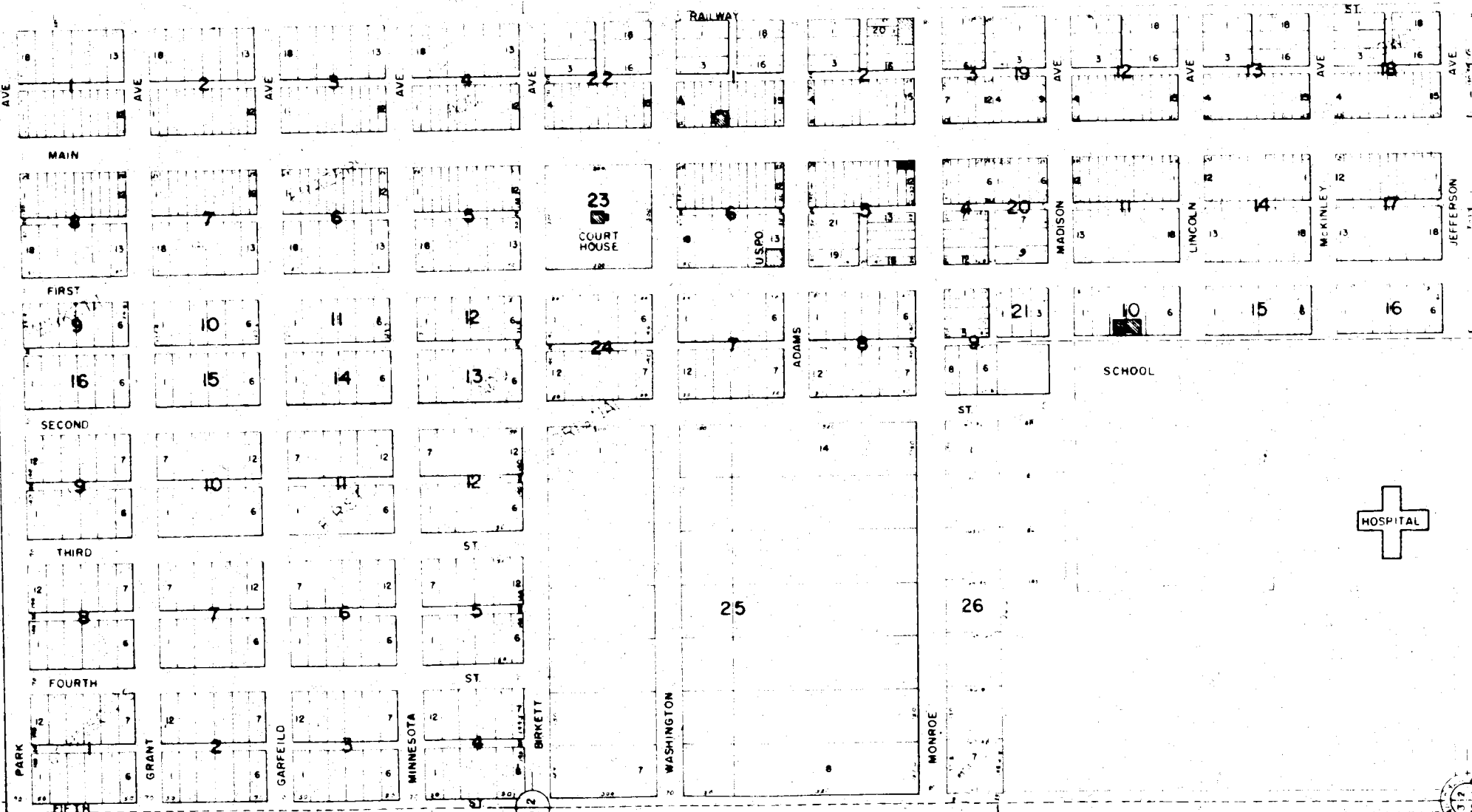

lot to be annexed by
Bradley Atman