

ORDINANCE NO. 819
AN ORDINANCE PROVIDING FOR THE ANNEXATION
OF RAYMOND S. NORRGARD REALTY TO THE
CITY OF BRAINERD

The Council of the City of Brainerd do ordain:

Section 1. That Raymond S. Norrgard, the fee owner of:

That part of the Northeast Quarter of the Northwest Quarter (NE1/4-NW1/4), that part of the Southeast Quarter of the Northwest Quarter (SE1/4-NW1/4), and that part of the Southwest Quarter of the Northwest Quarter (SW1/4-NW1/4) of Section 1, Township 44 North, Range 31 West, Crow Wing County, Minnesota, described as follows:

Commencing at the Northeast corner of said Northwest Quarter (N1/4 cor.); thence South 02 degrees 41 minutes 18 seconds East, assumed bearing, 627.24 feet along the East line of said Northwest Quarter to the Southerly right-of-way line of the abandoned Burlington Northern Railroad, the point of beginning of the tract to be described; thence continuing South 02 degrees 41 minutes 18 seconds East 2145.95 feet along the East line of said Northwest Quarter to the Southeast corner thereof; thence South 87 degrees 42 minutes 34 seconds West 1383.28 feet along the South line of said Southeast Quarter of the Northwest Quarter to the Southwest corner thereof; thence continuing South 87 degrees 42 minutes 34 seconds West 437.15 feet along the South line of said Southwest Quarter of the Northwest Quarter; thence North 01 degrees 20 minutes 40 seconds West 251.60 feet; thence North 50 degrees 10 minutes 49 seconds West 286.08 feet to said Southerly right-of-way line of the abandoned Burlington Northern Railroad; thence North 50 degrees 22 minutes 47 seconds East 1856.29 feet along said Southerly right-of-way line; thence Northeasterly 792.27 feet along said Southerly right-of-way line along a tangential curve concave to the Northwest having a radius of 2342.00 feet and a central angle of 19 degrees 22 minutes 55 seconds to the point of beginning; also abutting railroad and highway right-of-way. Said tract contains 55.30 acres, more or less. Subject to easements, reservations, or restrictions of record, if any,

filed a petition with the Council of the City of Brainerd requesting

that said realty be annexed to the City of Brainerd.

Section 2. That pursuant to Minnesota Statute 414.033, Subdivision 6, the Township of Crow Wing and the City of Brainerd adopted resolutions so as to permit the City of Brainerd to annex the above entitled realty forthwith by ordinance.

Section 3. That the Council of the City of Brainerd deems the annexation of said realty to the City of Brainerd to be in the best interests of the City of Brainerd and the territory affected and accordingly, said realty is hereby annexed to the City of Brainerd so as to become and be a part of the City of Brainerd and included within its corporate limits and boundaries thereof.

Section 4. This ordinance shall take effect and be in force one week from and after its publication.

Adopted this 18th day of June, 1984.

MILDRED M. MICHAELIS
President of the Council

Approved this 19th day of June, 1984.

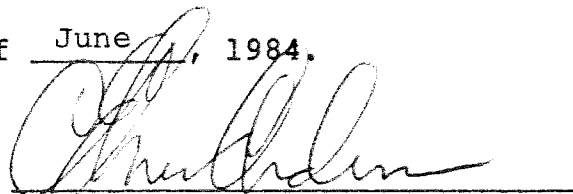
C. ELMER ANDERSON
Mayor

ATTEST: 
RICHARD M. JOHNSON, CMC
City Clerk/Treasurer

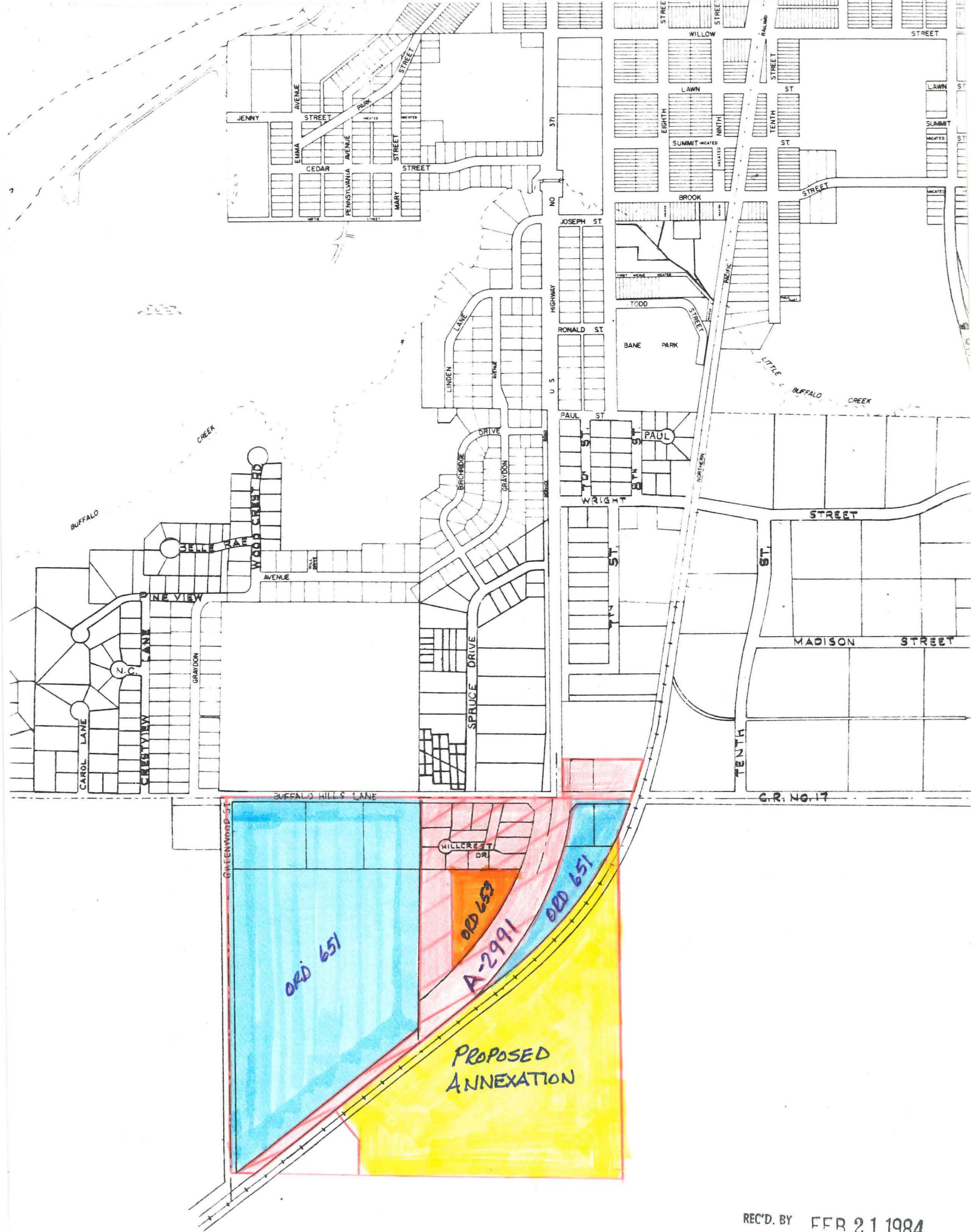

ORD 651

ORD 653

A-2991

ORD 651

PROPOSED ANNEXATION

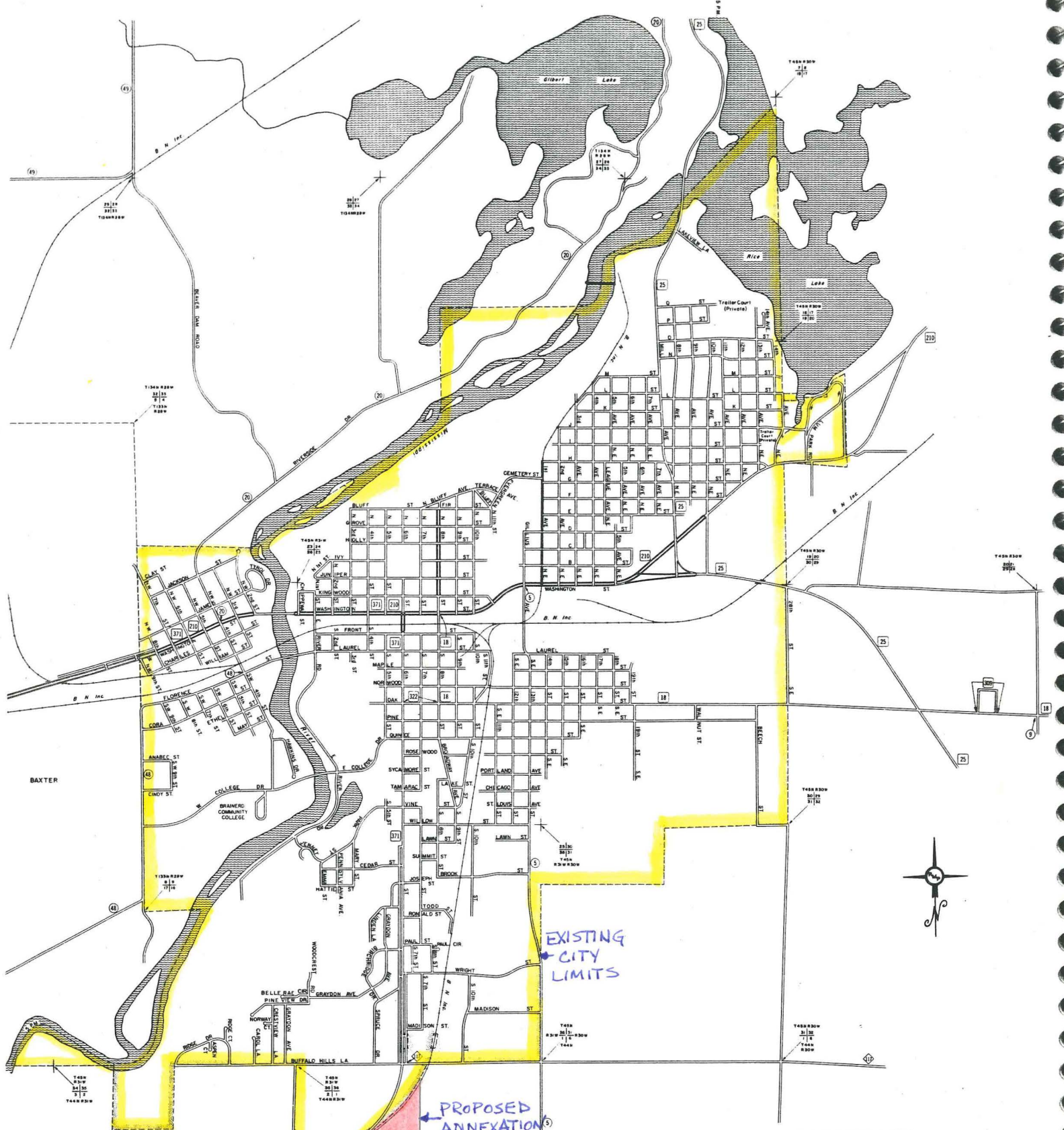

PROPOSED ANNEXATION

EXISTING CITY LIMITS

LEGEND

- Interstate TRUNK HIGHWAY — 26
- U.S. NUMBERED TRUNK HIGHWAY — 20
- STATE NUMBERED TRUNK HIGHWAY — 1
- COUNTY STATE AID HIGHWAY — 3
- COUNTY ROAD — 4
- COUNTY STATE AID HIGHWAY IN ADJACENT COUNTY — 21
- COUNTY ROAD IN ADJACENT COUNTY — 22
- CORPORATE LIMITS — 3

**MUNICIPALITY OF
BRAINERD**

PREPARED BY THE
MINNESOTA DEPARTMENT OF TRANSPORTATION
TECHNICAL SERVICES DIVISION
IN COOPERATION WITH THE
U.S. DEPARTMENT OF TRANSPORTATION
FEDERAL HIGHWAY ADMINISTRATION

SCALE
1000' 0 1000' 2000'