

REC'D. BY SEP 14 1983

ORDINANCE #365

AN ORDINANCE ANNEXING LAND KNOWN AS THE FRIEHAMMER/THEISEN PROPERTY  
AND ZONING THE PROPERTY R-3 AND R-2

The City Council of the City of Sauk Rapids does ordain:

Section 1. The following described property containing about 10 acres is hereby annexed to and included in the City of Sauk Rapids, Minnesota as effectively as if originally made a part thereof (Friehammer):

South half of the Northeast Quarter of the Northwest Quarter ( $S\frac{1}{2}$  NE $\frac{1}{4}$  NW $\frac{1}{4}$ ) lying Westerly of U.S. Highway #10 and that part of the Southeast Quarter of the Northwest Quarter (SE $\frac{1}{4}$  NW $\frac{1}{4}$ ) lying Westerly of U.S. Highway #10 and Northerly of the centerline of Fifth Street South (also referred to as Benton County Road #46), less and except all that part of the Southeast Quarter of the Northwest Quarter (SE $\frac{1}{4}$  NW $\frac{1}{4}$ ) of Section Twenty-five (25), Township Thirty-six (36) North, Range Thirty-one (31) West, Benton County, Minnesota, described as follows: Beginning at the point of intersection of the westerly right-of-way line of U.S. Highway 10 and the northerly right-of-way line of County Road 46; thence North 11 degrees 35 minutes 18 seconds East, along said westerly right-of-way line 163.53 feet; thence northerly along said right-of-way line and along a tangential curve, concave to the West, radius 5554.58 feet, central angle 00 degrees 29 minutes 31 seconds, 47.69 feet; thence South 87 degrees 49 minutes 32 seconds West 221.28 feet; thence South 00 degrees 00 minutes 00 seconds East 112.31 feet to the northerly right-of-way line of said County Road 46; thence South 64 degrees 15 minutes 16 seconds East, along said northerly right-of-way line, 198.60 feet to the point of beginning and there terminating. This exception contains approximately 0.75 acres.

Section 2. The property annexed and described in Section 1 shall be zoned as follows:

- A. The property lying north of the north line of the NE $\frac{1}{4}$  of the SW $\frac{1}{4}$  of Section 25, Township 36 North, Range 31 West will be Agricultural District, A-1.

- B. The property lying south of the north line of the NE $\frac{1}{4}$  of the SW $\frac{1}{4}$  of Section 25, Township 36 North, Range 31 West and westerly of a north-south roadway that is proposed to bisect the property will be Two Family District, R-2.
- C. The property lying south of the north line of the NE $\frac{1}{4}$  of the SW $\frac{1}{4}$  of Section 25, Township 36 North, Range 31 West and easterly of a north-south roadway that is proposed to bisect the property will be Multiple Family Residence District, R-3.

Section 3. The following described property containing approximately .89 acres is hereby annexed to and included in the City of Sauk Rapids Minnesota, as effectively as if originally made a part thereof (Theisen):

All that part of the Southeast Quarter of the Northwest Quarter (SE $\frac{1}{4}$  NW $\frac{1}{4}$ ) of Section 25, Township 36 North, Range 31 West, Benton County, Minnesota, described as follows:

Beginning at the point of intersection of the Westerly right of way line of U.S. Highway 10 and the Northerly right of way line of County Road 46; thence North 11 degrees 35 minutes 18 seconds East, along said Westerly right of way line 163.53 feet; thence Northerly along said right of way line and along a tangential curve, concave to the West, Radius 5554.58 feet, central angle 00 degrees 29 minutes 31 seconds, 47.69 feet; thence South 87 degrees 49 minutes 32 seconds West 221.28 feet; thence South 00 degrees 00 minutes 00 seconds East 112.31 feet to the Northerly right of way line of said County Road 46; thence South 64 degrees 15 minutes 16 seconds East, along said Northerly right of way line, 198.60 feet to the point of beginning and there terminating.

Section 4. The property annexed and described in Section 3 shall be zoned Multiple Family Residence District, R-3.

Section 5. This ordinance shall take effect from and after its passage and publication as provided by law, and upon filing a copy with the Minnesota Municipal Commission, the Sauk Rapids Township Clerk, the Benton County Auditor and the Minnesota Secretary of State as required by MN Statute 414.033, Subd. 7.

Adopted by the Sauk Rapids City Council this 18th day of July, 1983.

ATTEST

N. N. Hollenhorst  
N. N. Hollenhorst, City Clerk/Treasurer

Bernard Gratzek - Mayor

Published in the Sauk Rapids Herald on the 3rd day of August 1983.



ORD # 342<sup>RD</sup>  
North Acres

REC'D. BY  
MMB

SEP 14 1983

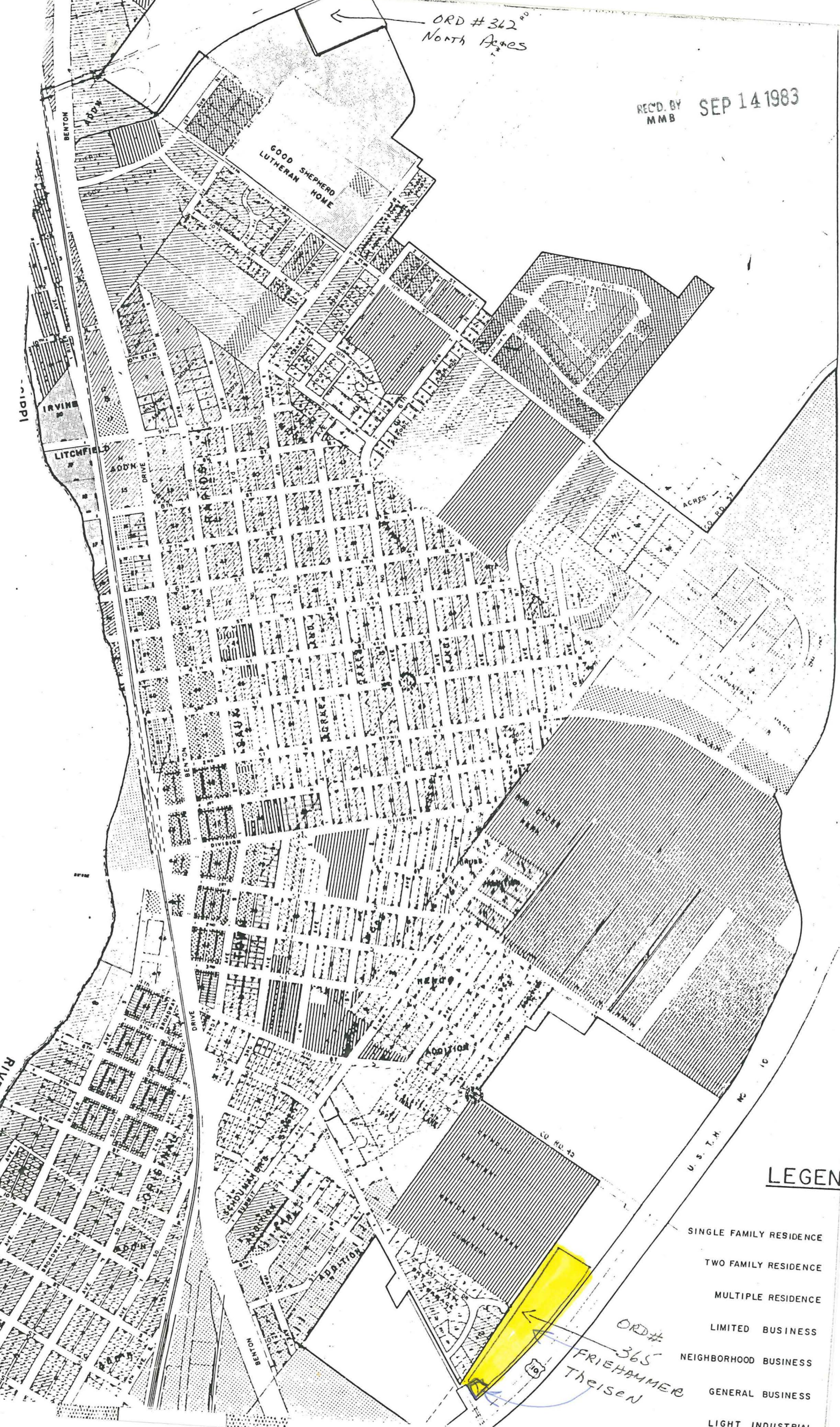

LEGEN

- SINGLE FAMILY RESIDENCE
- TWO FAMILY RESIDENCE
- MULTIPLE RESIDENCE
- LIMITED BUSINESS
- NEIGHBORHOOD BUSINESS
- GENERAL BUSINESS
- LIGHT INDUSTRIAL

ORD #  
365  
FRIEHHAMER  
Theisen