

AUG 31 1983

AN ORDINANCE EXTENDING THE CORPORATE LIMITS OF THE CITY OF DELANO TO INCLUDE CERTAIN UNINCORPORATED UNPLATTED LAND NOT EXCEEDING 200 ACRES IN AREA ABUTTING UPON THE CITY LIMITS.

WHEREAS, a certain petition dated June 3, 1983, requesting annexation of the territory hereinafter described was duly presented to the council on the 7th day of June, 1983; and

WHEREAS, the petition was signed by all owners; and

WHEREAS, no objections to the annexation have been received from the Town Board of Franklin Township or the governing body of any municipality whose boundaries abut upon the boundaries of the land to be annexed; and

WHEREAS, the Townboard of Franklin Township has waived the right to object and has waived the 90 days before the city ordinance can be adopted; and

WHEREAS, the land described in the petition abuts upon the city limits at the Northern boundary thereof;

THE COUNCIL OF THE CITY OF DELANO, MINNESOTA, ORDAINS:

SECTION 1. The City Council hereby determines (1) that the territory described herein abuts the city limits and is or is about to become urban or suburban in character; and (2) that none of the territory is now included within the limits of any city.

SECTION 2. Territory Annexed. The corporate limits of the City are hereby extended to include the unplatted land described in Exhibit A attached hereto and made a part hereof and the same is hereby annexed to and included within the city as effectually as if it had originally been a part thereof.

SECTION 3. Filing. The City Clerk is hereby directed to file certified copies of this ordinance with the Minnesota Municipal Board, the Secretary of State, the Town Clerk, and the County Auditor.

SECTION 4. Effective Date. This ordinance takes effect upon its passage and publication and the filing of the certified copies as directed in Section 3, and approval of the ordinance by the Municipal Board.

PASSED BY THE MAYOR AND CITY COUNCIL OF THE CITY OF DELANO, MINNESOTA, THIS 2nd DAY OF AUGUST, 1983.

Chuck Theis  
Chuck Theis, Mayor

ATTEST:

Motion by Litfin

Second by Quale

Theis: Aye  
Litfin: Aye  
Meiners: Aye  
Quale: Aye  
Zitzloff: Absent

B. Josan  
Baldev S. Josan, City Administrator

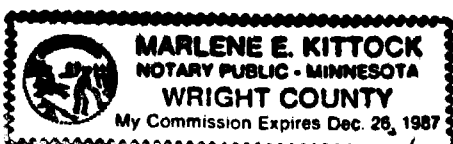

*Marlene E. Kittock*



12  
5

CO. 111.

That part of Lot 5 of the East Half of the Northwest Quarter ( $E\frac{1}{2}$  of  $NW\frac{1}{4}$ ) and West Half of the Northeast Quarter ( $W\frac{1}{2}$  of  $NE\frac{1}{4}$ ) of Section 11, Township 118, Range 25, described as follows: Begin at the Northwest corner of Lot "L" of said Lot five (5); thence East 476 feet; thence North 215 feet to the point of beginning of the tract to be described; thence North 353.26 feet; thence East a distance of 149.02 feet to center of public highway as now established; thence Southeasterly along the centerline of said highway to a point where said centerline is  $237\frac{1}{2}$  feet North of the North line of said Lot "L" of Lot Five (5); thence Southwesterly to the point of beginning, except therefrom the following described tract of land, to-wit: Begin at the Northwest corner of Lot "L" of said Lot five (5); thence East 476 feet; thence North 372.26 feet to the point of beginning of the tract to be described; thence North 196 feet; thence East 149.02 feet to the center of public highway as now established; thence Southeasterly along the centerline of said highway 247 feet; thence Northwesterly to the point of beginning.

DATED: 7-15-83

Mollie Little

Chairman

ATTEST:

Norma Chadwick

Clerk

Exhibit A



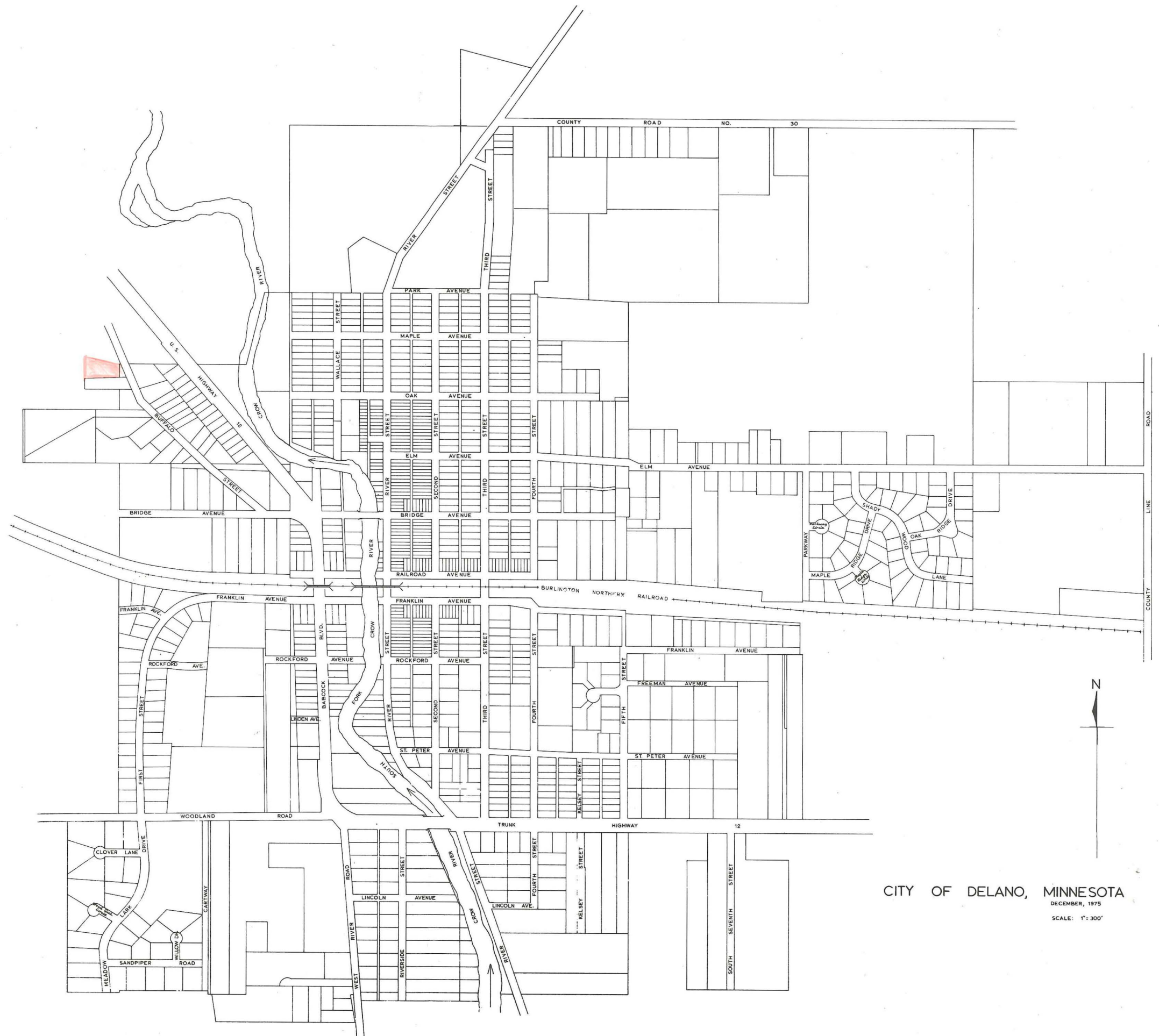

CITY OF DELANO, MINNESOTA  
DECEMBER, 1975  
SCALE: 1" = 300'