

PETITION FOR ANNEXATION

REC'D BY  
MMB  
AUG 31 1983

We, the undersigned, being all of the owners, in numbers, of the land legally described below, and consisting of less than 200 acres, do hereby petition the City Council of the City of Delano for the annexation to the city of the tract legally described as follows, to-wit:

That part of Lot 5 of the East Half of the Northwest Quarter ( $E\frac{1}{2}$  of  $NW\frac{1}{4}$ ) and West Half of the Northeast Quarter ( $W\frac{1}{2}$  of  $NE\frac{1}{4}$ ) of Section 11, Township 118, Range 25, described as follows: Begin at the Northwest corner of Lot "L" of said Lot five (5); thence East 476 feet; thence North 215 feet to the point of beginning of the tract to be described; thence North 353.26 feet; thence East a distance of 149.02 feet to center of public highway as now established; thence Southeasterly along the centerline of said highway to a point where said centerline is  $237\frac{1}{2}$  feet North of the North line of said Lot "L" of Lot Five (5); thence Southwesterly to the point of beginning, except therefrom the following described tract of land, to-wit: Begin at the Northwest corner of Lot "L" of said Lot five (5); thence East 476 feet; thence North 372.26 feet to the point of beginning of the tract to be described; thence North 196 feet; thence East 149.02 feet to the center of public highway as now established; thence Southeasterly along the centerline of said highway 247 feet; thence Northwesterly to the point of beginning.

We do further state that said land abuts the City of Delano, is not included in any other municipality, and is land suitably situated and conditioned as to be properly subject to inclusion within the municipality.

DATED JUNE 3, 1983

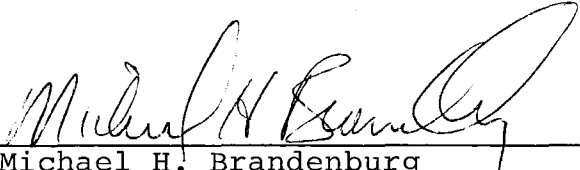
  
Michael H. Brandenburg

  
Dorothy Ann Brandenburg

12  
5  
to wit.

That part of Lot 5 of the East Half of the Northwest Quarter ( $E\frac{1}{2}$  of  $NW\frac{1}{4}$ ) and West Half of the Northeast Quarter ( $W\frac{1}{2}$  of  $NE\frac{1}{4}$ ) of Section 11, Township 118, Range 25, described as follows: Begin at the Northwest corner of Lot "L" of said Lot five (5); thence East 476 feet; thence North 215 feet to the point of beginning of the tract to be described; thence North 353.26 feet; thence East a distance of 149.02 feet to center of public highway as now established; thence Southeasterly along the centerline of said highway to a point where said centerline is  $237\frac{1}{2}$  feet North of the North line of said Lot "L" of Lot Five (5); thence Southwesterly to the point of beginning, except therefrom the following described tract of land, to-wit: Begin at the Northwest corner of Lot "L" of said Lot five (5); thence East 476 feet; thence North 372.26 feet to the point of beginning of the tract to be described; thence North 196 feet; thence East 149.02 feet to the center of public highway as now established; thence Southeasterly along the centerline of said highway 247 feet; thence Northwesterly to the point of beginning.

DATED: 7-15-83

Mollie Little

Chairman

ATTEST:

Norma Chadwick

Clerk

Exhibit A

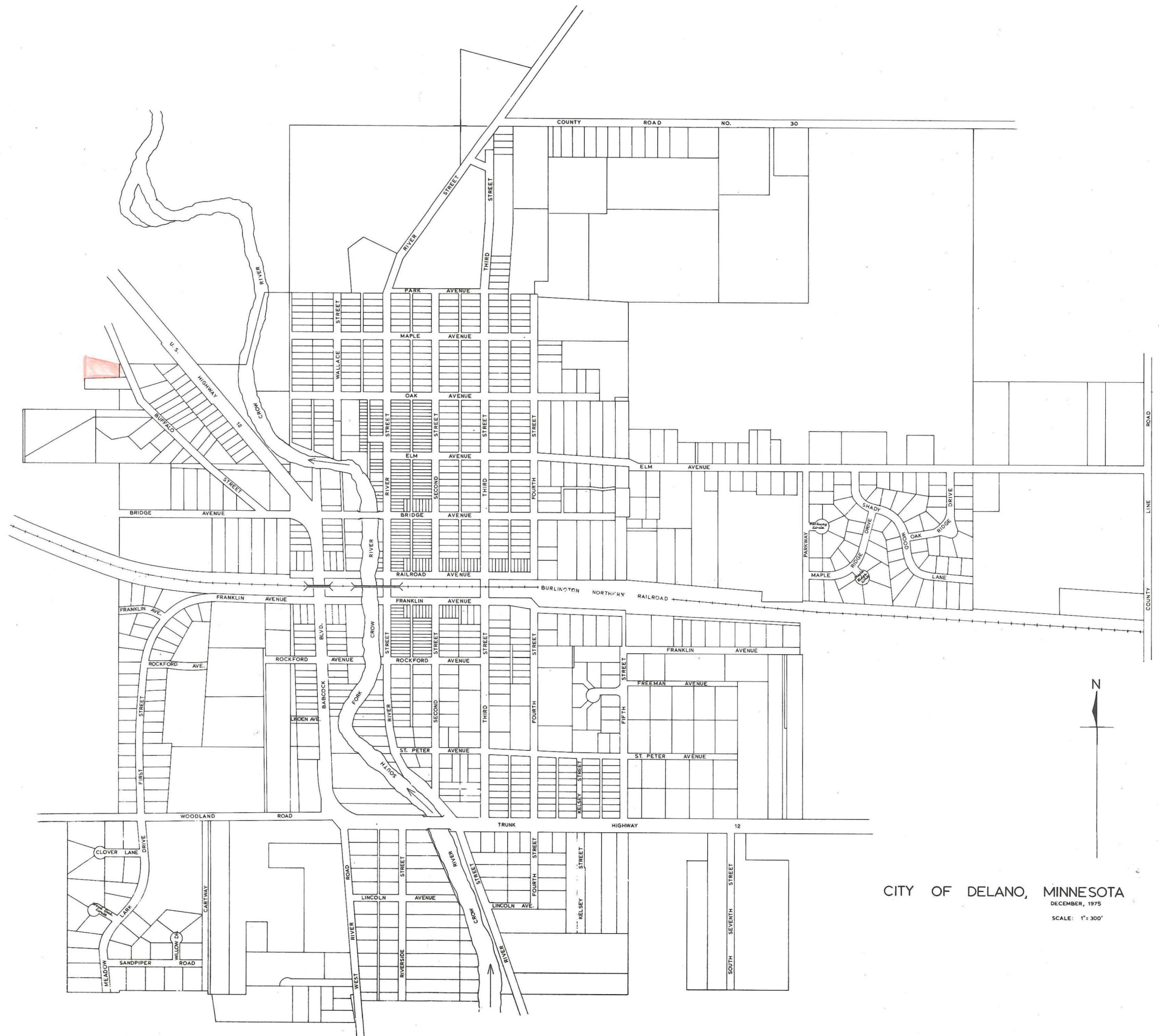

CITY OF DELANO, MINNESOTA  
DECEMBER, 1975  
SCALE: 1" = 300'