

REC'D. BY NOV 16 1983
MMB

STATE OF MINNESOTA

COUNTY OF MURRAY

CITY OF SLAYTON

ORDINANCE NO. 204

AN ORDINANCE EXTENDING THE CORPORATE LIMITS OF THE CITY OF SLAYTON, MURRAY COUNTY, MINNESOTA, TO INCLUDE CERTAIN UNINCORPORATED TERRITORY BORDERED BY LAND WITHIN THE CITY LIMITS AND ABUTTING THEREON.

WHEREAS, certain territory described below is not presently included within the corporate limits of any incorporated city, or borough; and

WHEREAS, this territory is forty (40) acres or less in area and sixty per cent (60%) or more of the perimeter of the territory is bordered by lands already included within the corporate limits of the City of Slayton; and

WHEREAS, this territory is deemed to be urban or suburban in character; and

WHEREAS, proper notice has been given by the City of Slayton of its intent to annex and no objections to the annexation have been received or filed; and

WHEREAS, the time period for the filing of objections has now expired;

THE CITY COUNCIL OF THE CITY OF SLAYTON, MINNESOTA, ORDAINS:

Section 1. Territory Annexed. The corporate limits of the City of Slayton, Minnesota, are hereby extended to include the unplatted territory described as follows, sixty per cent (60%) or more of the perimeter of which territory is bordered by territory already included within the City limits:

All that part of the Northwest Quarter of the Southeast Quarter (NW $\frac{1}{4}$ SE $\frac{1}{4}$) of Section Ten (10), Township One Hundred Six (106) North, Range Forty-one (41) West of the Fifth Principal Meridian (Slayton Township) bounded by the following described lines:

Commencing at the Center of Section 10-106-41, being a point on the center line of Trunk Highway #59, 2646.20 feet north of the south quarter corner of said Section 10, thence southerly along and upon the west line of the southeast quarter of said Section 10 on an assumed bearing of S. 00 degrees 00' for a distance of 484.52 feet to the point of beginning;

Thence S. 00 degrees 00' for a distance of 156.00 feet;
Thence S. 89 degrees 17' 20" E. for a distance of 375.00 feet;
Thence N. 00 degrees 00' for a distance of 156.00 feet;
Thence N. 89 degrees 17' 20" W. for a distance of 375.00 feet
to the point of beginning and there terminating;

Containing 1.342 acres more or less, and subject to T.H. #59 right of way of 0.268 acres more or less.

The south line of the above-described tract coincides in part with the south line of Lot One (1), Slayton Heights Addition, and the above-described tract includes all of Lot One (1), Slayton Heights Addition, except the east 125 feet of said Lot 1.

Section 2. Filing. The City Clerk is directed to file certified copies of this Ordinance with the Secretary of State, the Murray County Auditor and the Town Clerk of Slayton Township and the Minnesota Municipal Board.

Section 3. Effective Date of Annexation. This Ordinance takes effect upon passage and publication and the filing of certified copies as directed in Section 2 and approved by the Minnesota Municipal Board.

Passed by the City Council of the City of Slayton, Minnesota, this 7th day of November, 1983.

CITY OF SLAYTON



EDWARD SUEDBECK
MAYOR

ATTEST:

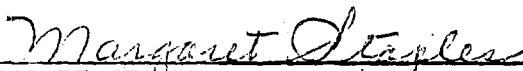
MARGARET STAPLES
CITY CLERK

I hereby certify that the above is a true and correct copy of Ordinance No. 204 duly passed, adopted and approved by the City Council on November 7th, 1983.

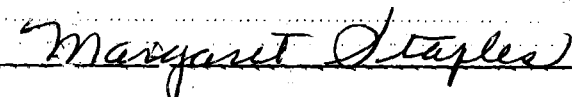

MARGARET STAPLES
CITY CLERK



CITY OF SLAYTON

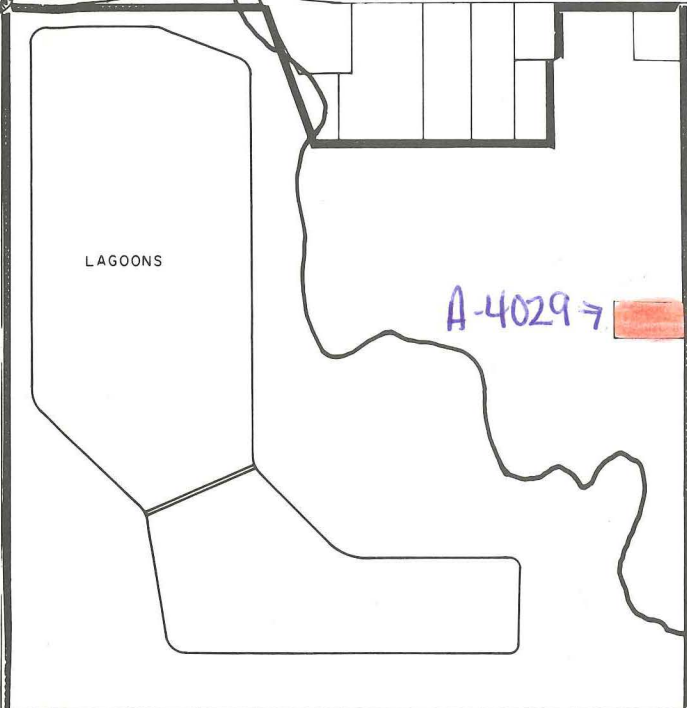

— CORPORATE LIMITS



A-4029 →



Tracts TO BE ANNEXED

A-4028 →



BEAVER CREEK

BEAVER CREEK

ENGBRETSON STREET

ERLANDSON AVE.

ALVAREED RD

HOSPITAL AVE.

22 ND ST

22 ND ST

24 TH ST

24 TH ST

24 TH ST

25 TH ST

25 TH ST

25 TH ST

COURT ST.

HOSPITAL AVE.

20 TH ST

23 RD

23 RD

23 RD

23 RD

23 RD

23 RD

23 RD

23 RD

23 RD

23 RD

LINDEN AVE.

22 ND ST

22 ND ST

22 ND ST

22 ND ST

22 ND ST

22 ND ST

22 ND ST

22 ND ST

22 ND ST

22 ND ST

22 ND ST

22 ND ST

22 ND ST

22 ND ST

22 ND ST

22 ND ST

22 ND ST

22 ND ST

22 ND ST

22 ND ST

22 ND ST

22 ND ST

22 ND ST

22 ND ST

22 ND ST

22 ND ST

22 ND ST

22 ND ST

22 ND ST

22 ND ST

22 ND ST

22 ND ST

22 ND ST

22 ND ST

22 ND ST

CITY OF SLAYTON

CITY OF SLAYTON (AIRPORT)