

RESOLUTION NO. 2005-054

**IN THE MATTER OF THE AMENDMENT TO THE JOINT RESOLUTION
FOR ORDERLY ANNEXATION BETWEEN THE TOWNSHIP OF ISANTI
AND THE CITY OF ISANTI, MINNESOTA PURSUANT TO MINNESOTA
STATUTES 414.0325. SUBD. 1**

**TO: OFFICE OF STRATEGIC & LONG RANGE PLANNING, ROOM 300, 658
CEDAR STREET, ST. PAUL, MN 55155:**

WHEREAS, the Township of Isanti and the City of Isanti are parties to a Joint Resolution for Orderly Annexation, which Joint Resolution was duly filed with the Municipal Board on August 31, 1973, (File No: A-2457(OA) which Resolution has since been amended to include additional lands; and,

WHEREAS, the lands described on the attached Exhibit "A", incorporated herein by this reference, are included in the area designated by said Joint Resolution as properly subject to and in need of Orderly Annexation as provided by Statute;

**NOW, THEREFORE, BE IT RESOLVED BY THE TOWNSHIP OF
ISANTI AND THE CITY OF ISANTI, AS FOLLOWS:**

1. Both the Township and the City agree that no alteration of the stated boundaries of the lands herein designated for annexation pursuant to this Resolution, as described on Exhibit "A" attached hereto and made a part hereof is appropriate. Further, both the City and Township agree that pursuant to Minnesota Statutes 414.0325, Subd. 1, no consideration by the Office of Strategic & Long Range Planning, is necessary for annexation of the herein described territory to the City of Isanti. Upon receipt of this Resolution, the Office of Strategic & Long Range Planning may review and comment, but shall, within thirty (30) days, order the annexation of the property as described on the attached Exhibit "A" in accordance with the terms of this Joint Resolution.

Adopted by Resolution of the Isanti Township Board this 16th day of May,
2005.

ISANTI TOWNSHIP BOARD

By: Michael Delund
Its: Chairman

By: Ann Scott
Its: Township Clerk

Adopted by Resolution of the Isanti City Council this 19th day of April 2005.

Attest:

Irene J. Bauer, City Clerk-Treasurer

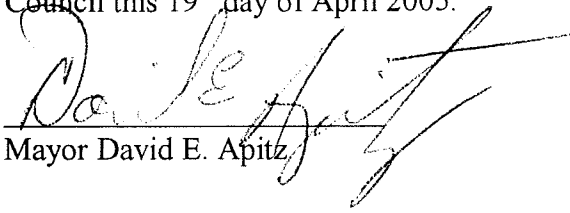
Mayor David E. Apitz

(SEAL)

Exhibit "A"

REC'D BY
M M B

MAY 19 2005

Parcel 1
Gas Station Parcel
Northland 66 Premium Stores LLC
PID: 050290800
2.79 Acre Parcel

All that part of the Southwest Quarter of the Northeast Quarter, of the Southeast Quarter of the Northwest Quarter, and of Lots 1, 2, and 3, Eastview Terrace, according to the plat thereof of record, all in Section 29, Township 35, Range 23, Isanti County, Minnesota, being more particularly described as follows:

Beginning at the southwest corner of said Southwest Quarter of the Northeast Quarter; thence South 89 degrees 59 minutes 25 seconds East, assumed basis of bearings, along the south line of said Southwest Quarter of the Northeast Quarter a distance of 216.67 feet; thence North 01 degree 16 minutes 13 seconds West 330.59 feet; thence North 89 degrees 59 minutes 25 seconds West 381.33 feet, more or less, to the easterly right-of-way line of State Trunk Highway No. 65; thence southerly along said right-of-way line 332.77 feet, more or less, to the south line of said Southeast Quarter of the Northwest Quarter; thence South 89 degrees 59 minutes 25 seconds East along said south line 210.76 feet, more or less, to the point of beginning; subject to roads, easements and restrictions if any.

Parcel 2
PID: 050400050
3.00 Acre Parcel

All that part of the Southwest Quarter of the Northeast Quarter, of the Southeast Quarter of the Northwest Quarter, and of Lots 3, 4, 5, and 6, Eastview Terrace, according to the plat thereof of record, all in Section 29, Township 35, Range 23, Isanti County, Minnesota, being more particularly described as follows:

Commencing at the southwest corner of said Southwest Quarter of the Northeast Quarter; thence South 89 degrees 59 minutes 25 seconds East, assumed basis of bearings, along the south line of said Southwest Quarter of the Northeast Quarter a distance of 216.67 feet; thence North 01 degree 16 minutes 13 seconds West 330.59 feet to the point of beginning; thence continuing North 01 degree 16 minutes 13 seconds West 229.41 feet; thence North 13 degrees 27 minutes 58 seconds East 134.94 feet; thence North 89 degrees 59 minutes 25 seconds West 365.36 feet, more or less, to the easterly right-of-way line of State Highway Trunk No. 65; thence southerly along said right-of-way line 363.05 feet, more or less, to the intersection thereof with a line drawn through the point of beginning and

REC'D BY
MMB

MAY 19 2005

having a bearing of North 89 degrees 59 minutes 25 seconds West; thence South 89 degrees 59 minutes 25 seconds East 381.33 feet, more or less, to the point of beginning, and containing 3.00 acres, more or less.

Subject to roads, easements, and restrictions, if any.

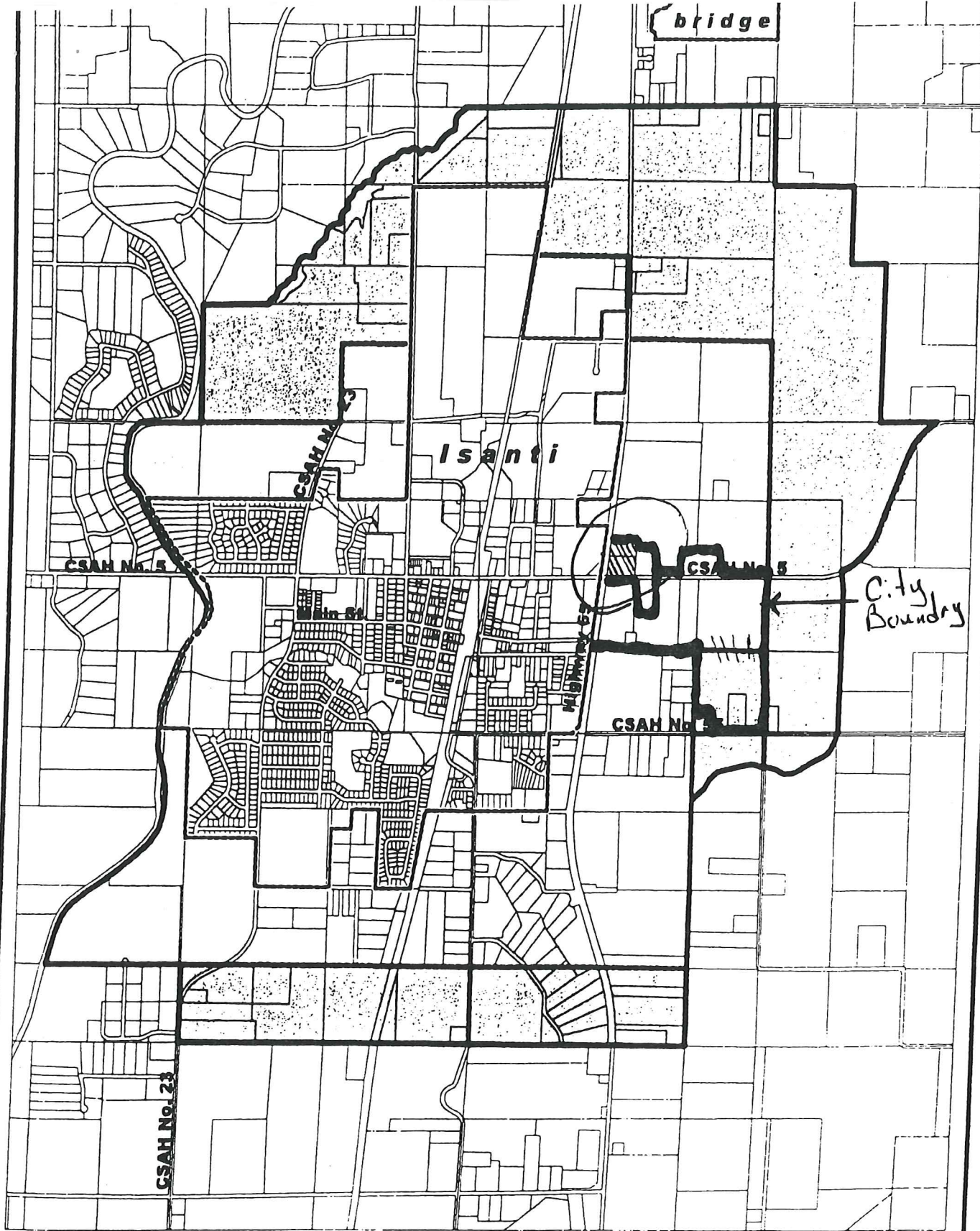





Figure 8.
Proposed USA Tier I Boundary
 Isanti, Minnesota

-  City Boundary
-  Existing USA I Boundary
-  Proposed USA I Boundary

REC'D BY
 MMB

MAY 19 2005



Prepared by Dahlgren, Shadlow and Lihan, Inc.
 December 28, 2001



See Page

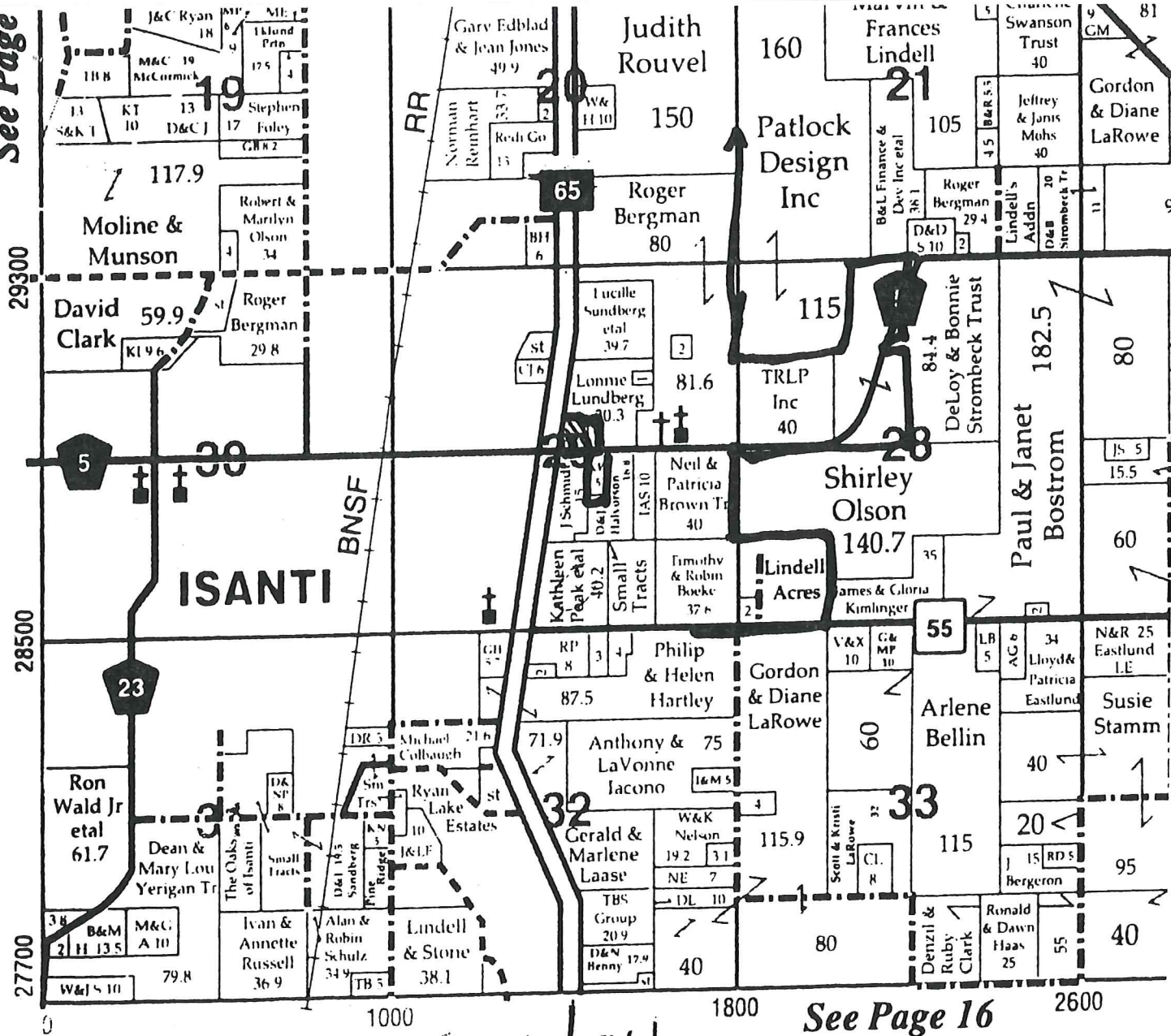

REC'D BY
MMB

MAY 19 2005

even Odd

See Page 16

"Call Us For All Your

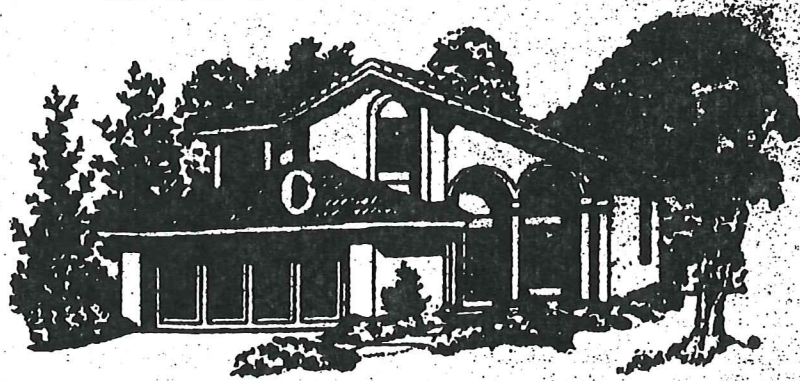

Home • Farm
Health • Invest
Clark G.

(763) 444-9491

Hwy 65 NE & 291st Ave. • Box 368 • Isanti