

IN THE MATTER OF THE JOINT
RESOLUTION OF THE TOWNSHIP OF
WORTHINGTON AND THE CITY OF
WORTHINGTON DESIGNATING AN
UNINCORPORATED AREA AS IN
NEED OF ORDERLY ANNEXATION
AND CONFERRING JURISDICTION
OVER SAID AREA TO THE
MINNESOTA MUNICIPAL BOARD

AMENDMENT TO THE JOINT
RESOLUTION FOR ORDERLY
ANNEXATION BETWEEN THE
TOWNSHIP OF WORTHINGTON
AND
THE CITY OF WORTHINGTON
ORIGINALLY ADOPTED ON
SEPTEMBER 1, 1972, PURSUANT
TO M.S. 414.0325

The Township of Worthington and the City of Worthington hereby jointly agree that the area designated for orderly annexation in the Joint Resolution between the Township of Worthington and the City of Worthington Designating an Area for Orderly Annexation dated September 1, 1972, be amended to include the following:

1. The Township of Worthington and the City of Worthington request immediate annexation of the following described territory to the City of Worthington:

All of the Northwest Quarter (NW -1/4) of Section 13, Township 102, Range 40, Nobles County, Minnesota, except those portions already situated within the boundary of the City of Worthington.

2. Both the Town of Worthington and the City of Worthington agree that no alteration of the stated boundaries of this agreement is appropriate. Furthermore, both parties agree that no consideration by the Municipal Board is necessary. Upon receipt of this resolution, passed and adopted by each party, the Municipal Board may review and comment, but shall, within thirty (30) days, order the annexation, in accordance with the terms of this joint resolution.
3. That the Town Board of the Township of Worthington, and the City Council of the City of Worthington, upon passage and adoption of this resolution and upon the acceptance by the Municipal Board, confer jurisdiction upon the Municipal Board over the various provisions contained in this Agreement.
4. That this certain property which abuts the City of Worthington is presently urban or suburban in nature or is about to become so. Further, the City of Worthington is capable of providing services to this area within a reasonable time, and the annexation is in the best interest of the area proposed for annexation.
5. The population change with this annexation shall be 0.
6. Upon the annexation the parcel shall be zoned TZ - Transitional Zoning.
7. The tax differential for this annexation shall be established over a one year period.

REC'D. BY FEB 10 1997
MMB

Approved by the Town of Worthington this 3 day of Feb, 1997.

Town of Worthington

BY: Keith W. Schroeder
Keith Schroeder, Town Board Chair

BY: Dorothy Bauman
Dorothy Bauman, Town Board Clerk

Approved by the City of Worthington this 27 day of January, 1997.

(SEAL)

City of Worthington

BY: Robert J. Demuth
Robert J. Demuth, Mayor

ATTEST:

Garnet A. Burns
Garnet A. Burns, City Clerk

AIRPORT

REC'D. BY FEB 10 1997
MMR

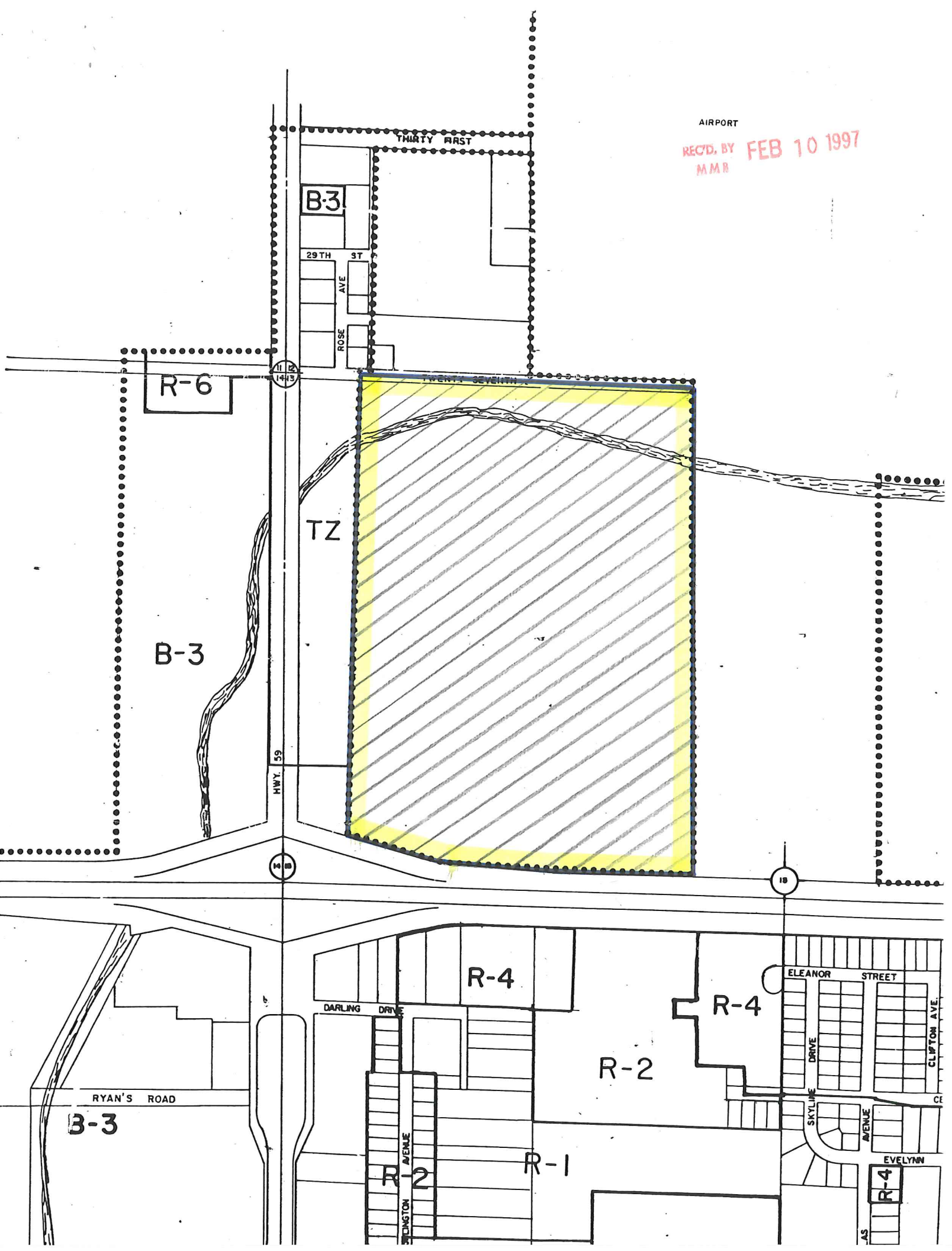

TOPOGRAPHY MAP OF WORTHINGTON

REC'D BY FEB 10 1997
MMR
MIDLAND ATLAS CO. INC.
SILSBANK, SOUTH DAKOTA

