

RESOLUTION

The Village of Prior Lake, through its Village Council, hereby resolves:

The Village Council of the Village of Prior Lake is advised that a Petition for Annexation has been initiated by the owners of the following described parcels of real estate of have said real estate annexed to the Village of Prior Lake.

1. The North Three-Fourths of the Southeast one-quarter of the Northeast one-quarter of Section Eleven (11), Township One Hundred Fourteen (114), Range Twenty-two (22), Scott County Minnesota, owned by the Village of Prior Lake.
2. The Northeast Quarter of the Northeast Quarter (NE 1/4 of NE 1/4) of Section 11, Township 114 North, Range 22 West, Scott County, Minnesota, together with a roadway easement for ingress and egress over the West 60 feet of that portion of the East half of the Northeast Quarter (E 1/2 of NE 1/4) and the West 60 feet of that portion of the Northeast Quarter of the Southeast Quarter (NE 1/4 of SE 1/4), lying Northerly of Fulton Road, all in said Section 11, owned by the Village of Prior Lake.
3. That part of the Northwest Quarter (NW 1/4) of Section 11, Township 114, Range 22, Scott County, Minnesota described as follows:

Beginning at a point on the East line of said Northwest Quarter distant 842.84 feet Southerly of the Northeast corner of said Northwest Quarter; thence North 00 degrees 19'09" East along said East line a distance of 842.84 feet to the Northeast corner of said Northwest Quarter; thence west along the North line of said Northwest Quarter a distance of 715.31 feet to a point distant 1924.78 feet East of the Northwest corner of said Northwest Quarter; thence South 19 degrees 27'00" East a distance of 100.00 feet; thence South 17 degrees 20'48" East a distance of 99.48 feet; thence South 16 degrees 32'58" East a distance of 99.67 feet; thence South 17 degrees 11'00" East a distance of 210.0 feet more or less to the Northeast corner of the plat of O'Rourke Addition; thence South 17 degrees 11'00" East along the Easterly line of said Addition and its Southerly extension a distance of 380.00 feet to a point 80 feet Southerly as measured along the Southerly extension of the Easterly line of said Addition; thence South 72 degrees 49'00" West parallel with the Southerly line of said Addition a distance of 218.4 feet more or less to the center line of Township Road; thence Southeasterly along said

center line to its intersection with a line which bears South 53 degrees 28'40" West from the point of beginning; thence North 53 degrees 28'40" East from the point of beginning; thence North 53 degrees 28'40" East a distance of 600.66 feet to the point of beginning.

Containing 13.95 acres more or less, owned by Stassen Construction, Inc.,

4. That part of the Northwest Quarter (NW 1/4) of Section 11, Township 114, Range 22, Scott County, Minnesota, described as follows:

Commencing at the Southeast corner of the plat of O'Rourke Addition; thence Southerly along the Southerly extension of the Easterly line of said Addition a distance of 40.00 feet to the point of beginning of the tract of land to be described; thence continuing Southerly along said extension a distance of 40.00 feet; thence Southeasterly paralleled with the Southerly line of said Addition a distance of 218.4 feet more or less to the center line of a Township Road; thence Northerly along said center line a distance of 40.00 feet to its intersection with a line parallel with and distant 40.00 feet Southerly of the Southerly line of said Addition; thence Northeasterly along said line to the point of beginning, owned by Stassen Construction, Inc.

Said owners have also petitioned the Village of Prior Lake to annex that parcel of real estate described as follows:

West 1/2 of NE quarter (W 1/2 of NE 1/4) of section eleven (11) Township 114, Range 22, Scott County lying northeast of the Township Road, owned by Joseph P. McNulty.

The Village of Prior Lake hereby supports the Petition for Annexation of said real estate to the Village of Prior Lake pursuant to the provisions of Minnesota Statute 414.0325.

Passed this 4th day of August, 1980.

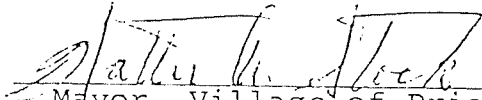

Mayor, Village of Prior Lake

Attested by:

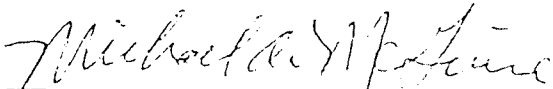

Clerk, Village of Prior Lake

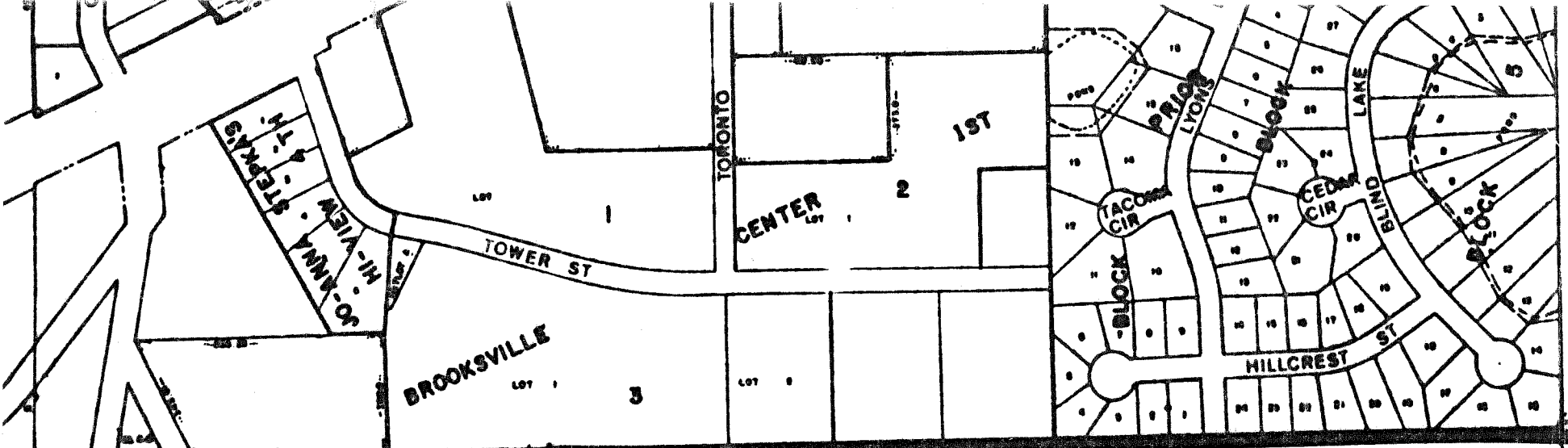

NE 1/4 of the NE 1/4 Sec. 11 T114 R22

NE 1/4 SEC. 11

W 1/2 of NE 1/4 Sec. 11

N 3/4 of the SE 1/4 of the NE 1/4 Sec 11

SE 1/4 SEC 11

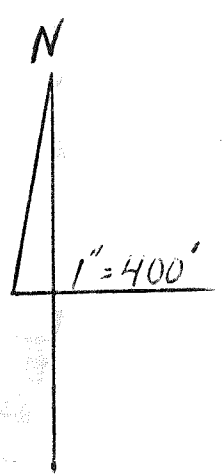

REC'D BY NOV 26 1980

CO RD 23