

**RESOLUTION NO. 2009 - 02**

**A RESOLUTION ANNEXING PROPERTY (FLETCHER DEVELOPMENT, LLP) FROM THE TOWN OF HASSAN INTO THE CITY OF ROGERS (MBA DOCKET OA-992)**

**WHEREAS,** the City of Rogers ("City") and the Town of Hassan ("Hassan"), have entered into an orderly annexation agreement entitled, "Agreement between the Town of Hassan and the City of Rogers for Growth Management, Orderly Annexation and the Exercise of Joint Powers for the Extension of Municipal Services and Transportation Improvements" identified as MBA Docket No. OA-992; and

**WHEREAS,** said Agreement constitutes a "Joint Resolution" between the City and the Town authorized by Minn. Statutes §414.0325; and

**WHEREAS,** said Agreement designates the land shown on the attached map and legally described in Exhibit A as Phase II property and which may be annexed only in a contiguous manner to the City during the period of January 1, 2004 and August 15, 2010 (said described land is so contiguous) and provides for annexation of said land; and

**WHEREAS,** pursuant to said Annexation Agreement between the City and the Township (Docket No. OA-992), the City of Rogers states:

1. That the following described property in Hassan Township is subject to annexation pursuant to Minnesota State Statutes 414.0325 and the said "Joint Resolution" and hereby requests annexation of the following described properties to wit:

**SEE ATTACHED EXHIBIT A**

2. That the annexation as contemplated herein pursuant to subparagraph 4.02(c) of the Joint Resolution has been triggered by all the landowner(s) filing a petition with the City for annexation and connection with the City municipal sewer and water services and the City filing this Resolution with the Department of Administration and Municipal Boundary Adjustments following receipt of such Petition.
3. Said Joint Resolution provides that the City may execute a resolution for annexation of property and file the same with the Department of Administration, Municipal Boundary Adjustments, or its successors upon the occurrence of any event triggering annexation as provided in said Joint Resolution.

4. Upon receipt of this Resolution from the City providing for annexation of a designated area and a copy of the initial Joint Resolution, the Department of Administration and Municipal Boundary Adjustments pursuant to Minnesota Statutes 414.0235, may review and comment, but shall, within 30 days of receipt of this Resolution order the annexation of the area designated therein in accordance with the terms and conditions of the Joint Resolution.
5. The City acknowledges that after annexation of any portion of Phase II, pursuant to the terms of the Joint Resolution, the City shall provide municipal governmental services to such area, and the parcels therein shall then be required to connect to municipal sewer and water services as directed by the City from time to time.
6. Pursuant to paragraph 5.01 of the Joint Resolution, the City of Rogers' portion of the property taxes for these properties is phased over a five year period.

**NOW, THEREFORE,** be it resolved by the City Council of the City of Rogers, that:

- A. The recitals set forth above are incorporated herein.
- B. The City of Rogers has approved the proposed annexation of the aforementioned property of Hassan Township in the City of Rogers.
- C. The staff is hereby directed to forward this Resolution to Minnesota Municipal Boundary Adjustments for review and comment.

Moved by Councilmember Bunting, seconded by Councilmember Bell

The following voted on favor of said Resolution: Bell, Davis, Bunting,

The following voted against the same: Grimm, Rauenhorst  
None

Whereupon said Resolution was declared carried.

Dated this 13th day of January, 2009.

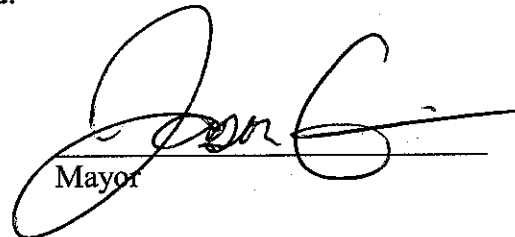
  
Mayor

ATTEST:

  
Asst. City Administrator/City Clerk

(SEAL)

REC'D BY  
MAR

JAN 21 2009

**EXHIBIT A**

**LEGAL DESCRIPTION**

That part of the Southwest Quarter of the Northwest Quarter, Section 25, Township 120 North, Range 23 West, Hennepin County, Minnesota, lying Southwesterly of the Railroad right-of-way EXCEPT the West 8 rods of the North 24 rods thereof; and EXCEPT the West 631.95 feet of the South 461.33 feet thereof; also

That part of the Northwest Quarter of the Southwest Quarter, Section 25, Township 120 North, Range 23 West, lying Northerly of the centerline of the Minneapolis and Monticello Road EXCEPT the West 632.00 feet thereof; also

That part of the Northwest Quarter of the Southwest Quarter, Section 25, Township 120 North, Range 23 West, lying Southerly of the centerline of the Minneapolis and Monticello Road and Westerly of a line described as follows:

Beginning at a point on the South line of said Northwest Quarter of the Southwest Quarter distant 522.41 feet West from the Southeast corner of said Northwest Quarter of the Southwest Quarter; thence Northeasterly, deflecting 105 degrees, 54 minutes, 56 seconds to the right, to the center line of the Minneapolis and Monticello Road and there terminating.

all in Section 25, Township 120, Range 23, Hennepin County, Minnesota, according to the recorded plat thereof.

PID #25-120-23 23 0004

Will be rezoned to residential (infuture)

Approximately 54.08 acres.

REC'D BY  
M M D

JAN 21 2009

## Hennepin County Property Map - Tax Year: 2008

The data contained on this page is derived from a compilation of records and maps and may contain discrepancies that can only be disclosed by an accurate survey performed by a licensed land surveyor. The perimeter and area (square footage and acres) are approximates and may contain discrepancies. The information on this page should be used for reference purposes only. Hennepin County does not guarantee the accuracy of material herein contained and is not responsible for any misuse or misrepresentation of this information or its derivatives.

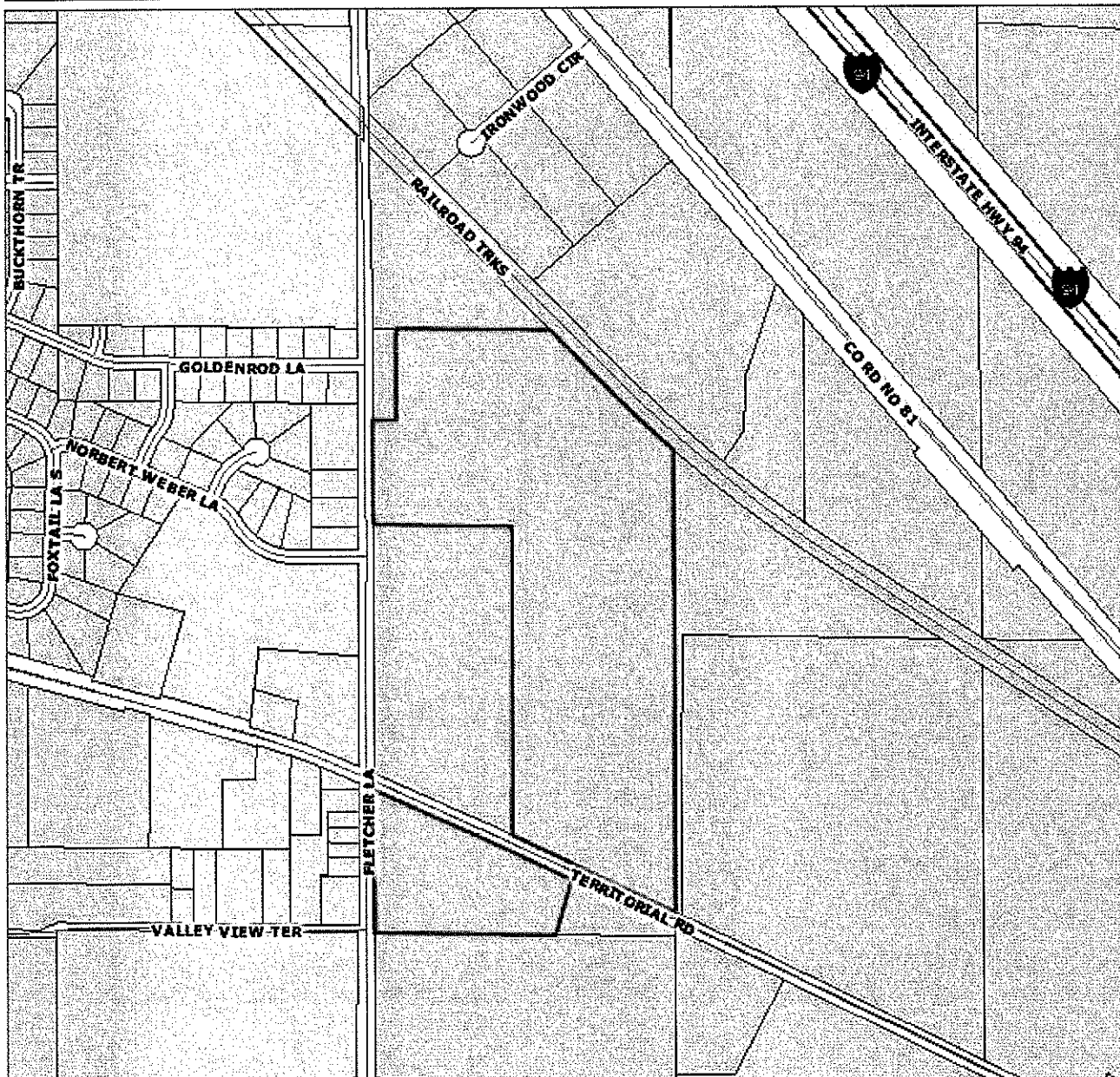

### Selected Parcel Data

Parcel ID: 25-120-23-23-0004

Owner Name: FLETCHER DEVELOPMENT LLP

Parcel Address: 12000 FLETCHER LA , HASSAN TOWNSHIP , MN 55311

Property Type: FARM

Homestead: NON-HOMESTEAD

Area (sqft): 2355610

Area (acres): 54.08

A-T-B: ABSTRACT

Market Total: \$4,102,200.00

Tax Total: \$26,807.96

Date Printed: 1/13/2009 9:42:48 AM

Current Parcel Date: 1/5/2009

Sale Price: \$940,000.00

Sale Date: 07/2005

Sale Code:

SEH DataView Parcel Report

REC'D BY  
AAAB

JAN 21 2009 1/15/2009

