

JOINT RESOLUTION FOR ORDERLY ANNEXATION

IN THE MATTER OF JOINT RESOLUTION OF THE TOWNSHIP OF SPRING VALLEY AND THE CITY OF SPRING VALLEY DESIGNATING AN UNINCORPORATED AREA AS IN NEED OF ORDERLY ANNEXATION AND CONFERRING JURISDICTION OVER SAID AREA TO MINNESOTA PLANNING PURSUANT TO MINN. STAT. § 414.0325.

The Township of Spring Valley in the City of Spring Valley, hereby agree to the following:

1. That the following area described in Spring Valley Township is subject to Orderly annexation pursuant to Minnesota Statute § 414.0325, and the parties hereto designate this area for orderly annexation:

That part of the NE $\frac{1}{4}$ NW $\frac{1}{4}$ of Sec. 28-103-13, Fillmore County, Minnesota described as follows: Commencing at the Northeast corner of said NE $\frac{1}{4}$ NW $\frac{1}{4}$; thence North 89 degrees 58 minutes 01 seconds West (assumed bearing) along the North line of said NE $\frac{1}{4}$ NW $\frac{1}{4}$, 740.45 feet to the centerline of the Spring Valley-Hamilton Territorial Road (formerly a Township Road); thence South 18 degrees 27 minutes 20 seconds East along said centerline, 1091.90 feet to the point of beginning of the tract of land to be herein described; thence continuing South 18 degrees 27 minutes 20 seconds East along said centerline, 285.22 feet to the South line of said NE $\frac{1}{4}$ NW $\frac{1}{4}$; thence North 89 degrees 48 minutes 55 seconds East along said South line 305.94 feet to the Southeast Corner of said NE $\frac{1}{4}$ NW $\frac{1}{4}$; thence North 00 degrees 03 minutes 47 seconds West along the East line of said NE $\frac{1}{4}$ NW $\frac{1}{4}$, 356.12 feet; thence South 77 degrees 39 minutes 54 seconds West, 405.19 feet to the point of beginning and containing 2.57 acres, more or less. Subject to easement for C.S.A.H. No. 8 across the Westerly line thereof. Subject to easement for MN Trunk Highway No. 63 & 16 across the Westerly line thereof. Subject to any other easements of record.

2. That the Township of Spring Valley does, upon passage of this resolution and its adoption by the City Council of the City of Spring Valley, Minnesota, and upon acceptance by Minnesota Planning, confer jurisdiction upon Minnesota Planning over the various provisions contained in this agreement. No consideration by Minnesota Planning is necessary. Minnesota Planning may review and comment, but shall, within 30 days, order the annexation in accordance with the terms of the resolution.
3. The above described real estate, which abuts the City of Spring Valley, Minnesota is presently residential in nature. Further, the City of Spring Valley is capable of providing services to this area within a reasonable time.

REC'D BY
MMB

JUN 18 2003

Minnesota is presently residential in nature. Further, the City of Spring Valley is capable of providing services to this area within a reasonable time.

City of Spring Valley

Passed and adopted by the City Council of the City of Spring Valley this 21st day of May, 2003.

BY:

ATTEST:

James Struzyk, Mayor

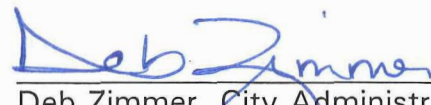

Deb Zimmer, City Administrator

Township of Spring Valley

Passed and adopted by the township of Spring Valley this 21st day of May, 2003.

BY:

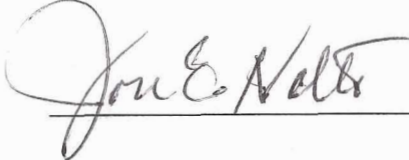
ATTEST:

Jon E. Valters



Anna Cooper

Annexation

Parcel being annexed into the city limits,
by request of the property owners.
Parcel # 35.0299.010

REC'D BY
MMB

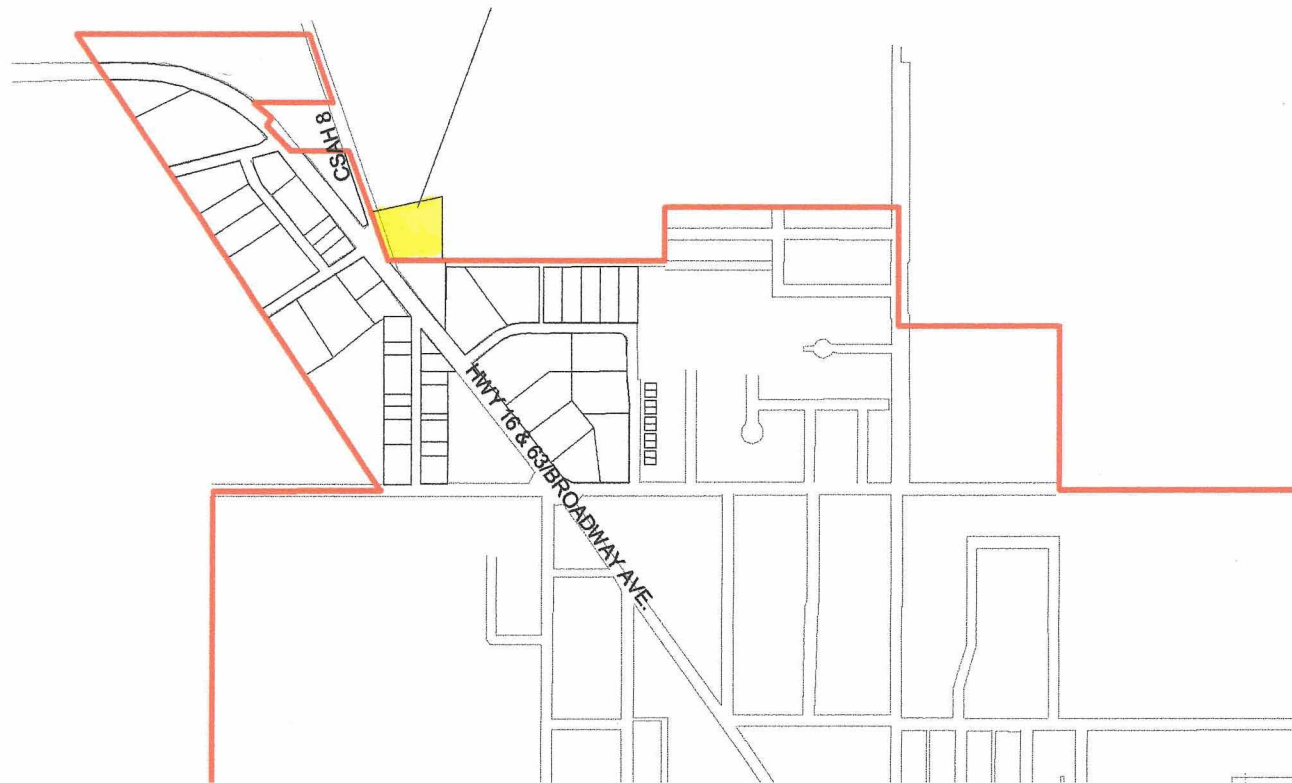
JUL 02 2003



- Street casings.shp
- Corporate limits.shp
- Parcels.shp
- Rivers.shp
- Row lines.shp

0.5

0

0.5

1 Miles

