

JOINT RESOLUTION FOR ORDERLY ANNEXATION

IN THE MATTER OF THE JOINT RESOLUTION OF THE TOWNSHIP OF NEW LONDON AND THE CITY OF NEW LONDON DESIGNATING AN UNINCORPORATED AREA AS IN NEED OF ORDERLY ANNEXATION AND CONFERRING JURISDICTION OVER SAID AREA TO MINNESOTA PLANNING PURSUANT TO 414.0325.

The Township of New London and the City of New London hereby agree to the following:

1. That the following described area in New London Township is subject to orderly annexation pursuant to Minnesota Statutes 414.0325, and the parties hereto designate this area for orderly annexation:

TRACT A:

That part of the SE $\frac{1}{4}$ of the NW $\frac{1}{4}$ of Section 15, Township 121, Range 34 described as follows: Commencing at the Northeast corner of said SE $\frac{1}{4}$ of the NW $\frac{1}{4}$: thence on an assumed bearing of S 87 degrees 09' 54" W. along the North line said SE $\frac{1}{4}$ of the NW $\frac{1}{4}$. a distance of 960.41 feet to a point on the Easterly right-of-way line of State of Minnesota (D.N.R.) formerly known as Old Burlington Northern Railroad right-of-way: thence Southwesterly along the last said right-of-way line, along a non-tangent curve, concave to the East 235.35 feet. having a delta of 7 degrees 20' 53" and a radius of 1835.00 feet and a chord bearing and distance of S 7 degrees 00' 52" W. 235.19 feet: thence on a bearing of S 3 degrees 24' 49" W. along last said right-of-way line. tangent to the last said curve. 30.00 feet to the point of beginning of the tract herein described: thence on a bearing of S 79 degrees 11' 28" E. 369.23 feet to the point on the Westerly right-of-way line of S.T.H No 23: thence Southwesterly along the last said right-of-way line, along a non-tangent curve, concave to the Southeast 430.38 feet, having a delta of 3 degrees 12' 00". and a radius of 2964.79 feet and a chord bearing and distance of S 32 degrees 23' 39" W. 165.56 feet: thence on a bearing of N 55 degrees 24' 50" W. 334.20 feet to a point on the Easterly right-of-way line of State of Minnesota (D.N.R.) formerly known as Old Burlington Northern Railroad right-of-way: thence on a bearing of N 3 degrees 26' E. along last said right-of-way line. 19.36 feet to the point of beginning.

Containing .71 acres, more or less.

2. That the Township of New London does, upon passage of this resolution and its adoption by the City Council of the City of New London, Minnesota, and upon acceptance by Minnesota Planning, confer jurisdiction upon Minnesota

Planning over the various provisions contained in this agreement. No consideration by Minnesota Planning is necessary, Minnesota Planning may review and comment, but shall, within 30 days, order the annexation in accordance with the terms of the resolution.

3. Certain properties abutting the City of New London are presently residential in nature or are about to become so. Further, the City of New London is capable of providing services to this area within a reasonable time.

City of New London

Passed and adopted by the City council of the City of New London this 7th day of May, 2003.

BY:

ATTEST:



John Mack, Mayor



Trudie Dubord, City Clerk

Township of New London

Passed and adopted by the township board of the township of New London this 23rd day of April, 2003.

BY:

ATTEST:



Merle Gjerde, Township Chair



Nancy Hammerschmidt, Township Clerk

B-2 - 5,000
Zoning

CH BRG. - S 7° 0'
CH-235.1
Δ-7° 20' S
L-235.35
R-1835.01

REC'D BY
MME MAY 22 2003

N 3° 26' E
623.31'

N 3° 26' E
19.36'

30.00'
S 3° 24' 49" W

S 79° 11' 28" E
369.23'

N 55° 24' 50" W
334.21'

R-2964.79'
L-165.58'
Δ-3° 12' 00"
CH-165.00'

CH BRG. - S 32° 23' 39" W

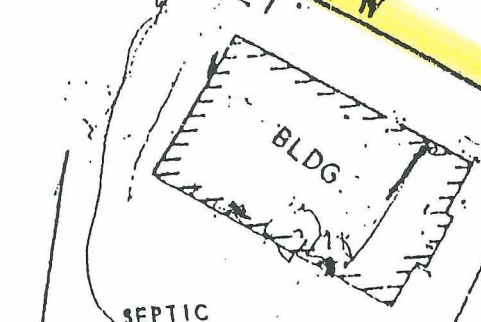

SEPTIC TANK

GRAVEL PARKING

ROADWAY

SIGN

TRACT "B"

R-2964.79'
L-483.01'
Δ-9° 20' 03"
CH-482.47'

CH BRG. - S 26° 07' 38" W

S.P.H.

N 89° 36' 14" W
100.01'

SIGN

BITUMINOUS

NO. 23

NO. 23



Handwritten notes at the bottom of the page, including the name 'S.P.H.' and other illegible scribbles.



REC'D BY
MMB
MAY 22 2003

