

RESOLUTION 2010-66

RESOLUTION APPROVING ANNEXATION OF CERTAIN "NON-DESIGNATED NEIGHBORHOODS" IN BELLE PRAIRIE TOWNSHIP IN ACCORDANCE WITH THE TERMS OF THAT ORDERLY ANNEXATION AGREEMENT, NO. OA-916, (NO. 10AE)

WHEREAS, in accordance with Minnesota Statutes 414.0325, the City of Little Falls ("City") and the Township of Belle Prairie ("Township") have signed an Orderly Annexation Agreement, No. OA-916, ("Agreement") on February 10, 2003, and February 3, 2003, respectively; and

WHEREAS, Paragraph 1.b, of said Agreement designates certain properties as the Belle Prairie Suburban Orderly Annexation Area ("Designated Area") for annexation; and

WHEREAS, Paragraph 3.e of said Agreement indicates the City has notified Minnesota Power Company on January 13, 2003, of our intent to annex said territory and requested notification if there is a change in the cost of electric utility service as a result of the annexation of the properties within the Designated Area. The only change anticipated is the addition of a monthly City franchise fee, since the following described properties are and will remain within the Minnesota Public Utilities Commission's Service Area of Minnesota Power; and

WHEREAS, Paragraph 4.c of said Agreement outlines provisions for annexation of "Non-Designated Neighborhoods" in said Designated Area, by City Council resolution, if a petition is received by the City from an individual property owner(s) requesting annexation; and

WHEREAS, Paragraph 4.g of said Agreement outlines provisions for annexation of the following properties by resolution of the City Council:

Lot 1, Block 2, Second Addition to Oak Park.

NOW, THEREFORE, BE IT RESOLVED, by the City Council of the City of Little Falls, in accordance with the provisions of said Agreement, that the following described properties are designated for immediate annexation to the City of Little Falls:

Lot 1, Block 2, Second Addition to Oak Park; and

BE IT FURTHER RESOLVED, that in accordance with Paragraph 3.d of said Agreement, the City shall share a one-time payment at 150% of the property taxes for said parcel(s) due and payable in the last year that the Township collected taxes, (i.e. 2010 property taxes \$131.59) for a total of \$197.39; and

BE IT FURTHER RESOLVED, that the current population in said property is two (2), with a total area of 0.70 acres more or less; and

BE IT FURTHER RESOLVED, that in accordance with Chapter 11.03, Subd. 6 of the City Code, a public hearing was held on the proposed zoning of said territory on June 30, 2003 and on August 18, 2003, and said property was zoned "One- and Two-Family Residential, Country Homes, 'R-1.C'" on August 18, 2003; and

BE IT FURTHER RESOLVED, that the City Administrator is directed to forward copies of this Resolution to the Office of Administrative Hearings, Belle Prairie Town Clerk, and the Morrison County Auditor, Assessor and Recorder; and

BE IT FURTHER RESOLVED, that in accordance with Paragraph 4.g, of said Agreement, the City of Little Falls agrees that no alteration of the stated boundaries as described herein is appropriate, that no consideration by the Office of Administrative Hearings, is necessary, and that all terms and conditions for annexation of the aforementioned properties are provided in that Orderly Annexation Agreement, OA-916. Pursuant to Minnesota Statutes, Section 414.0325, upon receipt of this Resolution, the Office of Administrative Hearings may review and comment, but shall within thirty (30) days order the annexation of the aforementioned properties in accordance with the terms and conditions contained in said Agreement.

Passed this 7th day of September, 2010.



Urban L. Otremba
Council President

ATTEST:

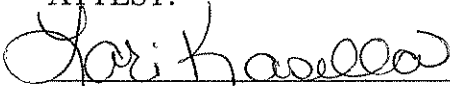

Lori Kasella
Acting City Administrator

Approved this 7th day of September, 2010.

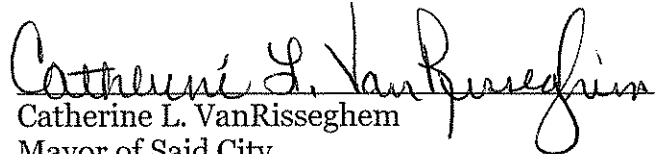

Catherine L. VanRisseghem
Mayor of Said City

(SEAL)

REC'D BY
MBA

SEP 15 2010

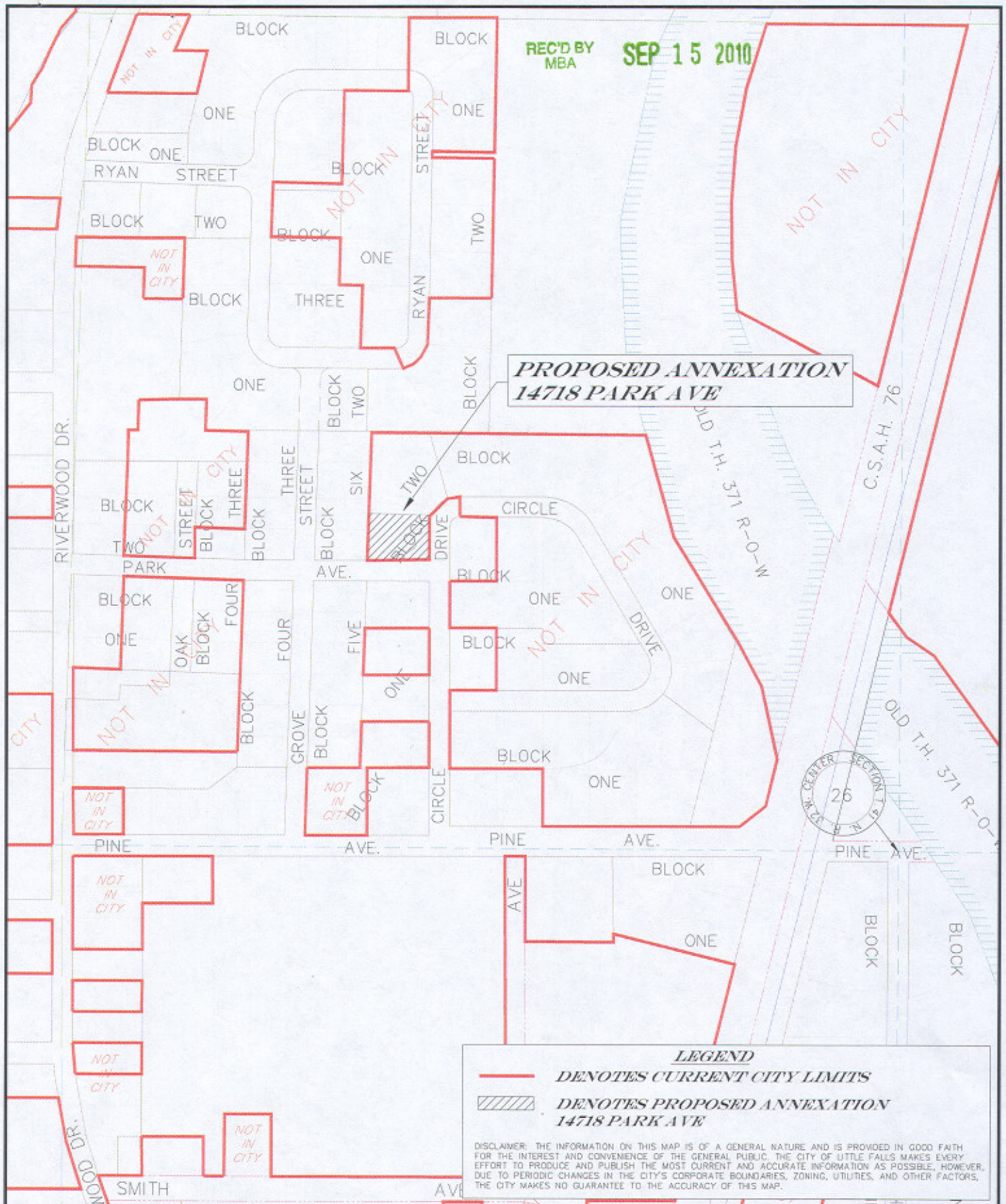

**PROPOSED ANNEXATION
14718 PARK AVE**

LEGEND

- DENOTES CURRENT CITY LIMITS
- DENOTES PROPOSED ANNEXATION 14718 PARK AVE

DISCLAIMER: THE INFORMATION ON THIS MAP IS OF A GENERAL NATURE AND IS PROVIDED IN GOOD FAITH FOR THE INTEREST AND CONVENIENCE OF THE GENERAL PUBLIC. THE CITY OF LITTLE FALLS MAKES EVERY EFFORT TO PRODUCE AND PUBLISH THE MOST CURRENT AND ACCURATE INFORMATION AS POSSIBLE, HOWEVER, DUE TO PERIODIC CHANGES IN THE CITY'S CORPORATE BOUNDARIES, ZONING, UTILITIES, AND OTHER FACTORS, THE CITY MAKES NO GUARANTEE TO THE ACCURACY OF THIS MAP.

SHEET NO.
1
OF
1

CITY OF LITTLE FALLS
LITTLE FALLS, MINNESOTA

JOB NUMBER:
SCALE: 1"=400'
DRAWN BY: B.D.R
CHECKED BY: D.H.S
PLOTTED: 8/30/2010 11:54 AM

