

RESOLUTION 2008-21

RESOLUTION APPROVING ANNEXATION OF CERTAIN "NON-DESIGNATED NEIGHBORHOODS" IN BELLE PRAIRIE TOWNSHIP IN ACCORDANCE WITH THE TERMS OF THAT ORDERLY ANNEXATION AGREEMENT, NO. OA-916, (NO. 08-X)

WHEREAS, in accordance with Minnesota Statutes 414.0325, the City of Little Falls ("City") and the Township of Belle Prairie ("Township") have signed an Orderly Annexation Agreement, No. OA-916, ("Agreement") on February 10, 2003, and February 3, 2003, respectively; and

WHEREAS, Paragraph 1.b, of said Agreement designates certain properties as the Belle Prairie Suburban Orderly Annexation Area ("Designated Area") for annexation; and

WHEREAS, Paragraph 3.e of said Agreement indicates the City has notified Minnesota Power Company on January 13, 2003, of our intent to annex said territory and requested notification if there is a change in the cost of electric utility service as a result of the annexation of the properties within the Designated Area. The only change anticipated is the addition of a monthly City franchise fee, since the following described properties are and will remain within the Minnesota Public Utilities Commission's Service Area of Minnesota Power; and

WHEREAS, Paragraph 4.c of said Agreement outlines provisions for annexation of "Non-Designated Neighborhoods" in said Designated Area, by City Council resolution, if a petition is received by the City from an individual property owner(s) requesting annexation; and

WHEREAS, Paragraph 4.g of said Agreement outlines provisions for annexation of the following properties by resolution of the City Council:

Attachment "A".

NOW, THEREFORE, BE IT RESOLVED, by the City Council of the City of Little Falls, in accordance with the provisions of said Agreement, that the following described properties are designated for immediate annexation to the City of Little Falls:

Attachment "A"; and

BE IT FURTHER RESOLVED, that in accordance with Paragraph 3.d of said Agreement, the City shall share a one-time payment at 150% of the property taxes for said parcel(s) due and payable in the last year that the Township collected taxes, (i.e. 2007 property taxes \$84.53 for a total of \$126.80); and

BE IT FURTHER RESOLVED, that the current population in said property is zero (0), with a total area of approximately 44.73 acres more or less; and

BE IT FURTHER RESOLVED, that in accordance with Chapter 11.03, Subd. 6 of the City Code, a public hearing was held on the proposed zoning of said territory on June 30, 2003, and on August 18, 2003, and said property was zoned "Planned Unit Development, One and Two Family Residential, PUD.R-1" on August 18, 2003; and

BE IT FURTHER RESOLVED, that the City Administrator is directed to forward copies of this Resolution to the Minnesota Department of Administration, Minnesota Secretary of State, Belle Prairie Town Clerk, and the Morrison County Auditor, Assessor and Recorder; and

BE IT FURTHER RESOLVED, that in accordance with Paragraph 4.g, of said Agreement, the City of Little Falls agrees that no alteration of the stated boundaries as described herein is appropriate, that no consideration by the Minnesota Department of Administration, is necessary, and that all terms and conditions for annexation of the aforementioned properties are provided in that Orderly Annexation Agreement, OA-916. Pursuant to Minnesota Statutes, Section 414.0325, upon receipt of this Resolution, the Minnesota Department of Administration may review and comment, but shall within thirty (30) days order the annexation of the aforementioned properties in accordance with the terms and conditions contained in said Agreement.

Passed this 4th day of February, 2008.

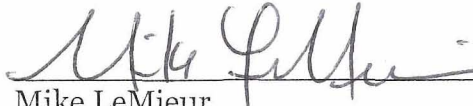
Mike LeMieur
Council President

ATTEST:

Garrison L. Hale
City Administrator

Approved this 4th day of February, 2008.

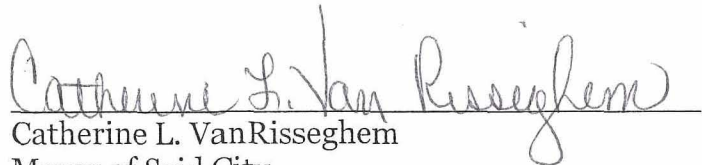

Catherine L. VanRisseghem
Mayor of Said City

(SEAL)

ATTACHMENT A

TRACT A: That part of Government Lot 1, part of the Southwest Quarter of the Northeast Quarter, and part of the Northwest Quarter of the Southeast Quarter, all in Section 23, Township 41, Range 32, Morrison County, Minnesota, described as follows: commencing at the southwest corner of said Northwest Quarter of the Southeast Quarter; thence North 00 degrees 15 minutes 37 seconds West, assumed bearing, 190.93 feet along the west line of said Northwest Quarter of the Southeast Quarter; thence South 61 degrees 34 minutes 24 seconds East 1.89 feet to the east line of Sunrise Addition, on file and of record in the Office of the County Recorder in said Morrison County; thence North 00 degrees 11 minutes 38 seconds West 812.50 feet along said east line of Sunrise Addition to the northeast corner of Lot 16, Block 2, said Sunrise Addition, the point of beginning; thence North 89 degrees 48 minutes 22 seconds East 240.35 feet; thence North 15 degrees 03 minutes 14 seconds East 605.60 feet; thence northeasterly along a tangential curve left having a central angle of 1 degree 09 minutes 00 seconds, a radius of 48526.67 feet, an arc length of 973.99 feet, and a chord bearing North 14 degrees 28 minutes 44 seconds East 973.98 feet; thence North 13 degrees 54 minutes 14 seconds East, tangent to said curve, 189.06 feet to the south line of Lot 1, Block Two, Edgewood First Addition, on file and of record in said Office of the County Recorder; thence South 89 degrees 28 minutes 17 seconds West 643.24 feet along said south line of Lot 1, Block Two, Edgewood First Addition and the south line of Block Two, Edgewood, on file and of record in said Office of the County Recorder, and the south line of those tracts of land described in Document Numbers 330011 and 296340, to the northeast corner of that tract of land described in Document Number 339689; thence South 48 degrees 40 minutes 09 seconds West 71.05 feet along the west line of said tract of land described in Document Number 339689 to the southeast corner thereof; thence South 00 degrees 00 minutes 11 seconds West 32.92 feet to the northwest corner of said Southwest Quarter of the Northeast Quarter; thence South 00 degrees 15 minutes 37 seconds East 658.44 feet along the west line of said Southwest Quarter of the Northeast Quarter to its intersection with the north line of said Sunrise Addition; thence North 89 degrees 59 minutes 37 seconds East 3.72 feet along said north line of Sunrise Addition to the northeast corner of Lot 17, Block 1, said Sunrise Addition; thence South 00 degrees 11 minutes 38 seconds East 1538.82 feet along the east line of said Sunrise Addition to the point of beginning. TRACT B: that part of Government Lot 1, part of the Southwest Quarter of the Northeast Quarter, and part of the Northwest Quarter of the Southeast Quarter, all in Section 23, Township 41, Range 32, Morrison County, Minnesota, described as follows: commencing at the southwest corner of said Northwest Quarter of the Southeast Quarter; thence North 00 degrees 15 minutes 37 seconds West, assumed bearing, 190.93 feet along the west line of said Northwest Quarter of the Southeast Quarter; thence South 61 degrees 34 minutes 24 seconds East 1.89 feet to the east line of Sunrise Addition, on file and of record in the Office of the County Recorder in said Morrison County, the point of beginning; thence North 00 degrees 11 minutes 38 seconds West 812.50 feet along said east line of Sunrise Addition to the northeast corner of Lot 16, Block 2, said Sunrise Addition; thence North 89 degrees 48 minutes 22 seconds East 240.35 feet; thence North 15 degrees 03 minutes 14 seconds East 605.60 feet; thence northeasterly along a tangential curve left having a central angle of 1 degree 09 minutes 00 seconds, a radius of 48526.67 feet, an arc length of 973.99 feet, and a chord bearing North 14 degrees 28 minutes 44 seconds East 973.98 feet; thence North 13 degrees 54 minutes 14 seconds East, tangent to said curve, 189.06 feet to the south line of Lot 1, Block Two, Edgewood First Addition, on file and of record in said Office of the County Recorder; thence North 89 degrees 28 minutes 17 seconds East 413.03 feet along said south line of Lot 1, Block Two, Edgewood First Addition and its extension easterly to the west line of County Road No. 76 (formerly Highway 371); thence South 13 degrees 54 minutes 14 seconds West 292.00 feet along said west line of County Road No. 76;

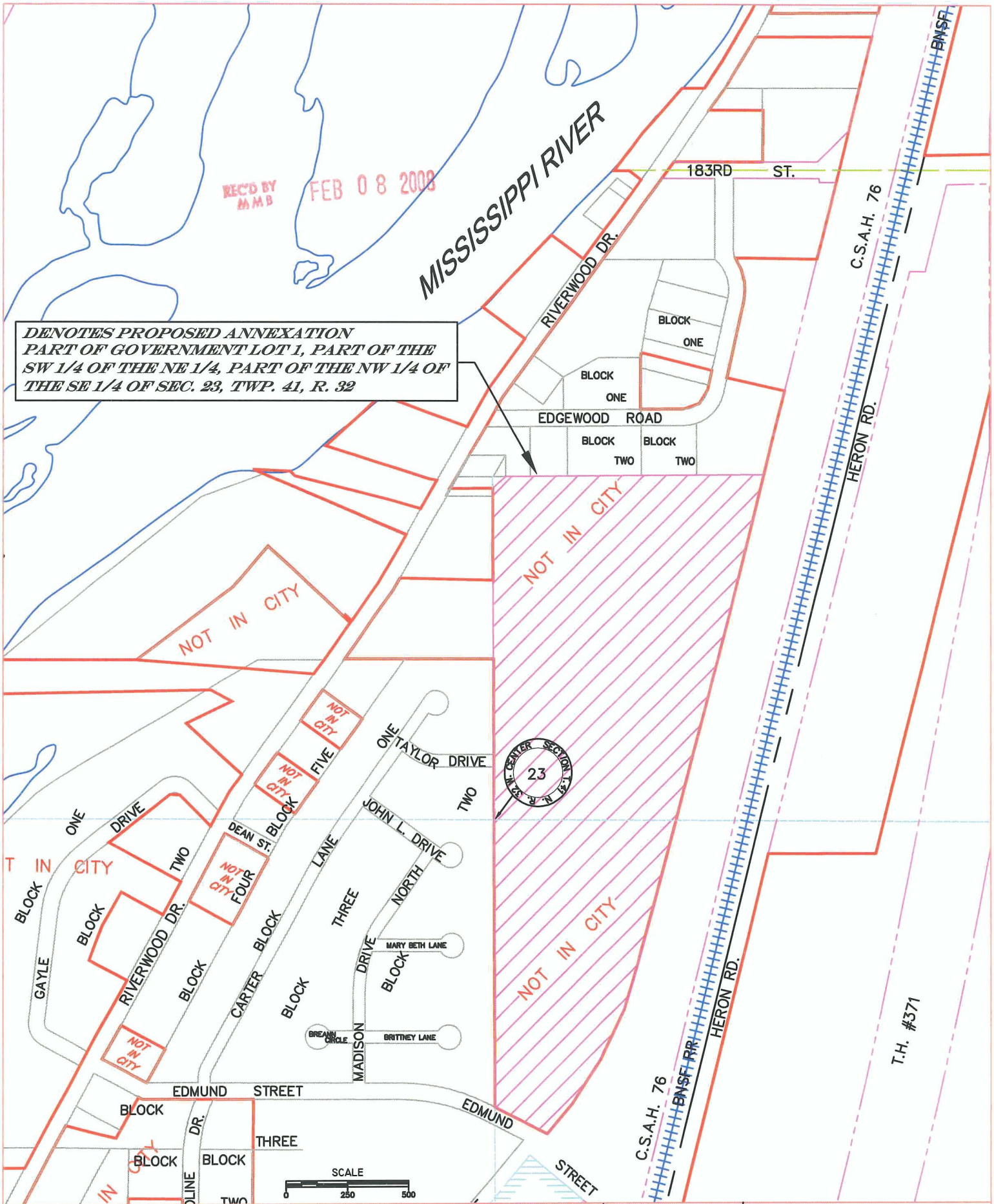
thence southwesterly along said west line of County Road No. 76, along a tangential curve right, having a central angle of 1 degree 09 minutes 00 seconds, a radius of 48926.67 feet, an arc length of 982.02 feet, and a chord bearing South 14 degree 28 minutes 44 seconds West 982.00 feet; thence South 15 degrees 03 minutes 14 seconds West, tangent to said curve, 761.37 feet along said west line of County Road No. 76; thence southwesterly along said west line of County Road No. 76, along a tangential curve right, having a central angle of 24 degrees 51 minutes 58 seconds, a radius of 1724.62 feet, an arc length of 748.48 feet, and a chord bearing South 27 degree 29 minutes 13 seconds West 742.62 feet; thence South 39 degrees 55 minutes 12 seconds West, tangent to said curve, 27.35 feet along said west line of County Road No. 76 to it's intersection with a line bearing South 61 degrees 34 minutes 24 seconds East from the point of beginning; thence North 61 degrees 34 minutes 24 seconds West 253.70 feet to the point of beginning.



DENOTES PROPOSED ANNEXATION
PART OF GOVERNMENT LOT 1, PART OF THE
SW 1/4 OF THE NE 1/4, PART OF THE NW 1/4 OF
THE SE 1/4 OF SEC. 23, TWP. 41, R. 32

SHEET NO.
1
OF
1

CITY OF LITTLE FALLS
LITTLE FALLS, MINNESOTA
PROPOSED ANNEXATION

JOB NUMBER: N/A
SCALE: 1"=500'
DRAWN BY: B.D.R.
CHECKED BY: D.H.S.
PLOTTED: 2/5/2008 2:58 PM

