

REC'D BY
MAB SEP 05 2002

RESOLUTION 2002-8

A JOINT RESOLUTION BETWEEN THE CITY OF STEWARTVILLE AND HIGH FOREST TOWNSHIP EXTENDING THE CORPORATE LIMITS OF THE CITY OF STEWARTVILLE (Schumann)

Whereas, a Petition requesting annexation of the territory hereinafter described was duly presented to the City Council of Stewartville the 3rd day of September, 2002 and

Whereas, a quantity of land embraced within the area described in the Petition and bounded as described is 78.74 acres more or less, and no part of which is included within the limits of an incorporated City; and

Whereas, the land is not in the Flood Plain – mapping #27109C0000, Effective date: April 17, 1995.

Whereas, the land will continue to be serviced by the current electric company;

Whereas, the Petition was signed by the owners of the property and the Township Board has waived the 10 day notice period and the 90 review process,

Now Therefore Be It Resolved That:

1. That the annexation will be to the best interest of the City of Stewartville and the territory affected,

2. That the territory described herein abuts upon the City limits and is about to become urban or suburban in character;
3. That none of said territory is now included within the limits of the City.
4. The area is included in Exhibit C of the Orderly Annexation Agreement between the City of Stewartville and High Forest Township;
5. No written objections were received.

6. Minnesota Planning may review and comment, but shall, within thirty (30) days, order annexation in accordance with the terms and conditions of this Agreement.

Section 2:

Territory Annexed:

The corporate limits of the City are hereby extended to include the unplatted land described above and the same is hereby annexed to and included within the City as effectually as if it had originally been a part of thereof;

See Attachement A & B

Section 3:

Filing: The City Clerk is hereby directed to file certified copies of the Resolution with the Minnesota Municipal Commission, the Secretary of State, the Township Clerk and County Auditor.

Section 4:

Effective Date: This Resolution takes effect upon its passage and publication and the filing of the certified copies as directed in Section 3, and approval from the Minnesota Municipal Commission.

Adopted by the High Forest Township Board, this 3rd day of September, 2002.

Adopted by the City Council of Stewartville, this 4th day of September, 2002.

High Forest Township Board Chair

Rich Bault

Attest:

William J. Coyle

Clerk

City of Stewartville

Chris Gray

Mayor

Attest:

T. J. Wilkins

City Administrator

**SCHUMANN ANNEXATION
(T.H. 63 RIGHT OF WAY)**

That part of the Southeast Quarter of the Southwest Quarter of Section 22 and the Northeast Quarter of the Northwest Quarter of Section 27, all in Township 105 North, Range 14 West, Olmsted County, Minnesota, described as follows:

Beginning at the southeast corner of said Southwest Quarter of Section 22; thence northerly on a Minnesota State Plane Grid Azimuth from north of 359 degrees 51 minutes 08 seconds along the east line of said Southwest Quarter 1316.89 feet to the north line of said Southeast Quarter of the Southwest Quarter of Section 22; thence westerly 269 degrees 47 minutes 45 seconds azimuth along said north line 68.95 feet to the westerly right-of-way line of Trunk Highway No. 63; thence southerly 228.86 feet along said westerly right-of-way line on a nontangential curve concave easterly, having a radius of 17330.81 feet, a central angle of 00 degrees 45 minutes 24 seconds, and a chord azimuth of 180 degrees 11 minutes 04 seconds; thence southerly 179 degrees 48 minutes 27 seconds azimuth along said westerly right-of-way line 1087.90 feet to the southerly line of said Southwest Quarter of Section 22; thence continue southerly 179 degrees 48 minutes 27 seconds azimuth along said westerly right-of-way line 1323.51 feet to the south line of said Northeast Quarter of the Northwest Quarter of Section 27; thence easterly 89 degrees 52 minutes 04 seconds azimuth along said south line 77.16 feet to the east line of said Northwest Quarter of Section 27; thence northerly 359 degrees 28 minutes 22 seconds azimuth along said east line 1323.49 feet to the point of beginning.

Said tract contains 4.34 acres more or less.

**SCHUMANN ANNEXATION
(S1/2, SW1/4)**

All of the South Half of the Southwest Quarter of Section 22, Township 105 North, Range 14 West, Olmsted County, Minnesota, lying west of the west right of way line of Trunk Highway 63, except that part of the south 450 feet of the north 1050 feet of the east 400 feet of said South Half, lying west of the right of way of Trunk Highway 63, and except the north 30 feet of the east 469 feet of said South Half.

Containing 74.4 acres more or less.

REC'D BY
MMB
SEP 05 2002

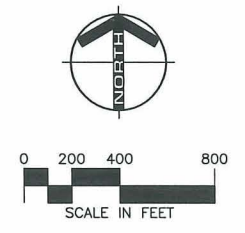
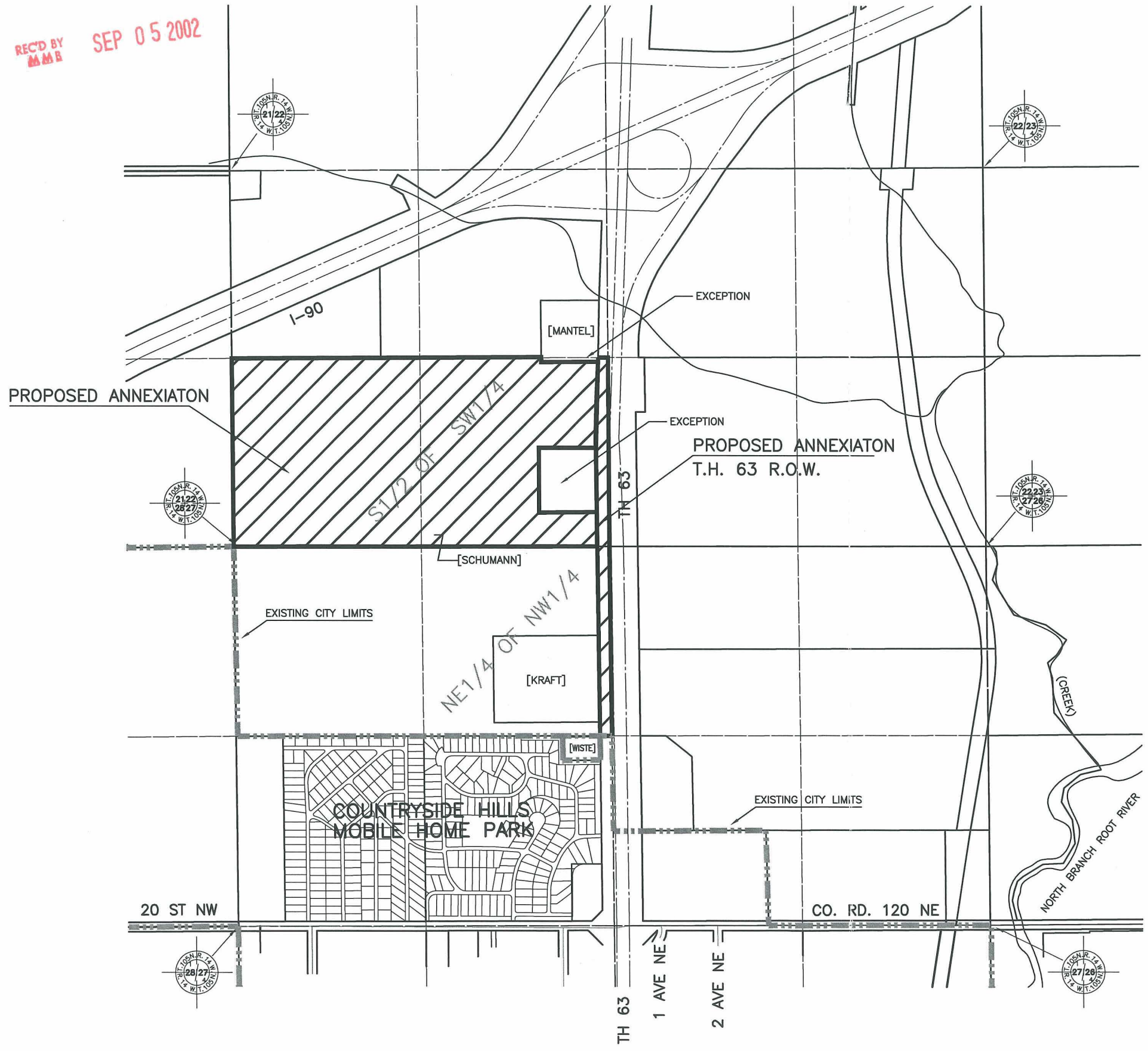

YAGGY COLBY ASSOCIATES
 ENGINEERS • ARCHITECTS
 SURVEYORS • PLANNERS
 LANDSCAPE ARCHITECTS
 717 THIRD AVENUE SOUTHEAST
 ROCHESTER, MINNESOTA 55904
 507-288-6464
 507-288-5058
 FAX 507-288-5058
 EMAIL INFO@YAGGY.COM

SCHUMANN ANNEXATION
 CITY OF STEWARTVILLE, MN
 OVERVIEW

PROJECT NUMBER	7235
COMPUTER FILE	7235ANNEX03.DWG
DATE	9/4/02
DRAWN BY	MWE
CHECKED BY	
REVISIONS	
SHEET NUMBER	