

# Joint Resolution of Mantorville Township and the City of Kasson, MN # 8.3-03

## RESOLUTION ACCEPTING ALLAN R. RADEL'S PETITION FOR ANNEXATION, AND ORDERING SAID ANNEXATION PURSUANT TO THE TERMS OF THE ORDERLY ANNEXATION AGREEMENT BETWEEN MANTORVILLE TOWNSHIP AND THE CITY OF KASSON

**BE IT RESOLVED BY THE CITY COUNCIL OF KASSON, MINNESOTA AND THE TOWNSHIP OF MANTORVILLE, MN** as follows:

1. That the owner(s) of the area being petitioned for annexation is Allan R. Radel, and the land is described as that of unplatted property which is less than 200 acres containing approximately 32.22 acres more or less, of which its SW boundary abuts a portion of the City of Kasson corporate limits and is within the designated Orderly Annexation Area, pursuant to Minnesota State Statute § 414.0325.

The description of the property is as follows: Attached

2. Request for annexation to the City of Kasson and detachment from Mantorville Township is for the purpose of platting and extending utility lines for future residential development. Mantorville Township is unable to provide necessary services such as sanitary sewer, storm sewer, water and adequate police services and facilities.
3. No consideration by the Director of Strategic and Long Range Planning is necessary, although the Director may review and comment. However, within 30 days the Director shall order their annexation in accordance with the terms of said Orderly Annexation Agreement and joint resolution.

**BE IT FURTHER RESOLVED** that the City Council of the City of Kasson, Minnesota, accepts the petition for annexation as presented and hereby authorizes the City Administrator to file a copy of same with the Township Clerk and the Secretary of State.

**BE IT FURTHER RESOLVED** that the Township of Mantorville does not object to, nor will contest, the annexation of said lands into the Kasson corporate limits.

Passed and adopted this 8 day of Sept, 2003.

  
\_\_\_\_\_  
Chair, Township of Mantorville

  
\_\_\_\_\_  
Mayor, City of Kasson, MN

ATTEST:

  
\_\_\_\_\_  
Town Board Clerk

ATTEST:

  
\_\_\_\_\_  
City Administrator

The motion for the adoption of the foregoing resolution was made by Council Member Fitch and duly seconded by Council Member Tjosaas. Upon a vote being taken, the following members voted in favor thereof: Burton, Fitch, Fjerstad, Tjosaas, Worden.

That part of the Northwest Quarter of Section 28, Township 107 North, Range 16 West, Dodge County, Minnesota, described as follows:

Commencing at the southwest corner of said Northwest Quarter; thence South 89 degrees 54minutes 39 seconds East (NOTE: All bearings in relation to Dodge County Coordinate system, NAD 83, 1996 adjustment) along the south line of said Northwest Quarter for a distance of 1591.77 feet to the POINT OF BEGINNING; thence North 00 degrees 04 minutes 40 seconds East for a distance of 1756.87 feet to the north line of the South Two-Thirds of said Northwest Quarter; thence South 89 degrees 54 minutes 39 seconds along said North line for a distance of 809.18 feet to the northwest corner of KASSON MANTORVILLE HEIGHTS SUBDIVISION; thence South 00 degrees 15minutes 09 seconds West along the west line of said KASSON MANTORVILLE HEIGHTS SUBDIVISION for a distance of 1235.88 feet plat to the northwest corner of Lot 5 Block 1 of said KASSON MANTORVILLE HEIGHTS SUBDIVISION; thence North 89 degrees 44 minutes 51 seconds West for a distance of 70.00 feet; thence South 00 degrees 15 minutes 09 seconds West for a distance of 188.00 feet; thence South 89 degrees 44 minutes 51 seconds East for a distance of 70.00 feet to the southwest corner of Lot 4 Block 1 said KASSON MANTORVILLE HEIGHTS SUBDIVISION; thence South 00 degrees 15 minutes 09 seconds West for a distance of 333.00 feet along the west line of said KASSON MANTORVILLE HEIGHTS SUBDIVISION to the south line of said Northwest Quarter of Section 28; thence North 89 degrees 54minutes 39 seconds West along said south line to the POINT OF BEGINNING.

Said Parcel contains 32.22 acres more or less.

Said Parcel is subject to any easements or encumbrances of record.

1758



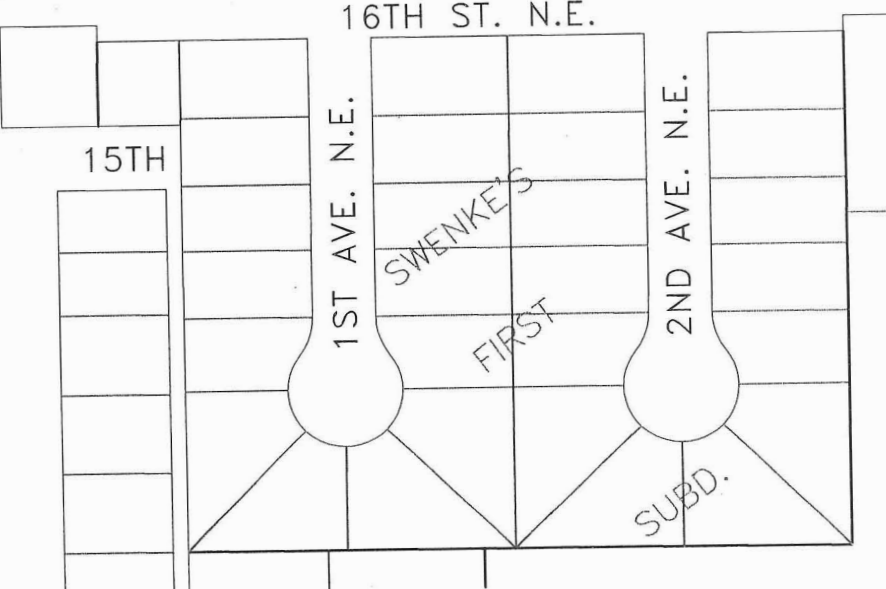
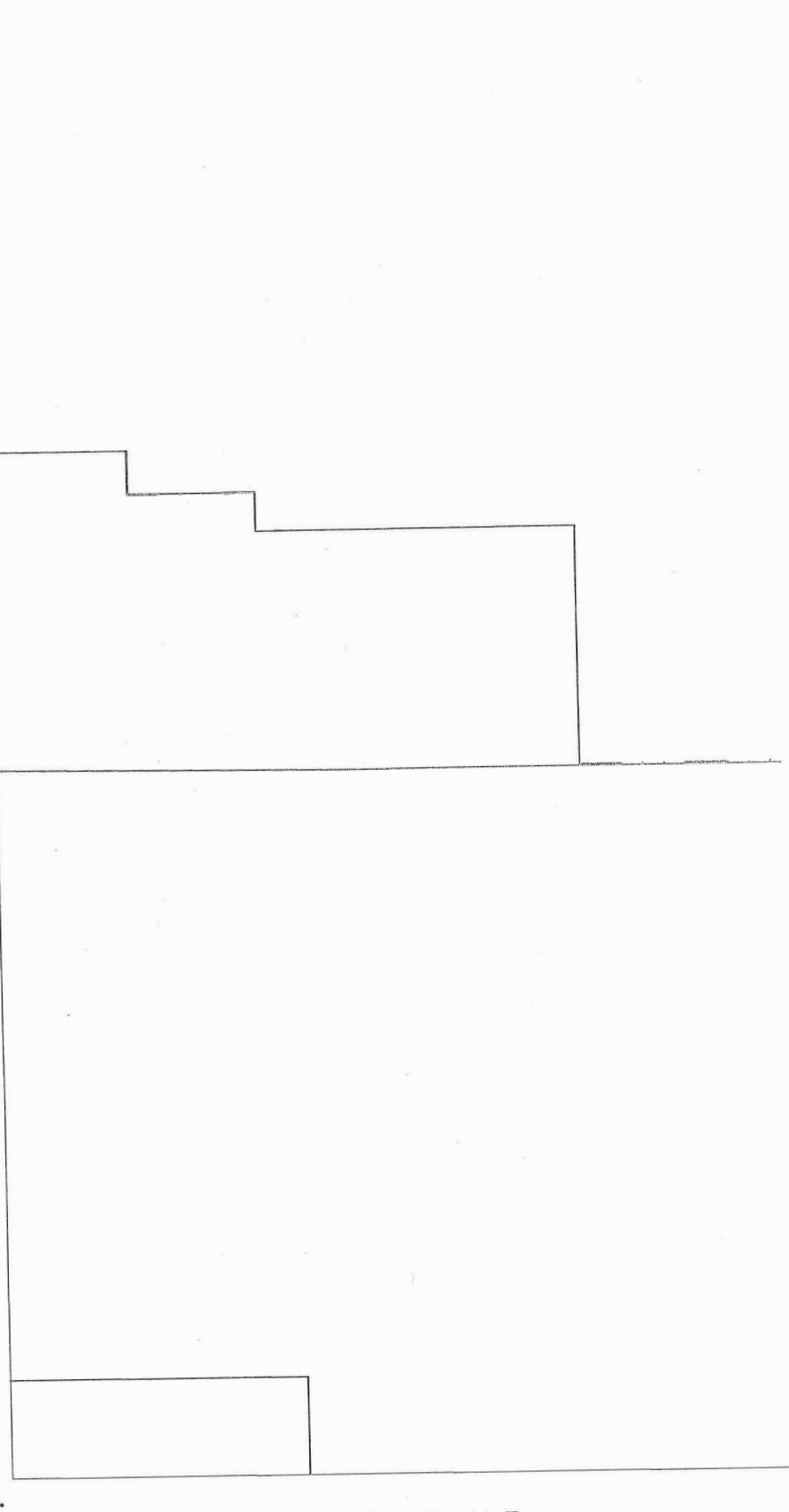
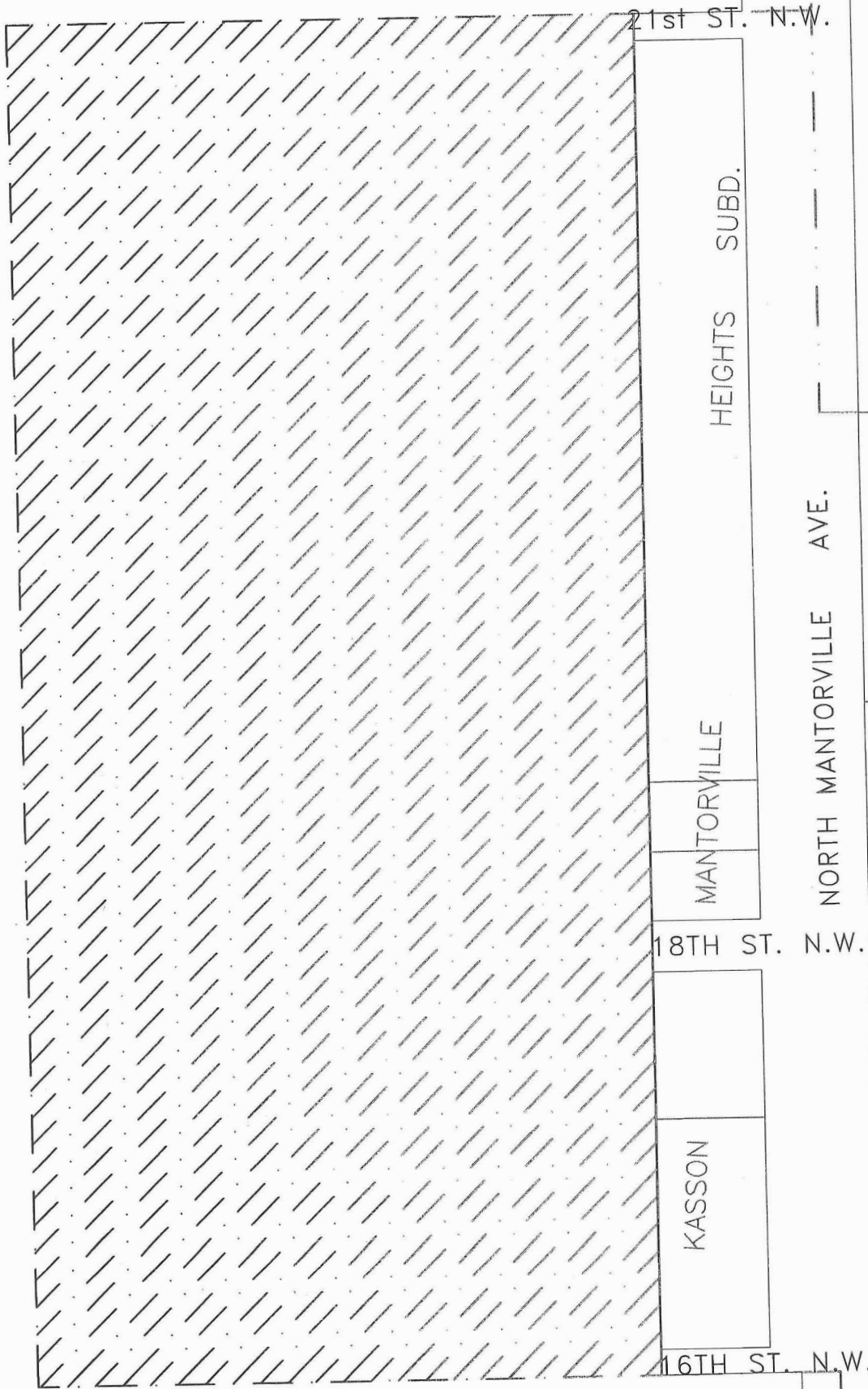

REC'D BY  
MIM B  
SEP 22 2003

# CITY OF KASSON

REC'D BY  
M M B SEP 22 2003

*Range Annex*

