

REC'D BY
MMB

OCT 22 2001

IN THE MATTER OF THE JOINT
RESOLUTION OF THE TOWN OF
HARTFORD AND THE CITY OF
BROWERVILLE DESIGNATING AN
UNINCORPORATED AREA AS IN
NEED OF ORDERLY ANNEXATION
AND CONFERRING JURISDICTION
OVER SAID AREA TO THE MINNE-
SOTA MUNICIPAL BOARD PURSUANT
TO M. S. 414.0325

JOINT RESOLUTION
FOR ORDERLY ANNEXATION

The Township of Hartford and the City of Browerville hereby jointly agree to the following:

1. That the following described area in Hartford Township is subject to orderly annexation pursuant to Minnesota Statutes 414.0325, and the parties hereto designate this area for orderly annexation, to wit:

The East 70 rods of the Northwest Quarter of the Northwest Quarter (NW 1/4 NW 1/4), Section Nine (9), Township One Hundred Thirty (130) North, Range Thirty-three (33) West of the Fifth P.M., according to the United States Government Survey thereof, EXCEPT the South ten (10) acres of the said East 70 rods of Section 9, Township 130 North, Range 33 of the NW 1/4 of the NW 1/4, and EXCEPT the following: Commencing at the Northeast corner of the South 10 acres of the East 70 rods of the NW 1/4 NW 1/4 of Sect. 9, Township 130, Range 33; thence West parallel with the South line of said NW 1/4 NW 1/4 and along the North line of said South 10 acres of the said East 70 rods, a distance of 20 rods; thence North parallel with the East line of said NW 1/4 NW 1/4 a distance of 16 rods; thence East parallel with the North line of said South 10 acres of the said East 70 rods a distance of 20 rods to the East line of said NW 1/4 NW 1/4; thence South and along the East line of said NW 1/4 NW 1/4 a distance of 16 rods to the place of beginning.

2. Upon annexation, the zoning shall be agricultural (A-O).

3. Both the Town of Hartford and the City of Browerville agree that no alteration of the stated boundaries of this agreement is appropriate. Furthermore, each party agrees that no consideration by the Board is necessary. Upon receipt of this resolution, passed and adopted by each party, the Board may review and comment, but shall, within thirty (30) days, order the annexation in accordance with the terms of this joint resolution.

REC'D BY
MAM

OCT 22 2001

Approved by the Town of Hartford this 1st day of Oct 2001
2001.

Town of Hartford

By: Eugene Seefeld
Town Board Chair

By: Arthur Blawie

Town Board Clerk

Approved by the City of Browerville this 11 day of October
2001.

City of Browerville

By: Walt Lucas
Mayor

(SEAL)

ATTEST:

Severin F. Blawie
City Administrator

REC'D BY
M M B
OCT 22 2001

*Annexed by
Joint Resolution 11 Oct 01*

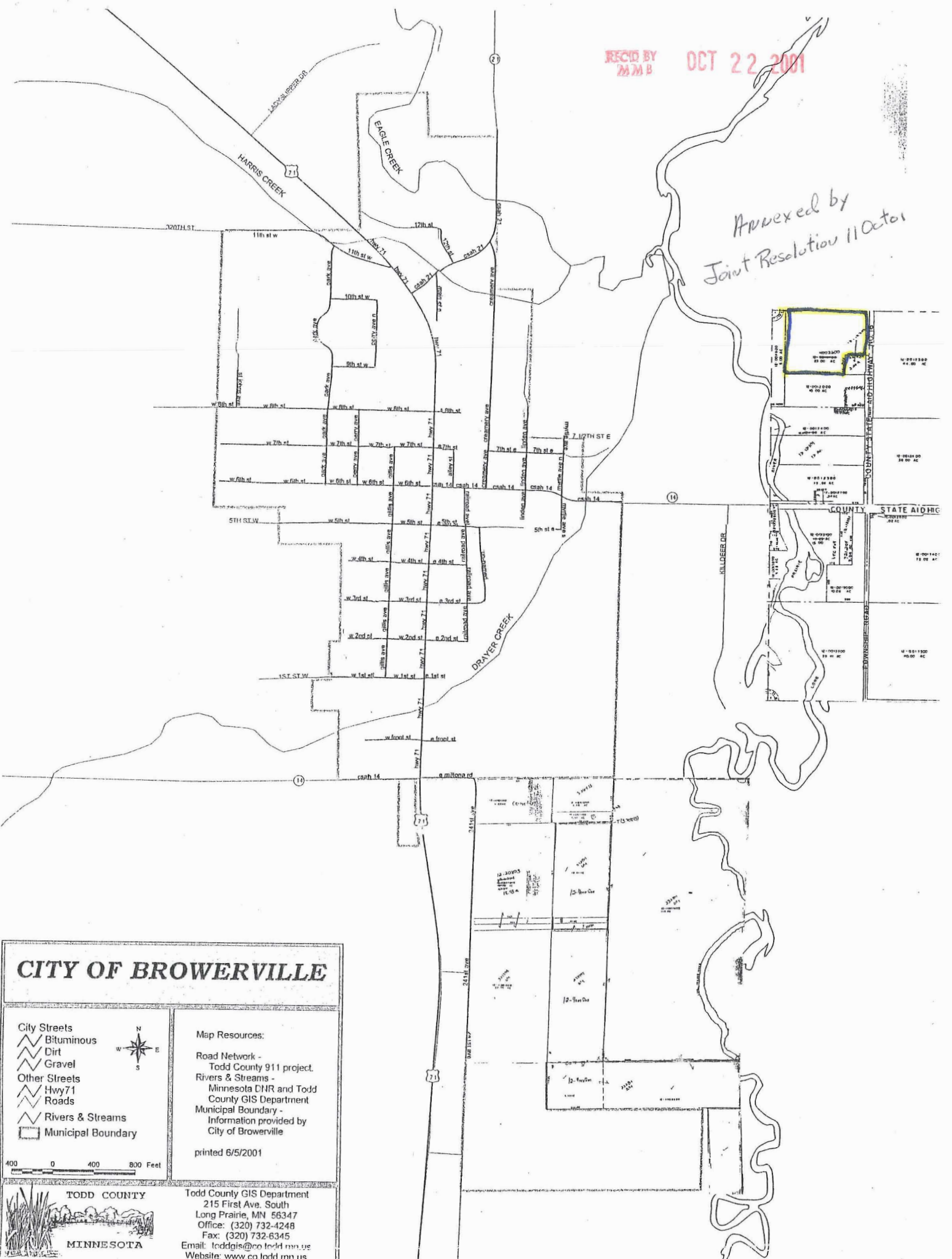

CITY OF BROWERVILLE

- City Streets
 - Bituminous
 - Dirt
 - Gravel
- Other Streets
 - Hwy 71
 - Roads
- Rivers & Streams
- Municipal Boundary



Map Resources:
 Road Network -
 Todd County 911 project.
 Rivers & Streams -
 Minnesota DNR and Todd
 County GIS Department
 Municipal Boundary -
 Information provided by
 City of Browerville

printed 6/5/2001

400 0 400 800 Feet

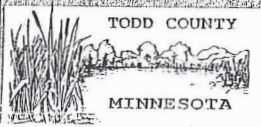

TODD COUNTY
 Todd County GIS Department
 215 First Ave. South
 Long Prairie, MN 56347
 Office: (320) 732-4248
 Fax: (320) 732-6345
 Email: toddgis@co.todd.mn.us
 Website: www.co.todd.mn.us