

JOINT RESOLUTION OF THE CITY OF FULDA AND OF THE TOWN OF BONDIN,
COUNTY OF MURRAY, STATE OF MINNESOTA, DESIGNATING CERTAIN
TERRITORY SITUATED WITHIN SAID TOWN AS IN NEED OF ORDERLY
ANNEXATION AND REQUESTING IMMEDIATE ANNEXATION THEREOF.

WHEREAS, it is anticipated by the Town of Bondin and the City of Fulda that the following described territory:

SEE ATTACHED EXHIBITS

having a population of approximately 40 persons living in single-family dwellings and will ultimately become or has become urban or suburban in nature ; and

WHEREAS, an orderly annexation will best provide for anticipated growth and municipal service needs of the whole community, including the city and the township; and

WHEREAS, the owners of a majority of the property affected have indicated to both the city and the town that they are in favor of an orderly annexation and are in need of the services to be provided thereunder; and

WHEREAS, the City of Fulda owns and operates the only central sanitary sewage collection and treatment system in the area herein under consideration and the city's facilities have the capacity to serve the territory proposed for immediate annexation and it is feasible to make the necessary extensions; and

WHEREAS, the City of Fulda owns and operates the only central water system in the area herein under consideration and its system has capacity to provide service to the territory proposed for immediate annexation and it is feasible to make the necessary extensions;

WHEREAS, the City of Fulda has demonstrated its willingness to proceed with a program to make such extensions and provide services to the territory proposed for immediate annexation; and

WHEREAS, the City of Fulda Fire Department serves the territory proposed for immediate annexation; and

WHEREAS, in addition to those services already described, the City of Fulda provides a full range of municipal services, including police protection, street maintenance, street lighting, and garbage collection and disposal and the benefits of these services would be extended to the territory proposed for immediate annexation immediately upon such annexation and the City of Fulda has demonstrated its willingness to proceed with a program to provide such services to the territory immediately upon such annexation;

NOW, THEREFORE, IT IS RESOLVED AS FOLLOWS:

1. That the Town Bondin and the City of Fulda hereby designate the attached described territory to be in need of immediate orderly annexation pursuant to and in accordance with Minnesota

Statutes § 414.0325.

2. That upon annexation the City of Fulda agrees to provide all services to citizens of the designated area that it provides to its current citizens.
3. That upon annexation the City of Fulda agrees to provide maintenance of the roadway, commonly known as South Lafayette Avenue, through the territory proposed for immediate annexation as indicated on the attached map and to further provide maintenance of said roadway south of the existing Mailander property to the boat landing.
4. That upon annexation the City of Fulda agrees to install the culvert that was planned and that the Town of Bondin had intended to install.
5. That upon annexation both the City of Fulda and the Town of Bondin agree to adopt whatever regulations and further resolutions deemed necessary to give full effect to the terms of this joint resolution.
6. That should a dispute arise as a result of the interpretation of terms contained in this joint resolution, such dispute shall first be attempted to be resolved by negotiation between the City of Fulda and the Town of Bondin and should such fail, the matter shall then be subject to mediation by a mediator jointly agreed upon.
7. That in providing for annexation of the designated area, no consideration by Minnesota Planning is necessary and no alteration of the agreed-upon boundaries is appropriate and all conditions for annexation have been stated in this joint resolution and that Minnesota Planning may review and comment, but shall, within 30 days of receipt of this joint resolution, order the annexation.
8. That the interpretation of this joint resolution shall be governed by the laws of the State of Minnesota.
9. That in the event one or more terms of this agreement shall be found invalid or unenforceable, the remainder of the agreement terms shall continue in full force and effect.

TOWN OF BONDIN

Charles R Friese

Chairman

The undersigned, clerk of the Town of Bondin, states that he is the custodian of the records of said town and that the above is a true and correct copy of the joint resolution adopted by the Board of Supervisors of said town on the 23 day of April, 2001.

REC'D BY
M M B

JUN 21 2001

Donna Clarke
Clerk

CITY OF FULDA

John A. Martin
Mayor

The undersigned, clerk of the City of Fulda, states that she is the custodian of the records of said City and that the above is a true and correct copy of a joint resolution adopted by the Council of said City on the 23rd day of April, 2001.

Michelle Baumgardner
Clerk

Perry Zieske - R.L.S.



RECTD BY
M M B JUN 21 2001

225 - 9th St.
P.O. Box 94
Windom, MN 56101

Phone & Fax: (507) 831-0100
1-800-278-0104

ANNEXATION DESCRIPTION

PART OF THE NORTHEAST QUARTER OF SECTION 35, TOWNSHIP 105 NORTH, RANGE 40 WEST AND PART OF GOVERNMENT LOT 1 IN SECTION 36, TOWNSHIP 105 NORTH, RANGE 40 WEST, ALL IN MURRAY COUNTY, MINNESOTA, DESCRIBED AS FOLLOWS:

BEGINNING AT AN EXISTING IRON MONUMENT AT THE NORTHEAST CORNER OF SECTION 35; THENCE SOUTH 89 DEGREES 34 MINUTES 33 SECONDS WEST, BEARINGS BASED ON PLAT OF HABERMAN'S FIRST ADDITION, ALONG THE NORTH LINE OF THE NORTHEAST QUARTER OF SAID SECTION 35 AND NORTH LINE OF SAID HABERMAN'S FIRST ADDITION, A DISTANCE OF 233.01 FEET; THENCE SOUTH 00 DEGREES 41 MINUTES 51 SECONDS WEST, PARALLEL WITH THE EAST LINE OF THE NORTHEAST QUARTER OF SAID SECTION 35 AND ALONG THE WEST LINE OF SAID HABERMAN'S FIRST ADDITION, AND EXTENSION THEREOF, A DISTANCE OF 1514.54 FEET; THENCE SOUTH 89 DEGREES 34 MINUTES 33 SECONDS WEST, PARALLEL WITH THE NORTH LINE OF THE NORTHEAST QUARTER OF SAID SECTION 35, A DISTANCE OF 203.00 FEET; THENCE SOUTH 00 DEGREES 41 MINUTES 51 SECONDS WEST, PARALLEL WITH THE EAST LINE OF THE NORTHEAST QUARTER OF SAID SECTION 35, A DISTANCE OF 465.00 FEET, TO A POINT ON THE SOUTH LINE OF THE NORTH HALF OF THE SOUTHEAST QUARTER OF THE NORTHEAST QUARTER OF SAID SECTION 35; THENCE NORTH 89 DEGREES 34 MINUTES 33 SECONDS EAST, PARALLEL WITH THE NORTH LINE OF SAID NORTHEAST QUARTER AND ALONG THE SOUTH LINE OF THE NORTH HALF OF THE SOUTHEAST QUARTER OF THE NORTHEAST QUARTER OF SAID SECTION 35, A DISTANCE OF 436.00 FEET, TO THE EAST LINE OF SAID NORTHEAST QUARTER; THENCE SOUTH 00 DEGREES 41 MINUTES 51 SECONDS WEST, ALONG THE WEST LINE OF SECTION 36 AND ALONG THE WEST LINE OF GOVERNMENT LOT 1 IN SAID SECTION 36, A DISTANCE OF 661.46 FEET, TO THE SOUTHWEST CORNER OF GOVERNMENT LOT 1; THENCE NORTH 32 DEGREES 59 MINUTES 36 SECONDS EAST, ALONG THE SHORELINE OF FULDA FIRST LAKE, A DISTANCE OF 313.50 FEET; THENCE NORTH 17 DEGREES 37 MINUTES 48 SECONDS EAST, ALONG SAID SHORELINE, A DISTANCE OF 235.20 FEET; THENCE NORTH 04 DEGREES 44 MINUTES 07 SECONDS EAST, ALONG SAID SHORELINE, A DISTANCE OF 170.42 FEET; THENCE NORTH 12 DEGREES 47 MINUTES 54 SECONDS WEST, ALONG SAID SHORELINE, A DISTANCE OF 102.84 FEET; THENCE NORTH 05 DEGREES 15 MINUTES 35 SECONDS WEST, ALONG SAID SHORELINE, A DISTANCE OF 231.25 FEET; THENCE NORTH 04 DEGREES 07 MINUTES 52 SECONDS EAST, ALONG SAID SHORELINE, A DISTANCE OF 100.18 FEET; THENCE NORTH 06 DEGREES 24 MINUTES 29 SECONDS EAST, ALONG SAID SHORELINE, A DISTANCE OF 100.50 FEET; THENCE NORTH 14 DEGREES 11 MINUTES 36 SECONDS EAST, ALONG SAID SHORELINE, A DISTANCE OF 102.84 FEET; THENCE NORTH 08 DEGREES 36 MINUTES 17 SECONDS EAST, ALONG SAID SHORELINE, A DISTANCE OF 181.73 FEET; THENCE NORTH 40 DEGREES 15 MINUTES 26 SECONDS EAST, ALONG SAID SHORELINE, A DISTANCE OF 149.16 FEET; THENCE NORTH 89 DEGREES 18 MINUTES 09 SECONDS WEST A DISTANCE OF 103.00 FEET; THENCE NORTH 00 DEGREES 41 MINUTE 51 SECONDS EAST A DISTANCE OF 153.00 FEET, TO A POINT ON THE NORTH LINE OF GOVERNMENT LOT 1 IN SAID SECTION 36; THENCE NORTH 89 DEGREES 18 MINUTES 09 SECONDS WEST, ALONG THE NORTH LINE OF SAID GOVERNMENT LOT 1, A DISTANCE OF 415.00 FEET, TO THE POINT OF BEGINNING, CONTAINING 36.4 ACRES.

Fulda Lake West

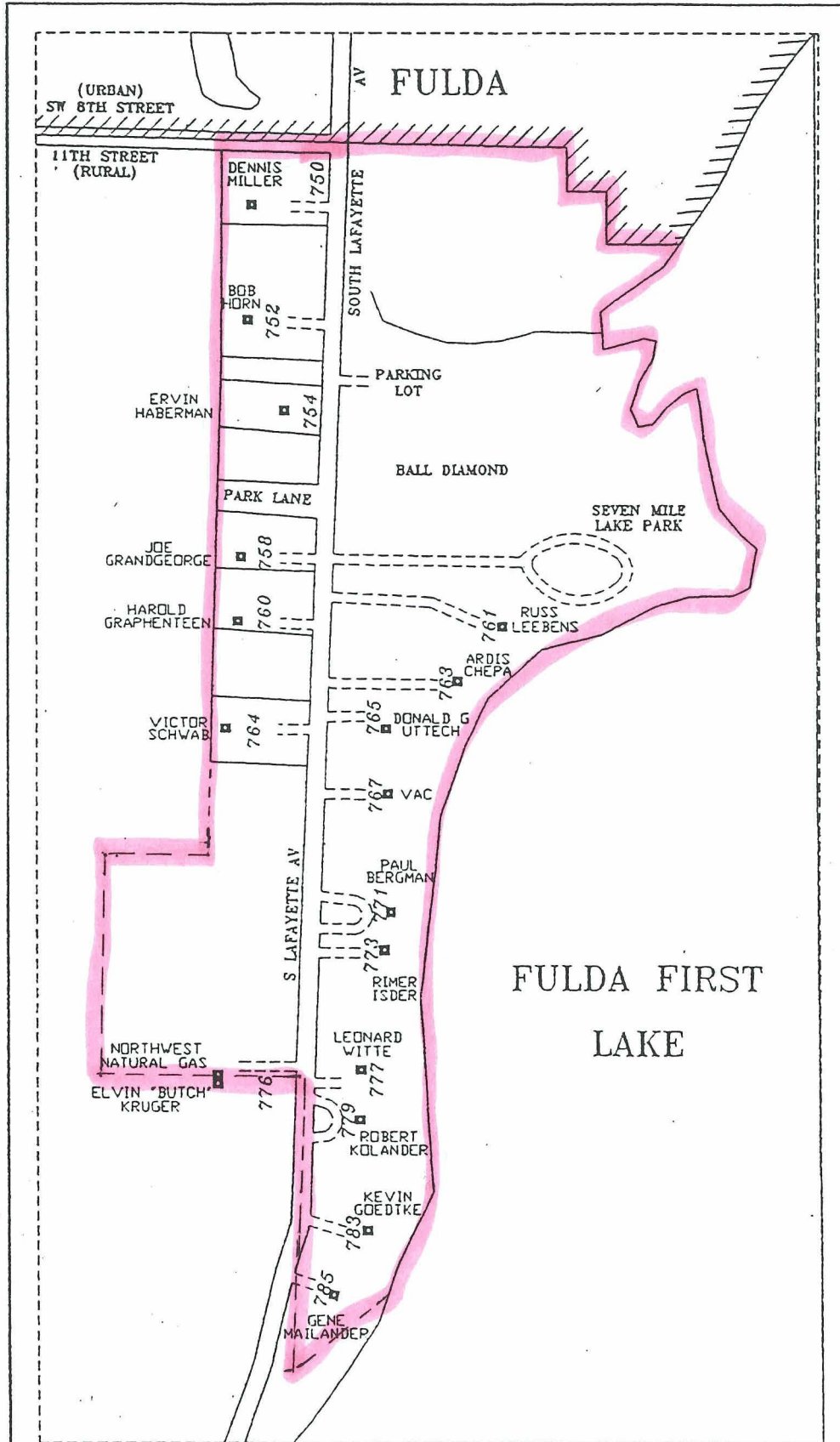

| DATE | REVISIONS |
|------|-----------|
| | |

FULDA LAKE WEST

RIOR CONVERTED WETLAND

TRACT NUMBER

WETLAND

W RSH RYM TR=SPECIAL COND. (SEE NRCS)

F=P-PARSED WETLAND PASTURE

NEL-HIGHLY ERODIBLE LAND

M=MULTIPLE TRACT NUMBER

WETLAND

NHEL-NON HIGHLY ERODIBLE LAND

NC-NON CROPLAND

NI-NON INVENTORIED

WETLAND

PC=PRIOR CONVERTED WETLAND

T=TRACT NUMBER

W=WETLAND

RSH RYM RYM RYM TR=SPECIAL COND. (SEE NRCS)

NOT TO BE REPRODUCED
SCALE Feb

CROP
YEAR 00

PHOTO
NO.

N-12

PHOTO
NO. N-12

before clearing, draining, dredging, filling or leveling any wet areas or leveling any wet areas or fields or improving modifying or maintaining an existing drainage system or an existing drainage system

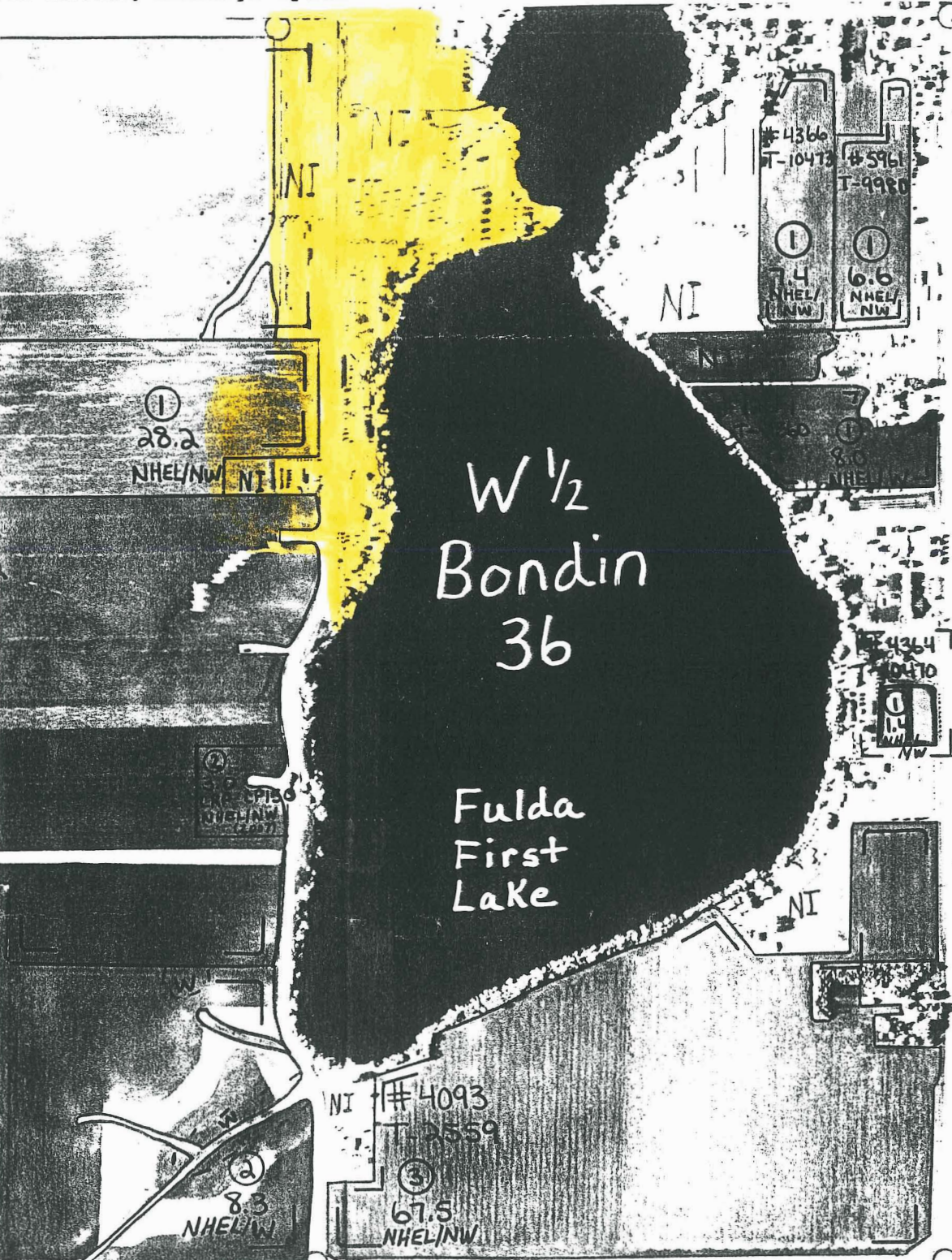

REC'D BY
MMB
JUN 21 2001