

504-09

RESOLUTION

REC'D BY  
MBA

NOV 30 2009

WHEREAS, on May 1, 2000, the Common Council of the City of Rochester and the Town of Rochester executed a Joint Resolution for Orderly Annexation for Rochester Area #4 (a copy of which is attached and incorporated herein); and

WHEREAS, paragraph 4 of the Joint Resolution allows land contained in the orderly annexation area to be annexed to the City no earlier than January 1 of the year five years after the substantial completion of a water or sewer project providing water or sewer service to the area; and,

WHEREAS, a water or sewer project providing water or sewer service to the area was substantially completed in 2004; and,

WHEREAS, the legal description for the area covered by the orderly annexation agreement is as follows:

That part of the Southeast Quarter of Section 13, Township 106 North, Range 14 West, Olmsted County, Minnesota, described as follows:

All of SOUTHPORT SUBDIVISION, SOUTHPORT SUBDIVISION NUMBER TWO, SOUTHPORT SUBDIVISION NUMBER THREE, SOUTHPORT SUBDIVISION NUMBER FOUR, SOUTHPORT SUBDIVISION NUMBER FIVE, and SOUTHPORT SUBDIVISION NUMBER SIX.

Also:

That part of the Northeast Quarter of the Northeast Quarter of Section 24, Township 106 North, Range 14 West, Olmsted County, Minnesota, described as follows:

Commencing at the northeast corner of said Northeast Quarter of the Northeast Quarter; thence West, assumed bearing, along the north line of said Northeast Quarter of the Northeast Quarter a distance of 363.40 feet to the center line of the County Road No. 1 and the point of beginning; thence continuing West along said north line 435.90 feet; thence South 200.00 feet; thence East 466.92 feet East to the center line of County Road No. 1; thence North 08 degrees 57 minutes 30 seconds West along said center line 94.94 feet; thence northerly along said center line on a tangential curve, concave to east, radius of 11459.16 feet, central angle 00 degrees 32 minutes 14 seconds, 107.45 feet to the point of beginning.

Containing in all, 92.8 acres, more or less.

NOV 30 2009

This proposed annexation area is to include all public right-of-ways and easements within the above-described areas; and,

WHEREAS; January 1, 2010, will be five years after the substantial completion of the water or sewer project; and,

WHEREAS, the Council wishes to invoke the procedure described in paragraph 4 of the Joint Resolution and annex the land contained in the orderly annexation area; and,

WHEREAS, the orderly annexation agreement allows for annexation by resolution and provides that the Minnesota Municipal Board may review and comment but shall, within 30 days or receipt of said resolution, order the annexation of the area described in the resolution; and,

WHEREAS, the City's estimate of the population contained in the area to be annexed is 333 and the number of households contained in the area to be annexed is 136; and,

WHEREAS, the City's estimate of electrical service cost at the time of annexation is (a) .09201 per kilowatt-hour from January through May and October through December, and (b) .11134 per kilowatt-hour from June through September; and,

WHEREAS, the amount of township taxes on the property to be annexed is \$30,621.62 and, in compliance with Minn. Stat. §414.036, the City states that there are no township special assessments assigned or portion of township debt attributable to the property to be annexed.

NOW, THEREFORE, BE IT RESOLVED by the Common Council of the City of Rochester that the petitioned property described above is hereby annexed, added to and made a part of the City of Rochester, Minnesota, as if it had originally been a part thereof.

BE IT FURTHER RESOLVED that this resolution shall take effect and be in force from and after its filing of a certified copy hereof with the Minnesota Municipal Board, or its successor, the Town of Rochester and the Olmsted County Auditor/Treasurer.

PASSED AND ADOPTED BY THE COMMON COUNCIL OF THE CITY OF  
ROCHESTER, MINNESOTA, THIS 16TH DAY OF NOVEMBER, 2009.

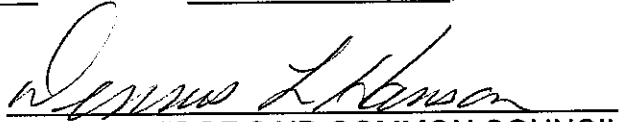
  
PRESIDENT OF SAID COMMON COUNCIL

ATTEST:   
CITY CLERK

REC'D BY  
MEA

NOV 30 2009

APPROVED THIS 17<sup>TH</sup> DAY OF NOVEMBER, 2009.

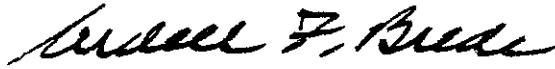

MAYOR OF SAID CITY

(Seal of the City of  
Rochester, Minnesota)

Zone05\OAA\Res1(Roch4)

Rochester Township Orderly Annexation Area #4  
Land area to be annexed into the City of Rochester, January 1, 2010

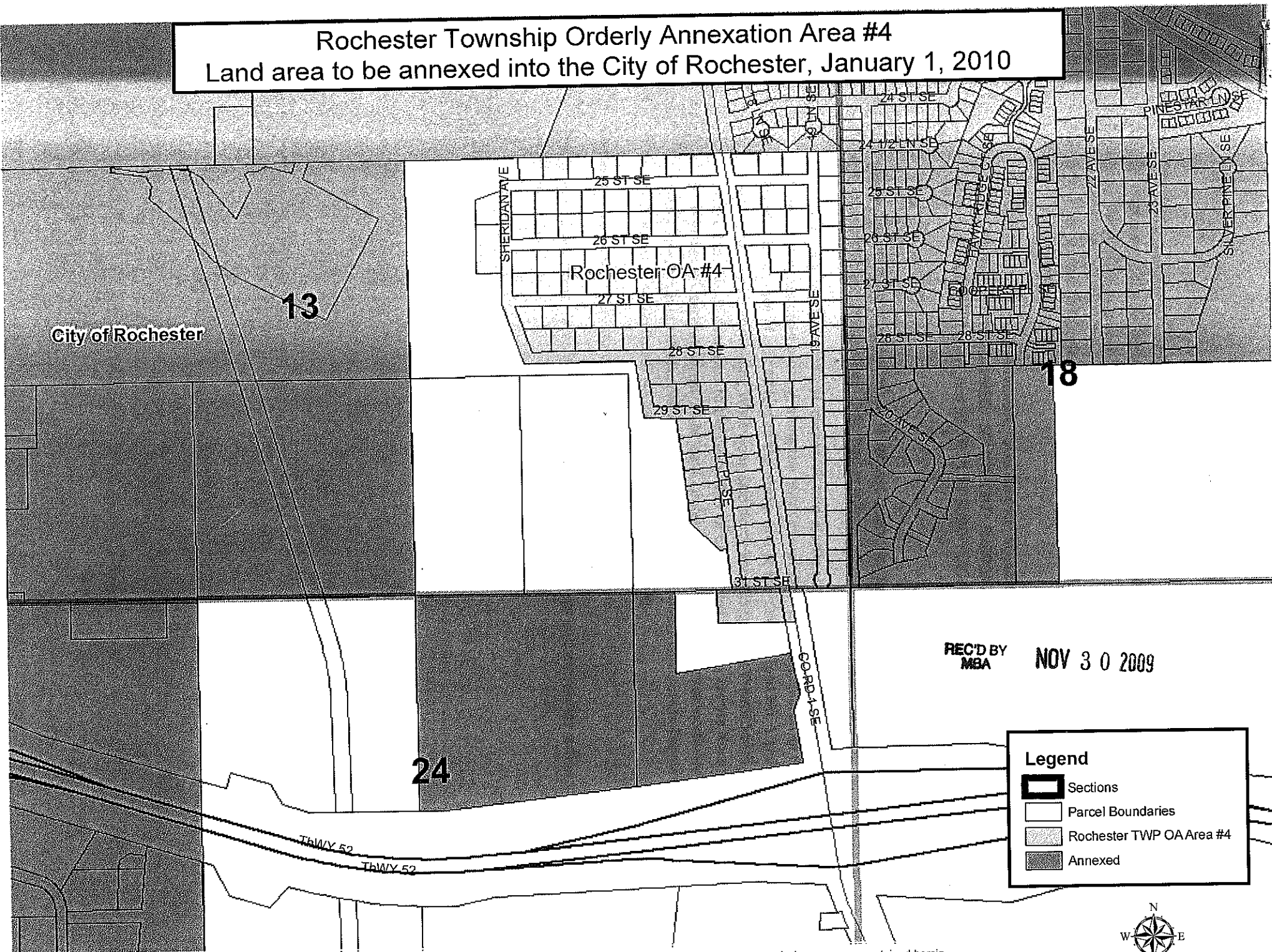

Prepared by the Geographic Information Systems Division, Rochester-Olmsted Planning Department. Olmsted County is not responsible for omissions or errors contained herein.  
If discrepancies are found within this map, please notify the GIS Division, Rochester-Olmsted County Planning Department, 2122 Campus Drive SE, Rochester, MN 55904, (507) 328-7100.

