

**JOINT RESOLUTION BETWEEN THE TOWNSHIP OF MEDFORD AND  
THE CITY OF MEDFORD  
FOR ANNEXATION OF PART OF AREA DESIGNATED FOR  
ORDERLY ANNEXATION**

WHEREAS Lyle L. Tuttle, owner of the following described property situated in the County of Steele, State of Minnesota, to-wit:

Commencing at the NE Corner of Sublot 4 in the SW 1/4 of Section 9, Township 108, Range 20, thence West along the North line of said Lot, 625 feet; thence South to the South line of said Lot a distance of 297 feet more or less; thence East 625 feet more or less to a point 297 feet South of the Northeast Corner of said Sublot 4; thence North a distance of 297 feet more or less to the Northeast Corner of said Sublot 4. Together with a perpetual easement for road purposes over and across the North 16 1/2 feet of that part of Sublot 4 in the Southwest Quarter of Section 9, Township 108, Range 20, lying East of the Chicago and Rock Island and Pacific Railway right of way, excepting, however, the East 500 feet thereof. All in Steele County, Minnesota.

has petitioned the Town Board for the Township of Medford and the City Council for the City of Medford for the annexation of the above-described property into the municipal limits of the City of Medford, a municipal corporation; and

WHEREAS, the above-described property is within the area designated for orderly annexation by Joint Resolution Between the Township of Medford and The City of Medford Designating an Area for Orderly Annexation on file with the Minnesota Municipal Board, said Joint Resolution dated June 8, 1999; and

WHEREAS, all conditions for the annexation of the above-described property set forth in the aforementioned Joint Resolution have been satisfied.

NOW, THEREFORE, it is hereby jointly resolved by and between the Town Board for the Township of Medford and the City Council for the City of Medford as follows:

1. The following described property situated in the County of Steele, State of Minnesota, to wit:

Commencing at the NE Corner of Sublot 4 in the SW 1/4 of Section 9, Township 108, Range 20, thence West along the North line of said Lot, 625 feet; thence South to the South line of said Lot a distance of 297 feet more or less; thence

East 625 feet more or less to a point 297 feet South of the Northeast Corner of said Sublot 4; thence North a distance of 297 feet more or less to the Northeast Corner of said Sublot 4. Together with a perpetual easement for road purposes over and across the North 16 ½ feet of that part of Sublot 4 in the Southwest Quarter of Section 9, Township 108, Range 20, lying East of the Chicago and Rock Island and Pacific Railway right of way, excepting, however, the East 500 feet thereof. All in Steele County, Minnesota.

shall be and hereby is annexed to the City of Medford.

2. The above-described property consists of 4.26 acres, more or less. A map showing the relationship of the above-described property to the municipal limits of the City of Medford is attached hereto as Exhibit "A".
3. This Joint Resolution shall be filed with the Minnesota Municipal Board together with the appropriate filing fee. No consideration by the Minnesota Municipal Board is necessary although the Board may review and comment. However, within thirty (30) days, the Board shall order the annexation in accordance with the terms of this joint resolution.

Dated this \_\_\_\_\_ day of February, 2003.

**CITY OF MEDFORD:**

Passed and Adopted by the City of Medford  
this 16<sup>th</sup> day of April,  
2003.

By: [Signature]  
Its Mayor

ATTEST: [Signature]  
City Clerk

**TOWNSHIP OF MEDFORD:**

Passed and Adopted by the Township of Medford  
this 8 day of April,  
2003.

By: [Signature]  
Its Chairman

ATTEST: [Signature]  
Town Board Clerk



# EXHIBIT

tabbles

" A "

REC'D BY APR 28 2003  
M.M.B.

CITY OF  
**MEDFORD**



STRAIGHT RIVER

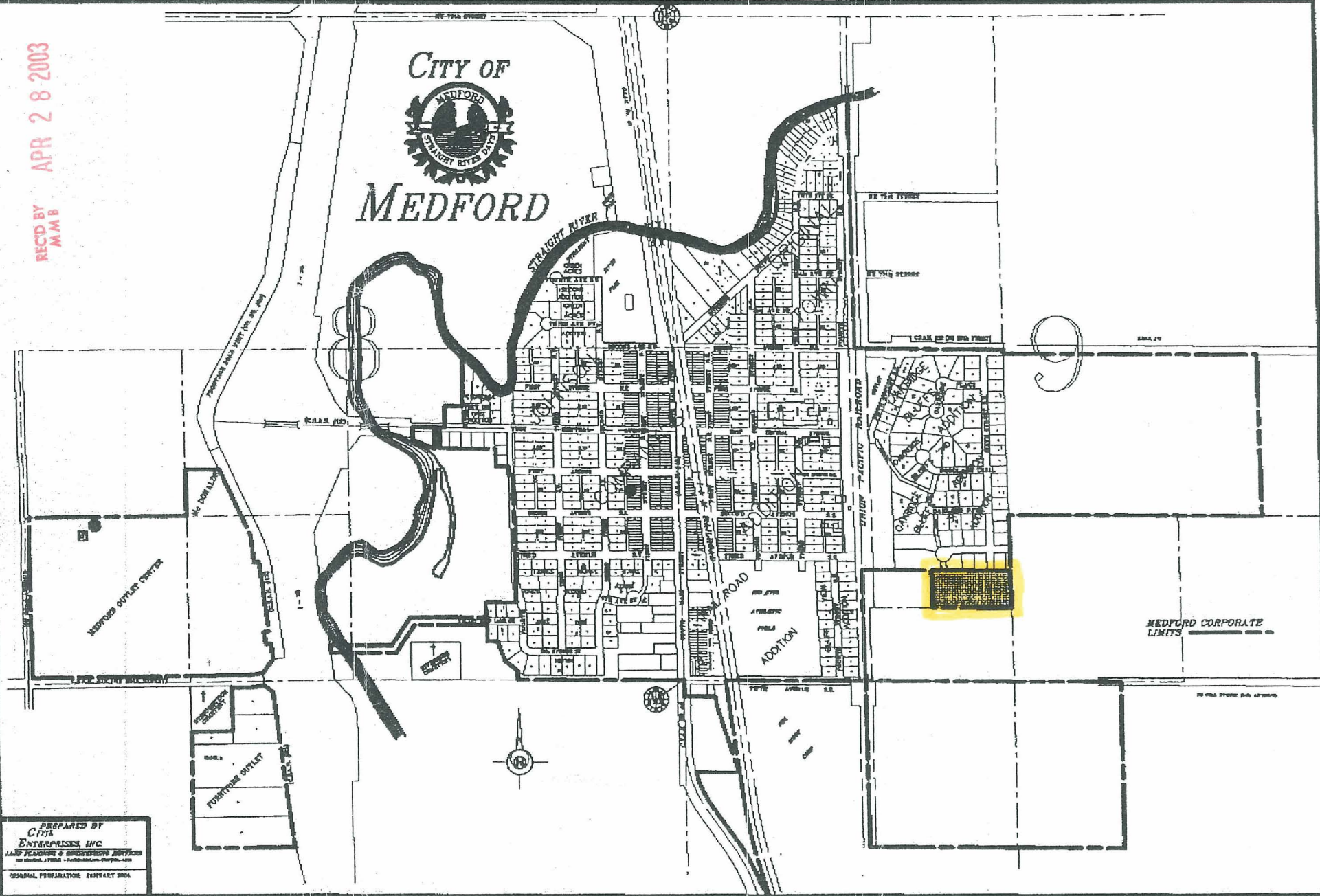

MEDFORD CORPORATE LIMITS

PREPARED BY  
CIVIL  
ENTERPRISES, INC.  
LAND PLANNING & ENGINEERING SERVICES  
1000 N. 10TH ST. SUITE 100  
MEDFORD, OREGON 97504  
ORIGINAL PREPARATION: JANUARY 2004