

TO THE MINNESOTA MUNICIPAL BOARD  
15 METRO SQUARE BUILDING  
ST. PAUL, MINNESOTA 55101

In the Matter of the Joint Resolution  
of the City of Nashwauk and the Town  
of Nashwauk, Itasca County, Minnesota  
DESIGNATING AN UNINCORPORATED  
AREA IN NEED OF ORDERLY ANNEXATION  
and conferring Jurisdiction over said area to the  
Municipal Board Pursuant to MST 414.0325.

JOINT RESOLUTION FOR  
ORDERLY ANNEXATION  
AND IMMEDIATE  
ANNEXATION

---

THIS JOINT RESOLUTION, made and entered into the day and year hereinafter noted by the City of Nashwauk, Itasca County, Minnesota, (hereinafter referred to as CITY) and the Town of Nashwauk, Itasca County, Minnesota, (hereinafter referred to as TOWN).

RECITALS

1. That the City constructed a waste water treatment plant upon property located outside of the CITY in the TOWN. That in addition, the CITY is in need of suitable property for the continued expanse of its commercial and/or industrial base, the majority of such suitable property located in the CITY having been utilized.
2. The CITY, in 1988 proceeded to construct the waste water treatment plant, bid sewer pipes and connected the equalization base to the sewage pond.
3. The CITY and TOWN filed a joint annexation request with the Municipal Board in 1988, but failed to identify the proper legal descriptions.
4. The corrected legal description of the property located with the Township which is proposed to be annexed is described fully on Exhibit "A".
5. That the CITY is capable of providing necessary service to this area within a reasonable time, and the TOWNSHIP is not able to adequately protect the public health, safety or welfare of the area should anticipated commercial and/or industrial development take place within the area, and further the TOWN has no interest in the waste water treatment facility of the CITY, thus the immediate annexation of such area would be in the best interest of all concerned.
6. That the CITY and the TOWN believe that no consideration by the Minnesota Municipal Board is necessary for said annexation, and both agree that the above described area should be annexed and become a part of the CITY subject to all of the ordinances,

controls and other obligations and benefits of property located within the CITY, and should cease to be part of the TOWNSHIP and should therefore be released from the jurisdiction thereof.

NOW THEREFORE, BE IT RESOLVED BETWEEN THE CITY AND TOWNSHIP AS FOLLOWS:

1. That the area described above is in need of orderly annexation and no alternative of its stated boundaries as set forth above is appropriate.
2. That the area described above in its entirety is presently urban or suburban in nature or is about to become so and thus the entire area should be immediately annexed into the CITY following the Minnesota Municipal Board reviewing and commenting on the same, but ordering nonetheless, within thirty days of the filing of this Resolution, the annexation of the entire area in accordance with the terms of this Resolution.
3. The conditions of annexation of said area described above shall be that said property will cease to be part of the TOWNSHIP and shall be annexed to and included within the corporate limits of the CITY and would in all things become subject to the jurisdiction of the CITY and become a part thereof and shall be released from the jurisdiction of the TOWNSHIP and shall be no longer a part thereof.
4. The mill levy of the CITY on the area to be annexed shall be increased in substantially equal proportions over a period of six years to equality with the mill levy of the CITY pursuant to MSA 414.035. Provided, however, that following such annexation, property subsequently developed within the annexed area during the six-year mill levy phase-in shall be immediately subject to taxation at the full and current mill levy rate of the CITY. That in addition, the CITY shall pay to the TOWNSHIP a sum equal to the total taxes received by the TOWNSHIP from all the property set forth on the attached Exhibit "A" for taxes levied in 1997 and payable in 1998 to the TOWNSHIP, to be paid for each of the three years immediately following the order of annexation.
5. That the CITY shall zone the area to be annexed pursuant to the conditions and requirements of its existing City Code, if any.
6. Upon annexation, the CITY shall take over maintenance of and be responsible for all public roadways located within the annexed area formerly maintained by the TOWNSHIP, if any.
7. The area described in the attached Exhibit "A" contains no existing homes, and there are no residences and therefore no population in the effected area.
8. That the joint resolution requesting both orderly annexation and the immediate annexation of the area described above pursuant to the terms and conditions set forth herein shall be

REC'D. BY  
MMB FEB 24 1998

submitted by the City Clerk of the City of Nashwauk to the Minnesota Municipal Board for said Board's thirty-day review and comment pursuant to MSA 414.0325, accompanied by the required filing fee.

THE ABOVE RESOLUTION IS HEREBY ADOPTED AND APPROVED BY THE CITY COUNCIL OF THE CITY OF NASHWAUK, ITASCA COUNTY, MINNESOTA, ON THE 12 DAY OF JANUARY 1998.

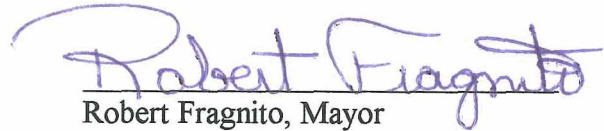
  
Robert Fragnito, Mayor

ATTEST:

  
Edward Bolf, Clerk-Treasurer

THE ABOVE RESOLUTION IS HEREBY ADOPTED AND APPROVED BY THE TOWN BOARD OF SUPERVISORS OF THE TOWN OF NASHWAUK, ITASCA COUNTY, MINNESOTA, ON THE 10<sup>th</sup> DAY OF FEBRUARY 1998.

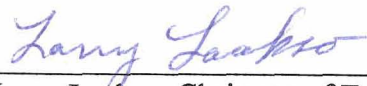
  
Larry Laakso, Chairman of Town Board

ATTEST:

  
Karen Calaguire, Clerk

Cub A

REC'D. BY  
MMB FEB 27 1998

CITY OF NASHWAUK  
NASHWAUK TOWNSHIP LAND ANNEXATION

1. Section 33, Township 57 North, Range 22 West
  - NW 1/4 of SW 1/4 south of northerly right-of-way line of Trunk Highway 169
  - NE 1/4 of SW 1/4 south of northerly right-of-way line of Trunk Highway 169
  - SW 1/4 of SW 1/4
  - SE 1/4 of SW 1/4
  - NW 1/4 of SE 1/4 south of northerly right-of-way line of Trunk Highway 169
  - SW 1/4 of SE 1/4
  - SE 1/4 of SE 1/4
  - NE 1/4 of SE 1/4
  - SW 1/4 of NE 1/4 including O'Brien Lake
  - NW 1/4 of NE 1/4 including O'Brien Lake and north of abandoned Trunk Highway 169
  - SE 1/4 of NE 1/4
  - NE 1/4 of NE 1/4
  - NW 1/4 of NW 1/4 north of abandoned Trunk Highway 169
  - NE 1/4 of NW 1/4 north of abandoned Trunk Highway 169
  
2. Section 34, Township 57 North, Range 22 West, the whole section

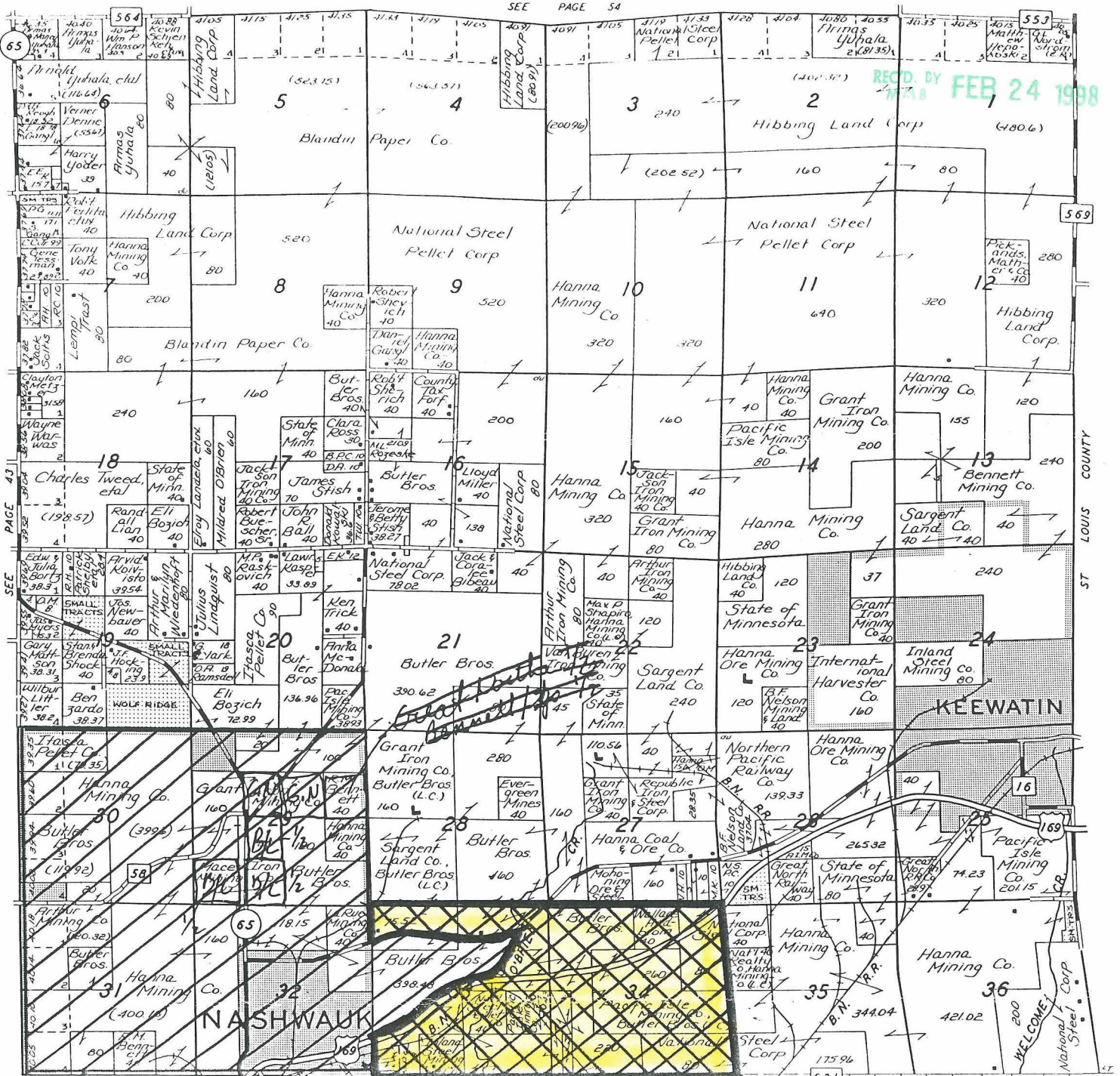

EXISTING CITY LIMITS PROPOSED ANNEXATION

Home Of  
Fred's Quality Meats and Sausage

Phone: 885-1447 • Goodland: 492-4477

