

**RESOLUTION NO. 98-007**

IN THE MATTER OF THE JOINT RESOLUTION  
OF THE TOWN OF GROVE AND THE CITY OF MELROSE  
DESIGNATING AN UNINCORPORATED AREA AS IN NEED OF  
ORDERLY ANNEXATION AND CONFERRING  
JURISDICTION OVER SAID AREA TO THE MINNESOTA  
MUNICIPAL BOARD PURSUANT TO M.S. 414.0325.

**JOINT RESOLUTION FOR ORDERLY ANNEXATION**

The Township of Grove and the City of Melrose hereby jointly agree to the following:

1. That the following described area in Grove Township is subject to orderly annexation pursuant to Minnesota Statutes 414.0325, and the parties hereto designate this area for orderly annexation:

That part of the NE1/4 NE1/4 and that part of the SE1/4 NE1/4 and that part of the SW1/4 NE1/4, Section 2, Township 125 North, Range 33 West, Stearns County, Minnesota, described as follows: Beginning at the northwest corner of said NE1/4 NE1/4; thence North 89 degrees 59 minutes 49 seconds East (assumed bearing) along the north line of said NE1/4 NE1/4, 150.01 feet; thence South 00 degrees 32 minutes 22 seconds West parallel with the west line of said NE1/4 NE1/4, 352.52 feet to the northerly right of way line of the discontinued Burlington Northern Railroad; thence South 81 degrees 55 minutes 20 seconds East along said right of way line 109.92 feet; thence South 00 degrees 32 minutes 22 seconds West parallel with the west line of said NE1/4 NE1/4 and the west line of said SE1/4 NE1/4, 2028.50 feet to the centerline of Old Highway No. 52; thence North 73 degrees 11 minutes 58 seconds West along said centerline 402.30 feet; thence North 00 degrees 32 minutes 22 seconds East, parallel with the west line of said NE1/4 NE1/4 and the west line of said SE1/4 NE1/4, 460.21 feet; thence South 89 degrees 27 minutes 38 seconds East 127.23 feet to the west line of said SE1/4 NE1/4 and to the west line of said NE1/4 NE1/4; thence North 00 degrees 32 minutes 22 seconds East along the west line of said SE1/4 NE1/4 and the west line of said NE1/4 NE1/4, 1822.15 feet to the point of beginning.

2. That the Township of Grove does, upon passage of this Resolution and its adoption by the City Council of the City of Melrose, Minnesota, and upon acceptance by the Municipal Board, confer jurisdiction upon the Minnesota Municipal Board over the various provisions contained in this Resolution.

3. The above described property abuts upon the corporate limits at the east boundary of the City of Melrose and is presently urban or suburban in nature or about to become so. Further, the City of Melrose is capable of providing services to this area within a reasonable time. The parties request immediate annexation to the City of Melrose the area which is above described.

4. There are eleven (11) persons living on this property.

5. The reason for this annexation is to permit City services to be brought to the area.

6. No consideration by the Municipal Board is necessary.

7. Electrical service to the area proposed to be annexed is provided by Stearns Cooperative Electric Association. The City of Melrose is the owner of an electrical distribution service which now services areas of the City of Melrose. Upon annexation of the property, the City of Melrose will attempt to negotiate an agreement with Stearns Cooperative Electric Association which will permit the City to provide the electrical service to the annexed property. In the event City is successful, City will then provide electrical needs to the area. In the event it is not successful in negotiating a contract, the area will continue receiving service from Stearns Cooperative Electric Association.

The owners of property lying in the area to be annexed have not petitioned for annexation and therefore Subdivision 1a. of M.S.A. 414.0325 does not appear to be applicable. Property owners within the area to be annexed have been notified that there may be a change in their source of electrical power and in such event there may be a change in the electrical rates for them. A copy of the electrical rates charged by the City of Melrose at the present time has been given to each of the affected property owners.

CITY OF MELROSE:

Passed and adopted by the City Council of the City of Melrose this 22nd day of January, 1998.

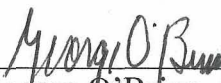
  
George O'Brien  
Mayor

ATTEST:

  
Rose Ann Inderrieden  
City Clerk-Treasurer

REC'D. BY  
MMB FEB 05 1998

TOWNSHIP OF GROVE:

Passed and adopted by the Town Board of the Town of Grove this 12th day of January, 1998.

Walter Sand

Walter Sand  
Chairman

ATTEST:

Richard W. Thull

Richard W. Thull  
Clerk



REC'D. BY  
MAB FEB 05 1998

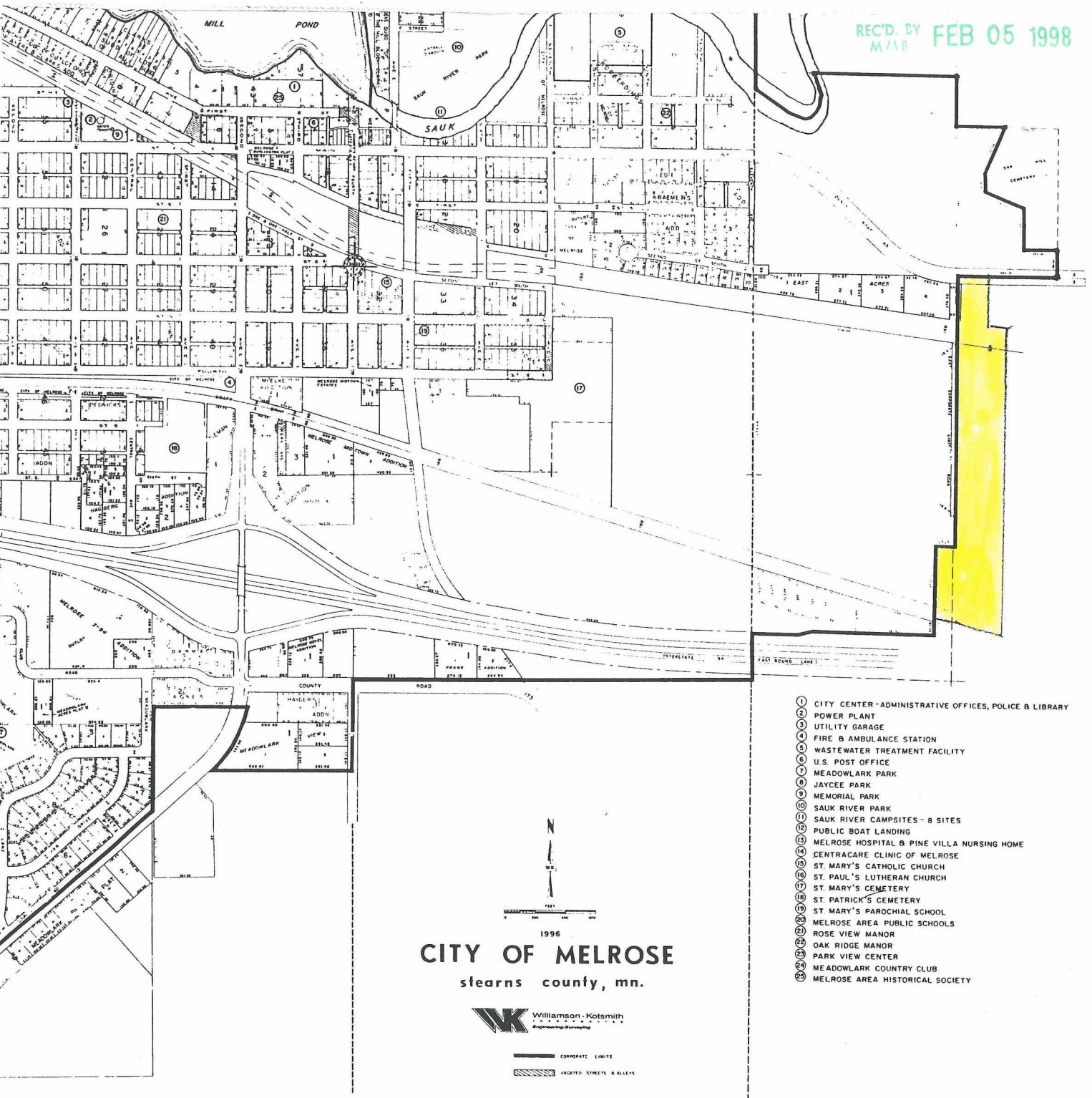

POLICE 256-4247 or 256-7211  
FIRE 256-4247  
AMBULANCE 256-4231  
CITY HALL 256-4278  
CITY CLERK 256-3659  
CITY MAINTENANCE 256-4247  
UTILITY PLANT 256-4247



REC'D. BY  
MAB FEB 05 1998

# CITY OF MELROSE

stearns county, mn.



POLICE 256-4261 or 256-7211  
FIRE 256-4267  
AMBULANCE 256-4275  
CITY HALL 256-4276  
CITY CLERK 256-3858  
CITY MAINTENANCE 256-4287  
UTILITY PLANT 256-4247

- ① CITY CENTER-ADMINISTRATIVE OFFICES, POLICE & LIBRARY
- ② POWER PLANT
- ③ UTILITY GARAGE
- ④ FIRE & AMBULANCE STATION
- ⑤ WASTEWATER TREATMENT FACILITY
- ⑥ U.S. POST OFFICE
- ⑦ MEADOWLARK PARK
- ⑧ JAYCEE PARK
- ⑨ MEMORIAL PARK
- ⑩ SAUK RIVER PARK
- ⑪ SAUK RIVER CAMPSITES - 8 SITES
- ⑫ PUBLIC BOAT LANDING
- ⑬ MELROSE HOSPITAL & PINE VILLA NURSING HOME
- ⑭ CENTRACAPE CLINIC OF MELROSE
- ⑮ ST. MARY'S CATHOLIC CHURCH
- ⑯ ST. PAUL'S LUTHERAN CHURCH
- ⑰ ST. MARY'S CEMETERY
- ⑱ ST. PATRICK'S CEMETERY
- ⑲ ST. MARY'S PAROCHIAL SCHOOL
- ⑳ MELROSE AREA PUBLIC SCHOOLS
- ㉑ RIDGE VIEW MANOR
- ㉒ OAK RIDGE MANOR
- ㉓ PARK VIEW CENTER
- ㉔ MEADOWLARK COUNTRY CLUB
- ㉕ MELROSE AREA HISTORICAL SOCIETY