

2025 OCT 23 10:57

JOINT RESOLUTION BETWEEN THE
TOWNSHIP OF PEMBINA AND THE CITY OF MAHNOMEN
DESIGNATING AN AREA FOR ORDERLY ANNEXATION

The Township of Pembina and the City of Mahnomen hereby jointly agree to the following:

1. That the following described area in Pembina Township is in need of orderly annexation pursuant to Minnesota Statutes 414.0325, and the parties hereto designate this area for orderly annexation:

A Fifty-seven Hundredths (0.57) acre of land in the Northeast Quarter of the Northeast Quarter (NE 1/4 NE 1/4) of Section Eleven (11), Township One Hundred Forty-four (44), North of Range Forty-two (42) West of the Fifth Principal Meridian in Mahnomen County, Minnesota, described as follows:

Beginning at a point marked by an iron monument, which point bears East Nineteen (19) rods, South forty (40) rods and East twenty eight and six tenths (28.6) feet from the Northwest Corner of said NE 1/4 NE 1/4; thence running due East one hundred and one five tenths (101.5) feet to an iron stake; thence Southeasterly One Hundred Twenty Nine and two tenths (129.2) feet parallel to the Northeasterly Line of State Highway #59 to an iron stake; thence at right angles Southwesterly One Hundred Fifty (150) feet to an iron pipe on the Northeasterly Line of the said State Highway; thence Northwesterly on and along the Northeasterly Line of the said Highway Ninety (90.0) feet; thence at right angles Northeasterly Ten (10.0) feet to Highway Engineer's Station #489 plus 00 (iron monument); thence at right angles Northwesterly on and along the Northeasterly Line of the said State Highway Eighty-seven and three tenths (87.3) feet to an iron pipe; thence running Northeasterly Sixty-one and nine tenths (61.9) feet to the point of beginning and there terminating.

2. That no alternation of the stated boundaries (the property described at Paragraph 1 hereof) is appropriate and the Municipal Board may review and comment, but shall, within thirty (30) days, order the annexation in accordance with the terms of this Resolution.

3. That the City of Mahnomen shall follow City policies regarding the extension of municipal utilities to the area to be annexed.

4. That the parties agree that the City of Mahnomen shall not be obligated to reimburse Pembina Township for the property being annexed as part of the Board's Order.

REC'D. BY
M/M/B OCT 29 1997

Approved by the City of Mahanomen and the Township of Pembina
this 23rd day of October, 1997.

CITY OF MAHNOMEN

BY: Darwin Schoenborn
IT'S MAYOR

BY: [Signature]
IT'S CLERK/ADMINISTRATOR

PEMBINA TOWNSHIP BOARD

BY: Richard Buschett
IT'S CHAIRMAN

BY: [Signature]
IT'S CLERK

Wild Rice River

AREA PROPOSED
to be ANNEXED
Lewis & Janice Cox Property
SEE ATTACHED LEGAL DESCRIPTION.



REC'D. BY
MMB OCT 29 1997

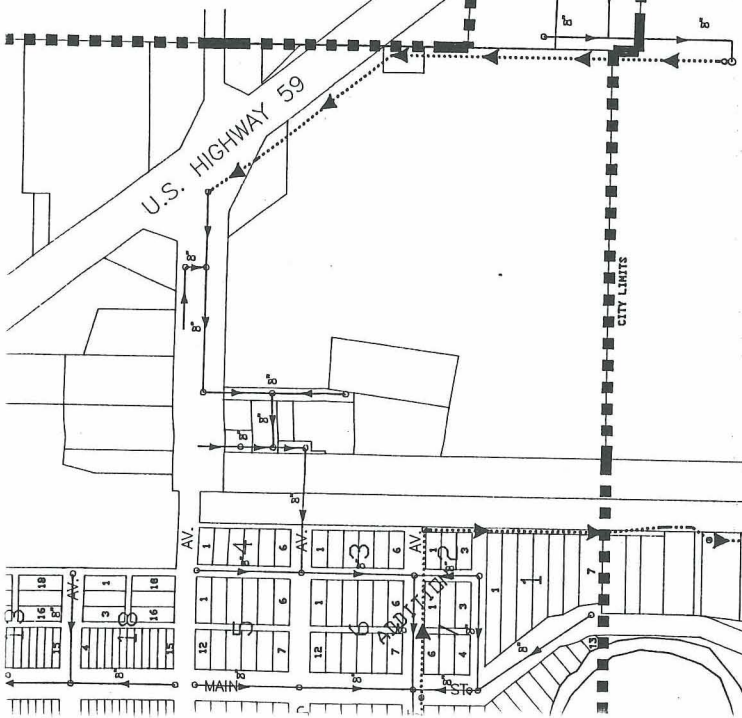

Wild Rice River

13.012.0400

13.012.0400

DELMAR

WABE STATION

13.011.6500

1072.5'

1056'
13.011.6400

1122'

825'

REC'D. BY
MMB OCT 29 1997



13.002.2800
S.M.

13.011.0300
13.011.0100
13.011.6200

13.011.0500
13.011.0400
13.011.0210
13.011.0200

13.011.5710
13.011.0600
13.011.0700

13.011.5428

151K.

180'
490'
140'
236.70
299C
65.54
18.002.2930
4141

02.2940 3,59AC

299C

U.S. HWY 59

STARBUCK
SERVICES
INC.

PHILADELPHIA
INTERNATIONAL

11.5.57.4011

DR 05.611

1124 1124 SEC 12

1124 1124 SEC 12

13.012.0700

13.012.0700

DELMAR
KREBSBACH

13.011.0500

1072.5'

1056'

1122'

894.5'

13.011.0910
THORSON

7.55 AC

798'

REC'D. BY OCT 29 1997
MAB

13.011.0300
D. WINTER

13.011.0310
SCHADEN PORN
CONCRETE 6 AC

211.5'

620.8'

730'

13.002.2800
3. AC.

13.011.0300

13.011.0100

13.011.0200

13.011.0240

13.011.0220

13.011.0300

13.011.0110

13.011.0210

13.011.0200

13.011.0200

13.011.0200

Y. SHAVE

IMMANONEN
WHOLESALE

STARBUCK
SILITES
INC.

13.011.0710

13.011.0700

13.011.0920

15 AC.

U.S. HWY. 59

2.901
3.47 AC

1002.2940 3.59 AC

2.2940
1.29 AC

1.65.54

18.002.2930

CRSING

LOAD