

RESOLUTION NO. 2013-45

**RESOLUTION APPROVING THE PRELIMINARY AND FINAL PLAT OF
GOLDENSPIKE COMMONS AND APPROVING THE ANNEXATION OF THE
SAME**

WHEREAS, the Adelman Sisters LLC. ("Developer") have presented an application for a preliminary plat and final plat called Goldenspike Commons, in addition to applying for annexation of the property into the City of Sauk Rapids;

WHEREAS, the Developer has complied or will comply with all of the conditions imposed on the Final and Preliminary Plats;

WHEREAS, the City has entered into an orderly annexation agreement with Sauk Rapids Township that addresses the annexation of this property;

WHEREAS, the Sauk Rapids Planning Commission has at their regularly scheduled September meeting recommended approval of both the preliminary Plat and annexation request.

NOW, THEREFORE, the Sauk Rapids City Council resolves as follows:

1. The annexation request is hereby approved
2. The Preliminary and Final Plat are approved with the following conditions:
 - That the applicant executes a developers agreement with the City prior to the plat being valid.
 - That the required drainage and utility easements be added to the plat.
 - All existing structures not meeting setbacks to be torn down or moved to meet setbacks.

Adopted September 23 2013.



Mayor

ATTEST:

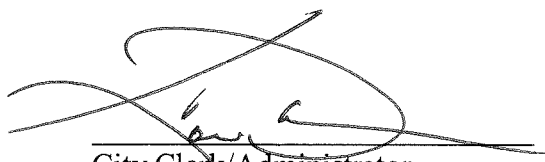

City Clerk/Administrator

That part of the Southwest Quarter of the Southeast Quarter of Section 13, Township 36 North, Range 31 West, Benton County, described as follows:

Commencing at the southwest corner of said Southwest Quarter of the Southeast Quarter; thence North 89 degrees 01 minute 07 seconds East, assumed bearing along the south line of said Southwest Quarter of the Southeast Quarter, a distance of 400.04 feet to the southwest corner of the tract of land described in Doc. No. 347364 on file and of record in the Office of the County Recorder, said Benton County; thence North 01 degree 47 minutes 01 second West, along the west line of said tract of land, a distance of 1037.91 feet; thence South 85 degrees 18 minutes 07 seconds West, continuing along said west line, a distance of 50.00 feet to the point of beginning of the tract of land to be described; thence North 01 degree 47 minutes 01 second West, along said west line, a distance of 93.67 feet; thence North 85 degrees 18 minutes 07 seconds East, continuing along said west line, a distance of 278.52 feet; thence North 14 degrees 33 minutes 46 seconds East, continuing along said west line, a distance of 201.27 feet to the north line of said Southwest Quarter of the Southeast Quarter; thence South 89 degrees 13 minutes 00 seconds West along said north line, a distance of 434.94 feet to the east line of the tract of land described in Doc. No. 198445, on file and of record in the Office of the County Recorder, said Benton County; thence South 01 degree 47 minutes 01 seconds East along said east line, a distance of 118.53 feet to the southeast corner of said tract of land; thence South 88 degrees 12 minutes 59 seconds West along the south line of said tract of land, a distance of 250.00 feet to the west line of said Southwest Quarter of the Southeast Quarter; thence South 01 degree 47 minutes 01 second East along said west line, distance of 926.80 feet; thence North 88 degrees 12 minutes 59 seconds East, a distance of 195.00 feet; thence North 01 degree 47 minutes 01 second West, a distance of 208.30 feet; thence South 88 degrees 12 minutes 59 seconds West, a distance of 42.00 feet; thence North 01 degree 47 minutes 01 second West, a distance of 316.70 feet; thence North 88 degrees 12 minutes 59 seconds East, a distance of 110.00 feet; thence North 01 degree 47 minutes 01 second West, a distance of 189.40 feet; thence North 88 degrees 12 minutes 59 seconds East, a distance of 87.07 feet; thence North 01 degree 47 minutes 01 second West, a distance of 22.37 feet to the point of beginning.

LESS AND EXCEPT the West 33.00 feet of the South 1219.80 feet of said Southwest Quarter of the Southeast Quarter.

ALSO LESS AND EXCEPT that part of said Southwest Quarter of the Southeast Quarter described as follows:

Beginning at a point located 1037.4 feet North and 33 feet East of the Southwest Quarter corner in said Section 13; thence East (assumed bearing) at a 90 degree angle to the South Quarter line in said Section 13 a distance of 230 feet; thence South on a line parallel with said South Quarter line a distance of 189.4 feet; thence West at a 90 degree angle to said South Quarter line a distance of 230 feet to a point distant 33 feet East of said South Quarter line; thence North on a line parallel with said South Quarter line a distance of 189.4 feet to the point of beginning.

GOLDENSPIKE COMMONS

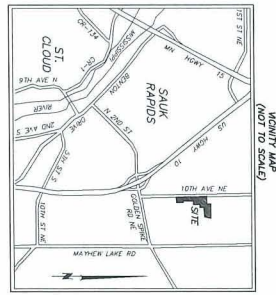

BEARINGS SHOWN ARE BASED UPON THE BENTON COUNTY
CADASTRAL SURVEY OF 1887, AS AMENDED BY
RECORDS OF THE BENTON COUNTY CLERK'S OFFICE
BEFORE NORTH 01 DEGREES 47 MINUTES 01 SECONDS WEST.

○ Denotes 1/2 inch by 1/4 inch measurement
● Denotes found monument
● Denotes government section center
(XXX.XX) Denotes round dimension



LOT 1, Block 2
IS EXCLUDED
FROM ANNEXATION.

THIS LOT WAS
ANNEXED IN
2007.
(PARCEL #
19.00005.20)

TO BE
ANNEXED