

TO: THE MINNESOTA MUNICIPAL BOARD
165 METRO SQUARE BUILDING
ST. PAUL, MN 55101

REC'D. BY OCT 20 1995
M M R

IN THE MATTER OF THE JOINT
RESOLUTION OF THE TOWN
OF ROCKFORD AND THE CITY OF
ROCKFORD DESIGNATING AN
UNINCORPORATED AREA AS IN
NEED OF ORDERLY ANNEXATION
AND CONFERRING JURISDICTION
OVER SAID AREA TO THE MINNESOTA
MUNICIPAL BOARD PURSUANT TO
MINNESOTA STATUTES 414.0235.

JOINT RESOLUTION
FOR ORDERLY ANNEXATION

The Township of Rockford (the "Township") and the City of
Rockford (the "City") hereby jointly resolve and agree as
follows:

1. The property described below (the "Property") is located
in the Township, is subject to orderly annexation pursuant to
Minnesota Statutes 414.0325, and the parties hereto designate the
Property for orderly annexation:

The South 534.50 feet of the Northwest Quarter of the
Southeast Quarter and the South 534.50 feet of the West
Quarter of the Northeast Quarter of the Southeast Quarter
all in Section 20, Township 119, Range 24, Wright County,
Minnesota. Containing 20.00 acres and subject to the right-
of-way of Wright County Highway Number 18 over the West
33.00 feet of said Northwest Quarter of the Southeast
Quarter and also except the West five acres thereof.

Also conveyed is that certain roadway easement over the
North 66 feet of the West five acres excepted from the above
described tract as described in that certain deed dated
August 9, 1973 between the same parties covering said five
acre tract.

LESS AND EXCEPT: The tract described in Book 306 of Deeds,
Page 922 described as:

The South 534.50 feet of the West one quarter of the
Northeast Quarter of the Southeast Quarter and the South
534.50 feet of the East 498.57 feet of the Northwest Quarter
of the Southeast Quarter, Section 20, Township 119, Range
24, lying North of the Northerly boundary of the Maplewood

Manor Third Addition as platted, said plat being on file and of record in the office of the County Recorder in and for Wright County, Minnesota. Together with an ingress and egress easement across the North 66.00 feet of the South 534.50 feet of the Northwest Quarter of the Southeast Quarter of Section 20, Township 119, Range 24, lying west of the East 498.57 feet of said Northwest Quarter of the Southeast Quarter.

2. The Township does, upon passage of this resolution and its adoption by the City, and upon acceptance by the Minnesota Municipal Board, confer jurisdiction upon the Minnesota Municipal Board over the various provisions contained in this Agreement.

3. The Property abuts the City and is presently suburban in nature. The City is capable of providing essential sewer and water services to the Property within a reasonable time, which the Township is not. The existing township form of government is not adequate to protect the public health and welfare by providing essential sewer and water services to the Property. Annexation would be in the best interests of the Property. The Property should be immediately annexed to the City.

4. The Property is owned by the Rockford Baptist Church, a Minnesota religious corporation which pays no real estate taxes; therefore, division of future real estate taxes between the Township and the City is not necessary.

5. Rockford Baptist Church, as owner of the Property to be annexed to the City pursuant to this Agreement, shall have rights and obligations with regard to conditions of annexation and the payment of fees, costs, assessments and hook-up charges on projects previously completed by the City as set forth in a separate Annexation and Assessment Agreement to be entered into between the Church and the City.

6. No consideration by the Minnesota Municipal Board is necessary.

TOWN OF ROCKFORD:

The foregoing Resolution was passed and adopted by the Town Board of the Town of Rockford on the 26th day of September, 1995.

Township:

By Dennis Beier
Its Chairman

ATTEST:

By James Taylor
James Taylor, Town Clerk

CITY OF ROCKFORD:

The foregoing Resolution was adopted by the City Council of the City of Rockford on the 26th day of September, 1995.

City of Rockford:

By Lane Wilson
Lane Wilson, Mayor

ATTEST:

By Ruth David
Ruth David, Clerk-Treasurer

This map is for planning purposes only and should not be used when precise measurements are required.

Property to be Annexed

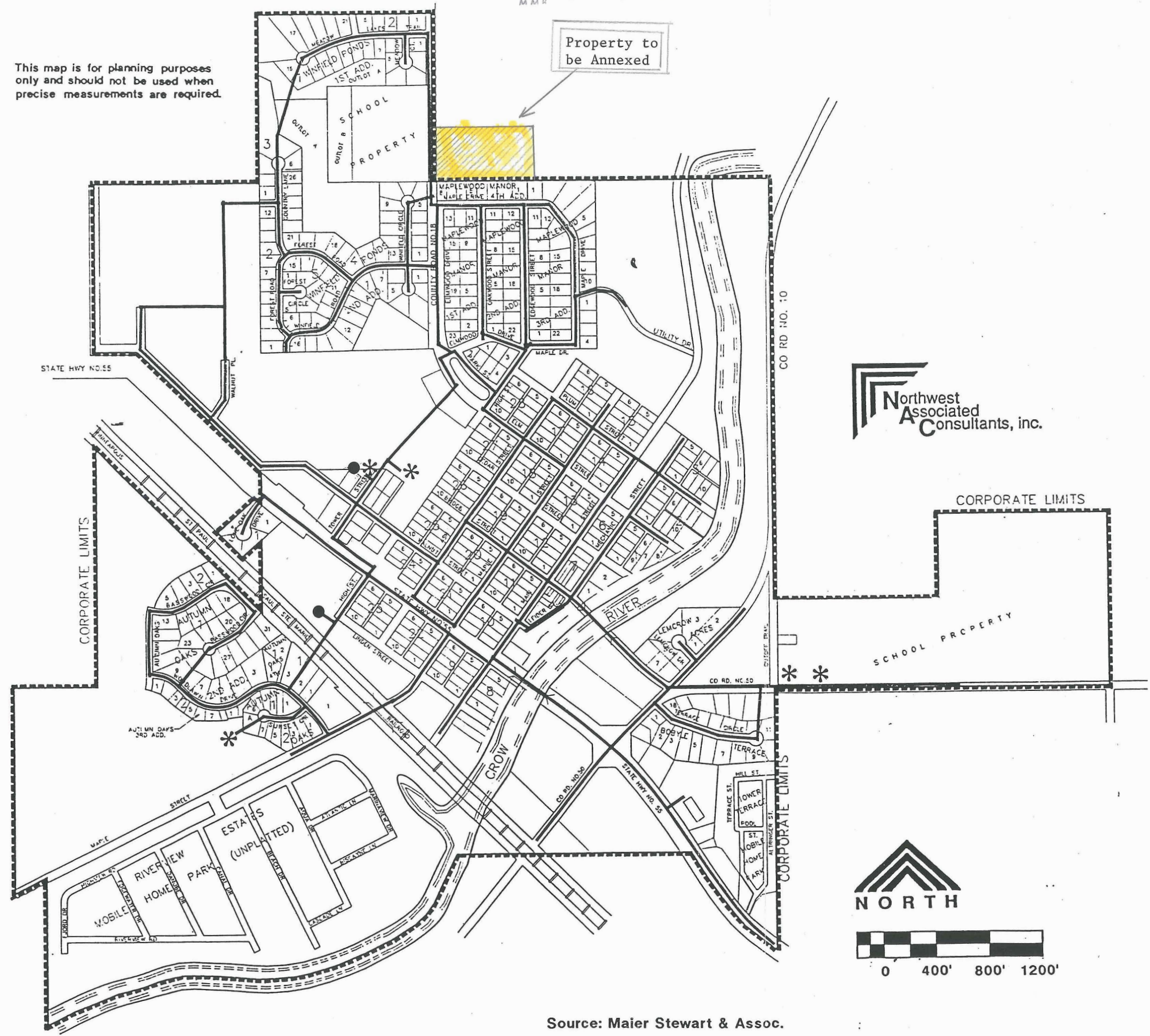

Northwest Associated Consultants, inc.

- WATER MAIN
- WATER TOWER
- * WELL

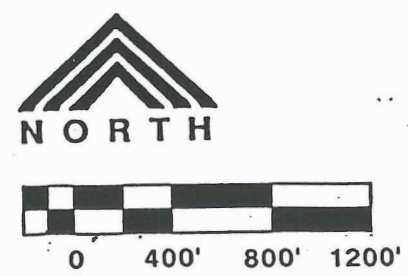

Source: Maier Stewart & Assoc.

WATER SYSTEM

Rockford, Minnesota