

RESOLUTION OF THE CITY OF MANKATO APPROVING ANNEXATION PER JOINT
ORDERLY ANNEXATION AGREEMENT WITH MANKATO TOWNSHIP

WHEREAS, a petition has been submitted by the City for land located in Section 30, Township 108 North, Range 26 West, requesting that said property be annexed to the City of Mankato; and

WHEREAS, the annexation of the property is needed for further development; and

WHEREAS, there are two (2) residents living on said property; and

WHEREAS, the Council of the City of Mankato finds that it is in the best interest of the City to support such annexation.

NOW, THEREFORE, BE IT RESOLVED, that the City Council of Mankato, Minnesota, hereby states that the City has no objection to the annexation of the following described property per M.S. 414.0325 and the joint resolution for orderly annexation approved by Mankato Township and the City of Mankato:

Exhibit A

Upon receipt of this resolution and an annexation petition approved by each party, the Municipal Board may review and comment, but shall, within thirty (30) days, order annexation in accordance with the terms of this joint resolution when an annexation petition is presented to the Municipal Board.

Passed this 8 day of July, 2002.

Mayor 

ATTEST: Cheryl S. Lindquist
City Clerk

EXHIBIT A

Beginning at the East Quarter Corner of Section 30, Township 108 North, Range 26 West; thence South 00 degrees 34 minutes 22 seconds East, (Minnesota County Coordinate System of 1983 - Blue Earth County Zone) along the east line of the Southeast Quarter of Section 30, a distance of 132.00; thence South 89 degrees 00 minutes 44 seconds West, along a line parallel with the east - west center line of Section 30, a distance of 165.00 feet; thence North 27 degrees 13 minutes 14 seconds West, 147.15 feet to a point on the east - west center line of Section 30 distant 231.00 feet westerly of the East Quarter Corner of Section 30 as measured along said east - west center line; thence South 89 degrees 00 minutes 44 seconds West, along the east - west center line of Section 30 a distance of 69.00 feet; thence North 13 degrees 57 minutes 48 seconds West, 80.00 feet; thence North 76 degrees 27 minutes 48 seconds West, 45.00 feet; thence North 04 degrees 02 minutes 12 seconds East, 35.00 feet; thence North 79 degrees 27 minutes 48 seconds West, 55.00 feet; thence North 05 degrees 02 minutes 12 seconds East, 40.00 feet; thence North 64 degrees 42 minutes 48 seconds West, 45.00 feet; thence North 08 degrees 02 minutes 12 seconds East, 30.00 feet; thence North 42 degrees 57 minutes 48 seconds West, 35.00 feet; thence North 63 degrees 57 minutes 48 seconds West, 35.00 feet; thence North 26 degrees 02 minutes 12 seconds East, 30.00 feet; thence South 72 degrees 27 minutes 48 seconds East, 40.00 feet; thence North 02 degrees 02 minutes 12 seconds East, 49.35 feet to a point on the north line of the South half of the Southeast Quarter of the Southeast Quarter of the Northeast Quarter of Section 30, the same being the south line of South Brook Addition Phase Two; thence North 88 degrees 59 minutes 30 seconds East, along said north line, the same being the south line of South Brook Addition Phase Two, a distance of 453.70 feet to the northeast corner of the South half of the Southeast Quarter of the Southeast Quarter of the Northeast Quarter of Section 30; thence South 00 degrees 39 minutes 29 seconds West, along the east line of the Northeast Quarter of Section 30 a distance of 329.95 feet to the point of beginning. Containing 3.66 acres.

AUG 16 2002

TO: Minnesota Planning
Municipal Boundary Adjustments
300 Centennial Office Building
658 Cedar Street
St. Paul, MN 55155

RE: Orderly Annexation Petition: Michael Leider – Leider Subdivision
Proposed Annexation to the City of Mankato

Ladies and Gentlemen:

The Town Board of Mankato Township, Blue Earth County, pursuant to a resolution duly adopted by the town board 6-18, 2002 hereby states that Mankato Township has no objection to the annexation of the following described land to the City of Mankato per M.S. 414.0325 and the Joint Resolution for Orderly Annexation between the City of Mankato and Mankato Township.

Exhibit A

Upon receipt of this resolution and an annexation petition approved by each party, the Municipal Board may review and comment, but shall, within thirty (30) days, order annexation in accordance with the terms of this joint resolution when an annexation petition is presented to the Municipal Board.

Date 6-18-02

Signature

Clerk

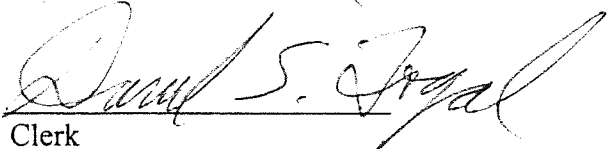

EXHIBIT A

Beginning at the East Quarter Corner of Section 30; thence South 00 degrees 34 minutes 22 seconds East, (Minnesota County Coordinate System of 1983 - Blue Earth County Zone) along the east line of the Southeast Quarter of Section 30, a distance of 132.00; thence South 89 degrees 00 minutes 44 seconds West, along a line parallel with the east - west center line of Section 30, a distance of 165.00 feet; thence North 27 degrees 13 minutes 14 seconds West, 147.15 feet to a point on the east - west center line of Section 30 distant 231.00 feet westerly of the East Quarter Corner of Section 30 as measured along said east - west center line; thence South 89 degrees 00 minutes 44 seconds West, along the east - west center line of Section 30 a distance of 69.00 feet; thence North 13 degrees 57 minutes 48 seconds West, 80.00 feet; thence North 76 degrees 27 minutes 48 seconds West, 45.00 feet; thence North 04 degrees 02 minutes 12 seconds East, 35.00 feet; thence North 79 degrees 27 minutes 48 seconds West, 55.00 feet; thence North 05 degrees 02 minutes 12 seconds East, 40.00 feet; thence North 64 degrees 42 minutes 48 seconds West, 45.00 feet; thence North 08 degrees 02 minutes 12 seconds East, 30.00 feet; thence North 42 degrees 57 minutes 48 seconds West, 35.00 feet; thence North 63 degrees 57 minutes 48 seconds West, 35.00 feet; thence North 26 degrees 02 minutes 12 seconds East, 30.00 feet; thence South 72 degrees 27 minutes 48 seconds East, 40.00 feet; thence North 02 degrees 02 minutes 12 seconds East, 49.35 feet to a point on the north line of the South half of the Southeast Quarter of the Southeast Quarter of the Northeast Quarter of Section 30, the same being the south line of South Brook Addition Phase Two; thence North 88 degrees 59 minutes 30 seconds East, along said north line, the same being the south line of South Brook Addition Phase Two, a distance of 453.70 feet to the northeast corner of the South half of the Southeast Quarter of the Southeast Quarter of the Northeast Quarter of Section 30; thence South 00 degrees 39 minutes 29 seconds West, along the east line of the Northeast Quarter of Section 30 a distance of 329.95 feet to the point of beginning. Containing 3.66 acres.

REC'D BY
MMB

AUG 16 2002

(HU) CY 22-02
Preliminary Plat Review
General Location Map

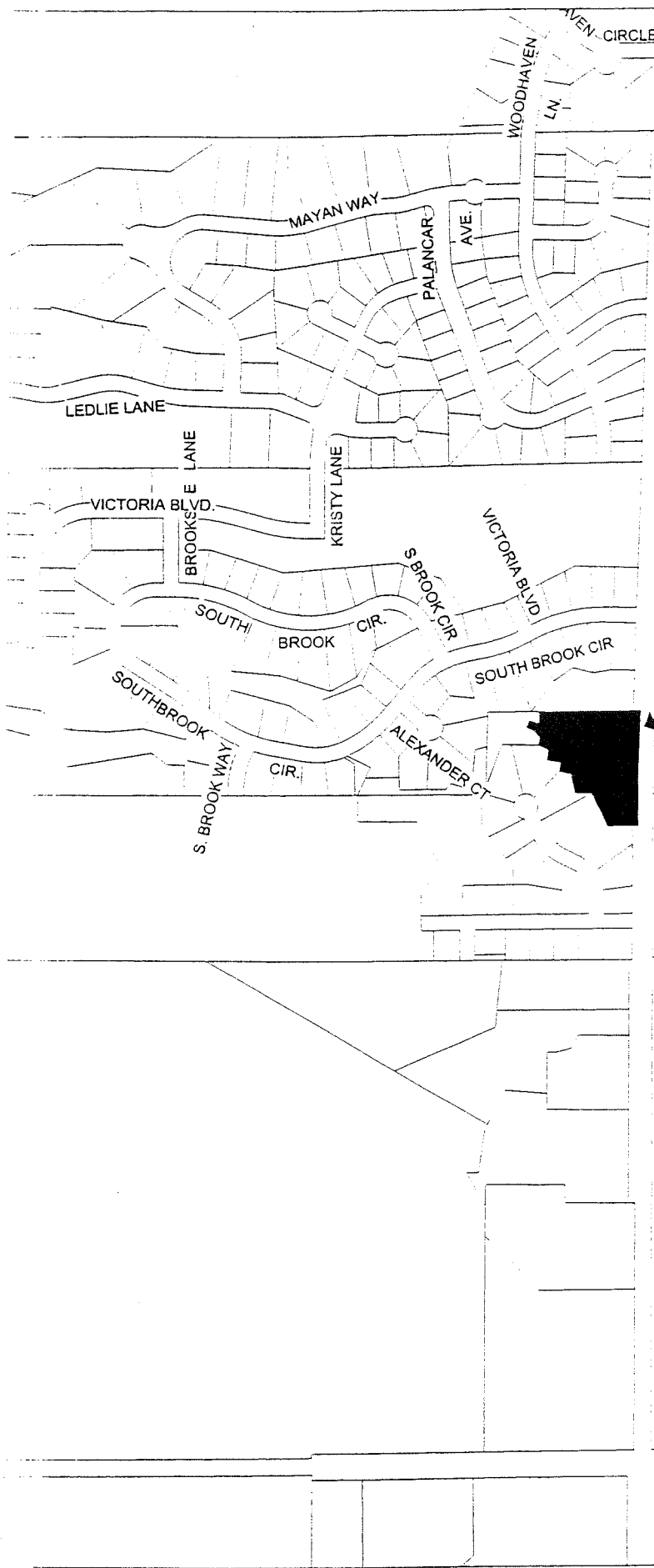

MONKS AVE

Subject Property

8



LEIDER ADDITION

CITY OF MANKATO
BLUE EARTH COUNTY, MINNESOTA

REC'D BY
MMB
AUG 16 2002

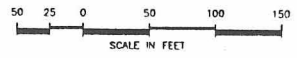
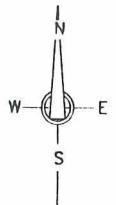

INDICATES 1/2" DIA. X 20" LONG PIPER SET WITH PLASTIC CAP MARKED BY LICENSE NO. 13114.

INDICATES PIPER PIPE MONUMENTS FOUND.

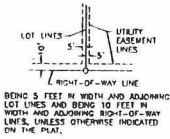

LEGEND

A=100.00' INDICATES ARC DISTANCE
 R=100.00' INDICATES RADIUS LENGTH
 C=90°00'00" INDICATES CENTRAL ANGLE
 PC INDICATES POINT OF CURVATURE
 PT INDICATES POINT OF TANGENCY

