

REC'D BY  
MMB

JUN 12 2002

RESOLUTION OF THE CITY OF MANKATO APPROVING ANNEXATION PER JOINT  
ORDERLY ANNEXATION AGREEMENT WITH MANKATO TOWNSHIP

WHEREAS, a petition has been submitted by the City for land located in Sections 15,  
Township 108 North, Range 26 West, requesting that said property be annexed to the City of  
Mankato; and

WHEREAS, the annexation is for City right-of-way; and

WHEREAS, there are no residents living on said property; and

WHEREAS, the Council of the City of Mankato finds that it is in the best interest of the City  
to support such annexation.

NOW, THEREFORE, BE IT RESOLVED, that the City Council of Mankato, Minnesota,  
hereby states that the City has no objection to the annexation of the following described property per  
M.S. 414.0325 and the joint resolution for orderly annexation approved by Mankato Township and  
the City of Mankato:

See Exhibit A

Upon receipt of this resolution and an annexation petition approved by each party, the Municipal  
Board may review and comment, but shall, within thirty (30) days, order annexation in accordance  
with the terms of this joint resolution when an annexation petition is presented to the Municipal  
Board.

Passed this 13 day of May, 2002.

  
\_\_\_\_\_  
Mayor

ATTEST: Cheryl S. Hindquist  
City Clerk

## EXHIBIT A

An easement for street and utility purposes over, under, and across part of the East Half of the West Half of the Northwest Quarter of Section 15, Township 108 North, Range 26 West, Blue Earth County, Minnesota described as: Beginning at the Southwest corner of Lot 5, Block One, Government Service Center, according to the recorded plat thereof; thence North 00 degrees 26 minutes 56 seconds West (bearings based on said Government Service Center) along the West line of said Lot 5, a distance of 10.00 feet to a point on an 870.00 foot radius curve to the left having a central angle of 15 degrees 34 minutes 04 seconds, a 235.66 foot chord which bears South 81 degrees 24 minutes 10 seconds West; thence along said curve, 236.39 feet to the point of curvature of a reverse 770.00 foot radius curve to the right having a central angle of 15 degrees 32 minutes 44 seconds and a 208.28 foot chord which bears South 81 degrees 23 minutes 30 seconds West; thence along said curve 208.92 feet to the point of tangency; thence South 89 degrees 09 minutes 52 seconds West, 224.02 feet to the Northeast corner of Bassett Drive, Mankato Heights Plaza, according to the recorded plat thereof; thence along the East line of said Bassett Drive, South 00 degrees 32 minutes 35 seconds East, 100.00 feet to the Southeast corner of said Bassett Drive; thence North 89 degrees 09 minutes 52 seconds East, 224.53 feet to the point of curvature of a 870.00 foot radius curve to the left having a central angle of 15 degrees 32 minutes 44 seconds and a 235.33 foot chord which bears North 81 degrees 23 minutes 30 seconds East; thence along said curve 236.05 feet to a point on a reverse 770.00 foot radius curve to the right having a central angle of 15 degrees 31 minutes 13 seconds and a 207.94 foot chord which bears North 81 degrees 22 minutes 45 seconds East; thence along said curve 208.58 feet to the East line of said West Half of the Northwest Quarter; thence along said East line North 00 degrees 26 minutes 56 seconds West, 90.00 feet to the point of beginning.

TO: Minnesota Planning  
Municipal Boundary Adjustments  
300 Centennial Office Building  
658 Cedar Street  
St. Paul, MN 55155

REC'D BY  
MMB

JUN 12 2002

RE: Orderly Annexation Petition: City of Mankato  
Proposed Annexation to the City of Mankato

Ladies and Gentlemen:

The Town Board of Mankato Township, Blue Earth County, pursuant to a resolution duly adopted by the town board 5-21, 2002 hereby states that Mankato Township has no objection to the annexation of the following described land to the City of Mankato per M.S. 414.0325 and the Joint Resolution for Orderly Annexation between the City of Mankato and Mankato Township.

See Exhibit "A" attached

Upon receipt of this resolution and an annexation petition approved by each party, the Municipal Board may review and comment, but shall, within thirty (30) days, order annexation in accordance with the terms of this joint resolution when an annexation petition is presented to the Municipal Board.

Date 5-21-02

Signature

Clerk

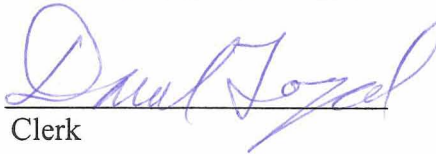

REC'D BY  
MMB

JUN 12 2002

## EXHIBIT A

An easement for street and utility purposes over, under, and across part of the East Half of the West Half of the Northwest Quarter of Section 15, Township 108 North, Range 26 West, Blue Earth County, Minnesota described as: Beginning at the Southwest corner of Lot 5, Block One, Government Service Center, according to the recorded plat thereof; thence North 00 degrees 26 minutes 56 seconds West (bearings based on said Government Service Center) along the West line of said Lot 5, a distance of 10.00 feet to a point on an 870.00 foot radius curve to the left having a central angle of 15 degrees 34 minutes 04 seconds, a 235.66 foot chord which bears South 81 degrees 24 minutes 10 seconds West; thence along said curve, 236.39 feet to the point of curvature of a reverse 770.00 foot radius curve to the right having a central angle of 15 degrees 32 minutes 44 seconds and a 208.28 foot chord which bears South 81 degrees 23 minutes 30 seconds West; thence along said curve 208.92 feet to the point of tangency; thence South 89 degrees 09 minutes 52 seconds West, 224.02 feet to the Northeast corner of Bassett Drive, Mankato Heights Plaza, according to the recorded plat thereof; thence along the East line of said Bassett Drive, South 00 degrees 32 minutes 35 seconds East, 100.00 feet to the Southeast corner of said Bassett Drive; thence North 89 degrees 09 minutes 52 seconds East, 224.53 feet to the point of curvature of a 870.00 foot radius curve to the left having a central angle of 15 degrees 32 minutes 44 seconds and a 235.33 foot chord which bears North 81 degrees 23 minutes 30 seconds East; thence along said curve 236.05 feet to a point on a reverse 770.00 foot radius curve to the right having a central angle of 15 degrees 31 minutes 13 seconds and a 207.94 foot chord which bears North 81 degrees 22 minutes 45 seconds East; thence along said curve 208.58 feet to the East line of said West Half of the Northwest Quarter; thence along said East line North 00 degrees 26 minutes 56 seconds West, 90.00 feet to the point of beginning.



REC'D BY  
MMB

JUN 12 2002



Subject Property

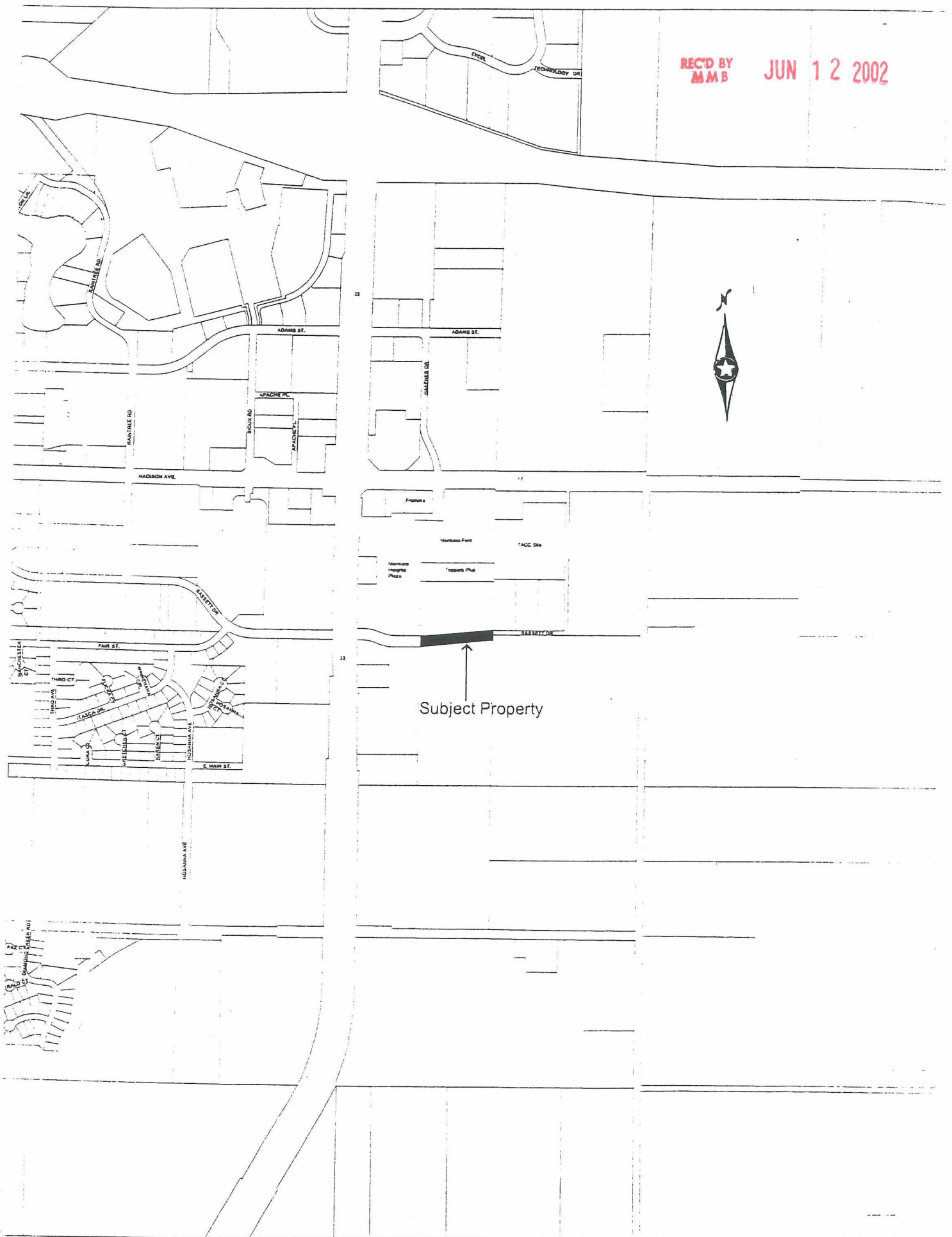

REC'D BY  
MMB

JUN 12 2002

BLOCK ONE  
3

BLOCK ONE  
GOVERNMENT SERVICE CENTER  
3

CARVER ROAD

BASSETT  
DRIVE

MANKATO  
HEIGHTS  
PLAZA

EAST LINE MANKATO HEIGHTS PLAZA

WEST LINE E 1/2 - W 1/2 - NW 1/4, SECTION 15-108-26

SECTION 15  
TOWNSHIP 108 NORTH  
RANGE 26 WEST  
E 1/2  
W 1/2

I hereby certify that this survey was prepared by me or under my direct supervision and that I am a duly Registered Land Surveyor under the laws of the State of Minnesota.

*Janele Fowles*  
Janele Fowles  
1-4-02  
Date License No. 26748

100 0 100  
SCALE IN FEET

S 89°09'52"W 224.02'

CH= 208.28'  
CB= S81°23'30"W  
C= 15°32'44"

L= 208.92' R= 770.00'

NW 1/4

CH= 235.86'  
CB= S81°24'10"W  
C= 15°34'04"

L= 236.39' R= 870.00'

N 00°26'56"W  
100.00'

POINT OF BEGINNING  
ROADWAY EASEMENT

BASSETT DRIVE

# PROPOSED DESCRIPTION

## ROADWAY EASEMENT:

An easement for street and utility purposes over, under, and across part of the East Half of the West Half of the Northwest Quarter of Section 15, Township 108 North, Range 26 West, Blue Earth County, Minnesota described as: Beginning at the Southwest corner of Lot 5, Block One, Government Service Center, according to the recorded plat thereof; thence North 00 degrees 26 minutes 56 seconds West (bearings based on said Government Service Center) along the West line of said Lot 5, a distance of 10.00 feet to a point on an 870.00 foot radius curve to the left having a central angle of 15 degrees 34 minutes 04 seconds, a 235.86 foot chord which bears South 81 degrees 24 minutes 10 seconds West; thence along said curve, 236.39 feet to the point of curvature of a reverse 770.00 foot radius curve to the right having a central angle of 15 degrees 32 minutes 44 seconds and a 208.28 foot chord which bears South 81 degrees 23 minutes 30 seconds West; thence along said curve 208.92 feet to the point of tangency; thence South 89 degrees 09 minutes 52 seconds West, 224.02 feet to the Northeast corner of Bassett Drive, Mankato Heights Plaza, according to the recorded plat thereof; thence along the East line of said Bassett Drive, South 00 degrees 32 minutes 35 seconds East, 100.00 feet to the Southeast corner of said Bassett Drive; thence North 89 degrees 09 minutes 52 seconds East, 224.53 feet to the point of curvature of a 870.00 foot radius curve to the left having a central angle of 15 degrees 32 minutes 44 seconds and a 235.33 foot chord which bears North 81 degrees 23 minutes 30 seconds East; thence along said curve 236.05 feet to a point on a reverse 770.00 foot radius curve to the right having a central angle of 15 degrees 22 minutes 45 seconds East; thence along said curve 208.58 feet to the East line of said West Half of the Northwest Quarter; thence along said East line North 00 degrees 26 minutes 56 seconds West, 90.00 feet to the point of beginning.

SKETCH OF EASEMENT  
CITY OF MANKATO, MINNESOTA



**BOLTON & MENK, INC.**

Consulting Engineers & Surveyors

1960 PREMIER DRIVE, MANKATO, MN 56001 (507) 825-4171  
MANKATO, MN FAIRMONT, MN SLEEPY EYE, MN WILMAR, MN  
BURNSVILLE, MN CHASKA, MN AMES, IA LIBERTY, MO

PART OF THE E 1/2 - W 1/2 -  
NW QUARTER, SECTION 5, TOWNSHIP  
108 NORTH, RANGE 26 WEST,  
BLUE EARTH COUNTY

FOR: CITY OF MANKATO

JOB NUMBER: M16.32711

FIELD BOOK: SEE FILE

DRAWN BY: BAP

T-U, 12-13