

JAN 23 2013

RESOLUTION OF THE CITY OF MANKATO APPROVING ANNEXATION OF
PROPERTY IN ACCORDANCE WITH THE ORDERLY ANNEXATION AGREEMENT
WITH MANKATO TOWNSHIP

WHEREAS, petitions have been submitted by the owner of property described as That part of the West Half of the Northeast Quarter of Section 10 all in Township 108 North Range 26 West, Blue Earth County, Minnesota, described as:

Commencing at the northeast corner of said Section 10; thence South 00 degrees 24 minutes 24 seconds East, (Minnesota County Coordinate System - Blue Earth County Zone, NAD 83 - 1986), along the east line of the Northeast Quarter of said Section 10 a distance of 85.00 feet to a point on the Southerly 85.00 foot wide right of way line of Parcel V, of Blue Earth County Highway Right Of Way Plat No. 13, on file and of record with the Blue Earth County Recorder; thence South 89 degrees 15 minutes 15 seconds West, along said southerly right of way line, 1315.78 feet to the point of intersection with the east line of the West Half of the Northeast Quarter of said Section 10, said point being the southeasterly corner of Parcel U2, according to said right of way plat; thence continuing South 89 degrees 15 minutes 15 seconds West, along said southerly line of said Parcel U2, according to said right of way plat, 406.54 feet to the northwest corner of Sohler Drive according to the plat of Eastwood Industrial Park No. 3, on file and of record with the Blue earth County Recorder, said point being the point of beginning; thence South 00 degrees 17 minutes 16 seconds East, along the westerly line of said Sohler Drive, 655.98 feet to the northeast corner of Lot 1, Block 1, Eastwood Industrial Park No. 3; thence South 89 degrees 30 minutes 20 seconds West, along the north line of said Lot 1, a distance of 892.60 feet to the northwest corner of said Lot 1; thence North 00 degrees 07 minutes 25 seconds West, along the easterly line of Eastwood Industrial Park No. 2, according to the plat thereof on file and of record with the Blue Earth County Recorder, 652.08 feet to the most northeast corner of said Eastwood Industrial Park No. 2; thence North 89 degrees 15 minutes 15 seconds East, along the southerly line of Parcel U1, Parcel V, and Parcel U2, according to said Blue Earth County Highway Right Of Way Plat No. 13, a distance of 890.76 feet to the point of beginning; and

WHEREAS, the property is legally described in the attached petition; and

WHEREAS, the annexation of the property is being requested in order for city services to be extended for industrial development purposes; and

WHEREAS, there are zero (0) people living on the subject property; and

WHEREAS, the Council of the City of Mankato finds that it is in the best interest of the City to support such annexation.

NOW, THEREFORE, BE IT RESOLVED, that the City Council of Mankato, Minnesota, hereby states that the City has no objection to the annexation of the following described property and the City of Mankato hereby annexes said property per M.S. 414.0325.

Upon receipt of this resolution and an annexation petition approved by each party to the joint resolution, the Municipal Board may review and comment, but shall, within thirty (30) days, order annexation in accordance with the terms of this joint resolution when an annexation petition is presented to the Municipal Board.

REC'D BY
MBA

JAN 23 2013

Sohler Annexation
Page 2 of 2

Passed this 14 day of January, 2013.



Mayor

ATTEST: Cheryl Stindzius
City Clerk

General Location Map

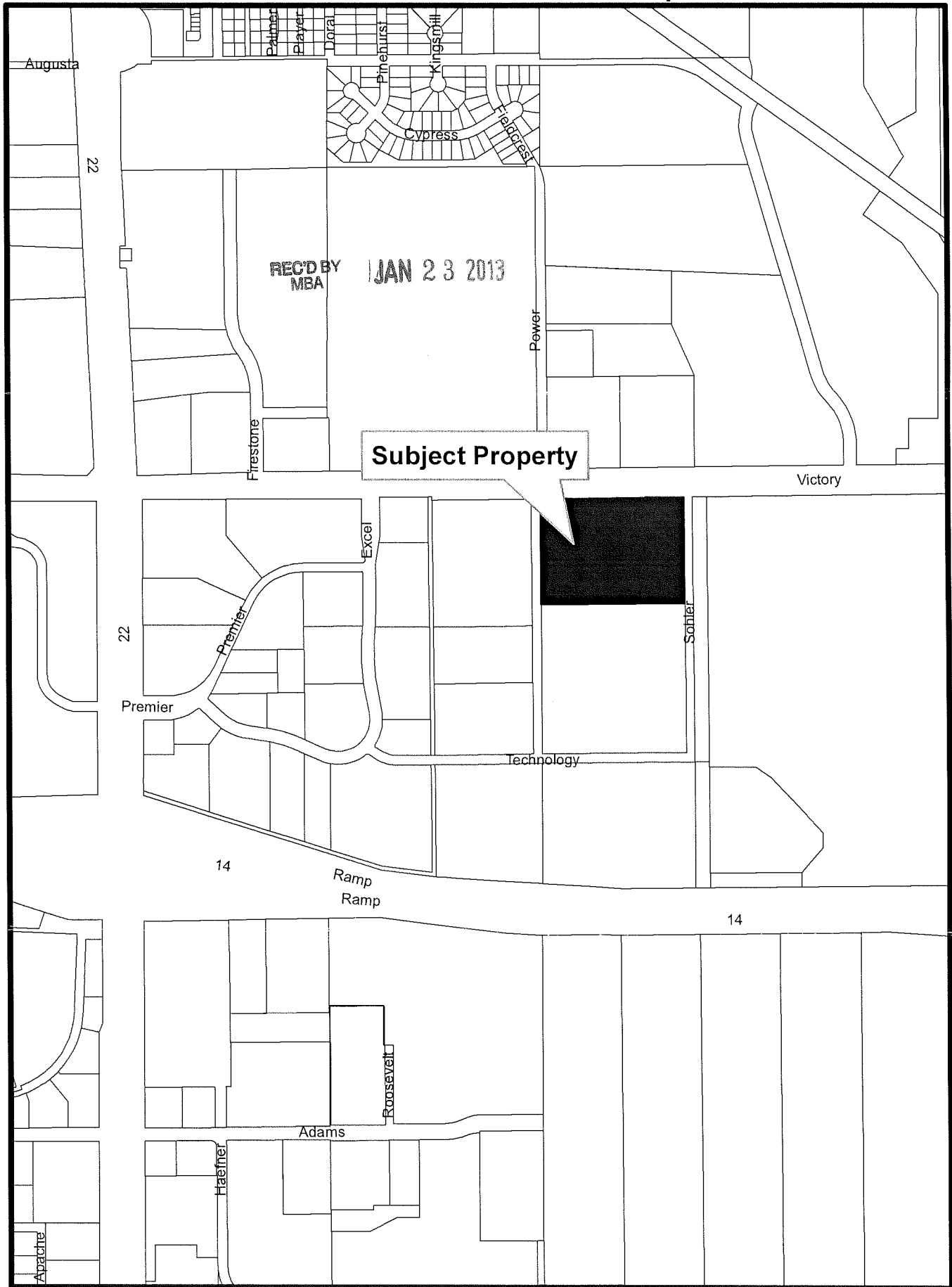

0 250 500 1,000 Feet



TO: Department of Administration
Municipal Boundary Adjustments
300 Centennial Office Building
658 Cedar Street
St. Paul, MN 55155

REC'D BY
MBA

JAN 23 2013

RE: Orderly Annexation Petition: James, Elizabeth, and Dorothy Sohler

Proposed Annexation to the City of Mankato

Ladies and Gentlemen:

The Town Board of Mankato Township, Blue Earth County, pursuant to a resolution duly adopted by the town board 11-19, 2012 hereby states that Mankato Township has no objection to the annexation of the following described land to the City of Mankato per M.S. 414.0325 and the Joint Resolution for Orderly Annexation between the City of Mankato and Mankato Township.

That part of the West Half of the Northeast Quarter of Section 10 all in Township 108 North Range 26 West, Blue Earth County, Minnesota, described as:

Commencing at the northeast corner of said Section 10; thence South 00 degrees 24 minutes 24 seconds East, (Minnesota County Coordinate System - Blue Earth County Zone, NAD 83 - 1986), along the east line of the Northeast Quarter of said Section 10 a distance of 85.00 feet to a point on the Southerly 85.00 foot wide right of way line of Parcel V, of Blue Earth County Highway Right Of Way Plat No. 13, on file and of record with the Blue Earth County Recorder; thence South 89 degrees 15 minutes 15 seconds West, along said southerly right of way line, 1315.78 feet to the point of intersection with the east line of the West Half of the Northeast Quarter of said Section 10, said point being the southeasterly corner of Parcel U2, according to said right of way plat; thence continuing South 89 degrees 15 minutes 15 seconds West, along said southerly line of said Parcel U2, according to said right of way plat, 406.54 feet to the northwest corner of Sohler Drive according to the plat of Eastwood Industrial Park No. 3, on file and of record with the Blue earth County Recorder, said point being the point of beginning; thence South 00 degrees 17 minutes 16 seconds East, along the westerly line of said Sohler Drive, 655.98 feet to the northeast corner of Lot 1, Block 1, Eastwood Industrial Park No. 3; thence South 89 degrees 30 minutes 20 seconds West, along the north line of said Lot 1, a distance of 892.60 feet to the northwest corner of said Lot 1; thence North 00 degrees 07 minutes 25 seconds West, along the easterly line of Eastwood Industrial Park No. 2, according to the plat thereof on file and of record with the Blue Earth County Recorder, 652.08 feet to the most northeast corner of said Eastwood Industrial Park No. 2; thence North 89 degrees 15 minutes 15 seconds East, along the southerly line of Parcel U1, Parcel V, and Parcel U2, according to said Blue Earth County Highway Right Of Way Plat No. 13, a distance of 890.76 feet to the point of beginning.

Date 11-19-12

Signature Daryl Zepal

Clerk

702
11/19/12