

REC'D BY
MAR
AUG 24 1994

A RESOLUTION ANNEXING PROPERTY

WHEREAS, the City of Buffalo and Township of Buffalo have entered into a certain agreement dated August 2, 1993, which has been previously approved by the Minnesota Municipal Board, to provide for the orderly annexation of certain lands as described therein to the City of Buffalo; and,

WHEREAS, those lands described herein are contained in the orderly annexation area, and are scheduled according to said agreement for annexation to the City in 1993; and,

WHEREAS, the orderly annexation of any lands subject thereto may be accomplished in the year provided for by the adoption of a resolution by the Common Council annexing the same.

NOW, THERETO, BE IT RESOLVED BY THE CITY COUNCIL OF THE CITY OF BUFFALO:

that the following described lands are annexed on the date set forth further herein to the City of Buffalo:

(insert legals)
see attached exhibit

BE IT FURTHER RESOLVED that a copy of the resolution shall be filed by the City Administrator with the Minnesota Municipal Board, the Buffalo Township Board of Supervisors, and the Wright County Auditor.

BE IT FURTHER RESOLVED that the annexation of the lands described shall be effective on the date this resolution is approved by the Minnesota Municipal Board, as provided in the orderly annexation agreement.

Adopted by the City Council this 1st day
of August,
1994.

ss/Fred Naaktgeboren
Mayor

ss/Merton T. Auger
City Administrator

City Seal

STATE OF MINNESOTA, COUNTY OF WRIGHT
Certified to be a true and correct copy of the
original on file and of record dated 8-1-94
in my office.

DATED 8-23-94
Merton T. Auger, City Administrator

by Lauren Bodin
Assistant Administrator

REC'D BY
M M R

AUG 24 1994

**EXHIBIT A
LEGAL DESCRIPTION**

All that part of the NE $\frac{1}{4}$ of the SE $\frac{1}{4}$ of Section 29, Township 120,
Range 25, Wright County, Minnesota.

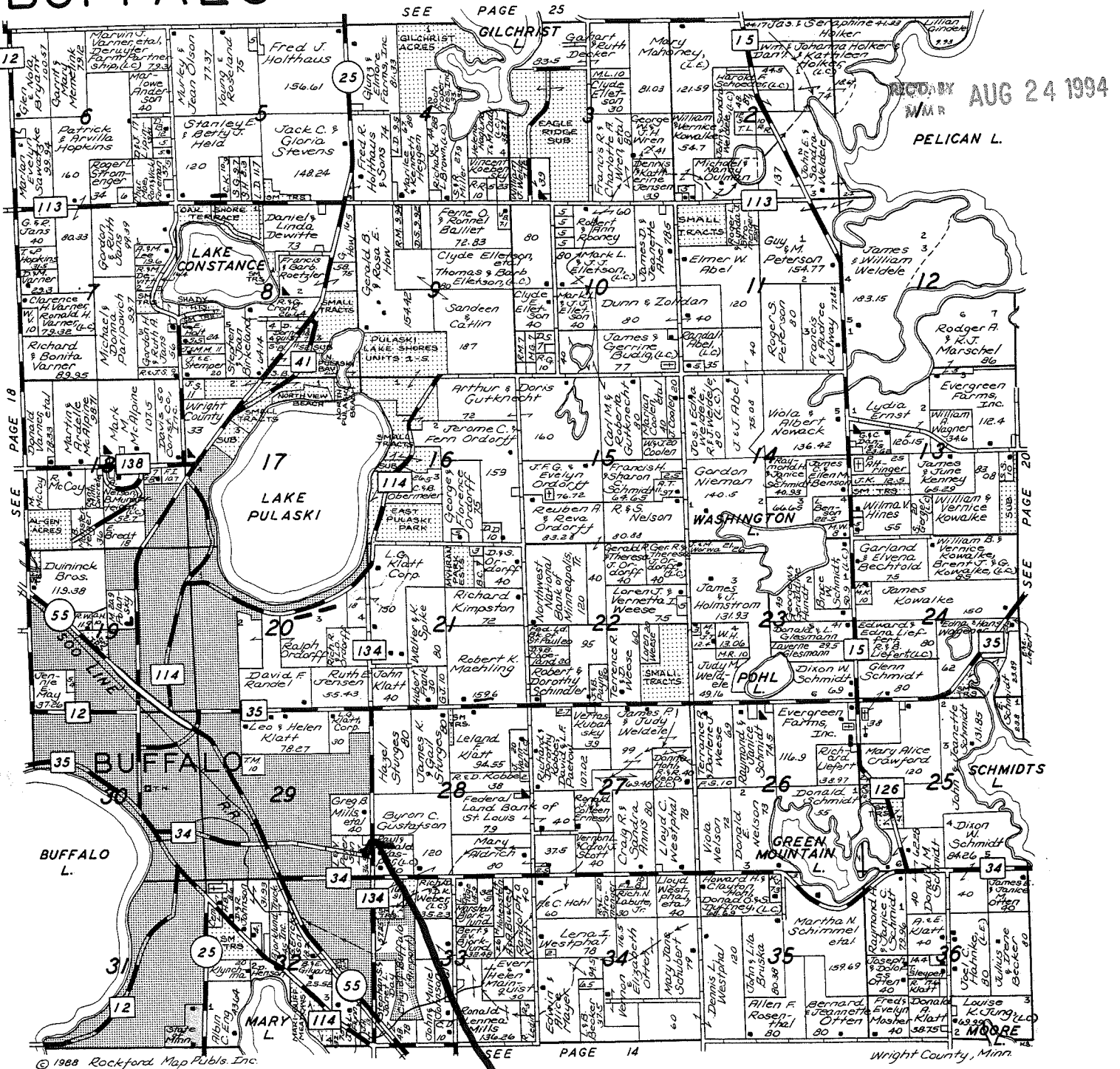

Mercury and Evinrude Outboards • Sun Patio Pontoons
Lund and Alumacraft Boats



Highway 55
Maple Lake,
Minnesota 55358
(612) 963-3025



985 Highway 10
St. Cloud,
Minnesota 56301
(612) 252-3035

Title Insurance and Abstracting by Wright Title Guarantee Co. and Sherburne Title Guarantee Co.

400 Jackson Street
P.O. Box 390
Elk River,
Minnesota 55330
Metro Phone: (612) 441-5465

109 South Second Street
P.O. Box 315
Buffalo, Minnesota 55313
Local Phone: (612) 682-2023
Metro Phone: (612) 477-6312

REPRESENTING STEWART TITLE

R.25

WRIGHT COUNTY MINNESOTA

