

## RESOLUTION NO. 11112

## RESOLUTION GRANTING APPROVAL OF ORDERLY ANNEXATION TO THE CITY OF HUTCHINSON OF 8 ACRES LOCATED IN LYNN TOWNSHIP

BE IT RESOLVED BY THE CITY COUNCIL OF THE CITY OF HUTCHINSON, MN:

WHEREAS, certain territory described below has been designated for orderly annexation to the City of Hutchinson is urban in character, or about to become so; and

WHEREAS, the following described property is totally within the Orderly Annexation Agreement and abuts property within the City of Hutchinson ;

Legal Description: Part of the Northeast Quarter of Section 13, Township 116 North, Range 30 West, and more particularly described as follows: Beginning at a point, said point being the intersection of the Westerly 75 foot right of way line of Minnesota State Trunk Highway #15 with the North line of said Northeast Quarter of Section 13; thence Westerly along said North line of Northeast Quarter 1356.61 feet; thence Southerly on a line parallel with the said Westerly 75 foot right of way line, 208.71 feet; thence Easterly on a line parallel with the North line of said Northeast Quarter, 1147.9 feet; thence Southerly on a line parallel with the said Westerly 75 foot right of way line, 730.49 feet; thence Easterly on a line parallel with the North line of said Northeast Quarter 208.71 feet to the said Westerly 75 foot right of way line; thence North along said right of way line, 939.2 feet to point of beginning, excepting therefrom the South 208.71 feet;

ALSO real property and real property rights deeded to the State of Minnesota by Warranty Deed dated December 17, 1997, filed January 6, 1998, as Document No. 283469 (real estate is legally described as follows: that part of the Northeast Quarter of the Northeast Quarter of Section 13, Township 116 North, Range 30 West, shown as Parcel 247 E on Minnesota Department of Transportation Right of Way Plat Numbered 43-21 as the same is on file and of record in the office of the County Recorder in and for McLeod County, Minnesota; containing 2.73 acres, more or less).

The above described property is subject to that certain permanent roadway easement dated January 24, 1992, filed March 20, 1992, as Document No. 244098, in Book 124 of Miscellaneous, pages 79-80.

ALSO that part of the Northeast Quarter of Section 13, Township 116 North, Range 30 West, McLeod County, Minnesota, described as follows:

Beginning at the Northeast corner of said Northeast Quarter; thence Westerly along the north line of said Northeast Quarter to the Westerly right of way line of Minnesota Trunk Highway 15; thence southerly along said right of way line a distance of 730.49 feet; thence easterly, parallel with said north line to the east line of said Northeast Quarter; thence northerly along said east line to the point of beginning.

WHEREAS, the property is agricultural and shall receive a "tax break" consisting of a staged, graduated increase in mill rates from the township rate to the city rate over a five (5) year period.

AND, WHEREAS, The orderly annexation agreement between the Township of Lynn and the City of Hutchinson states no consideration by the Minnesota Municipal Board is necessary, the board may review and comment, but shall, within 30 days, order the annexation in accordance with the terms of this joint resolution.

NOW, THEREFORE BE IT RESOLVED, that the City of Hutchinson requests the property described be annexed by order of the Minnesota Municipal Board within 30 days.

Adopted by the City Council for the City of Hutchinson this 22nd day of December, 1998.

ATTEST:

  
\_\_\_\_\_  
Gary D. Plotz  
City Administrator

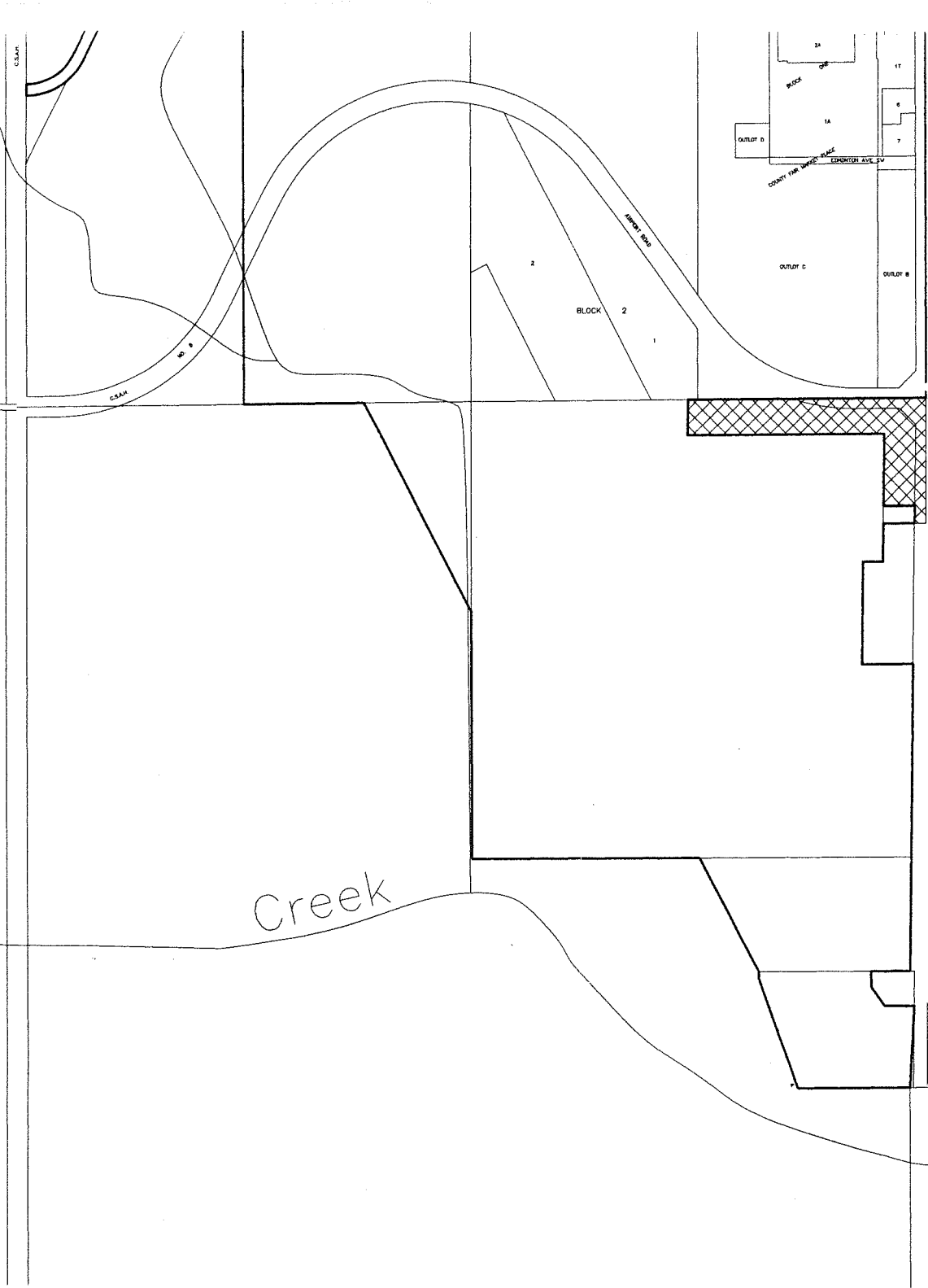

  
\_\_\_\_\_  
Marlin D. Forgeron  
Mayor

REC'D. BY  
M.A.B. DEC 28 1998



1	BLOCK	2	3	4	5	6	7
1	BREZZY	2	3	4	5	6	7
1	HEAROW	2	3	4	5	6	7

CSAK NO. 8

 Area to be Annexed  
 City Limits



Creek

1	2	BLOCK	3	4	5	6	7
1	2	HASSAN	3	4	5	6	7
1	2	VEILEY	3	4	5	6	7

1	2	COMMERCIAL	3	4	5	6	7
1	2	PARK	3	4	5	6	7
1	2	BLOCK	3	4	5	6	7