

REC'D. BY  
MMB JUL 19 1993

BEFORE THE  
MINNESOTA MUNICIPAL BOARD

---

IN THE MATTER OF THE DESCRIPTION OF	)	
AN UNINCORPORATED AREA IN ROCHESTER	)	
TOWNSHIP AS IN NEED OF ORDERLY	)	JOINT RESOLUTION FOR
ANNEXATION AND CONFERRING JURISDICTION	)	ORDERLY ANNEXATION
OVER SAID AREA IN THE MINNESOTA	)	
MUNICIPAL BOARD PURSUANT TO MINNESOTA	)	
STATUTES §414.0325.	)	

---

WHEREAS, the City of Rochester desires the immediate annexation to the City of Rochester that property described in the attached Exhibit A situated in the Town of Rochester, County of Olmsted, State of Minnesota; and

WHEREAS, the City of Rochester and the Town of Rochester, for the purpose of avoiding a dispute over the annexation of the property described in said petition, desire to enter into a joint resolution approving the immediate annexation of said property.

NOW, THEREFORE, BE IT RESOLVED by the City of Rochester and the Town of Rochester:

1. The property which is situated in the Town of Rochester, County of Olmsted, State of Minnesota and which is described on the attached Exhibit A is designated as in need of orderly annexation pursuant to Minnesota Statutes §414.0325, as it may be amended from time to time.

2. The Town of Rochester hereby withdraws any objections filed and agrees to not file any objections with the Minnesota Municipal Board concerning the City of Rochester's desire or request to annex any of the property described on the attached Exhibit A and hereby consents to the immediate annexation by ordinance to the City of Rochester of all said property, subject to the terms and conditions of this resolution. The annexation of said property may be accomplished by more than one ordinance adopted in sequence at the discretion of the City. The Town of Rochester further agrees that if it has filed any objections with the Minnesota Municipal Board to the annexation to the City of any of the property described in attached Exhibit A, the filing of this Joint Resolution with the Minnesota Municipal Board shall constitute sufficient notice of the withdrawal of the objections.

3. Pursuant to the provisions of Minnesota Statutes §414.0325, subd. 5, the parties agree that the City of Rochester may extend its planning and land use controls to all property designated for orderly annexation.

4. Pursuant to the provisions of Minnesota Statutes §414.036, the City of Rochester agrees to pay the Town of Rochester a sum of money in

1994, 1995, and 1996. The sum to be paid shall equal the amount of taxes levied by the Town of Rochester in 1993 (pursuant to its 1993 tax rate) upon the property annexed as part of this Joint Resolution.

PASSED AND ADOPTED BY THE COMMON COUNCIL OF THE CITY OF ROCHESTER, MINNESOTA, THIS 7 DAY OF June, 1993.

Nancy B. Selby  
PRESIDENT OF SAID COMMON COUNCIL

ATTEST: Cassie Anderson  
CITY CLERK

APPROVED THIS 8 DAY OF June, 1993.

Chuck Reynolds  
MAYOR OF SAID CITY

(Seal of the City of Rochester, Minnesota)

PASSED AND ADOPTED BY THE TOWN OF ROCHESTER, MINNESOTA, THIS

21 DAY OF MAY, 1993.

Brenda Decker  
CHAIRMAN OF TOWN BOARD

ATTEST: Gary Danova  
TOWN CLERK

## EXHIBIT A

## Parcel 1

That part of the South Half of the Northwest Quarter of Section 14, Township 106 North, Range 14 West, Olmsted County, Minnesota, described as follows:

Commencing at the southeast corner of said Northwest Quarter; thence northerly on a Minnesota State Plane Grid Azimuth from north of 358 degrees 23 minutes 35 seconds along the east line of said Northwest Quarter 556.73 feet; thence westerly 358 degrees 23 minutes 35 seconds azimuth 396.00 feet to the northeast corner of Block 1 of Meadow Hills Second Subdivision, according to the plat thereof on file at the County Recorder's Office, Olmsted County, Minnesota, and the point of beginning; thence continue westerly 268 degrees 23 minutes 35 seconds azimuth along the northerly line of said Block 1 and the northerly line of Meadow Hills First Subdivision and Meadow Hills Third Subdivision, according to the plats thereof on file at the County Recorder's Office, Olmsted County, Minnesota, 1302.60 feet to the southeasterly corner of Meadow Hills Fifth Subdivision, according to the plat thereof on file at the County Recorder's Office, Olmsted County, Minnesota; thence northerly 358 degrees 23 minutes 35 seconds azimuth along the easterly line of said Meadow Hills Fifth Subdivision 440.00 feet to the southwesterly corner of Meadow Hills Sixth Subdivision, according to the plat thereof on file at the County Recorder's Office, Olmsted County, Minnesota; thence easterly 88 degrees 23 minutes 35 seconds azimuth along the southerly line of said Meadow Hills Sixth Subdivision 636.27 feet to the southeasterly corner of Block 2 of said Meadow Hills Sixth Subdivision; thence continue easterly 88 degrees 23 minutes 35 seconds azimuth on projection of said southerly line 273.33 feet to the intersection with said southerly line; thence continue easterly 88 degrees 23 minutes 35 seconds azimuth along said southerly line 575.40 feet; thence southerly 178 degrees 23 minutes 35 seconds azimuth 150.00 feet to the northwesterly corner of Block 3 of said Meadow Hills Second Subdivision; thence continue southerly 178 degrees 23 minutes 35 seconds azimuth along the westerly line of said Block 3, a distance of 151.36 feet to the southwesterly corner of said Block 3; thence westerly 268 degrees 23 minutes 35 seconds azimuth along the northerly line of 24th Street S.W. 49.40 feet; thence southwesterly along the northwesterly line of 24th Street S.W. 208.92 feet on a tangential curve concave southeasterly, having a central angle of 90 degrees 00 minutes 00 seconds, and a radius of 133.00 feet; thence southerly 178 degrees 23 minutes 35 seconds azimuth along the westerly line of 24th Street S.W. 5.64 feet to the point of beginning.

Said tract contains 14.51 acres more or less.

Parcel 2

That part of the Southeast Quarter of the Southwest Quarter and of the Southwest Quarter of the Southeast Quarter of Section 10, Township 106 North, Range 14 West, Olmsted County, Minnesota, described as follows:

Beginning at the northeast corner of said Southeast Quarter of the Southwest Quarter; thence southerly on a Minnesota State Plane Grid Azimuth from north of 178 degrees 25 minutes 20 seconds along the east line of said Southeast Quarter of the Southwest Quarter 330.00 feet to the southeast corner of the north 10.00 acres of said Southeast Quarter of the Southwest Quarter; thence westerly 269 degrees 08 minutes 27 seconds azimuth along the south line of said north 10.00 acres 348 feet more or less to the center line of the South Fork of the Zumbro River; thence southeasterly along said center line 450 feet more or less to the west line of said Southwest Quarter of the Southeast Quarter; thence easterly along said center line 1200 feet more or less to the westerly right-of-way line of T.H. 52; thence northerly along said westerly right-of-way line 250 feet more or less to the north line of said Southwest Quarter of the Southeast Quarter; thence westerly 88 degrees 31 minutes 26 seconds azimuth along said north line 854.72 feet to the point of beginning.

Said tract contains 9.59 acres more or less.

Parcel 3

That part of the Northwest Quarter of the Northwest Quarter of Section 11, and that part of the North Half of the Northeast Quarter of Section 10, and that part of the Southeast Quarter of Section 3, all in Township 106 North, Range 14 West, Olmsted County, Minnesota, described as follows:

Beginning at the northwest corner of said Northwest Quarter of the Northwest Quarter; thence easterly on a Minnesota State Plane Grid Azimuth from north of 89 degrees 20 minutes 44 seconds along the north line of said Northwest Quarter of the Northwest Quarter of Section 11 270.20 feet; thence southerly 178 degrees 55 minutes 41 seconds azimuth 205.37 feet to the northerly line of Apache Mall Shopping Center, Resubdivision No. 1, according to the plat thereof on file in the County Recorder's Office, Olmsted County, Minnesota, also being the southerly right-of-way line of T.H. 14; thence westerly 268 degrees 55 minutes 41 seconds azimuth along said southerly right-of-way line 268.90 feet to the west line of said Northwest Quarter of the Northwest Quarter of Section 11; thence continue westerly 268 degrees 55 minutes 41 seconds azimuth along said southerly line and a westerly projection thereof 562.36 feet to the easterly right of way line of T.H. 52; thence southwesterly 203 degrees 21 minutes 15 seconds

azimuth along said easterly right-of-way line 716.15 feet; thence southerly 224.65 feet along said easterly right-of-way line on a tangential curve concave easterly, having a central angle of 12 degrees 10 minutes 00 seconds and a radius of 1057.92 feet; thence southerly 191 degrees 11 minutes 15 seconds azimuth along said easterly right-of-way line 244.14 feet to the south line of said North Half of the Northeast Quarter of Section 10; thence westerly 268 degrees 54 minutes 32 seconds azimuth along said south line 270.18 feet to the southeasterly corner of Barclay Square, according to the plat thereof on file at the County Recorder's Office, Olmsted County, Minnesota, also being the westerly right-of-way line of T.H. 52; thence northerly 11 degrees 11 minutes 15 seconds azimuth along said westerly line, also being the easterly line of said Barclay Square 540.00 feet to the most easterly corner of said Barclay Square; thence westerly 281 degrees 11 minutes 15 seconds azimuth along the northerly line of said Barclay Square also being the southerly right-of-way line of T.H. 52, a distance of 190.00 feet; thence northwesterly 326 degrees 37 minutes 51 seconds azimuth along the northeasterly line of said Barclay Square, also being the southwesterly right-of-way line of T.H. 52, a distance of 398.53 feet to the most northeasterly corner of said Barclay Square; thence westerly 276 degrees 11 minutes 10 seconds azimuth along the northerly line of said Barclay Square, also being the southerly right-of-way line of T.H. 52, a distance of 44.40 feet to the most northwesterly corner of said Barclay Square; thence southwesterly 212 degrees 34 minutes 00 seconds azimuth along the northwesterly line of said Barclay Square, also being the southeasterly right-of-way line of T.H. 52 and C.S.A.H. 8, a distance of 336.07 feet; thence northwesterly 309 degrees 15 minutes 11 seconds azimuth along the southwesterly right-of-way line of T.H. 52, a distance of 174.18 feet to the northwesterly right-of-way line of the Old County Road known as C.S.A.H. "P", also known as C.S.A.H. 8, and also being the northwesterly right-of-way line of T.H. 52; thence northeasterly 39 degrees 24 minutes 52 minutes azimuth along said northwesterly line 372.56 feet; thence northeasterly 32 degrees 18 minutes 40 seconds azimuth along said northwesterly line 346.04 feet to the north line of said North Half of the Northeast Quarter, also being the southeasterly corner of Lot 19 of "Sunny Slopes", according to the plat thereof on file at the County Recorder's Office, Olmsted County, Minnesota; thence continue northeasterly 32 degrees 18 minutes 40 seconds azimuth along the southeasterly line of said "Sunny Slopes", also being the northwesterly right-of-way line of T.H. 52, a distance of 461.15 feet; thence northerly 03 degrees 26 minutes 40 seconds azimuth along the easterly line of said "Sunny Slopes", also being the westerly right-of-way line of T.H. 52, a distance of 119.32 feet; thence northerly 341 degrees 08 minutes 40 seconds azimuth along the easterly line of said "Sunny Slopes" and the easterly line of North Sunny Slopes according to the plat thereof on file at the County Recorder's Office, Olmsted County, Minnesota, also being the

westerly right-of-way line of T.H. 52, a distance of 676.08 feet; thence northerly 358 degrees 40 minutes 40 seconds azimuth along the easterly line of said North Sunny Slopes, also being the westerly right-of-way line of T.H. 52 and along a northerly extension of said line, a distance of 547.76 feet to the center line of the northbound lane of T.H. 52; thence southeasterly 151 degrees 13 minutes 28 seconds azimuth along said center line 260.18 feet; thence southeasterly 690.44 feet on a tangential curve concave northeasterly, having a central angle of 13 degrees 48 minutes 32 seconds, and a radius of 2864.79 feet; thence northeasterly 47 degrees 24 minutes 56 seconds azimuth 100.00 feet to the southwesterly line of Olson's Subdivision also being the northeasterly right-of-way line of T.H. 52 and T.H. 14; thence southeasterly 1043.38 feet along said southwesterly line of Olson's Subdivision and the said northeasterly right-of-way line, and the southwesterly line of Baihly's First Addition, according to the plat thereof on file at the County Recorder's Office, Olmsted County, Minnesota, on a nontangential curve concave northeasterly, having a central angle of 21 degrees 37 minutes 21 seconds, a radius of 2764.79 feet and a chord azimuth of 126 degrees 36 minutes 16 seconds to the east line of said Southeast Quarter of Section 3; thence southerly 178 degrees 32 minutes 43 seconds azimuth along said east line 335.51 feet to the point of beginning.

Said tract contains 48.82 acres more or less.

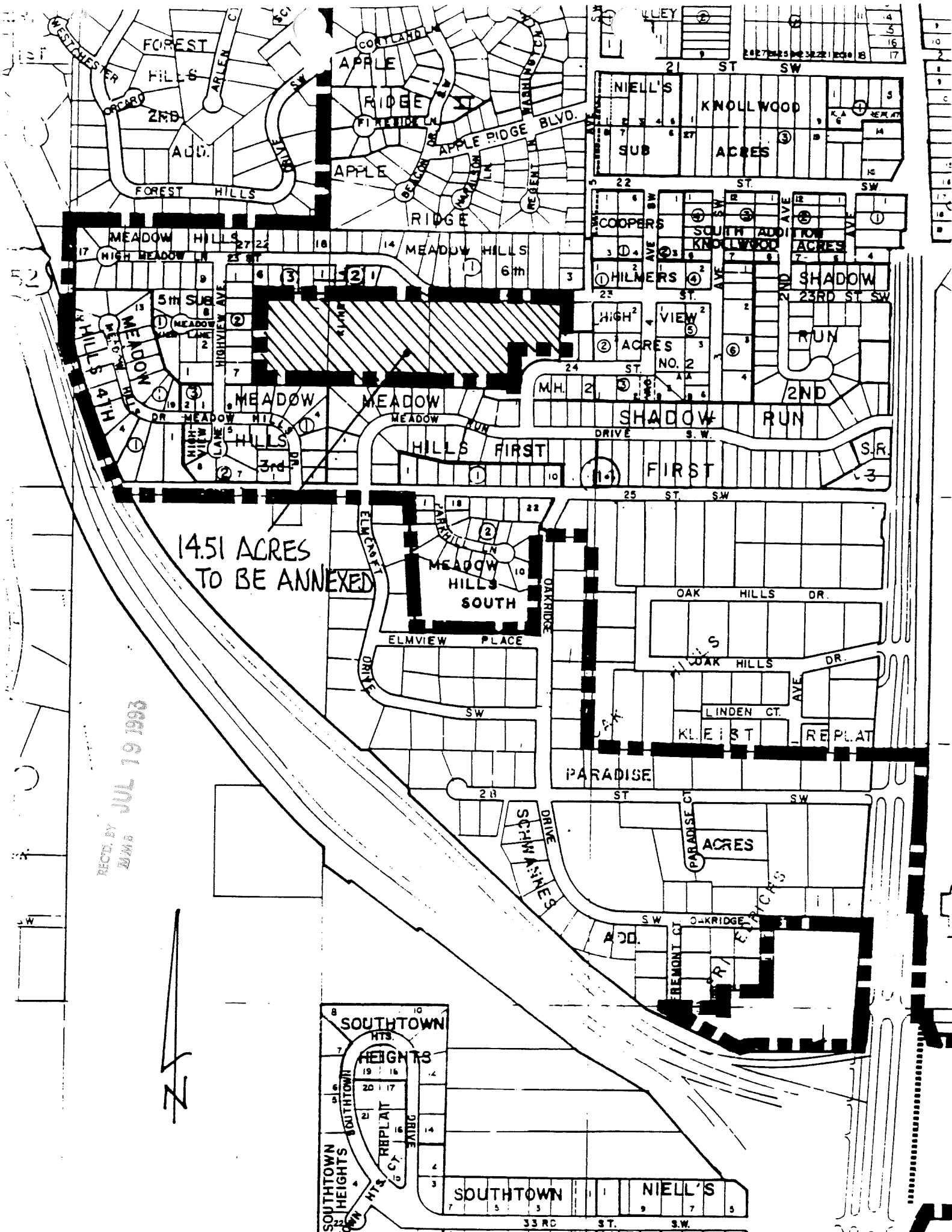

14.51 ACRES  
TO BE ANNEXED

REC'D BY  
MMB  
JUL 19 1983

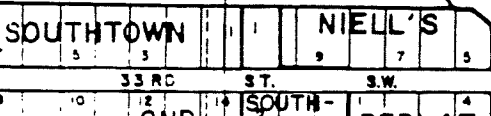
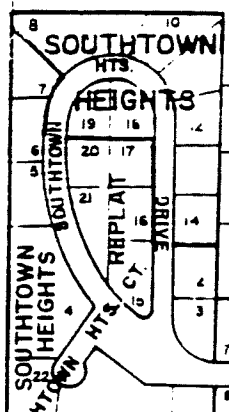

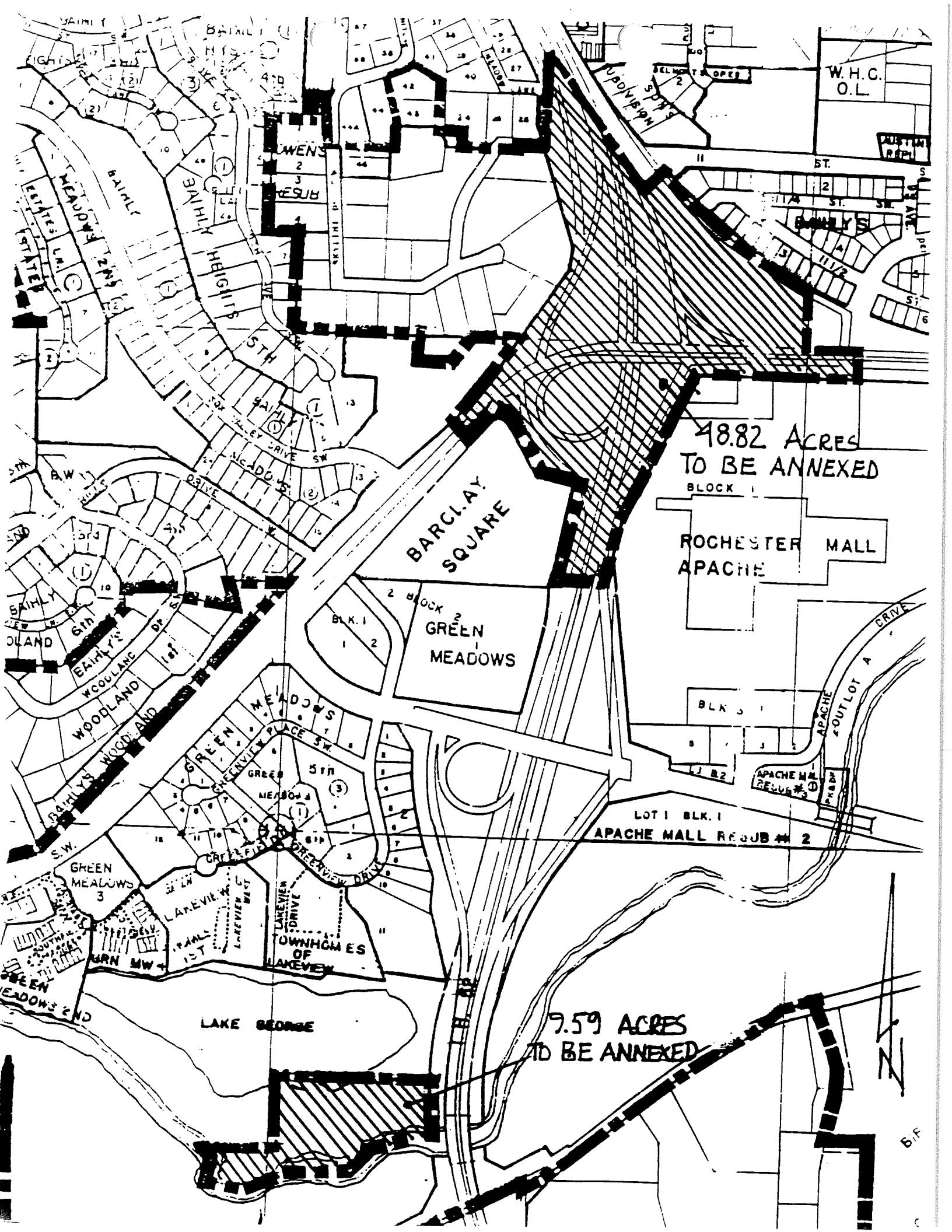

48.82 ACRES  
TO BE ANNEXED  
BLOCK 1

ROCHESTER MALL  
APACHE

BARCLAY  
SQUARE

GREEN  
MEADOWS

LOT 1 BLK. 1  
APACHE MALL REJOB # 2

LAKE GEORGE

9.59 ACRES  
TO BE ANNEXED



B.F.



# Meadow Hills

ANNEXATION AREA

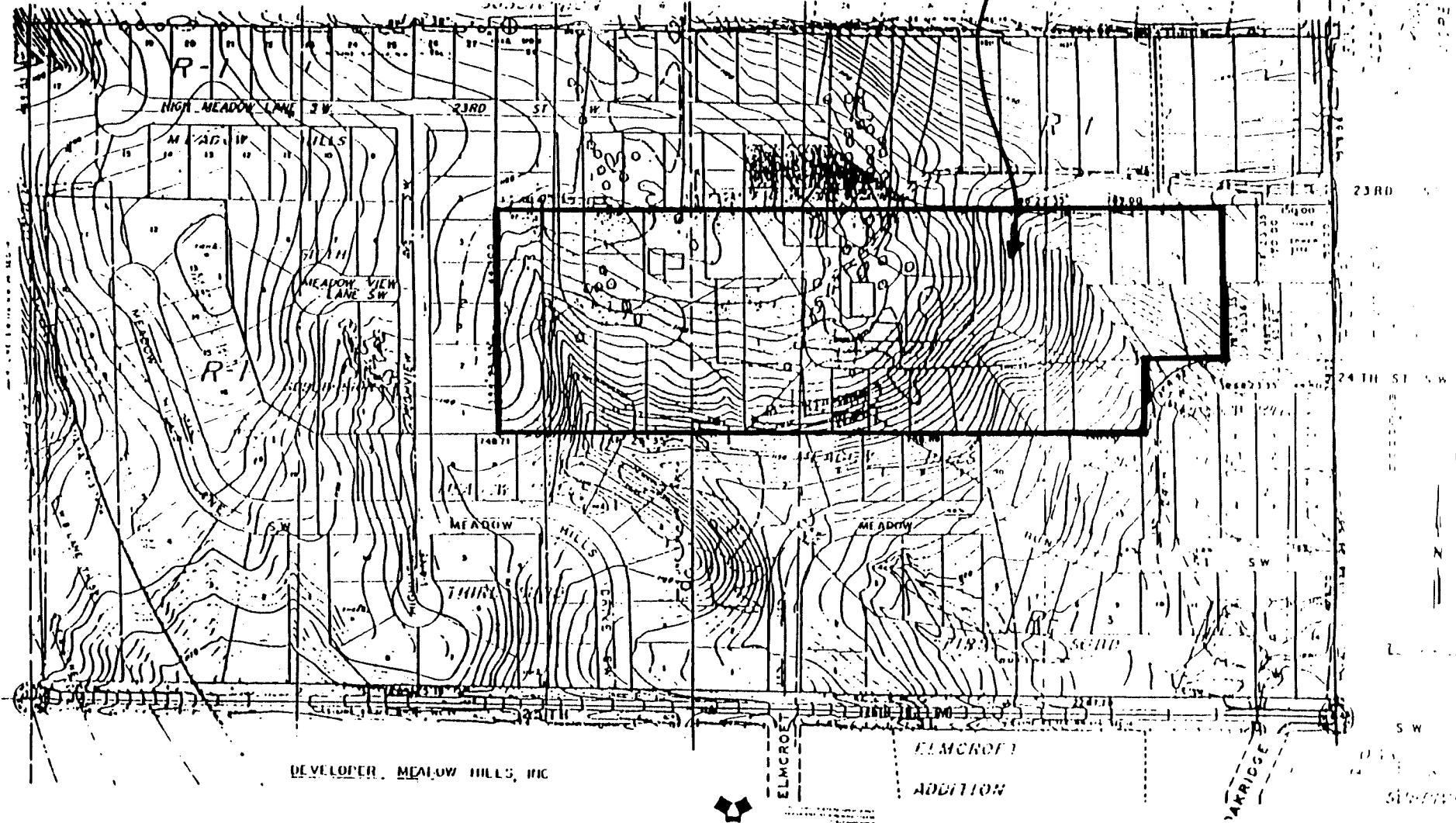

DEVELOPER, MEADOW HILLS, INC

ELMCROFT

ELMCROFT  
ADDITION

LARRIDGE

## General Development Plan

REC'D BY  
MMB  
JUL 19 1993

281-93

E-12  
6/19/93

REC'D. BY  
MMA JUL 19 1993

RESOLUTION

WHEREAS, the City of Rochester has initiated an orderly annexation agreement for portions of Sections 3, 10, 11, and 14 in the Rochester Township.

NOW, THEREFORE, BE IT RESOLVED by the Common Council of the City of Rochester that the City enter into a joint resolution with the Rochester Township for the orderly annexation of portions of Sections 3, 10, 11, and 14 in the Rochester Township.

BE IT FURTHER RESOLVED, that pursuant to said joint resolution the Common Council hereby requests that the Minnesota Municipal Board undertake proceedings pursuant to Minn. Stat. §414.0325 for the annexation to the City of Rochester of the lands described in the joint resolution which are located in Rochester Township, County of Olmsted, State of Minnesota.

BE IT FURTHER RESOLVED, that the City Clerk is hereby directed to forward a certified copy of the joint resolution to the Secretary of the Minnesota Municipal Board, the Rochester Town Clerk, the Olmsted County Planning and Zoning Commission, and the Rochester Planning and Zoning Department.

The Mayor and the City Clerk are authorized and directed to execute said joint resolution on behalf of the City.

PASSED AND ADOPTED BY THE COMMON COUNCIL OF THE CITY OF ROCHESTER, MINNESOTA, THIS 7 DAY OF June, 1993.

Deacy B. Selby  
PRESIDENT OF SAID COMMON COUNCIL

ATTEST: David A. Sumner  
CITY CLERK

APPROVED THIS 8 DAY OF June, 1993.  
Deacy B. Selby  
Acting MAYOR OF SAID CITY

(Seal of the City of Rochester, Minnesota)