

RESOLUTION NO. 32-05

**RESOLUTION APPROVING ANNEXATION
RICHARD THEISEN/KATHY COLGROVE
PARCEL # 17.9083.000**

WHEREAS, a certain petition requesting annexation of the territory hereinafter described was duly presented to the city council at their February 14, 2005, meeting; and

WHEREAS, the quantity of land embraced within the area described in the petition and bounded herein is not in excess of 200 acres of land, no part of which is included within the limits of any other incorporated city; and

WHEREAS, a public hearing is not required to be held by the city because 100% of the property owners of the land to be annexed signed the petition; and

WHEREAS, the land described in the petition does abut upon the present city limits thereof and is included in an existing orderly annexation agreement.

NOW, THEREFORE, BE IT RESOLVED BY THE COUNCIL OF THE CITY OF SARTELL, MINNESOTA: That the city council hereby determines that the annexation will be in the best interest of the city and of the territory affected; that the territory described herein does abut upon the city limits and is now urban or suburban in character; and that none of said territory is now included within the limits of any incorporated city.

BE IT ALSO RESOLVED: That the Town and the City mutually state that the joint resolution and agreement sets forth all the conditions for annexation of the area designated herein for orderly annexation and that no consideration by the Department of Administration/Municipal Boundary Adjustments is necessary. The Department of Administration/Municipal Boundary Adjustments may review and comment, but shall, within thirty (30) days order annexation in accordance with the terms and conditions of this agreement.

BE IT FURTHER RESOLVED: That the following described property is hereby annexed to the City of Sartell, Minnesota, the same as if it had originally been made a part thereof:

The South 673.60 feet of the North 2165.40 feet of the East 970.00 feet of the West Half of the Northeast Quarter (W ½ of NE ¼) of Section Twenty-nine (29), Township One-hundred Twenty-five (125), Range Twenty-eight (28), Stearns County, Minnesota.

AND

That part of the East 970 feet of the West half of the Northeast Quarter (W ½ of NE ¼) of Section Twenty-nine (29), Township One-hundred Twenty-Five (125), Range Twenty-eight (28), lying South of the North 2165.40 feet thereof.

Containing 22 acres, plus or minus.

BE IT FURTHER RESOLVED: That the future land use plan designates the property as high density and commercial and will be given the zoning designation of Agricultural until such time as appropriate planning, engineering and environmental reviews have been done to determine the appropriate long term designation.

Said property is being annexed to the City of Sartell under zoning classification of A-1 Agriculture District, and has a current population of 0.

ADOPTED BY THE SARTELL CITY COUNCIL THIS 28TH DAY OF FEBRUARY, 2005.

Mayor

ATTEST:

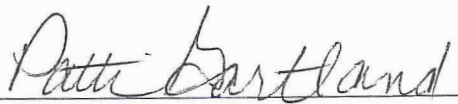
Administrator

SEAL

CERTIFICATION

I, Patti Gartland, Administrator-Clerk-Treasurer of the City of Sartell, do hereby certify that the foregoing is a true and correct copy of a resolution adopted by the Council of the City of Sartell at a regular meeting held on the 28th day of February, 2005.

Patti Gartland
Administrator-Clerk-Treasurer
City of Sartell, Minnesota

CITY OF SARTELL, MN

ANNEXATION MAP - FEBRUARY 2005

T125N - R28W
SECTION 29

LEGEND

- ANNEXATION AREA
- CITY BOUNDARY
- SECTION LINE
- WATER

1 inch equals 700 feet

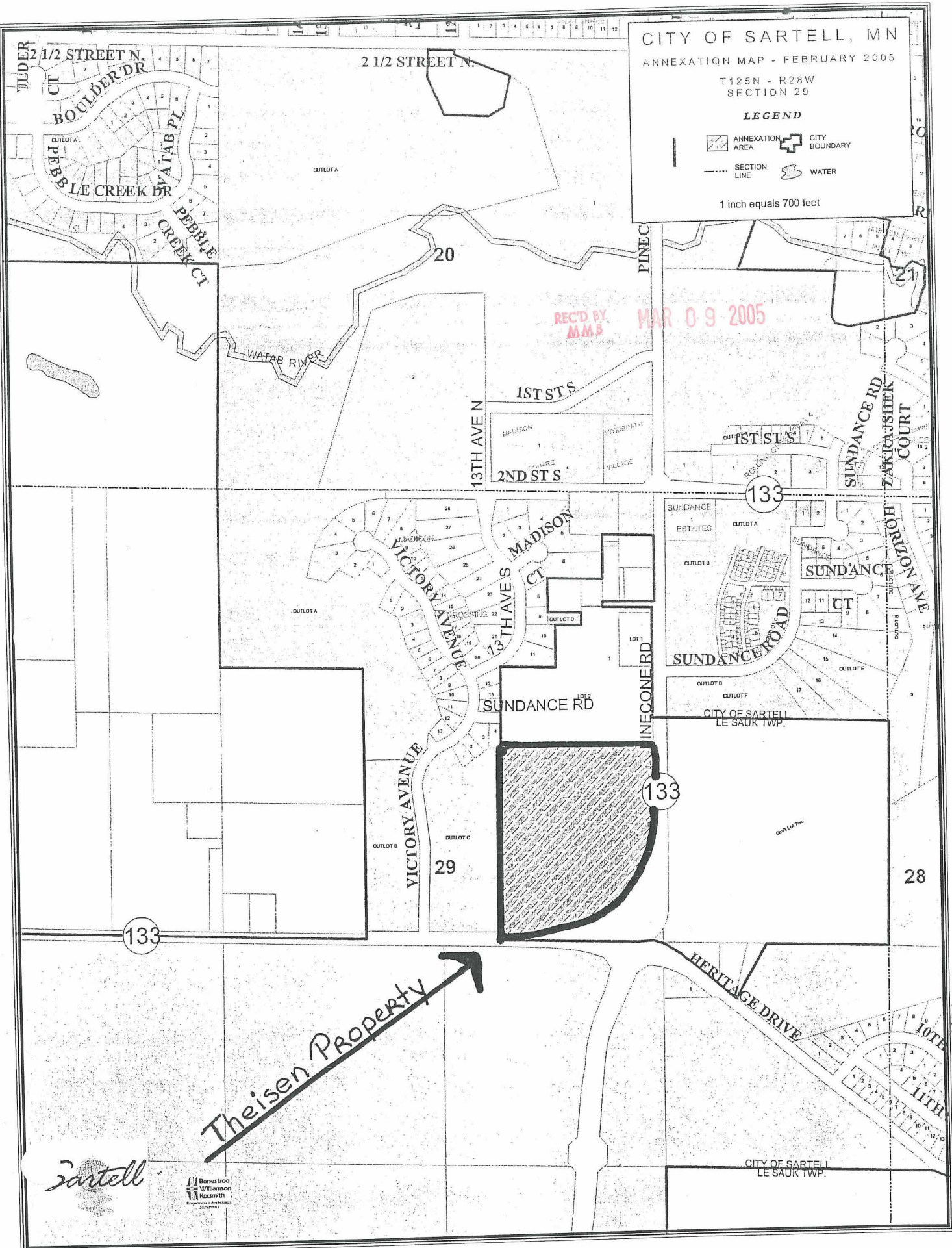

Sartell

Bonestroo
Williamson
Engineers & Architects
Surveyors

CITY OF SARTELL
LE SAUK TWP.