

RESOLUTION NO. 52-03

**RESOLUTION APPROVING ANNEXATION
THOMAS SCHAEFER PROPERTY**

WHEREAS, a certain petition requesting annexation of the territory hereinafter described was duly presented to the city council at their March 10, 2003, meeting; and

WHEREAS, the quantity of land embraced within the area described in the petition and bounded herein is not in excess of 200 acres of land, no part of which is included within the limits of any other incorporated city; and

WHEREAS, a public hearing is not required to be held by the city because 100% of the property owners of the land to be annexed signed the petition; and

WHEREAS, the land described in the petition does abut upon the present city limits thereof and is included in an existing orderly annexation agreement.

NOW, THEREFORE, BE IT RESOLVED BY THE COUNCIL OF THE CITY OF SARTELL, MINNESOTA: That the city council hereby determines that the annexation will be in the best interest of the city and of the territory affected; that the territory described herein does abut upon the city limits and is now urban or suburban in character; and that none of said territory is now included within the limits of any incorporated city.

BE IT ALSO RESOLVED: That approval of this annexation puts the property owners on notice that long range transportation, utility plans and land use plans need to be completed prior to preliminary plat approval.

BE IT ALSO RESOLVED: That the Town and the City mutually state that the joint resolution and agreement sets forth all the conditions for annexation of the area designated herein for orderly annexation and that no consideration by the Minnesota Planning/Municipal Board is necessary. The Minnesota Planning/Municipal Board may review and comment, but shall, within thirty (30) days order annexation in accordance with the terms and conditions of this agreement.

BE IT FURTHER RESOLVED: That the following described property is hereby annexed to the City of Sartell, Minnesota, the same as if it had originally been made a part thereof:

The West 1014.27 feet of the East 1047.27 feet of the South 460 feet of the Southwest Quarter of the Southeast Quarter (SW ¼ SE ¼) of Section Twenty (20), in Township One Hundred Twenty-five (125) North, of Range Twenty-eight (28) West, in Stearns County, Minnesota.

Said property is being annexed to the City of Sartell under zoning classification of R-1 Single Family Residence District, and has a current population of 1.

REC'D BY
MMB

APR 04 2003

ADOPTED BY THE SARTELL CITY COUNCIL THIS 34 DAY OF March, 2003.

Robert J. Sartell
Mayor

ATTEST:

Patti Gartland
Administrator

SEAL

CERTIFICATION

I, Patti Gartland, Administrator-Clerk-Treasurer of the City of Sartell, do hereby certify that the foregoing is a true and correct copy of a resolution adopted by the Council of the City of Sartell at a regular meeting held on the 34 day of March, 2003.

Patti Gartland
Patti Gartland
Administrator-Clerk-Treasurer
City of Sartell, Minnesota

CITY OF SARTELL

STEARNS & BENTON COUNTIES
MINNESOTA

OFFICIAL ZONING MAP

Zoning District Classifications

- | | |
|---------------------------------|------------------------------------|
| B1 - Neighborhood Business | R1 - Single Family Residence |
| B2 - General Business | R1A - Townhome District |
| CDZ - Comprehensive Design Zone | R2 - Single & Two Family Residence |
| I1 - Light Industrial | R3 - Multiple Family Residence |
| I2 - Heavy Industrial | R5 - Planned Unit Development |

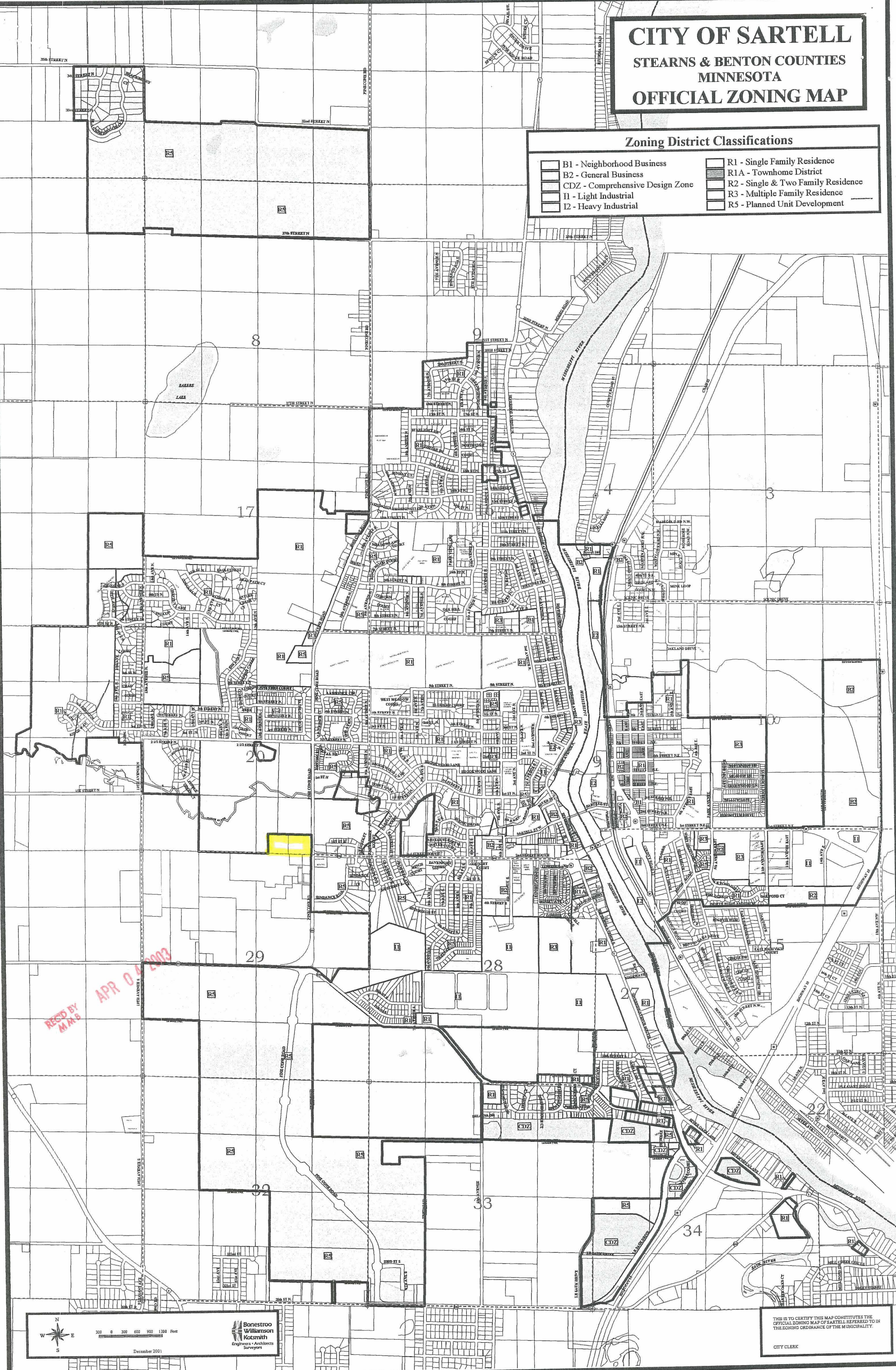

THIS IS TO CERTIFY THIS MAP CONSTITUTES THE
OFFICIAL ZONING MAP OF SARTELL REFERRED TO IN
THE ZONING ORDINANCE OF THE MUNICIPALITY.

CITY CLERK