

RESOLUTION NO. 102-02

RESOLUTION APPROVING ANNEXATION
MALESKA/VIKING DEVELOPMENT

WHEREAS, a certain petition requesting annexation of the territory hereinafter described was duly presented to the city council at their May 28, 2002, meeting; and

WHEREAS, the quantity of land embraced within the area described in the petition and bounded herein is not in excess of 200 acres of land, no part of which is included within the limits of any other incorporated city; and

WHEREAS, a public hearing is not required to be held by the city because 100% of the property owners of the land to be annexed signed the petition; and

WHEREAS, the land described in the petition does abut upon the present city limits thereof and is included in an existing orderly annexation agreement.

NOW, THEREFORE, BE IT RESOLVED BY THE COUNCIL OF THE CITY OF SARTELL, MINNESOTA: That the city council hereby determines that the annexation will be in the best interest of the city and of the territory affected; that the territory described herein does abut upon the city limits and is now urban or suburban in character; and that none of said territory is now included within the limits of any incorporated city.

BE IT ALSO RESOLVED: That approval of this annexation puts the property owners on notice that long range transportation and utility plans need to be completed prior to preliminary plat approval.

BE IT FURTHER RESOLVED: That the following described property is hereby annexed to the City of Sartell, Minnesota, the same as if it had originally been made a part thereof:

The North Half of the Southeast Quarter of Section 5, Township 125, Range 28,
Stearns County, Minnesota LESS AND EXCEPT the south 476 feet of the east
916 feet of the Northeast Quarter of the Southeast Quarter of said Section 5.

Said property is being annexed to the City of Sartell under zoning classification of R-1 Single Family Residence District, and has a current population of 0.

ADOPTED BY THE SARTELL CITY COUNCIL THIS 22 DAY OF July, 2002.

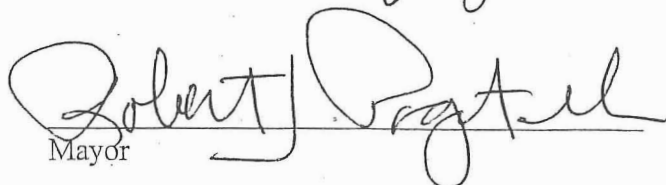
Mayor

REC'D BY
M M B

NOV 14 2002

ATTEST:

Patti Gartland

Administrator

SEAL

CERTIFICATION

I, Patti Gartland, Administrator-Clerk-Treasurer of the City of Sartell, do hereby certify that the foregoing is a true and correct copy of a resolution adopted by the Council of the City of Sartell at a regular meeting held on the 22 day of July, 2002.

Patti Gartland

Patti Gartland
Administrator-Clerk-Treasurer
City of Sartell, Minnesota

City of Sartell

Minnesota

June 2002

Bonestroo
Williamson
Kotsmith
Engineers - Architects
Surveyors



REC'D BY
M.A.M.B. NOV 14 2002

Sartell

Legend

- City Limits
- Parks
- Bike Paths
- Proposed Paths
- Sidewalks

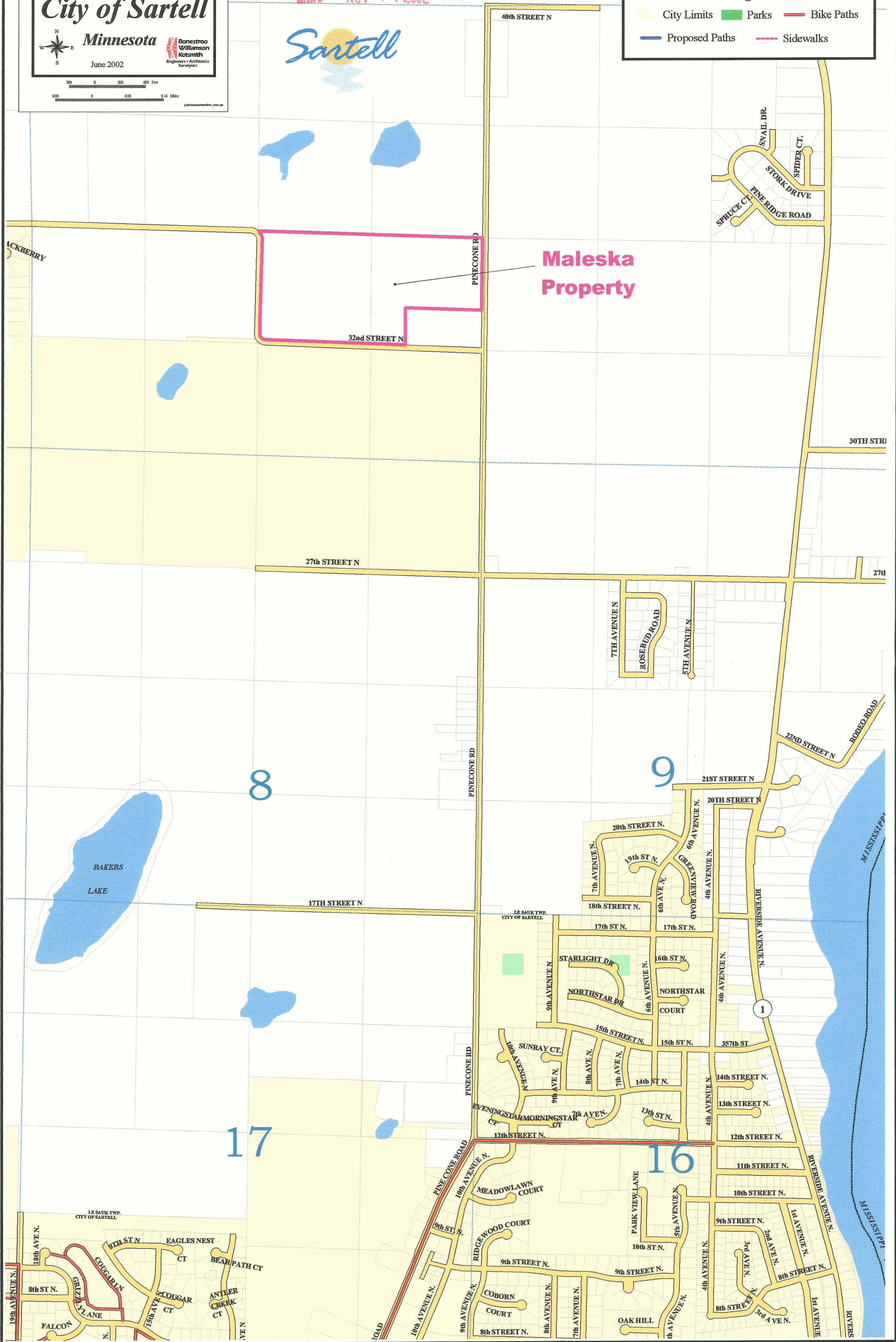

Maleska Property

8

9

17

16

LE SAUK TWP.
CITY OF SARTELL

LE SAUK TWP.
CITY OF SARTELL

1