

CITY OF APPLETON RESOLUTION 2016-06
TO THE MINNESOTA MUNICIPAL BOUNDARY ADJUSTMENTS

IN THE MATTER OF THE JOINT
RESOLUTION OF THE TOWNSHIP OF
APPLETON AND THE CITY OF APPLETON
DESIGNATING AN UNINCORPORATED
AREA AS IN NEED OF ORDERLY
ANNEXATION AND CONFERENCING
JURISDICTION OVER SAID AREA TO
THE MINNESOTA MUNICIPAL
BOUNDARY ADJUSTMENTS
PURSUANT TO M.S. 414.0325.

**JOINT RESOLUTION FOR
ORDERLY ANNEXATION**

The Township of Appleton (“Township”) and the City of Appleton (“City”) hereby jointly agree to the following:

1. That the following described area in Appleton Township is subject to orderly annexation pursuant to Minn. Stat. §414.0325, and the parties hereto designate this area for orderly annexation:

The South 250.00 feet of the East 330.00 feet of the Southeast Quarter of the Southeast Quarter (SE ¼ SE ¼) of Section 10, Township 120, Range 43, Swift County, Minnesota. Containing 1.89 acres, more or less.

hereinafter (“THE PROPERTY”).

2. That the Township does, upon passage of this resolution and its adoption by the City Council of Appleton, Minnesota, and upon acceptance by the Municipal Boundary Adjustments, confer jurisdiction upon the Minnesota Municipal Boundary Adjustments over the various provisions contained in this agreement.

3. THE PROPERTY abuts the City and is presently commercial in nature or about to become so. Further, the City is capable of providing services to this area within a reasonable time, or the existing township form of government is not adequate to protect the public health, safety or welfare, or the annexation would be in the best interests of the area proposed for annexation. Therefore, THE PROPERTY would be immediately annexed to the City.

4. That THE PROPERTY shall be zoned as “C” Commercial district property.

5. That property owners, as evidence by its consent hereto, has requested annexation of THE PROPERTY as it intends to develop the property with the construction and operation of a Dollar General Store and will be seeking city services.

6. No consideration by the board is necessary, and the board shall, after review and comment, order the annexation within thirty (30) days in accordance with the terms of this resolution.

7. The City shall, at its own cost, pay any required filing fees, cost of publication or other costs and request an order annexing THE PROPERTY in the above identified area. No such annexation shall be ordered unless it is consistent with the terms and conditions of this Joint Resolution.

8. Any notices required under this Joint Resolution shall be in writing and either personally served on the following or sent by certified or registered mail to the following persons or their successors:

City of Appleton
Roman A. Fidler
323 W. Schlieman Ave.
Appleton MN 56208

Appleton Township
Sonya Allpress
2210 70th St. SW
Appleton MN 56208

CITY OF APPLETON

Upon the vote taken thereon, the following voted:

For: Smith, Knutson, Molden, Raddatz and Syltie
Against: none

Whereupon said Joint Resolution for Orderly Annexation was declared duly passed and adopted this 16th day of March, 2016.



Chadwick C. Sylte, Mayor

ATTEST:



Roman A. Fidler, City Clerk

TOWNSHIP OF Appleton

Upon the vote taken thereon, the following voted:

For: Meyer, Tosel, Aasland, Allpress and Reinke

Against: none

Whereupon said Joint Resolution for Orderly Annexation was declared duly passed and adopted this 7th day of March, 2016.

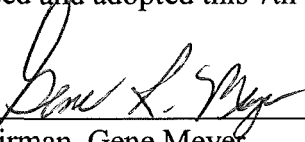

Chairman, Gene Meyer

ATTEST:

Township Clerk, Sonya Allpress

CONSENT TO ANNEXATION:

The undersigned are the owners of the PROPERTY and hereby petitions and consents to the annexation of the PROPERTY.

Dated: 5/25/16



Michael R. Munsterman

Dated 6/1/16

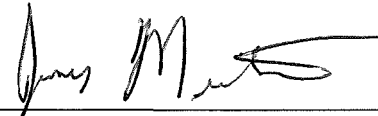

Jerome Munsterman

Dated 6/6/16

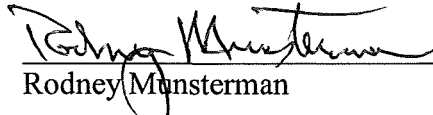

Rodney Munsterman

STATE OF MINNESOTA)
)ss
COUNTY OF)

The foregoing instrument was acknowledged before me this 25th day of MAY, 2016, by Michael R. Munsterman

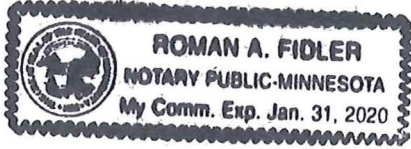

[Signature]
Notary Public

STATE OF MINNESOTA)
)ss
COUNTY OF)

The foregoing instrument was acknowledged before me this 01 day of JUNE 2016 by Jerome Munsterman

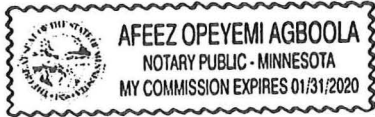

[Signature]
Notary Public

STATE OF MINNESOTA)
)ss
COUNTY OF Hennepin)

The foregoing instrument was acknowledged before me this 06 day of June 2016 by Rodney Munsterman

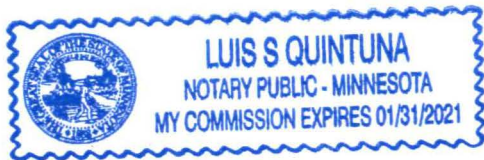

[Signature]
Notary Public

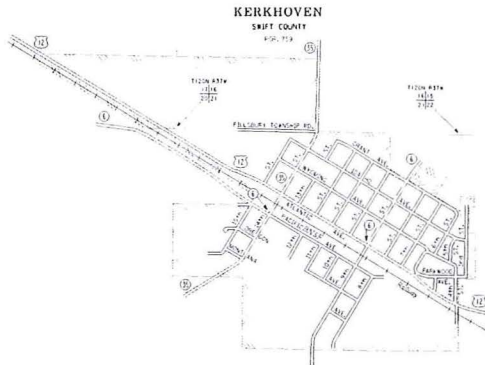
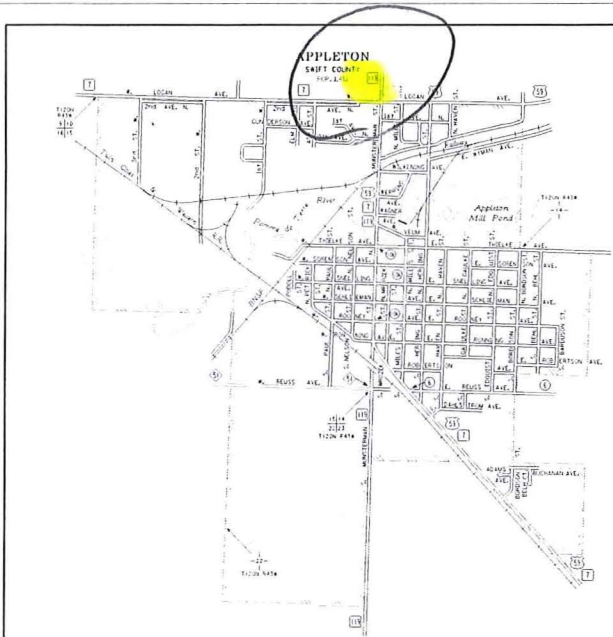

MUNICIPALITIES OF
SWIFT CO.
PREPARED BY THE
MINNESOTA DEPARTMENT OF TRANSPORTATION
OFFICE OF TRANSPORTATION SYSTEM MANAGEMENT
IN COOPERATION WITH
U.S. DEPARTMENT OF TRANSPORTATION
FEDERAL HIGHWAY ADMINISTRATION

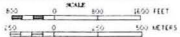

2015
BASE DATA - CAD

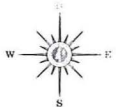

- LEGEND**
- INTERSTATE TRUCK HIGHWAY.....(1)
 - U.S. TRUCK HIGHWAY.....(2)
 - STATE TRUCK HIGHWAY.....(3)
 - COUNTY STATE AID HIGHWAY.....(4)
 - COUNTY ROAD.....(5)
 - PRIVATE ROAD.....(6)
 - CORPORATE LIMITS.....(7)

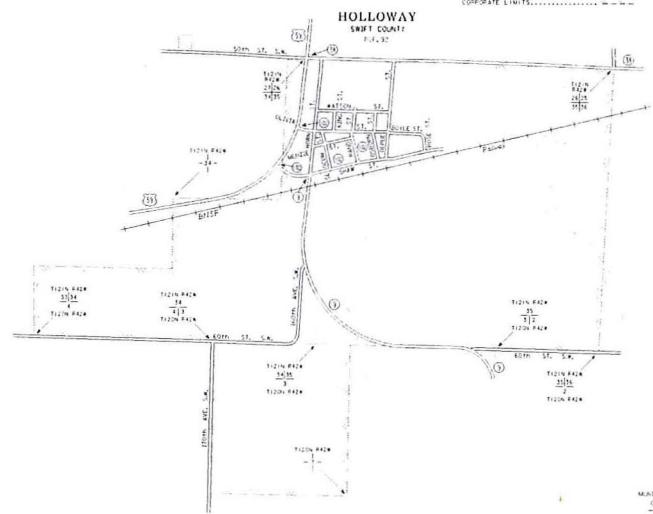

MUNICIPALITIES SHOWN
ON THIS SHEET

- APPLETON
- HOLLOWAY
- KERKHOVEN
- MURDOCK

1. THIS INFORMATION IS FOR GENERAL INFORMATION ONLY AND IS NOT TO BE USED FOR ANY PURPOSE OTHER THAN THAT FOR WHICH IT WAS PREPARED. THE USER ASSUMES ALL LIABILITY FOR ANY AND ALL DAMAGES, INCLUDING REASONABLE ATTORNEY'S FEES, ARISING FROM THE USE OF THIS INFORMATION.

NOTE: 2010 U.S. CENSUS FIGURES SHOWN FOR ALL MUNICIPALITIES UNLESS OTHERWISE STATED.

SEC. 10 TWP. 120, RNG. 43
SE1/4 SE1/4

APPLETON TOWNSHIP

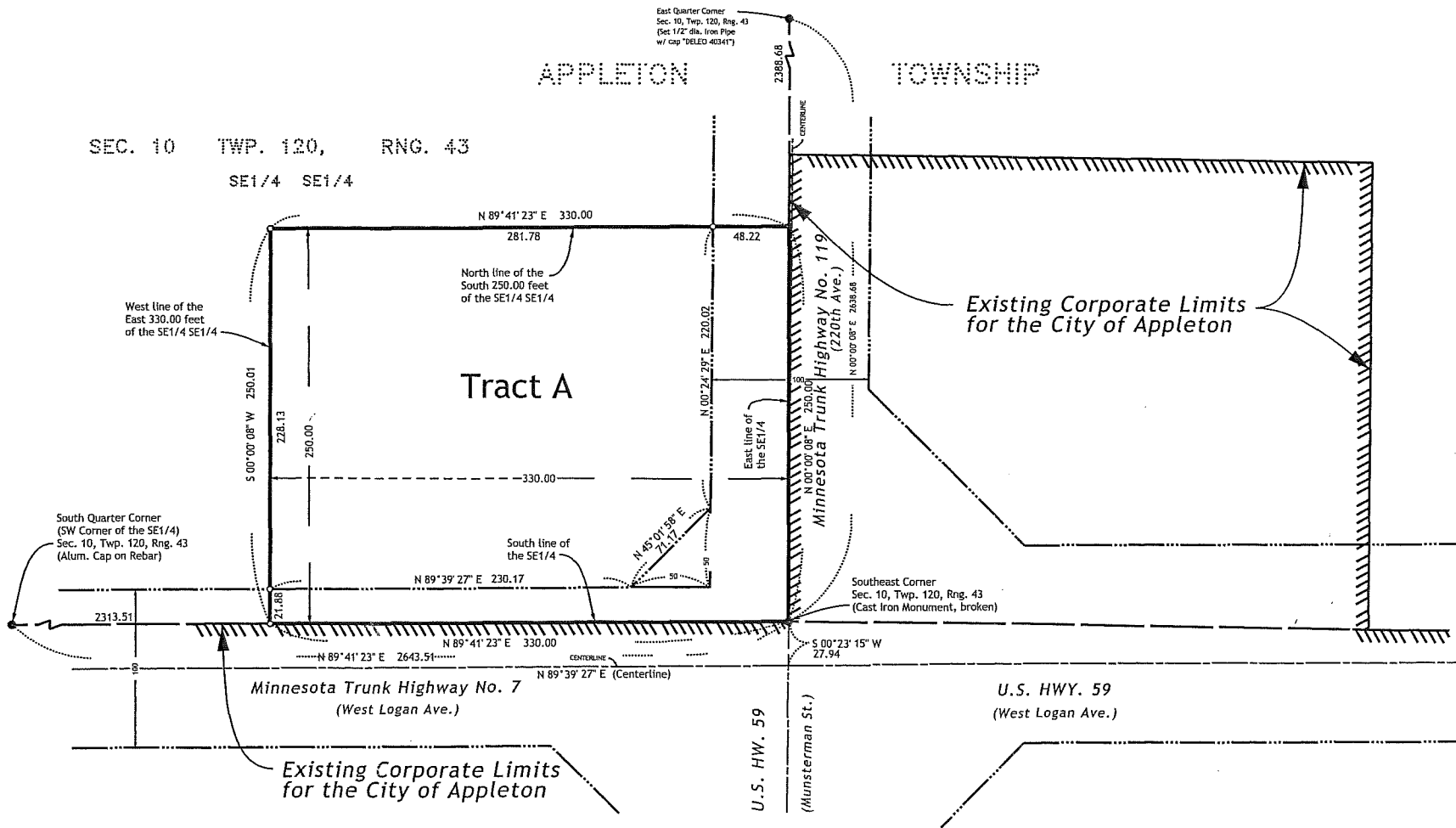

Vicinity Map

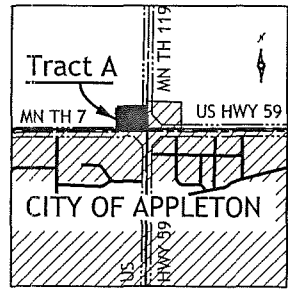

South Quarter Corner (SW Corner of the SE1/4) Sec. 10, Twp. 120, Rng. 43 (Alum. Cap on Rebar)

East Quarter Corner Sec. 10, Twp. 120, Rng. 43 (Set 1/2" dia. Iron Pipe w/ cap "DELEO 40341")



ORIENTATION OF THIS BEARING SYSTEM IS BASED ON THE SWIFT COUNTY COORDINATE SYSTEM NAD 83 (1996 HARN ADJ.)



- DENOTES: SET IRON PIPE WITH CAP STAMPED "DELEO 40341"
- ⊙ DENOTES: SET MAGNETIC "PK" NAIL
- ⊕ DENOTES: GOVERNMENT SECTION CORNER MONUMENT

NO.	REVISIONS SINCE INITIAL SURVEY DATED 2/04/2016	DATE

KRAMER LEAS DELEO
SURVEYING • ENGINEERING • PLANNING
BRainerd • ST. CLOUD

13 North 11th Avenue
St. Cloud, MN 56303
320-259-1265

I HEREBY CERTIFY THAT THIS PLAN, SURVEY, OR REPORT WAS PREPARED BY ME OR UNDER MY DIRECT SUPERVISION AND THAT I AM A DULY REGISTERED LAND SURVEYOR UNDER THE LAWS OF THE STATE OF MINNESOTA.

Signature: *Samuel J. DeLeo* Date: 3/19/2016
Samuel J. DeLeo, MN License No. 40341

PROJECT NO. OVERG1519

Legal description for parcel to be annexed into the City of Appleton, MN

Tract A
The South 250.00 feet of the East 330.00 feet of the Southeast Quarter of the Southeast Quarter (SE1/4 SE1/4) of Section 10, Township 120, Range 43, Swift County, Minnesota.

Containing 1.89 acres, more or less.

CERTIFICATE OF SURVEY
Property Boundary Survey for Annexation

For: The Overland Group, LLC
Site Description: Minnesota Trunk Highway No. 7,
City of Appleton, County of Swift, State of Minnesota
Located in Section 10 Township 120 North, Range 43 West