

IN THE MATTER OF THE JOINT  
RESOLUTION OF THE TOWN OF  
HARTFORD AND THE CITY OF  
BROWERVILLE DESIGNATING AN  
UNINCORPORATED AREA AS IN  
NEED OF ORDERLY ANEXATION  
AND CONFERRING JURISDICTION  
OVER SAID AREA TO THE DEPART-  
MENT OF ADMINISTRATIVE HEARINGS –  
MUNICIPAL BOUNDARY ADJUST-  
MENTS PURSUANT TO M.S. 414.0325

REC'D BY  
MBA

JUN 22 2015

JOINT RESOLUTION  
FOR ORDERLY ANNEXATION

-----

The Township of Hartford and the City of Browerville hereby jointly agree to the following:

1. That the following described area in Hartford Township is subject to orderly annexation pursuant to Minnesota Statutes 414.0325, and the parties hereto designate this area for orderly annexation, to wit:

Parcel "1"

Todd County Parcel # 12-4002900 That portion of the parcel as described below:

Township 130, Range 33, Section 17

THE SOUTH 884 FEET OF THE WEST 787 FEET OF THE NORTHWEST QUARTER OF THE  
NORTHEAST QUARTER AND THE NORTH 99 FEET OF THE WEST 787 FEET OF THE  
WOUTHWEST QUARTER OF THE NORHTEAST QUARTER OFSECTION 17, RANGE 33,  
TOWNSHIP 130

2. That the Town Board of the Township of Hartford, and the City Council of the City of Browerville, upon passage and adoption of this resolution and upon the acceptance by the Office of Administrative Hearings Municipal Boundary Adjustments, confer jurisdiction upon the Office of Administrative Hearings Municipal Boundary Adjustments over the various provisions contained in this Agreement.

3. That these certain properties are presently urban or suburban in nature or are about to become so. Further, the City of Browerville is capable of providing services to this area within a reasonable time, and the annexation is in the best interest of the area proposed for annexation. Therefore, this property would be immediately annexed to the City of Browerville, to wit:

Parcel "1"

Todd County Parcel # 12-4002900 That portion of the parcel as described below:

Township 130, Range 33, Section 17

THE SOUTH 884 FEET OF THE WEST 787 FEET OF THE NORTHWEST QUARTER OF THE  
NORTHEAST QUARTER AND THE NORTH 99 FEET OF THE WEST 787 FEET OF THE  
SOUTHWEST QUARTER OF THE NORHTEAST QUARTER OFSECTION 17, RANGE 33,  
TOWNSHIP 130

4. Upon annexation, the City shall zone Parcel #1 Commercial/Light Industrial

5. Both the Town of Hartford and the City of Browerville agree that no alteration of the stated boundaries of this agreement is appropriate. The annexation is in the best interest of both the City and Township. The annexation will increase the amount of property tax generated by the property by allowing for a broader use of the property. The current property tax generated for the Township is negligible and the Town Board does not wish to seek compensation. Furthermore, each party agrees that no consideration by the Office of Administrative Hearings Municipal Boundary Adjustments is necessary. Upon receipt of this resolution, passed and adopted by each party, the Office of Administrative Hearings Municipal Boundary Adjustments may review and comment, but shall, within thirty (30) days, order the annexation in accordance with the terms of this joint resolution.

Approved by the Town of Hartford this 23 day of March 2015.

**Town of Hartford**

BY: Darrell S Christensen  
Town Board Chair

BY: Jerry Rickard  
Town Board Clerk

Approved by the City of Browerville this 11<sup>th</sup> day of March 2015

**City of Browerville**

BY: Robert Hei  
Mayor

(SEAL)

ATTEST:

[Signature]  
City Administrator

MAIN ST-S

REC'D BY  
MBA JUN 22 2015

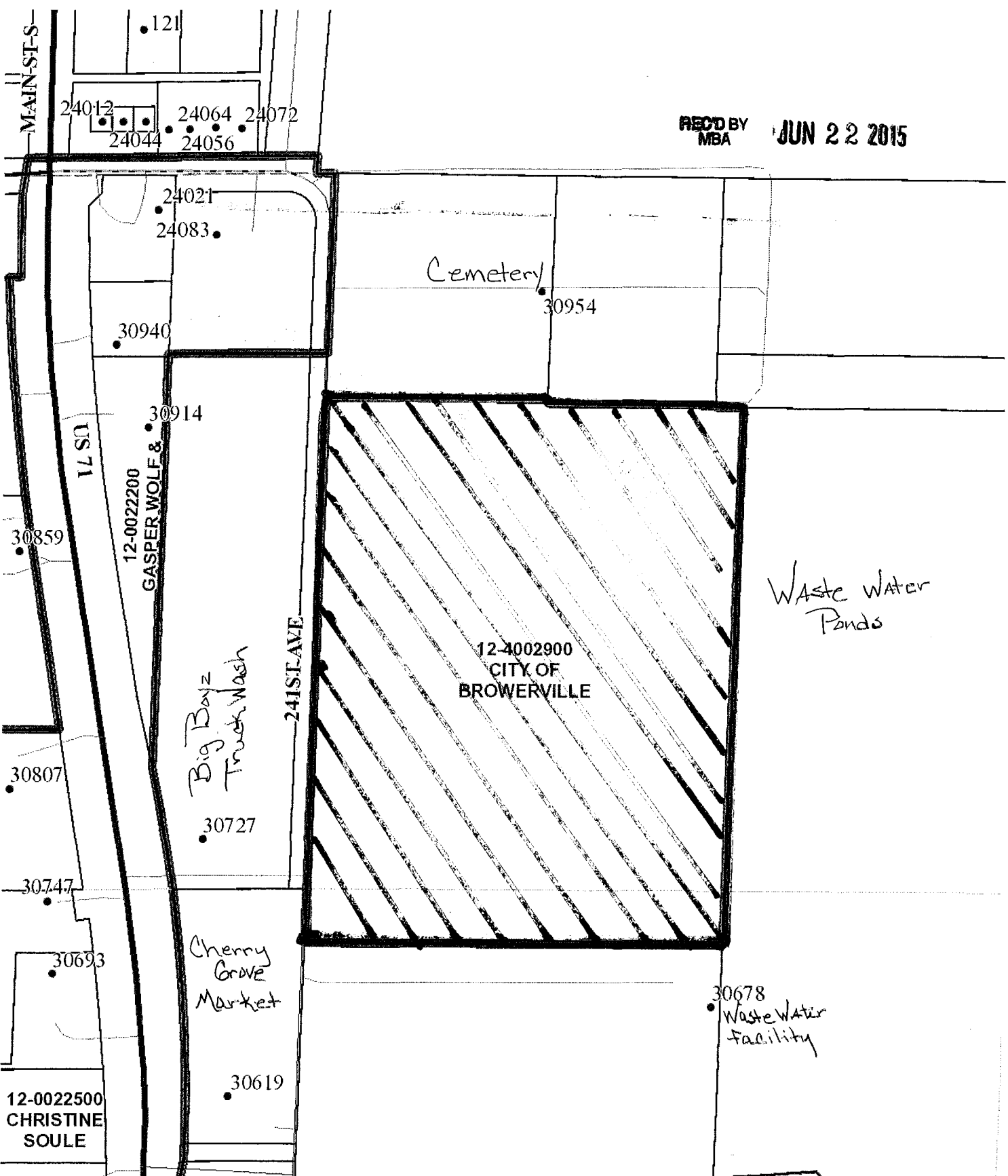

12-0022500  
CHRISTINE  
SOULE

12-4002900  
CITY OF  
BROWERVILLE

Waste Water  
Ponds

Big Boyz  
Truck Wash

Cherry  
Grove  
Market

30678  
Waste Water  
Facility



Todd County GIS  
215 1st Ave S, Ste 102  
Long Prairie, MN 56347  
(Office) 320-732-4248

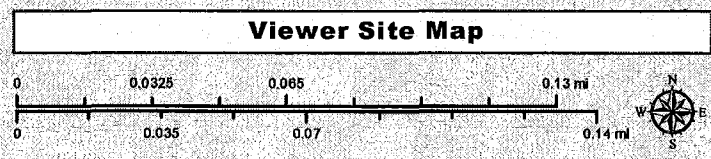

The Todd County GIS & Land Services Department has made every effort to provide the most accurate and up-to-date information available in this publication and cannot be held responsible for any unforeseen errors or omissions. If the recipient wishes to locate parcel corners and property lines, employ the services of a Registered Land Surveyor.

Printed on:  
Monday, March 23, 2015