

JOINT RESOLUTION  
FOR ORDERLY ANNEXATION

REC'D BY  
MBA

JUL 02 2012

This Joint Resolution is made and entered into by the City of Nashwauk ("City") Itasca County, Minnesota and the Township of Nashwauk ("Township"), Itasca County, Minnesota.

RECITALS

1. The City of Nashwauk desires to annex certain lands in the Township of Nashwauk. The area to be annexed is listed on Attachment A ("Affected Area"), and is presently owned by the City of Nashwauk.
2. The Township and City have agreed to meet to discuss and develop an orderly annexation of the Affected Area based upon the impending development of Essar Steel Minnesota.
3. It is desirous of the governing units to expand Nashwauk based on the development of mining facilities.
4. The property to be annexed into the City of Nashwauk would be used for residential development. The city owns all of the property and half is within the city limits. Infrastructure would be installed sewer, water and electrical services as part of the development of the property.
5. The City and the Town believe that no consideration by the Municipal Boundary Adjustment Unit of the Office of Administrative Hearings, or its successor ("OAH") is necessary for said annexation, and both agree that the Affected Area should be annexed and become a part of the City subject to all of the ordinances, controls and other obligations and benefits of property located within the City, and should cease to be part of the Township and should therefore be released from the jurisdiction thereof.

NOW, THEREFORE BE IT RESOLVED BETWEEN THE CITY AND TOWNSHIP AS FOLLOWS:

1. The Affected Area is in need of orderly annexation and no alteration of its stated boundaries as set forth above is appropriate.
2. The Affected Area is presently undeveloped former mining land or is about to become a residential area and the Affected Area should be immediately annexed into the City following the OAH reviewing and commenting on the same, and approval as required by statute within 30 days.
3. The conditions of annexation of the Affected Area shall be that it shall cease to be part of the Township and shall be annexed to be included within the corporate

limits of the City and shall in all things become subject to the jurisdiction of the City and become a part thereof and shall be released from the jurisdiction of the Township and shall no longer be a part thereof.

4. The parties further acknowledge that there are no special assessments levied on the Affected Area.
5. Upon annexation, the City shall zone the Affected Area pursuant to the conditions and requirements of its existing City Code, if any.
6. Upon annexation, the City shall take over maintenance of and be responsible for all public roadways located within the Affected Area formerly maintained by the Township, if any.
7. This joint resolution requesting both orderly annexation and the immediate annexation of the Affected Area pursuant to the terms and conditions set forth herein shall be submitted by the City Clerk of the City of Nashwauk, with any required filing fee, to the OAH for its thirty-day review, comment, and action pursuant to Minn. Stat. § 414.0325.

THE ABOVE RESOLUTION IS HEREBY ADOPTED AND APPROVED BY THE CITY COUNCIL OF THE CITY OF NASHWAUK, ITASCA COUNTY, MINNESOTA, ON THE 26 DAY OF June, 2012.

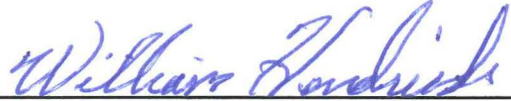

\_\_\_\_\_  
Mayor William Hendricks

ATTEST:



\_\_\_\_\_  
Clerk

THE ABOVE RESOLUTION IS HEREBY ADOPTED AND APPROVED BY THE TOWN BOARD OF SUPERVISORS OF THE TOWN OF NASHWAUK, ITASCA COUNTY, MINNESOTA, ON THE 12 DAY OF June, 2012.



\_\_\_\_\_  
Chairman of Town Board

ATTEST:



\_\_\_\_\_  
Clerk

REC'D BY  
MBA JUL 02 2012

Attachment A

The following legally described areas in Nashwauk Township are hereby designated for orderly annexation as the Affected Area:

Southeast Quarter of the Southwest Quarter (SE1/4SW1/4) of Section Twenty(20), in Township Fifty-seven (57) North, Range Twenty-two (22) West of the Fourth Principal Meridian, in Itasca County Minnesota, according to the united States Government survey thereof.

Southwest Quarter of the Southwest Quarter (SW1/4SW1/4) Less that part lying Southerly and Westerly of Tate Highway 65, Section Twenty (20), Township Fifty-seven (57) North, Range Twenty-two (22), West of the Fourth Principal Meridian

See Nashwauk (W) Page 40

39000 EASTW  
38000  
37000 65  
STONE RD  
36000

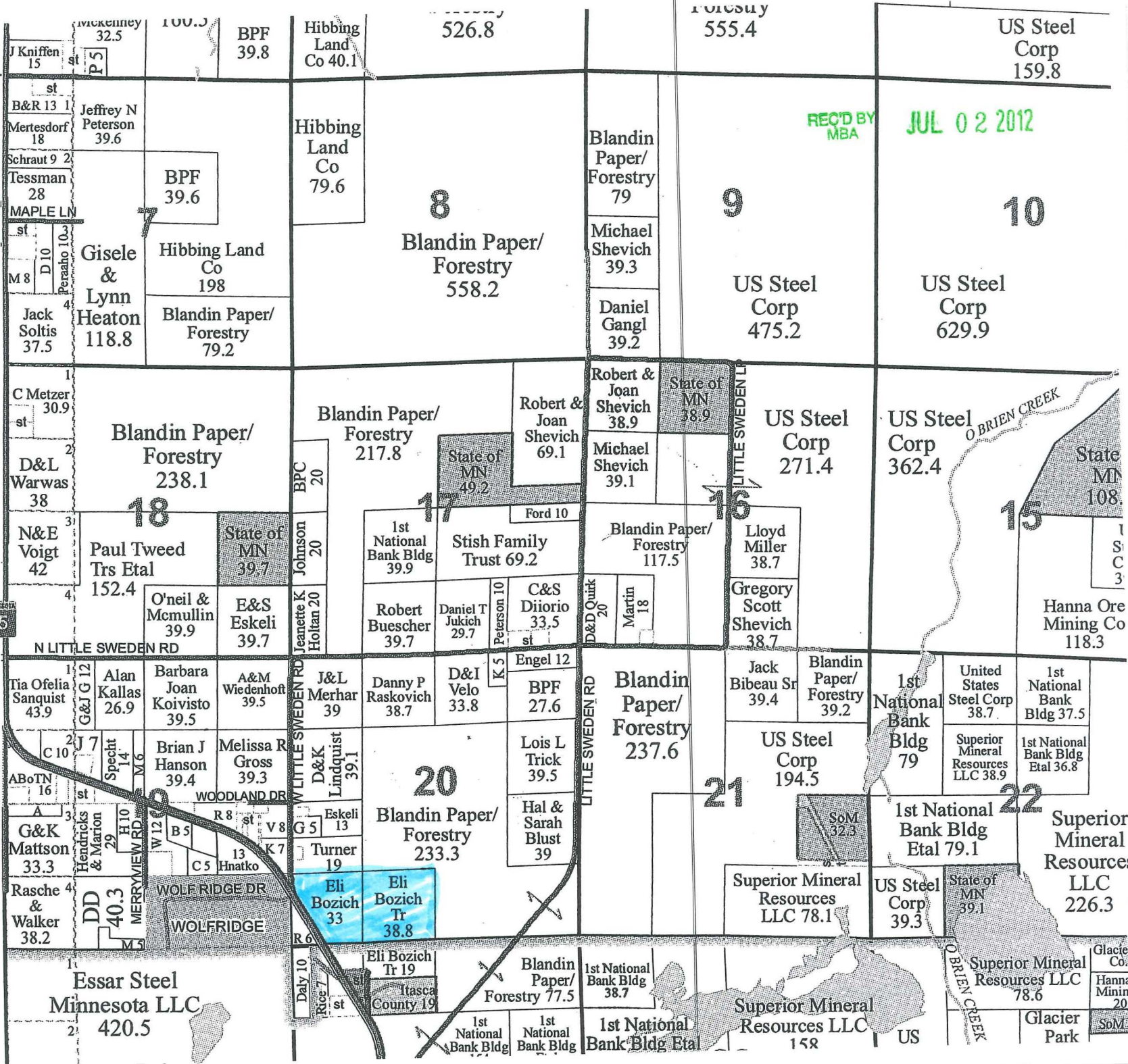

REC'D BY MBA JUL 02 2012

Jeffrey N Peterson 39.6	BPF 39.6	Hibbing Land Co 79.6	Blandin Paper/Forestry 79	US Steel Corp 475.2	US Steel Corp 629.9
Gisele & Lynn Heaton 118.8	Hibbing Land Co 198	Blandin Paper/Forestry 79.2	Michael Shevich 39.3	US Steel Corp 271.4	US Steel Corp 362.4
C Metzger 30.9	Blandin Paper/Forestry 238.1	Blandin Paper/Forestry 217.8	Robert & Joan Shevich 69.1	State of MN 38.9	US Steel Corp 108.3
D&L Warwas 38	Paul Tweed Trs Etal 152.4	State of MN 39.7	Stish Family Trust 69.2	Michael Shevich 39.1	Hanna Ore Mining Co 118.3
N&E Voigt 42	O'neil & McMullin 39.9	E&S Eskeli 39.7	1st National Bank Bldg 39.9	Ford 10	Lloyd Miller 38.7
Tia Ofelia Sanquist 43.9	Alan Kallas 26.9	Barbara Joan Koivisto 39.5	A&M Wiedenhoft 39.5	J&L Merhar 39	Danny P Raskovich 38.7
G&K Mattson 33.3	Rasche & Walker 38.2	Brian J Hanson 39.4	Melissa R Gross 39.3	D&K Lindquist 39.1	D&I Velo 33.8
Essar Steel Minnesota LLC 420.5	Eli Bozich Tr 38.8	Eli Bozich Tr 38.8	Blandin Paper/Forestry 233.3	Lois L Trick 39.5	Hal & Sarah Blust 39
Essar Steel Minnesota LLC 420.5	Superior Mineral Resources LLC 78.6	Superior Mineral Resources LLC 78.6	Blandin Paper/Forestry 77.5	1st National Bank Bldg 38.7	1st National Bank Bldg Etal 158