

IN THE MATTER OF THE JOINT RESOLUTION OF THE  
TOWN OF BELLE PRAIRIE AND THE CITY OF LITTLE  
FALLS DESIGNATING AN UNINCORPORATED AREA AS  
IN NEED OF ORDERLY ANNEXATION AND  
CONFERRING JURISDICTION OVER SAID AREA TO  
THE OFFICE OF ADMINISTRATIVE HEARINGS,  
MUNICIPAL BOUNDARY ADJUSTMENTS, PURSUANT  
TO MINNESOTA STATUTE 414.0325

REC'D BY JUL 28 2010  
MBA

JOINT RESOLUTION FOR  
ORDERLY ANNEXATION

The Township of Belle Prairie and the City of Little Falls hereby jointly agree to the following:

1. That the following described area in Belle Prairie Township is subject to orderly annexation pursuant to Minnesota Statute 414.0325, and the parties hereto designate this area for orderly annexation, to wit:

That part of the Southeast Quarter of the Northwest Quarter (SE 1/4 NW 1/4) of Section 26, Township 41 North, Range 32 West, shown as Parcel 10 on Minnesota Department of Transportation Right of Way Plat Numbered 49-64 as the same is on file and of record in the Office of the Morrison County Recorder, Minnesota; and

That part of the Northeast Quarter (NE 1/4) and part of the North Half of the Southeast Quarter (N1/2 SE1/4), Section 23, Township 41, Range 32, described in Document No. 459945 recorded in the Morrison County Recorders Office, Minnesota: and

That part of the highway right-of-way of Trunk Highway 371 in Sections 23, 24 and 26, Township 41, Range 32 shown on Minnesota Department of Transportation Right-of-Way Plats, No. 49-42, 49-43, 49-44, 49-45 and 49-64, recorded in the Morrison County Recorders Office, Minnesota, except any portions previously annexed.

2. That the Town Board of Belle Prairie Township, and the City Council of the City of Little Falls, upon passage and adoption of this Resolution and upon the acceptance by the Office of Administrative Hearings, Municipal Boundary Adjustments, confer jurisdiction upon said Office of Administrative Hearings, Municipal Boundary Adjustments, over the various provisions contained in this Agreement.

3. That this certain property, abuts the City of Little Falls corporate limits, is presently urban or suburban in nature or is about to become so. Further, the City of Little Falls is capable of providing services to this area within a reasonable time and the annexation is in the best interest of the area proposed for annexation.

4. In accordance with Minnesota Statute 414.0325, Subdivision 1(a) regarding electric utility service notice, the City of Little Falls notified Minnesota Power Company on June 4, 2010, of our intent to annex said territory, and requested notification if there is a change in the cost of electric utility service as a result of this annexation. No change is anticipated, since said territory is and will remain within the Minnesota Public Utilities Commissions' Service Area of Minnesota Power Company. This section is not applicable since there is currently no service to this territory.

Orderly Annexation Agreement  
page two

5. It is agreed that upon annexation, the City of Little Falls will reimburse, with two yearly payments to the Township of Belle Prairie, one hundred and fifty percent [150%] of the township's portion of the property taxes due and payable in 2010, [i.e. 40.86], for a total payment of \$61.29.

6. It is therefore agreed that the following property be immediately annexed to the City of Little Falls, to wit:

That part of the Southeast Quarter of the Northwest Quarter (SE 1/4 NW 1/4) of Section 26, Township 41 North, Range 32 West, shown as Parcel 10 on Minnesota Department of Transportation Right of Way Plat Numbered 49-64 as the same is on file and of record in the Office of the Morrison County Recorder, Minnesota; and

That part of the Northeast Quarter (NE 1/4) and part of the North Half of the Southeast Quarter (N1/2 SE1/4), Section 23, Township 41, Range 32, described in Document No. 459945 recorded in the Morrison County Recorders Office, Minnesota; and

That part of the highway right-of-way of Trunk Highway 371 in Sections 23, 24 and 26, Township 41, Range 32 shown on Minnesota Department of Transportation Right-of-Way Plats, No. 49-42, 49-43, 49-44, 49-45 and 49-64, recorded in the Morrison County Recorders Office, Minnesota, except any portions previously annexed.

7. The City of Little Falls and Township of Belle Prairie certify that the total acreage is 73.67 acres more or less and the current population of said property is zero [0].

8. Both Belle Prairie Township and the City of Little Falls agree that no alteration of the stated boundaries of this Agreement is appropriate. Furthermore, each party agrees that no consideration by the Office of Administrative Hearings, Municipal Boundary Adjustments, is necessary. Upon receipt of this Resolution, passed and adopted by each party, the Office of Administrative Hearings, Municipal Boundary Adjustments, may review and comment, but shall within thirty [30] days, order the annexation in accordance with the terms of this Joint Resolution.

Approved by the Town Board of Belle Prairie Township, this 12<sup>th</sup> day of July, 2010.

*BELLE PRAIRIE TOWNSHIP*

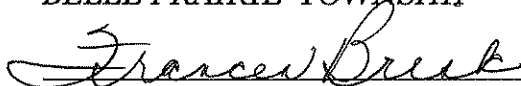

Frances Brisk  
Chairperson



Virginia Tembreull  
Clerk

Passed this 19th day of July, 2010.

*CITY OF LITTLE FALLS*



Urban L. Otremba  
Council President

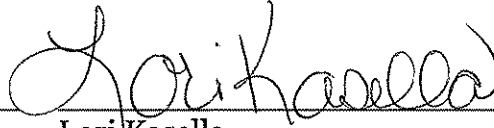

Lori Kasella  
Acting City Administrator

Approved this 19th day of July, 2010.

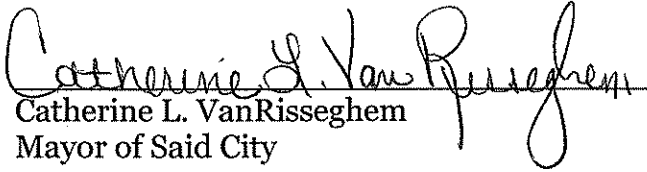

Catherine L. VanRisseghem  
Mayor of Said City

[SEAL]

REC'D BY  
MBA JUL 28 2010

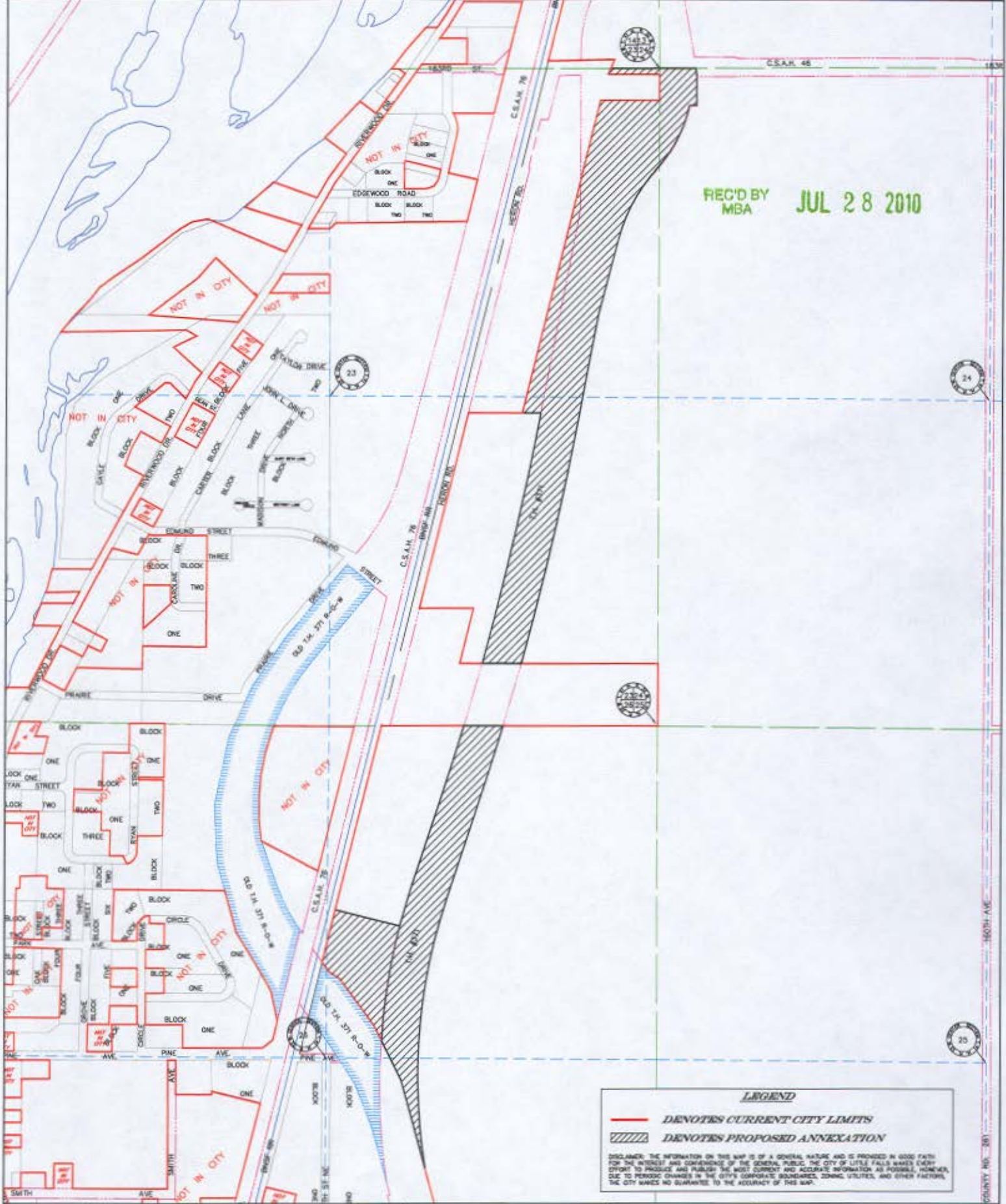

**LEGEND**

— DENOTES CURRENT CITY LIMITS

▨ DENOTES PROPOSED ANNEXATION

DISCLAIMER: THE INFORMATION ON THIS MAP IS OF A GENERAL NATURE AND IS PROVIDED IN GOOD FAITH FOR THE INTEREST AND CONVENIENCE OF THE GENERAL PUBLIC. THE CITY OF LITTLE FALLS MAKES EVERY EFFORT TO PRODUCE AND PUBLISH THE MOST CURRENT AND ACCURATE INFORMATION AS POSSIBLE, HOWEVER, DUE TO PERIODIC CHANGES IN THE CITY'S CORPORATE BOUNDARIES, ZONING UTILITIES, AND OTHER FACTORS, THE CITY MAKES NO GUARANTEE TO THE ACCURACY OF THIS MAP.

SHEET NO.  
**1**  
OF  
**1**

CITY OF LITTLE FALLS  
LITTLE FALLS, MINNESOTA

**Proposed Annexation**

JOB NUMBER:  
SCALE: 1"=1000'  
DRAWN BY: B.D.R  
CHECKED BY: D.H.S  
PLOTTED: 7/12/2010 11:12 AM

