

JOINT RESOLUTION

Eagle Lake Resolution 2009-41

Mankato Township Resolution 209-11

REC'D BY
MBA

DEC 01 2009

IN THE MATTER OF THE ORDERLY ANNEXATION BETWEEN THE
CITY OF EAGLE LAKE AND MANKATO TOWNSHIP
PURSUANT TO MINNESOTA STATUTES SECTION 414.0325

WHEREAS, the City of Eagle Lake and Mankato Township designate for orderly annexation, the following described lands located within Mankato Township, County of Blue Earth, Minnesota:

LEGAL DESCRIPTION: That part of the West Half of the Southeast Quarter of Section 13, Township 108 North Range 26 West, Blue Earth County, Minnesota, described as:

Commencing at the southeast corner of the West Half of the Southeast Quarter of said Section 13; thence North 00 degrees 02 minutes 27 seconds West, (assumed bearing), along the east line of the West Half of the Southeast Quarter of said Section 13, a distance of 1,584.67 feet to the point of beginning; thence continuing North 00 degrees 02 minutes 27 seconds West, along said east line, a distance of 540.00 feet; thence South 89 degrees 57 minutes 33 seconds West, a distance of 439.46 feet, thence South 00 degrees 02 minutes 27 seconds East, a distance of 540.00 feet; thence North 89 degrees 57 minutes 33 seconds East, a distance of 439.46 feet to the point of beginning.

And,

WHEREAS, the City of Eagle and Mankato Township are in agreement as to the orderly annexation of the unincorporated land described; that both believe it will be to their benefit and to the benefit of their respective residents; and

WHEREAS, Minnesota Statute Section 414.0325 provides a procedure whereby the City of Eagle Lake and Mankato Township may agree on a process of orderly annexation of a designated area; and

WHEREAS, the City of Eagle Lake and Mankato Township have agreed to all the terms and conditions for the annexation of the above-described lands within this document and the signatories hereto agree that no alteration of the designated area is appropriate and no consideration by the Chief of Administrative Law Judge is necessary. The Chief Administrative Law Judge may review and comment, but shall within thirty (30) days, order the annexation in accordance with the terms of the resolution.

NOW THEREFORE, BE IT RESOLVED, jointly by the City Council of the City of Eagle Lake and the Township Board of Mankato Township as follows:



1. (Property). That the following described lands in Mankato Township are subject to orderly annexation pursuant to Minnesota Statutes Section 414.0325. It is therefore agreed that the following property be immediately annexed to the City of Eagle Lake, to wit:

LEGAL DESCRIPTION: That part of the West Half of the Southeast Quarter of Section 13, Township 108 North Range 26 West, Blue Earth County, Minnesota, described as:

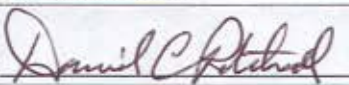

Commencing at the southeast corner of the West Half of the Southeast Quarter of said Section 13; thence North 00 degrees 02 minutes 27 seconds West, (assumed bearing), along the east line of the West Half of the Southeast Quarter of said Section 13, a distance of 1,584.67 feet to the point of beginning; thence continuing North 00 degrees 02 minutes 27 seconds West, along said east line, a distance of 540.00 feet; thence South 89 degrees 57 minutes 33 seconds West, a distance of 439.46 feet, thence South 00 degrees 02 minutes 27 seconds East, a distance of 540.00 feet; thence North 89 degrees 57 minutes 33 seconds East, a distance of 439.46 feet to the point of beginning.

2. (Acreage/Population/Usage.) That the designated area consists of approximately 5.45 acres, the population in the subject area is 0, and the land use type is Agricultural.
3. (Jurisdiction.) That Mankato Township and the City of Eagle Lake, by submission of this joint resolution to the Municipal Boundary Adjustment Unit of the Office of Administrative Hearings, confers jurisdiction upon the Chief Administrative Law Judge so as to accomplish said orderly annexation in accordance with the terms of this resolution.
4. (Need.) That the above-described property is urban or about to become so, and since the City of Eagle Lake is capable of providing services to this area within a reasonable time, the annexation would be in the best interest of the area.
5. (Municipal Reimbursement.) The City of Eagle Lake will reimburse Mankato Township for the loss of taxes generated for the property annexed. For the year following the tax year in which the Township last collects a levy, the City will reimburse the Township ninety percent (90%) of the amount of taxes that were collected by the Township in the previous year. For Each year thereafter, the City will reimburse a declining amount adjusted by ten percent (10%) per year thereafter; the City will reimburse a declining amount adjusted by ten percent (10%) of the original amount. Thereafter, the City will no longer reimburse the Township.
6. (Review and Comment.) The City of Eagle Lake and Mankato Township agree that upon receipt of this resolution, passed and adopted by each party, the Chief Administrative Law Judge may review and comment, but shall within thirty (30) days, order the annexation in accordance with the terms of the resolution.

Adopted by affirmative vote of all members of the Mankato Township Board of Supervisors this 18th day of November 2009.

Mankato Township		ATTEST:
By: 		By: 
Chairperson Board of Supervisor		Township Clerk

Adopted by affirmative vote of the City Council of Eagle Lake, this 2nd day of November 2009.

City of Eagle Lake		ATTEST:
By: 		By: 
Mayor		City Administrator

REC'D BY
MBA

DEC 01 2009

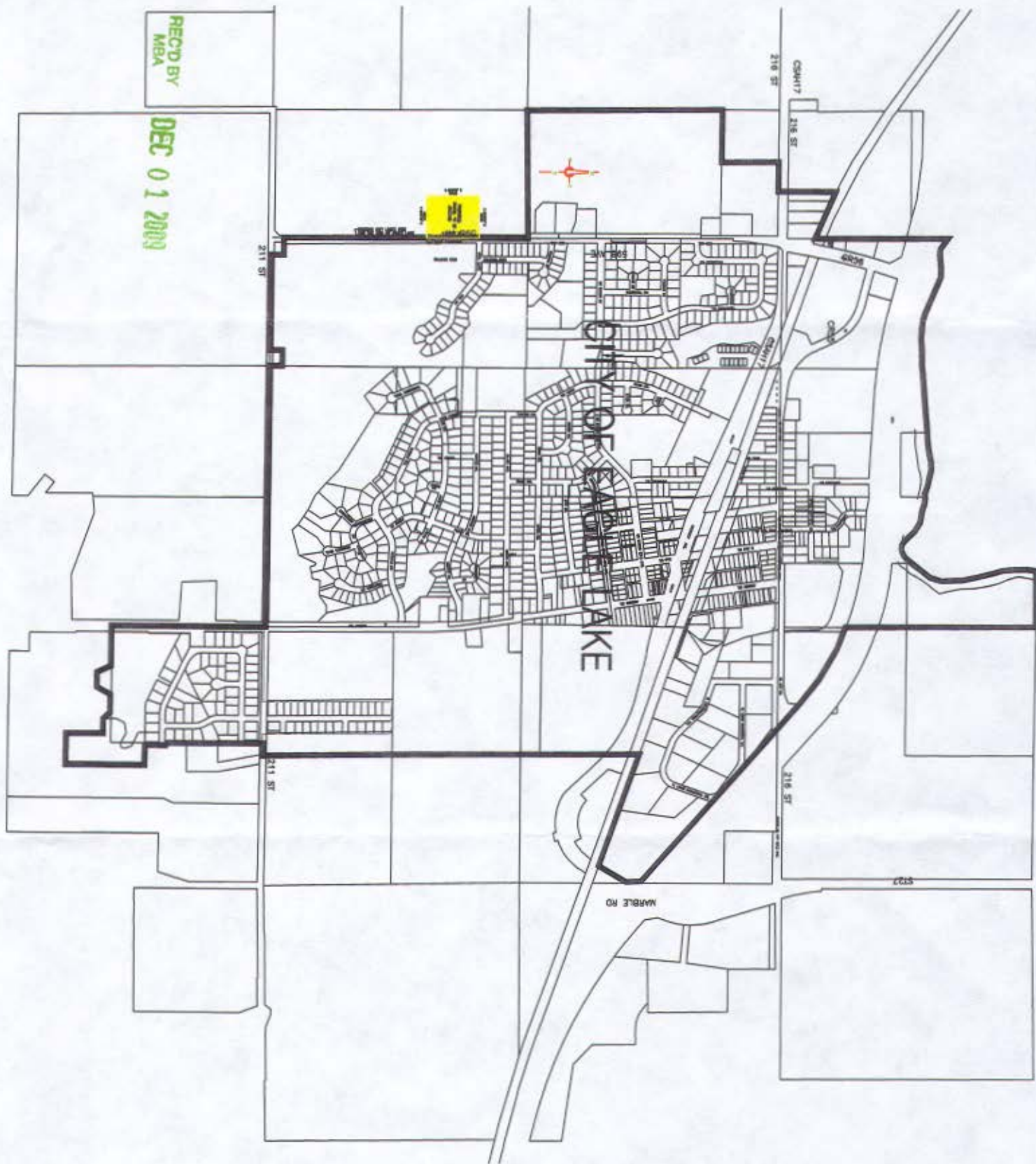

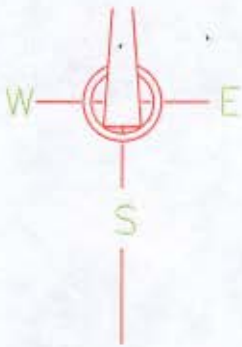

REC'D BY
MBA

DEC 01 2009

S 89°57'33" W
439.46

S 00°02'27" E
540.00

PROPOSED
PARCEL TO BE
ANNEXED

439.46
N 89°57'33" E

EXISTING CITY LIMITS LINE
FOR THE CITY OF EAGLE LAKE

N 89°57'33" W 866.91

598 AVE.

598 AVE.

FALCON CT

FALCON RUN

OWL LANE

FALCON RUN

OWL LN