

REC'D BY
MAM

MAR 20 2009

**JOINT RESOLUTION FOR ORDERLY ANNEXATION
RESOLUTION NO. 2009-02**

IN THE MATTER OF THE JOINT RESOLUTION OF THE TOWNSHIP OF NEW LONDON AND THE CITY OF NEW LONDON DESIGNATING AN UNINCORPORATED AREA AS IN NEED OF ORDERLY ANNEXATION AND CONFERRING JURISDICTION OVER SAID AREA TO THE OFFICE OF ADMINISTRATIVE HEARINGS-MUNICIPAL BOUNDARY ADJUSTMENTS, PURSUANT TO 414.0325.

The Township of New London and the City of New London hereby agree to the following:

That the following described area in New London Township is subject to orderly annexation pursuant to Minnesota Statutes 414.0325, and the parties hereto designate this area for orderly annexation:

Part of the SW $\frac{1}{4}$ of NE $\frac{1}{4}$ of Section 10, Township 121, Range 34 described as follows, to wit: Commencing at a point 66 feet East of the Southeast corner of Block 4 of Larson's Addition to the village of New London, thence North and parallel to the East line of said Larson's Addition a distance of 673.5 feet to the point of beginning of the tract to be described; thence East a distance of 75 feet to a point; thence North and parallel to the extension Northerly of the East line of said Larson's Addition to the North line of the SW $\frac{1}{4}$ of NE $\frac{1}{4}$; thence West on and along the North line of said SW $\frac{1}{4}$ of NE $\frac{1}{4}$ to a point 66 feet East of the projected East line of said Larson's Addition, thence South to the point of beginning. EXCEPT that part that is now a public road.

Containing .22 acres (9,669 square feet), more or less.

That the Township of New London does, upon passage of this resolution and its adoption by the City Council of the City of New London, Minnesota, and upon acceptance by the Office of Administrative Hearings-Municipal Boundary Adjustments, confer jurisdiction upon the Office of Administrative Hearings-Municipal Boundary Adjustments over the various provisions contained in this agreement. No consideration by upon the Office of Administrative Hearings-Municipal Boundary Adjustments is necessary, upon the Office of Administrative Hearings-Municipal Boundary Adjustments review and comment, but shall, within 30 days, order the annexation in accordance with the terms of the resolution.

Certain properties are presently residential in nature or are about to become so. Further, the City of New London is capable of providing services to this area immediately.

REC'D BY
MAM

MAR 20 2009

City of New London

Passed and adopted by the City council of the City of New London this 11th day of March, 2009.

BY:

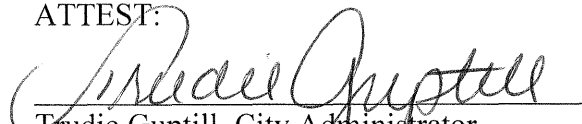

Bill Gossman, Mayor

ATTEST:

Trudie Guptill, City Administrator

State of Minnesota
County of Kandiyohi

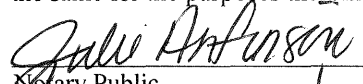
On this 11th day of March 2009, before me, the undersigned notary public, personally appeared Bill Gossman, Mayor, and Trudie Guptill, City Administrator; on behalf of the City of New London, known to me to be the person whose name is subscribed to the within instrument and acknowledged that he executed the same for the purposes therein contained. In witness whereof, I hereunto set my hand and official seal.

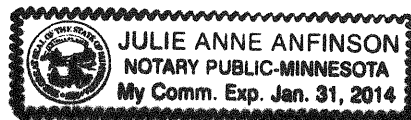

Notary Public
My commission expires 1/31, 2014



Township of New London

Passed and adopted by the township board of the township of New London this 5th day of March 2009.

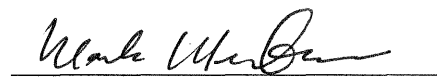
BY:

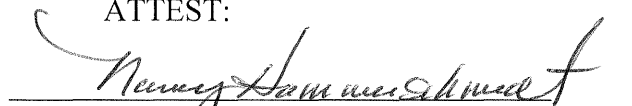

Mark Mertens, Township Chair

ATTEST:

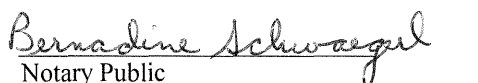

Nancy Hammerschmidt, Township Clerk

State of Minnesota
County of Kandiyohi

On this 5th day of March 2009, before me, the undersigned notary public, personally appeared Mark Mertens, Township Chair; and Nancy Hammerschmidt, Township Clerk; on behalf of the Township of New London, known to me to be the person whose name is subscribed to the within instrument and acknowledged that he executed the same for the purposes therein contained. In witness whereof, I hereunto set my hand and official seal.

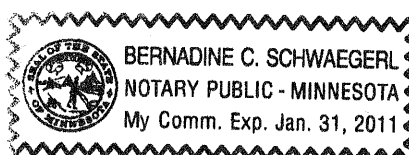

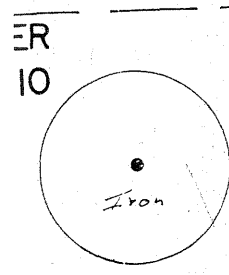
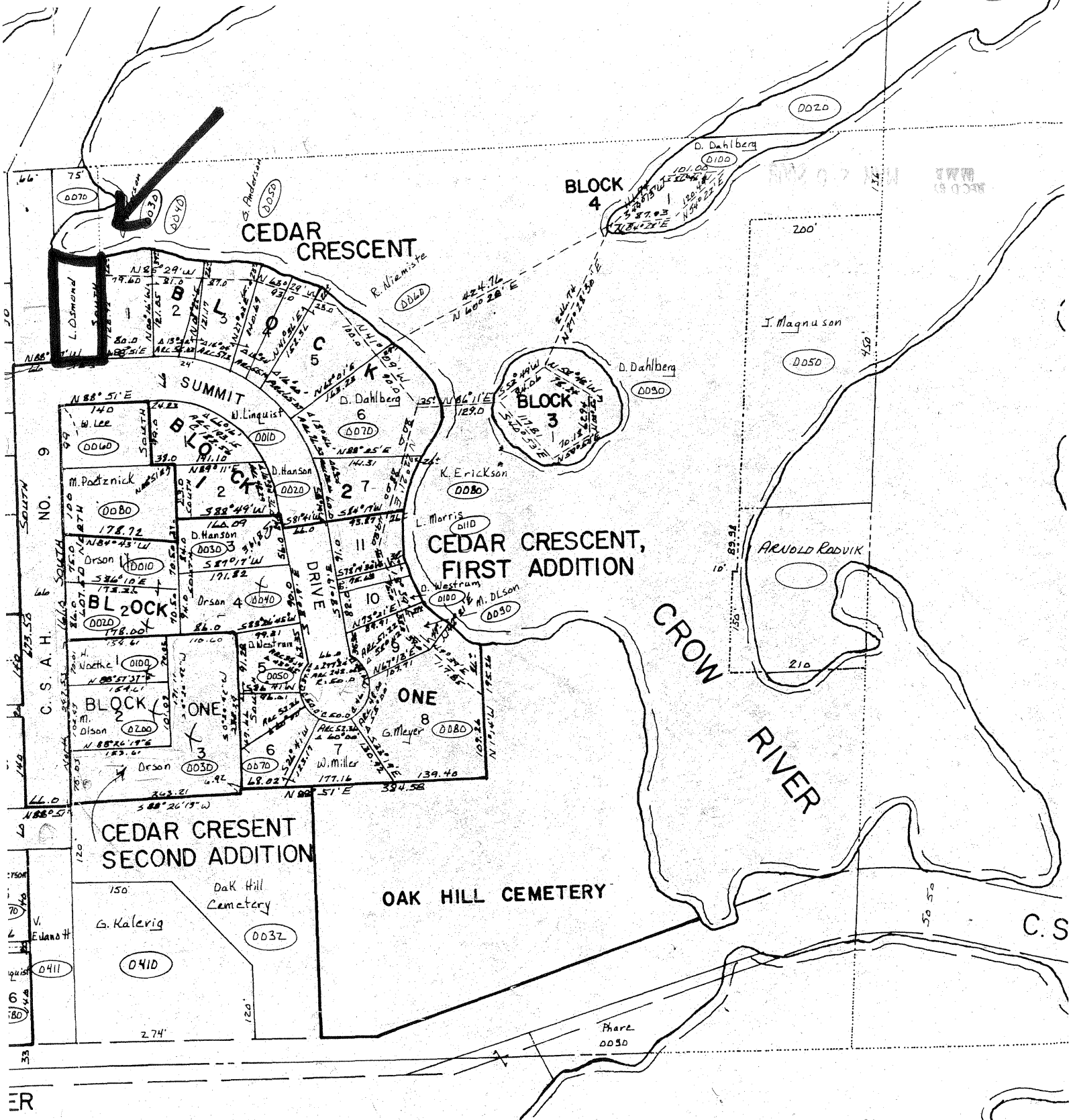
Notary Public
My commission expires Jan 31, 2011



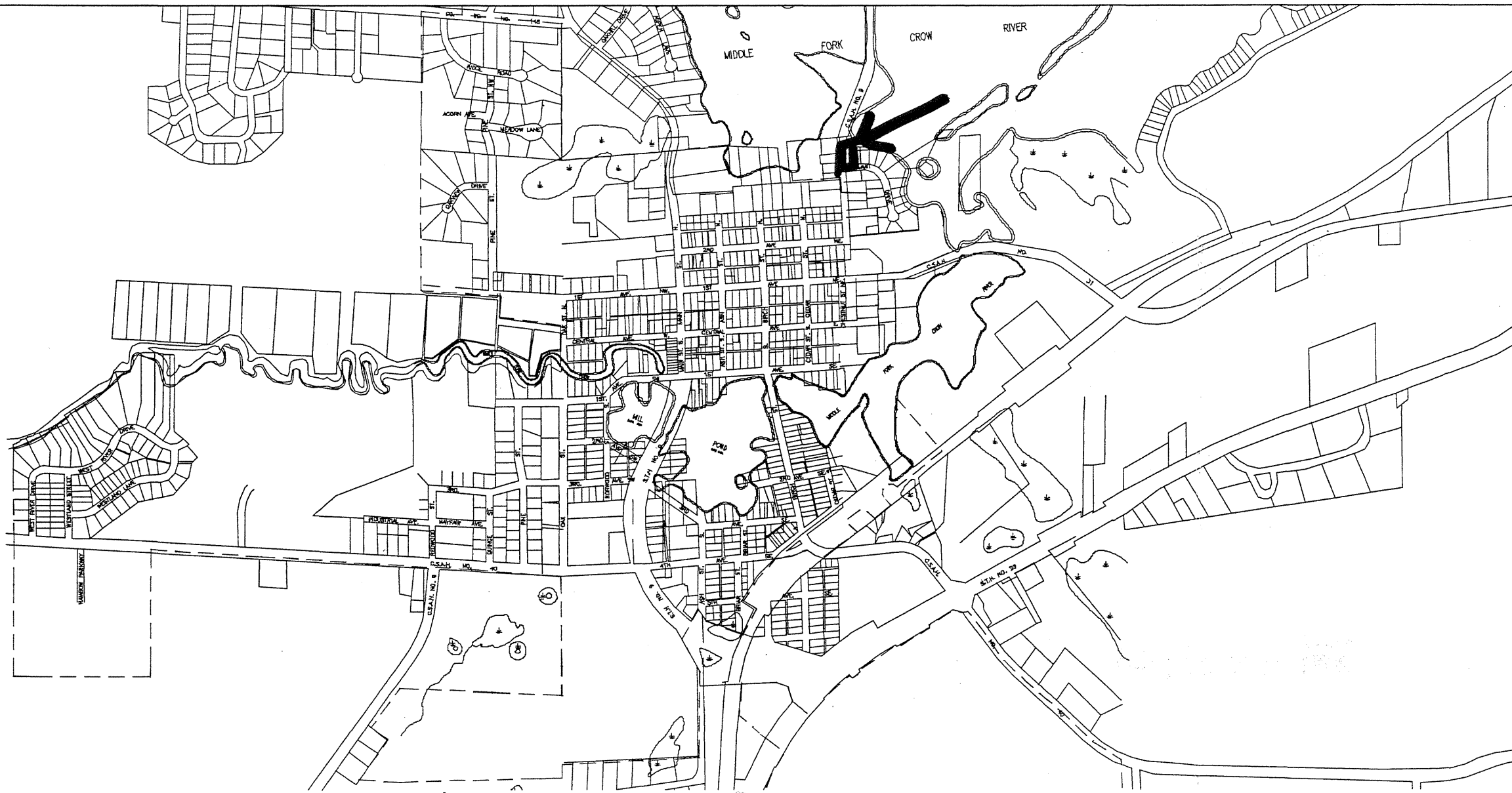

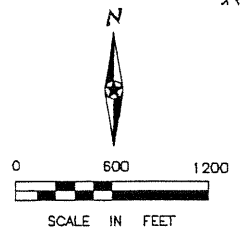

BOLTON & MENK, INC.
Consulting Engineers & Surveyors
MANKATO, MN FAIRMONT, MN SLEEPY EYE, MN WILLMAR, MN
BURNSVILLE, MN CHASKA, MN AMES, IA



**BASE
MAP**
JANUARY, 2005

MAP OF THE
CITY OF NEW LONDON
KANDIYOHI COUNTY, MINNESOTA