

REC'D. BY OCT 12 1995  
MMB

RESOLUTION NUMBER 1841 , SECOND SERIES

AMENDMENT TO THE JOINT RESOLUTION FOR ORDERLY ANNEXATION

IN THE MATTER OF THE AMENDMENT TO THE JOINT RESOLUTION  
FOR ORDERLY ANNEXATION BETWEEN THE TOWN OF FAIRVIEW  
AND THE CITY OF MARSHALL, MINNESOTA  
PURSUANT TO MINNESOTA STATUTES 414.0324, SUBD. 1

TO: Minnesota Municipal Board  
165 Metro Square Building  
St. Paul, Minnesota 55101

The Township of Fairview and the City of Marshall hereby jointly agree that the area designated for orderly annexation in the Joint Resolution Between the Town of Fairview and the City of Marshall Designating an Area for Orderly Annexation dated April 23, 1982 be amended to include the following:

Both the Town and the City agree that no alteration of the stated boundaries of this agreement is appropriate. Furthermore, both parties agree that no consideration by the Board is necessary. Upon receipt of this resolution, the Municipal Board may review and comment, but shall, within 30 days, order the annexation of the following-described property in accordance with the terms of the joint resolution.

All that part of the Northeast Quarter (NE¼) of Section Twenty-eight (28), Township One Hundred Twelve (112) North, Range Forty-one (41) West lying southeasterly of the southeasterly right-of-way of the Burlington Northern Railway Company, and westerly of the east line of Fairview Township Road No. T-306 established by resolution recorded on January 19, 1988 in Book 63 of Misc., page 191 as Doc. No. 68931, subject to road right-of-way, said area containing 10.33 acres more or less.

Approved by the City of Marshall this 5th day of September, 1995.

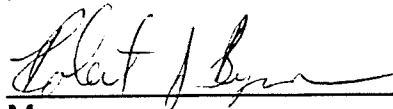
  
\_\_\_\_\_

Mayor

  
\_\_\_\_\_

City Clerk / Financial Director

Approved by the Town of Fairview this 2 day of October, 1995.

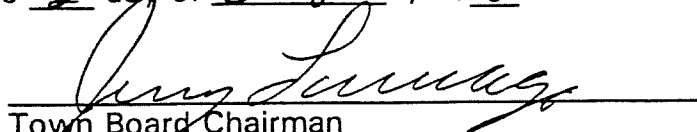
  
\_\_\_\_\_

Town Board Chairman

  
\_\_\_\_\_

Town Board Clerk

REC'D. BY OCT 12 1995  
MMB

(2) - 10.33  
ACRES

(1) - 11.24  
ACRES



Proposed Annexation

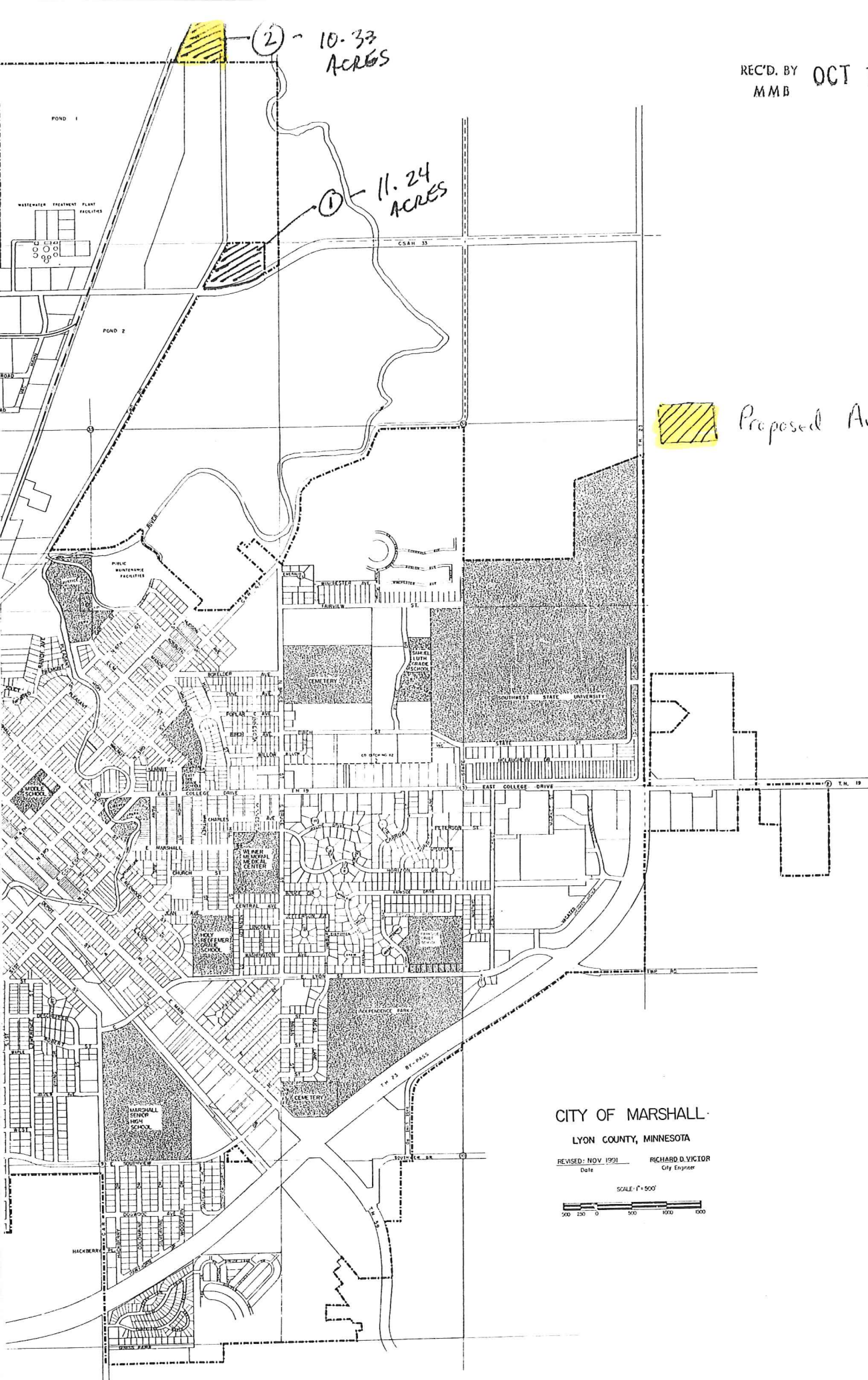

CITY OF MARSHALL

LYON COUNTY, MINNESOTA

REVISED: NOV 1991 Date RICHARD D. VICTOR City Engineer

SCALE: 1" = 500'

