

RECEIVED SEP 28 1995  
MMA

RESOLUTION NUMBER 1838 , SECOND SERIES

AMENDMENT TO THE JOINT RESOLUTION FOR ORDERLY ANNEXATION

IN THE MATTER OF THE AMENDMENT TO THE JOINT RESOLUTION  
FOR ORDERLY ANNEXATION BETWEEN THE TOWN OF LAKE MARSHALL AND  
THE CITY OF MARSHALL, MINNESOTA  
PURSUANT TO MINNESOTA STATUTES 414.0324, SUBD. 1

TO: Minnesota Municipal Board  
165 Metro Square Building  
St. Paul, Minnesota 55101

The Township of Lake Marshall and the City of Marshall hereby jointly agree that the area designated for orderly annexation in the Joint Resolution Between the Town of Lake Marshall and the City of Marshall Designating an Area for Orderly Annexation dated April 23, 1982 be amended to include the following:

Both the Town and the City agree that no alteration of the stated boundaries of this agreement is appropriate. Furthermore, both parties agree that no consideration by the Board is necessary. Upon receipt of this resolution, the Municipal Board may review and comment, but shall, within 30 days, order the annexation of the following-described property in accordance with the terms of the joint resolution.

**All that part of the SE¼ of Section 8, Township 111, Range 41, lying South of the following described line, to-wit:**

Beginning at a point on the East line of said Section 8, Township 111, Range 41 which is 666 feet South of the South line of Block 2, Third Addition to Eatros Place, an addition the City of Marshall, Minnesota, thence Westerly and parallel with the South line of said Block 2, Third Addition to Eatros Place, to the North and South ¼ line of Section 8, EXCEPTING that portion thereof conveyed to the State of Minnesota by Warranty Deeds recorded in Book 146 of Deeds, pages 72-75.

Approved by the City of Marshall this 7th day of August, 1995.

  
\_\_\_\_\_  
Mayor  
  
\_\_\_\_\_  
City Clerk / Financial Director

Approved by the Town of Lake Marshall this 15 day of Sept, 1995.

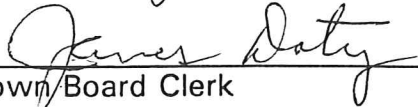
  
\_\_\_\_\_  
Town Board Chairman  
  
\_\_\_\_\_  
Town Board Clerk



REC'D. BY SEP 28 1995  
MAR

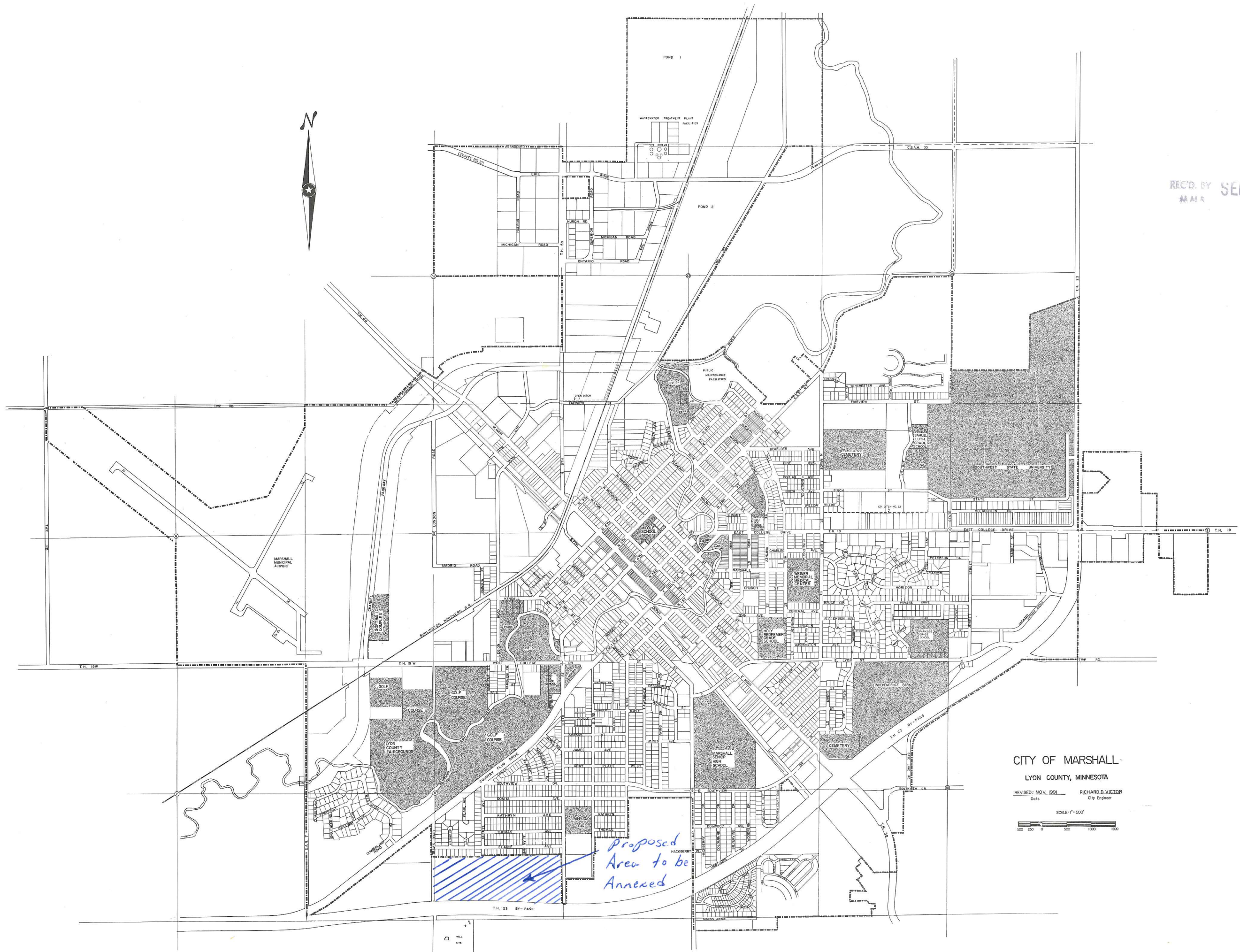

CITY OF MARSHALL  
LYON COUNTY, MINNESOTA  
REVISED: NOV. 1991  
Date  
RICHARD D. VICTOR  
City Engineer  
SCALE: 1" = 500'  
0 250 500 1000 1500