

Resolution Number 1627 , Second Series

AMENDMENT TO THE JOINT RESOLUTION FOR ORDERLY ANNEXATION

IN THE MATTER OF THE AMENDMENT TO THE JOINT RESOLUTION
FOR ORDERLY ANNEXATION BETWEEN THE TOWN OF LAKE MARSHALL
AND THE CITY OF MARSHALL, MINNESOTA
PURSUANT TO MINNESOTA STATUTES 414.0324, SUBD. 1

TO: Minnesota Municipal Board
165 Metro Square Building
St. Paul, Minnesota 55101

The Township of Lake Marshall and the City of Marshall hereby jointly agree that the area designated for orderly annexation in the Joint Resolution Between the Town of Lake Marshall and the City of Marshall Designating an Area for Orderly Annexation dated April 23, 1982 be amended to include the following:

Both the Town and the City agree that no alteration of the stated boundaries of this agreement is appropriate. Furthermore, both parties agree that no consideration by the Board is necessary. Upon receipt of this resolution, the Municipal Board may review and comment, but shall, within 30 days, order the annexation of the following-described property in accordance with the terms of the joint resolution.

ALL THAT PART OF THE E1/2 OF THE SW1/4 OF SECTION 9, T111N, R41W EXCEPTING THE N124' THEREOF, DESCRIBED AS FOLLOWS:

Commencing at the SE corner of the NW 1/4 of Section 9, T111N, R41W, thence S0°24'32"E assumed bearing a distance of 124 feet to point of beginning; thence S0°24'32"E a distance of 2533.27 feet; thence S89°57'48"E a distance of 1344.61 feet to the SE corner of the SW 1/4 Section 9; thence N0°41'45"W a distance of 2530.94 feet; thence N89°51'26"W a distance of 1331.94 feet to point of beginning; said area containing 77.79 acres more or less.

Approved by the City of Marshall this 20th day of December, 1993



Mayor

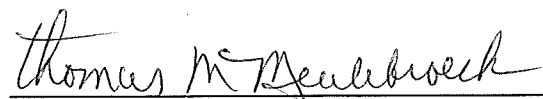

City Clerk / Financial Director

Ammendment to Joint Resolution For Orderly Annexation
All That Part of the E1/2 of the SW1/4 of Sec. 9, T111N, R41W
Excepting the N124 feet thereof
Page 2 of 2

Approved by the Town of Lake Marshall the 12 day of January, 1994

Floyd Wild
Town Board Chairman

James Doty
Town Board Clerk



REC'D. BY FEB 09 1994
MMB

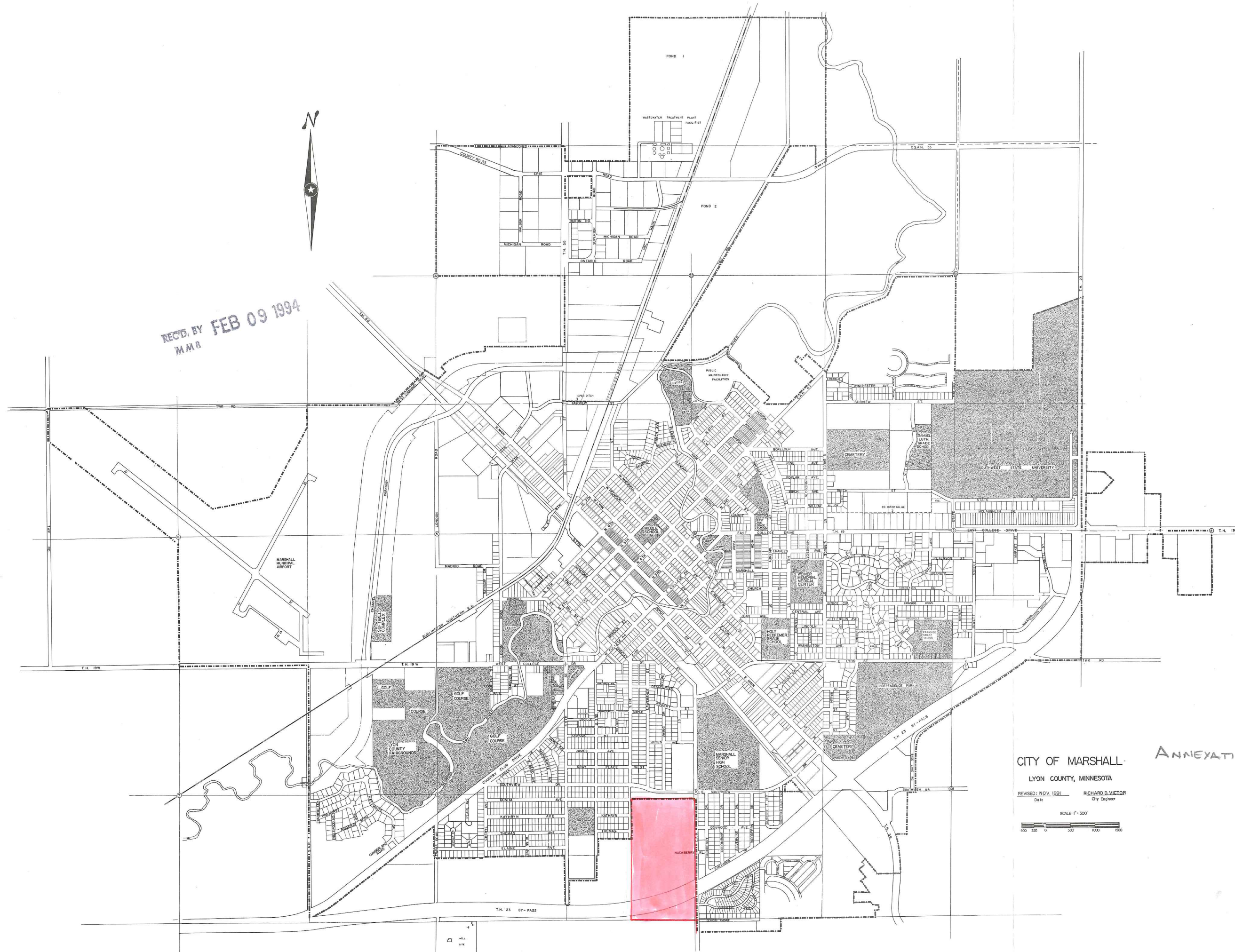

CITY OF MARSHALL
LYON COUNTY, MINNESOTA
REVISED: NOV. 1991
Date
RICHARD D. VICTOR
City Engineer
SCALE: 1" = 500'
0 250 500 1000 1500

ANNEXYATION