

**IN THE MATTER OF THE AMENDMENT TO THE JOINT RESOLUTION  
FOR ORDERLY ANNEXATION BETWEEN THE TOWN OF BLUE EARTH  
AND THE CITY OF BLUE EARTH, MINNESOTA  
PURSUANT TO MINNESOTA STATUTES 414.0325, SUBD. 1**

TO: Minnesota Planning  
Municipal Boundary Adjustments  
658 Cedar Street – Room 300  
Saint Paul, MN 55155-1603  
(651) 284-3383

The Town of Blue Earth and the City of Blue Earth hereby jointly agree that the Joint Resolution Between the Town of Blue Earth and the City of Blue Earth designating an area for Orderly Annexation dated January 24, 1977 be amended to include the following:

Both the Town and the City agree that no alteration of the stated boundaries of this agreement is appropriate. Furthermore, both parties agree that no consideration by the Minnesota Planning is necessary. Upon receipt of this resolution, Minnesota Planning may review and comment, but shall, within 30 days, order the annexation of the following described property in accordance with the terms of the joint resolution.

Commencing at a point in the center of the Blue Earth-Winnebago road where the same crosses and intersects the North boundary line of the City of Blue Earth, the same being in the boundary between the North Quarter of the Southwest Quarter (SW) of Section Eight (8), and being 1,110 feet West of the center of Section Eight (8) in Township One Hundred Two (102) North of Range Twenty-seven (27) West of the Fifth Principal Meridian, running thence West 36 rods; thence North 8.9 rods; thence East 36 rods, thence South 8.9 rods to the point of beginning; al being in the Northwest Quarter (NW $\frac{1}{4}$ ) of Section Eight (8) in Township One Hundred Two (102) North of Range Twenty-seven (27) West of the Fifth Principal Meridian, said premises being subject to easements of record, reserving unto the Grantor, an estate for and during the full term of her natural life.

AND

A tract bounded by a line commencing 8.9 rods North of a point 1110 feet West of the center of Section Eight (8) in Township One Hundred Two (102) North of Range Twenty-seven (27) West of the Fifth Principal Meridian in the County of Faribault and State of Minnesota; running thence North 7 rods, thence West 23 rods, thence South 7 rods and thence East 23 rods to the point of beginning.

AND

That part of the south 383 feet of the southeast quarter of the northwest quarter (SE $\frac{1}{4}$  NW $\frac{1}{4}$ ) of Section 8, Township 102 North, Range 27 West, lying easterly of the easterly boundary line of Trunk Highway No. 169 as now located and traveled and westerly of a line run parallel with and distant 400 feet westerly of the north and south quarter line of said section 8; containing 5.05 acres, more or less, in addition to the existing highway.

AND

A tract of land in the South Half of the Northeast Quarter (S $\frac{1}{2}$  NE $\frac{1}{4}$ ) of Section Nineteen (19), Township One Hundred Two (102) North, Range Twenty-seven (27) West of the Fifth Principal Meridian in the County of Faribault and State of Minnesota, described as follows:

Commencing at the Southwest corner of the Northeast Quarter of Section 19; thence North 90 degrees 00 minutes 00 seconds East (assumed bearing) along the South line of the Northeast Quarter of Section 19 (said line also being the centerline and centerline tangent of County State Aid Highway No. 6) a distance of 1130.8 feet to the point of intersection of the tangents of the circular curve therebeing (I=32°02' LT., D=8°00', T=205.86', L=400.63'); thence North 57 degrees 58 minutes 00 seconds East along the centerline tangent a distance of 187.14 feet to the point of beginning; thence continuing North 57 degrees 58 minutes 00 seconds East along the highway centerline and tangent thereto a distance of 211.06 feet to the Southwest corner of Valley Highlands Subdivision according to the plat thereof, on file and of record in the office of the Register of Deeds, Faribault County, Minnesota; thence North 1 degree 16 minutes 00 seconds East along the West line of Valley Highlands Subdivision a distance of 323.50 feet; thence North 89 degrees 01 minutes 00 seconds West a distance of 176.40 feet; thence South 1 degree 16 minutes 00 seconds West parallel with the West line of Valley Highlands Subdivision a distance of 438.51 feet to the point of beginning. Said tract contains 1.543 acres.

AND

A tract of land out of the Southeast Quarter of the Southwest Quarter (SE $\frac{1}{4}$  SW $\frac{1}{4}$ ) of Section Seven (7), Township One Hundred Two (102) North, Range Twenty-seven (27) West, more particularly described as follows: Commencing at a point 1374.7 feet East of the Southwest corner of said Section 7, thence North 1°13' West a distance of 73.6 feet to the North right-of-way line of U.S. Hwy. #16 for the point of beginning; thence North 1°13' West a distance of 125 feet; thence South 89°28' East a distance of 75 feet; thence South 1°13' East a distance of 125 feet; thence North 89°28' West along the North right-of-way line of U.S. Hwy. #16 a distance of 75 feet to the point of beginning.

Passed and adopted by the City Council of the City of Blue Earth on this 19<sup>th</sup> day of December, 2000.

**BY:**

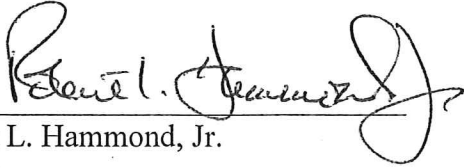

Robert L. Hammond, Jr.  
Mayor

**ATTEST:**

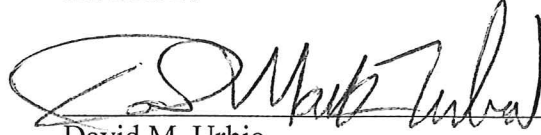

David M. Urbia  
City Clerk/Administrator

Passed and adopted by the Town of Blue Earth this 2 day of Jan, 2001.

**BY:**

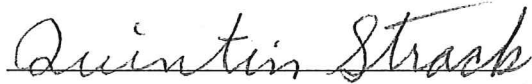

Quintin Strack  
Town Board Chair

**ATTEST:**

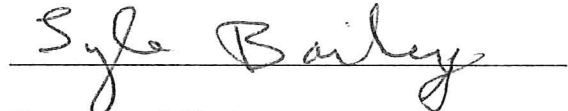

Syle Bailey  
Town Board Clerk

REC'D. BY MAR 05 2001  
M.M.B.

Jo Davies  
Old  
Subd. 2(1/3)

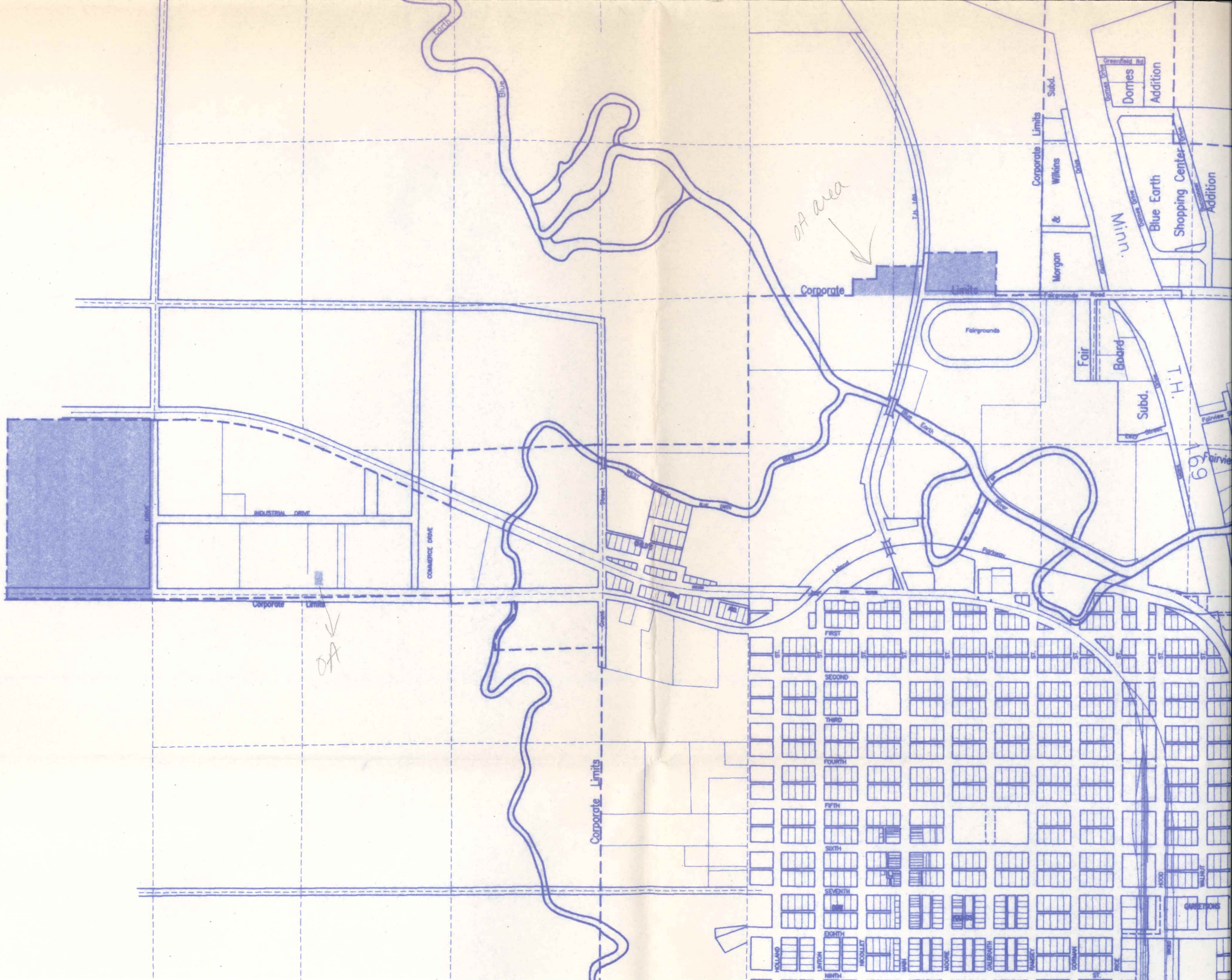

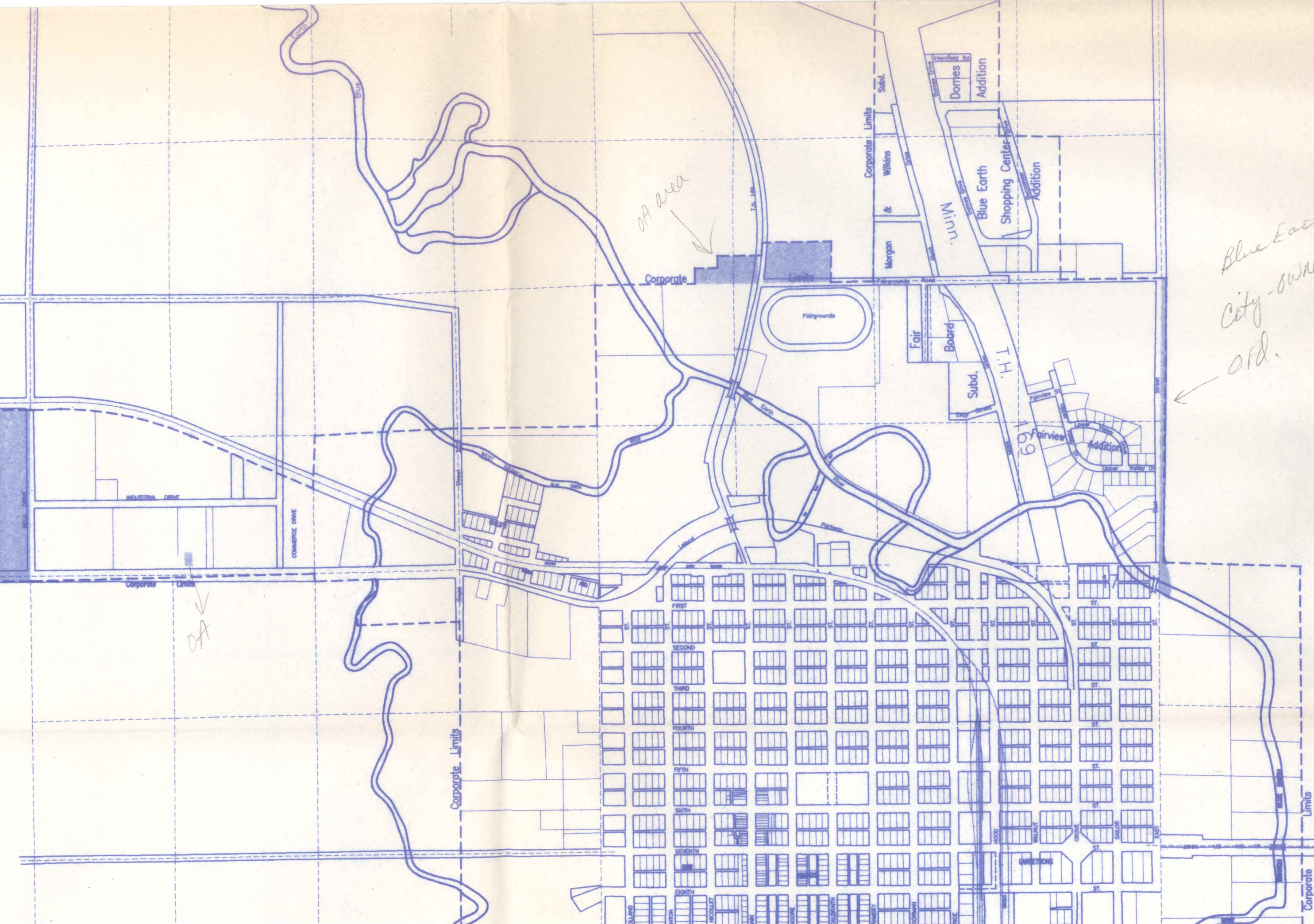

*OA area*

*OA*

*Blue Earth twp  
City-owned  
old.*