

RESOLUTION No. 6
A Joint Resolution of the City of Willmar and of
Willmar Township
Relating to Orderly Annexation

WHEREAS, the City of Willmar (hereinafter the "City") and the Township of Willmar (hereinafter "Township") deem it necessary and appropriate that they work together to develop and implement a process for the orderly and controlled growth of the City and the Township; and,

WHEREAS, the City and Township agree that orderly development with municipal services and the orderly annexation of certain unincorporated areas located in the Township is in the best interests of the community and of all affected political subdivisions; and,

WHEREAS, the land to be included in this plan for Orderly Annexation consists of the following Lands located in Kandiyohi County, Minnesota, described as follows, to-wit:

1. The east 255' of west 330' of east 660' of south 373' of north 883' of the NW ¼ of SW ¼ Section 23, Township 119, Range 35, (a parcel which consists of 2.18 acres, more or less), and
2. The north 990' of the east 660' of NW ¼ of SW ¼ excluding the northerly 135' thereof and excluding the west 75' of the south 375' of the north 510' and excluding the east 330' of the east 660' of the south 373' of the north 883' of NW ¼ of SW ¼ and excluding the south 107' of the north 990' of the west 175' of the east 660' of the NW ¼ of SW ¼ Section 23, Township 119, Range 35, (a parcel which consists of 9.06 acres, more or less), and
3. The south 107' of the north 990' of the west 175' of the east 660' of the NW ¼ of SW ¼ Section 23, Township 119, Range 35, (a parcel which consists of .43 acres, more or less), and
4. The Northeast Quarter of the Southwest Quarter of Section 23, Township 119, Range 35, Kandiyohi County, Minnesota.

And that part of the Southeast Quarter of the Southwest Quarter of Section 23, Township 119, Range 35, Kandiyohi County, Minnesota which lies North of the center line of County Ditch Number 23 running through said Southeast Quarter of the Southwest Quarter.

And that part of the Northwest Quarter of the Southwest Quarter of Section 23, Township 119, Range 35, Kandiyohi County, Minnesota described as follows: Beginning at the Southwest corner of the Northwest Quarter of the Southwest Quarter of Section 23; thence N 0 deg. 30 min. 22 sec. W along the West line of said Northwest Quarter of the Southwest Quarter (at 221.75 feet passing the Southwest corner of the tract conveyed to Duinick Brothers and Gilchrist (Microfilm # 34208) for a total distance of 296.77 feet

to the Southwest corner of a tract conveyed to Raymond Voit (Microfilm # 34229); thence S 89 deg. 43 min. 30 sec. E along the South line of said tract conveyed to Raymond Voit for a distance of 666.82 feet to the Southeast corner of said tract; thence N 0 deg. 31 min. 21 sec. W along the East line of said tract conveyed to Raymond Voit for a distance of 42.99 feet to a point in the South line of the North 990 feet of the Northwest Quarter of the Southwest Quarter of Section 23; thence S 89 deg. 43 min. 30 sec. E along the South line of the North 990 feet of said Northwest Quarter of the Southwest Quarter for a distance of 660.06 feet to a point in the East line of the Northwest Quarter of the Southwest Quarter of Section 23; thence S 0 deg. 31 min. 22 sec. E along said East line of said Northwest Quarter of the Southwest Quarter for a distance of 341.42 feet to the Southeast corner of Northwest Quarter of the Southwest Quarter of Section 23; thence N 89 deg. 39 min. 11 sec. W along the South line of said Northwest Quarter of the Southwest Quarter for a distance of 1327.00 feet to the point of beginning. All documents recited in this description are on record in the office of the County Recorder, Kandiyohi County, Minnesota.

And that part of Government Lots Number 1 and Number 2, Section 23, Township 119, Range 35, Kandiyohi County, Minnesota, lying southerly of Country Side Addition, a plat of record, lying northerly of the center line of County Ditch Number 23, lying northwesterly of Minnesota Trunk Highway 23-12-71 bypass right of way and lying westerly and southerly of the following description line, being the same line described in Microfilm # 338946: Beginning at the Southeast corner of said Country Side Addition; thence S 0 deg. 32 min. 21 sec. E for a distance of 60.00 feet; thence N 89 deg. 29 min. 14 sec. E for a distance of 75.08 feet; thence S 0 deg. 04 min. 05 sec. W for a distance 370.14 feet; thence S 34 deg. 13 min. 12 sec. for a distance of 324.60 feet to a point in the northwesterly right of way of said Trunk Highway 23-12-71 bypass and there terminating. All documents recited in this description are on record in the office of the County Recorder, Kandiyohi County, Minnesota.

And that part of the South Half of the Southwest Quarter of Section 23, Township 119, Range 35, Kandiyohi County, Minnesota described as follows: Beginning at the intersection of the North line of said South Half of the Southwest Quarter and the East line of the West 600 feet of said South Half of the Southwest Quarter; thence S 0 deg. 30 min. 22 sec. E along said East line of the West 600 feet for a distance of 343.34 feet to the Northwest corner of a tract conveyed to Dayton Hudson Corporation (microfilm # 352810); thence S 89 deg. 39 min. 11 sec. E along the North line of said tract for a distance of 110.01 feet to the Northeast corner of said tract; thence S 0 deg. 30 min. 22 sec. E along the East line of said tract for a distance of 551.76 feet to the Southeast corner of said tract; thence N 89 deg. 39 min. 11 sec. W along the South line of said tract for a distance a distance of 110.01 feet to the Southwest corner of said Dayton Hudson Corporation tract and said corner is also a point in the East line of the West 600 feet of the South Half of the Southwest Quarter of said Section 23; thence S 0 deg. 30 min. 22 sec. E along said East line of West 600 for a distance of 198.02 feet to a point in the South line of the North 1093 feet of said South Half of the Southwest Quarter; thence S 89 deg. 39 min. 11 sec. E. along the said South line of the North 1093 feet for a distance of 17.00 feet; thence S 0 deg. 30 min. 22 sec. E for a distance of 43.50 feet to the

Northwest corner of Country Inn Addition, a plat of record; thence S 89 deg. 34 min. 52 sec. E along the North line of said Country Inn Addition for a distance of 347.00 feet to the Northeast corner of said addition; thence S 0 deg. 30 min. 22 sec. E. along the East line of said addition for a distance of 149.91 feet to a point in the center line of Branch Number 2 of County Ditch Number 23; thence along the center line of said Branch Number 2 the following 11 courses and distances, N 59 deg. 53 min. 14 sec. E for a distance of 16.77 feet; thence N 61 deg. 39 min. 19 sec. E. for distance of 204.74 feet; thence N 58 deg. 11 min. 14 sec. E for a distance of 62.73 feet; thence N 56 deg. 34 min. 29 sec. E for a distance of 59.24 feet; thence N 63 deg. 42 min. 37 sec. E for a distance of 67.34 feet; thence N 58 deg. 22 min. 30 sec. E for a distance of 466.39; thence N 57 deg. 12 min. 06 sec. E for a distance of 220.05 feet; N 58 deg. 58 min. 08 sec. E for a distance of 575.94 feet; thence N 55 deg. 28 min. 36 sec. E for a distance of 43.38 feet; thence N 61 deg. 18 min. 35 sec. E for a distance of 57.99 feet; N 76 deg. 39 min. 08 sec. E for a distance of 63.04 feet to center line of County Ditch Number 23; thence along the center line of said County Ditch Number 23 the following 6 course and distances, N 56 deg. 27 min. 33 sec. W for a distance of 70.10 feet; thence N 63 deg. 44 min. 10 sec. W for a distance of 211.59 feet; thence N 64 deg. 20 min. 50 sec. W for a distance of 278.52 feet; thence N 64 deg. 01 min. 39 sec. W for a distance of 115.04 feet; thence N 70 deg. 40 min. 56 sec. W for a distance of 97.79 feet; thence N 58 deg. 39 min. 23 sec. W for a distance of 33.11 feet to a point in the North line of the South Half of the Southwest Quarter of said Section 23; thence N 89 deg. 39 min. 11 sec. W with said North line of the South Half of the Southwest Quarter for a distance of 1233.53 to point of beginning. All documents recited in this description are on record in the office of the County recorder, Kandiyohi County, Minnesota.

Excepting therefrom the North 497.61 ft of the South 1626.62 feet of the West 666.82 feet of the Southwest $\frac{1}{4}$ of said Section 23 (Exception A) and the Northerly 135 feet of the Northeast $\frac{1}{4}$ of the Southwest $\frac{1}{4}$ of said Section 23 (Exception B), (parcels consisting of 102.23 acres, more or less)

Totaling 113.90 acres more or less

And that these parcels, (hereinafter referred to as Annexation Properties) consist of areas that will best be served by the municipal services available through the City of Willmar; and,

WHEREAS, Minnesota Statutes Sections 414.0325 and the following, provides a procedure whereby the City and the Township may agree on a process of orderly annexation of a designated area; and

WHEREAS, the City and the Township desire to accomplish orderly annexation of said area in a mutually acceptable and beneficial manner without the need for a hearing before the Minnesota Municipal Board; and

WHEREAS, The City and Township have determined that no alteration of the stated boundaries of **Annexation Properties** is appropriate, and that no consideration by the Minnesota Municipal Board is necessary.

NOW, THEREFORE, BE IT RESOLVED by the City Council of the City of Willmar and by the Board of supervisors of the Town of Willmar jointly as follows:

1. **Designation of Orderly Annexation Areas.** The City and Township designate the following lands located in Kandiyohi County, Minnesota, as being in need of orderly annexation pursuant to Minnesota Statutes S 414.0325:
 - A. The east 255' of west 330' of east 660' of south 373' of north 883' of the NW ¼ of SW ¼ Section 23, Township 119, Range 35, (a parcel which consists of 2.18 acres, more or less), and
 - B. The north 990' of the east 660' of NW ¼ of SW ¼ excluding the northerly 135' thereof and excluding the west 75' of the south 375' of the north 510' and excluding the east 330' of the east 660' of the south 373' of the north 883' of NW ¼ of SW ¼ and excluding the south 107' of the north 990' of the west 175' of the east 660' of the NW ¼ of SW ¼ Section 23, Township 119, Range 35, (a parcel which consists of 9.06 acres, more or less), and
 - C. The south 107' of the north 990' of the west 175' of the east 660' of the NW ¼ of SW ¼ Section 23, Township 119, Range 35, (a parcel which consists of .43 acres, more or less), and
 - D. The Northeast Quarter of the Southwest Quarter of Section 23, Township 119, Range 35, Kandiyohi County, Minnesota.

And that part of the Southeast Quarter of the Southwest Quarter of Section 23, Township 119, Range 35, Kandiyohi County, Minnesota which lies North of the center line of County Ditch Number 23 running through said Southeast Quarter of the Southwest Quarter.

And that part of the Northwest Quarter of the Southwest Quarter of Section 23, Township 119, Range 35, Kandiyohi County, Minnesota described as follows: Beginning at the Southwest corner of the Northwest Quarter of the Southwest Quarter of Section 23; thence N 0 deg. 30 min. 22 sec. W along the West line of said Northwest Quarter of the Southwest Quarter (at 221.75 feet passing the Southwest corner of the tract conveyed to Duininck Brothers and Gilchrist (Microfilm # 34208) for a total distance of 296.77 feet to the Southwest corner of a tract conveyed to Raymond Voit (Microfilm # 34229); thence S 89 deg. 43 min. 30 sec. E along the South line of said tract conveyed to Raymond Voit for a distance of 666.82 feet to the Southeast corner of said tract; thence N 0 deg. 31 min. 21 sec. W along the East line of said tract conveyed to Raymond Voit for a distance of 42.99 feet to a point in the South line of the North 990 feet of the Northwest Quarter of the Southwest Quarter of Section 23;

thence S 89 deg. 43 min. 30 sec. E along the South line of the North 990 feet of said Northwest Quarter of the Southwest Quarter for a distance of 660.06 feet to a point in the East line of the Northwest Quarter of the Southwest Quarter of Section 23; thence S 0 deg. 31 min. 22 sec. E along said East line of said Northwest Quarter of the Southwest Quarter for a distance of 341.42 feet to the Southeast corner of Northwest Quarter of the Southwest Quarter of Section 23; thence N 89 deg. 39 min. 11 sec. W along the South line of said Northwest Quarter of the Southwest Quarter for a distance of 1327.00 feet to the point of beginning. All documents recited in this description are on record in the office of the County Recorder, Kandiyohi County, Minnesota.

And that part of Government Lots Number 1 and Number 2, Section 23, Township 119, Range 35, Kandiyohi County, Minnesota, lying southerly of Country Side Addition, a plat of record, lying northerly of the center line of County Ditch Number 23, lying northwesterly of Minnesota Trunk Highway 23-12-71 bypass right of way and lying westerly and southerly of the following description line, being the same line described in Microfilm # 338946: Beginning at the Southeast corner of said Country Side Addition; thence S 0 deg. 32 min. 21 sec. E for a distance of 60.00 feet; thence N 89 deg. 29 min. 14 sec. E for a distance of 75.08 feet; thence S 0 deg. 04 min. 05 sec. W for a distance 370.14 feet; thence S 34 deg. 13 min. 12 sec. for a distance of 324.60 feet to a point in the northwesterly right of way of said Trunk Highway 23-12-71 bypass and there terminating. All documents recited in this description are on record in the office of the County Recorder, Kandiyohi County, Minnesota.

And that part of the South Half of the Southwest Quarter of Section 23, Township 119, Range 35, Kandiyohi County, Minnesota described as follows: Beginning at the intersection of the North line of said South Half of the Southwest Quarter and the East line of the West 600 feet of said South Half of the Southwest Quarter; thence S 0 deg. 30 min. 22 sec. E along said East line of the West 600 feet for a distance of 343.34 feet to the Northwest corner of a tract conveyed to Dayton Hudson Corporation (microfilm # 352810); thence S 89 deg. 39 min. 11 sec. E along the North line of said tract for a distance of 110.01 feet to the Northeast corner of said tract; thence S 0 deg. 30 min. 22 sec. E along the East line of said tract for a distance of 551.76 feet to the Southeast corner of said tract; thence N 89 deg. 39 min. 11 sec. W along the South line of said tract for a distance a distance of 110.01 feet to the Southwest corner of said Dayton Hudson Corporation tract and said corner is also a point in the East line of the West 600 feet of the South Half of the Southwest Quarter of said Section 23; thence S 0 deg. 30 min. 22 sec. E along said East line of West 600 for a distance of 198.02 feet to a point in the South line of the North 1093 feet of said South Half of the Southwest Quarter; thence S 89 deg. 39 min. 11 sec. E. along the said South line of the North 1093 feet for a

distance of 17.00 feet; thence S 0 deg. 30 min. 22 sec. E for a distance of 43.50 feet to the Northwest corner of Country Inn Addition, a plat of record; thence S 89 deg. 34 min. 52 sec. E along the North line of said Country Inn Addition for a distance of 347.00 feet to the Northeast corner of said addition; thence S 0 deg. 30 min. 22 sec. E. along the East line of said addition for a distance of 149.91 feet to a point in the center line of Branch Number 2 of County Ditch Number 23; thence along the center line of said Branch Number 2 the following 11 courses and distances, N 59 deg. 53 min. 14 sec. E for a distance of 16.77 feet; thence N 61 deg. 39 min. 19 sec. E. for distance of 204.74 feet; thence N 58 deg. 11 min. 14 sec. E for a distance of 62.73 feet; thence N 56 deg. 34 min. 29 sec. E for a distance of 59.24 feet; thence N 63 deg. 42 min. 37 sec. E for a distance of 67.34 feet; thence N 58 deg. 22 min. 30 sec. E for a distance of 466.39; thence N 57 deg. 12 min. 06 sec. E for a distance of 220.05 feet; N 58 deg. 58 min. 08 sec. E for a distance of 575.94 feet; thence N 55 deg. 28 min. 36 sec. E for a distance of 43.38 feet; thence N 61 deg. 18 min. 35 sec. E for a distance of 57.99 feet; N 76 deg. 39 min. 08 sec. E for a distance of 63.04 feet to center line of County Ditch Number 23; thence along the center line of said County Ditch Number 23 the following 6 course and distances, N 56 deg. 27 min. 33 sec. W for a distance of 70.10 feet; thence N 63 deg. 44 min. 10 sec. W for a distance of 211.59 feet; thence N 64 deg. 20 min. 50 sec. W for a distance of 278.52 feet; thence N 64 deg. 01 min. 39 sec. W for a distance of 115.04 feet; thence N 70 deg. 40 min. 56 sec. W for a distance of 97.79 feet; thence N 58 deg. 39 min. 23 sec. W for a distance of 33.11 feet to a point in the North line of the South Half of the Southwest Quarter of said Section 23; thence N 89 deg. 39 min. 11 sec. W with said North line of the South Half of the Southwest Quarter for a distance of 1233.53 to point of beginning. All documents recited in this description are on record in the office of the County recorder, Kandiyohi County, Minnesota.

Excepting therefrom the North 497.61 ft of the South 1626.62 feet of the West 666.82 feet of the Southwest $\frac{1}{4}$ of said Section 23 (Exception A) and the Northerly 135 feet of the Northeast $\frac{1}{4}$ of the Southwest $\frac{1}{4}$ of said Section 23 (Exception B) (parcels consisting of 102.23 acres, more or less)

Totaling 113.90 acres more or less.

2. **No Minnesota Municipal Board Hearing is Required.** Subject to the terms and conditions of this Resolution, the City and Township hereby agree that **Annexation Properties** is in need of orderly annexation pursuant to Minnesota Statutes § 414.0325. No alteration of the stated boundaries is appropriate. No consideration by the Minnesota Municipal Board is necessary. All terms and conditions for annexation of said areas are provided for in this Resolution. The Minnesota Municipal Board may review and comment only. Within 30 days of receipt of this Joint Resolution, the Municipal Board

shall order the annexation of **Annexation Properties**, in accordance with this Joint Resolution.

3. **Municipal Reimbursement to Township.** The City shall reimburse the Township for the taxable property of parcel 1/A. and 2/B. (as described above) lost by annexation for a period of six (6) years following the last year in which the township would receive real estates for this property following annexation, and shall be paid according the schedule as follows:

Year 1:	100% of the Real Estate Tax paid to the Township in the year of annexation.		
Year 2:	80%	"	"
Year 3:	60%	"	"
Year 4:	40%	"	"
Year 5:	20%	"	"
Year 6:	10%	"	"
Year 7 and thereafter:	0%		

4. **Governing Law.** This Resolution is subject to the laws of the State of Minnesota.

AUG 05 2005

Passed and adopted by the City Council of the **City of Willmar** this 18th day of
July, 2005

Lester J. Vitke
Mayor

ATTEST:

[Signature]
City Clerk

Passed and adopted by the Town Board of Supervisors of the **Town of Willmar** this
11 day of July, 2005.

Benavon C. Monson
Chairperson

ATTEST:

Ronald J. Klein
Town Clerk

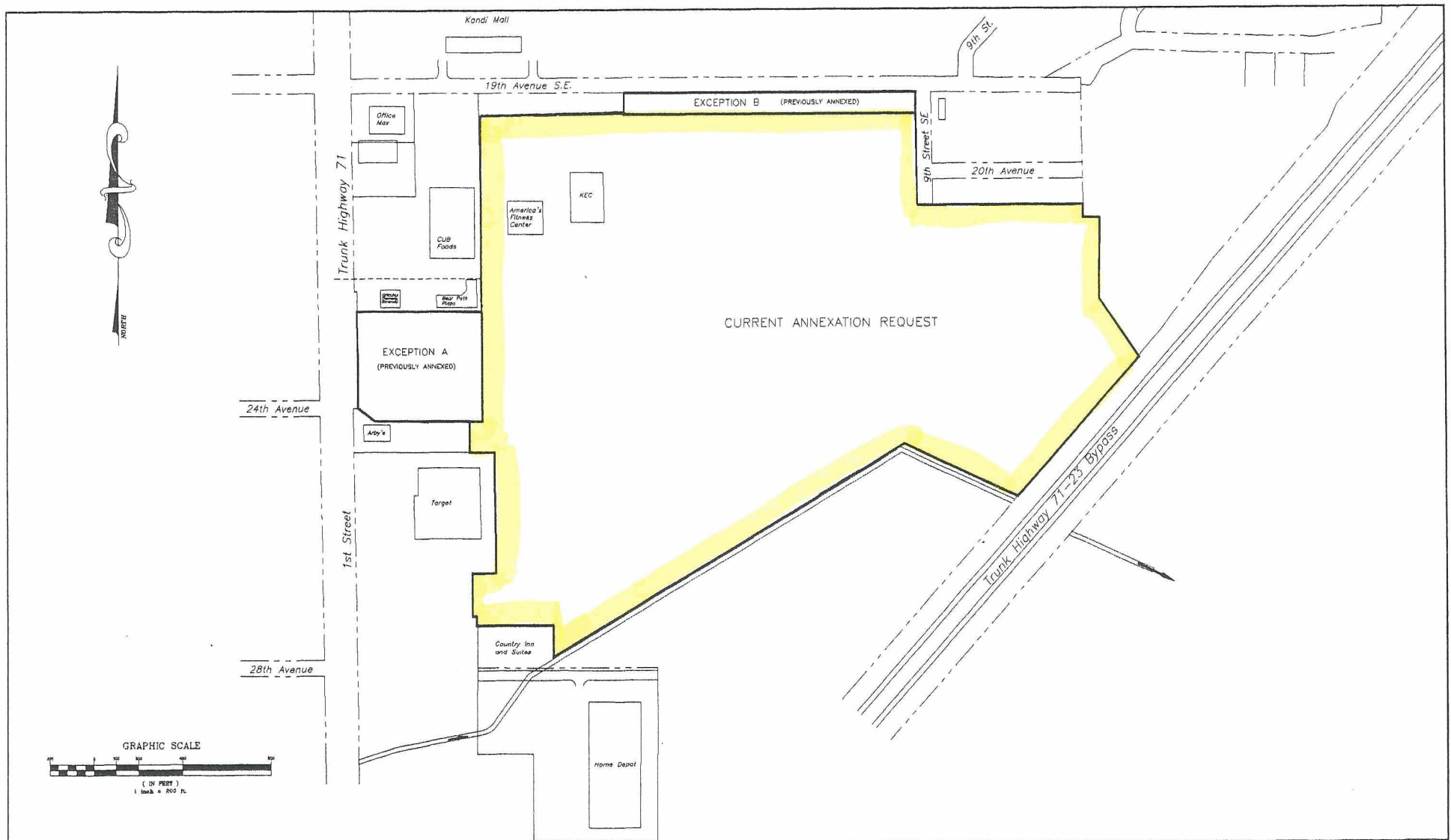

6/20/05	ADDED NOTES	1	JVS	© DUININCK BROS. INC. 2005. ANY USE OR REUSE OF THIS PLAN DRAWING AND THE CORRESPONDING COMPUTER AIDED DESIGN DRAWING FILES WITHOUT THE EXPRESS WRITTEN CONSENT OF DBI IS PROHIBITED. DBI SHALL NOT BE RESPONSIBLE FOR ANY UNAUTHORIZED USE OR REUSE OF THESE MATERIALS, OR DAMAGES RESULTING THEREFROM.	DUININCK BROS. DESIGN GROUP PHONE: (320) 978-8011 FAX: (320) 978-4978 PO BOX 208 NORTH COUNTY ROAD 1 PRINSBURG, MN 56281	I HEREBY CERTIFY THAT THIS PLAN WAS PREPARED BY ME OR UNDER MY DIRECT SUPERVISION AND THAT I AM A DULY LICENSED PROFESSIONAL ENGINEER UNDER THE LAWS OF THE STATE OF MINNESOTA. SIGNATURE: _____ DATE: _____ NAME: JASON VERSTEED LIC. NO. 26505	Orderly Annexation Area Waterview Business Park July 11, 2005
DATE	REVISIONS	NO.	BY			Scale 1" = 200'	

REC'D BY
M.M.B.
AUG 05 2005

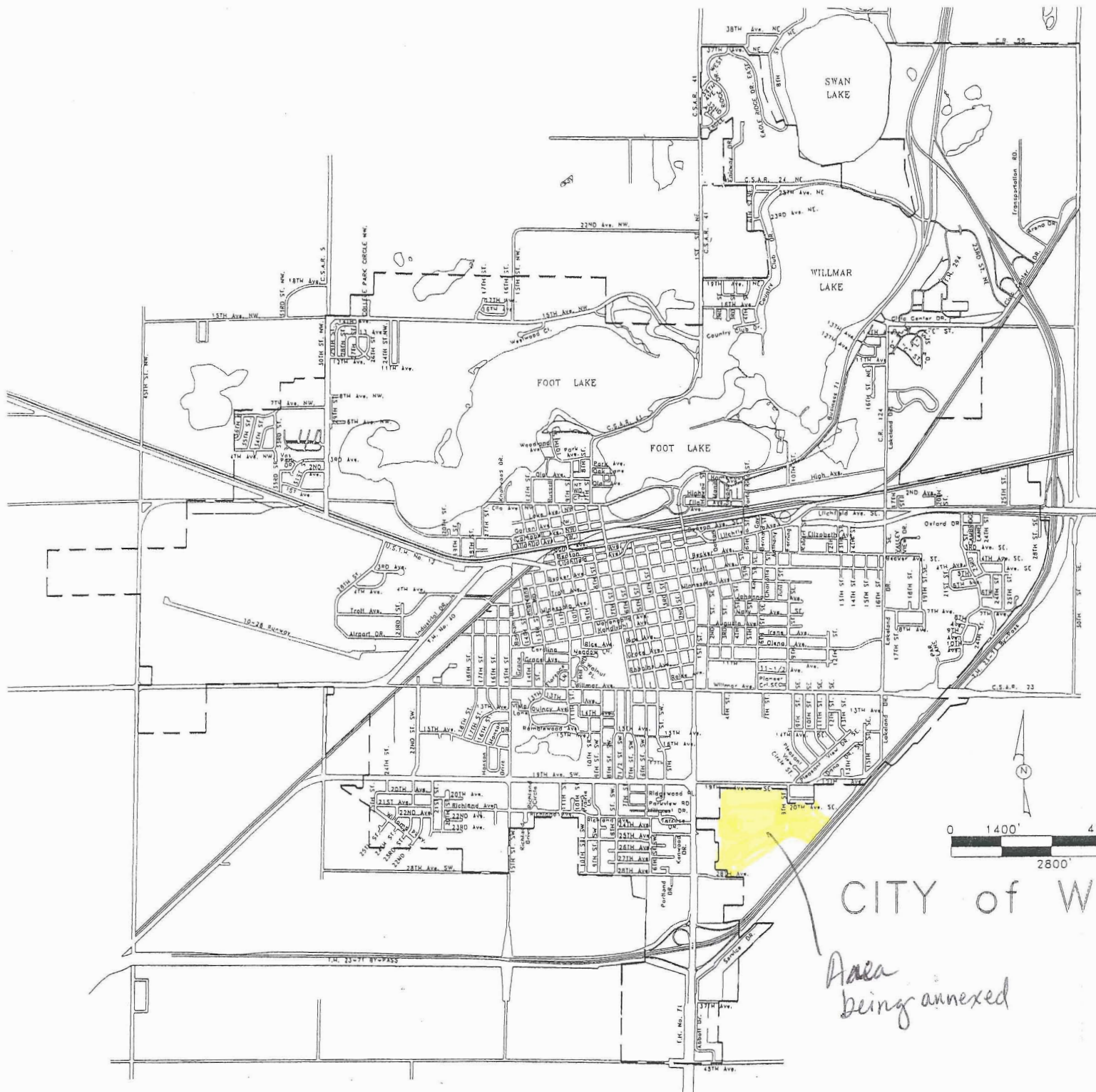

RECD BY
M.M.D. AUG 05 2005

CITY of WILLMAR

Area
being annexed