

REC'D. BY
MMR OCT 16 1995

AMENDMENT TO THE JOINT RESOLUTION
FOR ORDERLY ANNEXATION
BETWEEN THE TOWNSHIP OF ST. JOSEPH, MINNESOTA
AND THE CITY OF ST. JOSEPH, MINNESOTA

The Township of St. Joseph and the City of St. Joseph hereby jointly agree that the area designated for orderly annexation in the Joint Resolution between the Township of St. Joseph and the City of St. Joseph designating an area for orderly annexation dated October 10, 1975 be amended to include the following:

Both the Township and the City agree that no alteration of the stated boundaries of this agreement is appropriate. Furthermore, both parties agree that no consideration by the Board is necessary. Upon receipt of this resolution, the Municipal Board may review and comment, but shall, within 30 days, order the annexation of the following-described property in accordance with the terms of the Joint Resolution.

Whereas, the following described property is currently designated for orderly annexation in zone 2;

The undersigned jointly resolve that the described property is in need of orderly annexation, is urban or suburban in character, abuts the city boundaries on the east and resolve that the property be annexed.

The property is currently bare land, with no population, and in need of municipal water and sewer for construction of an office building.

Zoning classification upon annexation of the parcel is General Business according to Section 52.14, Subdivision 4 b of the St. Joseph Code of Ordinances.

The property is legally described as follows:

All that part of the Southwest Quarter of the Northwest Quarter and the Northwest Quarter of the Southwest Quarter of Section 11, Township 124, Range 29, Stearns County, Minnesota, lying easterly of Mohs Second Addition and southerly of the southerly right-of-way line of County Road #75 (Formerly S.T.H. #52) and northerly of the centerline of County Aid Road #134, subject to the right-of-way of said County Road #134.

Together with the easterly 25.00 feet of Lot 1, Block 1, Mohs Second Addition, according to the recorded plat thereof, Stearns County, Minnesota. Subject to the easements of record. The parcel is .33 acres.

REC'D. BY OCT 16 1995
M M R

Adopted this 5th day of October, 1995 by the City Council for the City of St. Joseph.

(SEAL)

CITY OF ST. JOSEPH

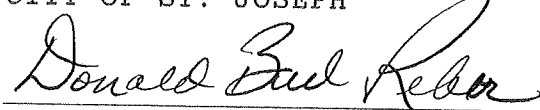

Donald Bud Reber, Mayor



Rachel Stapleton
Clerk/Administrator

Adopted this 10 day of October _____, 1995 by the Town Board for the Town of St. Joseph.

(SEAL)

TOWN OF ST JOSEPH

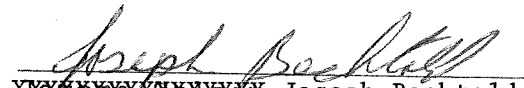

~~Joseph Bechtold~~ Joseph Bechtold
Town Supervisor

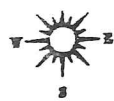

Anna Reischl
Town Clerk

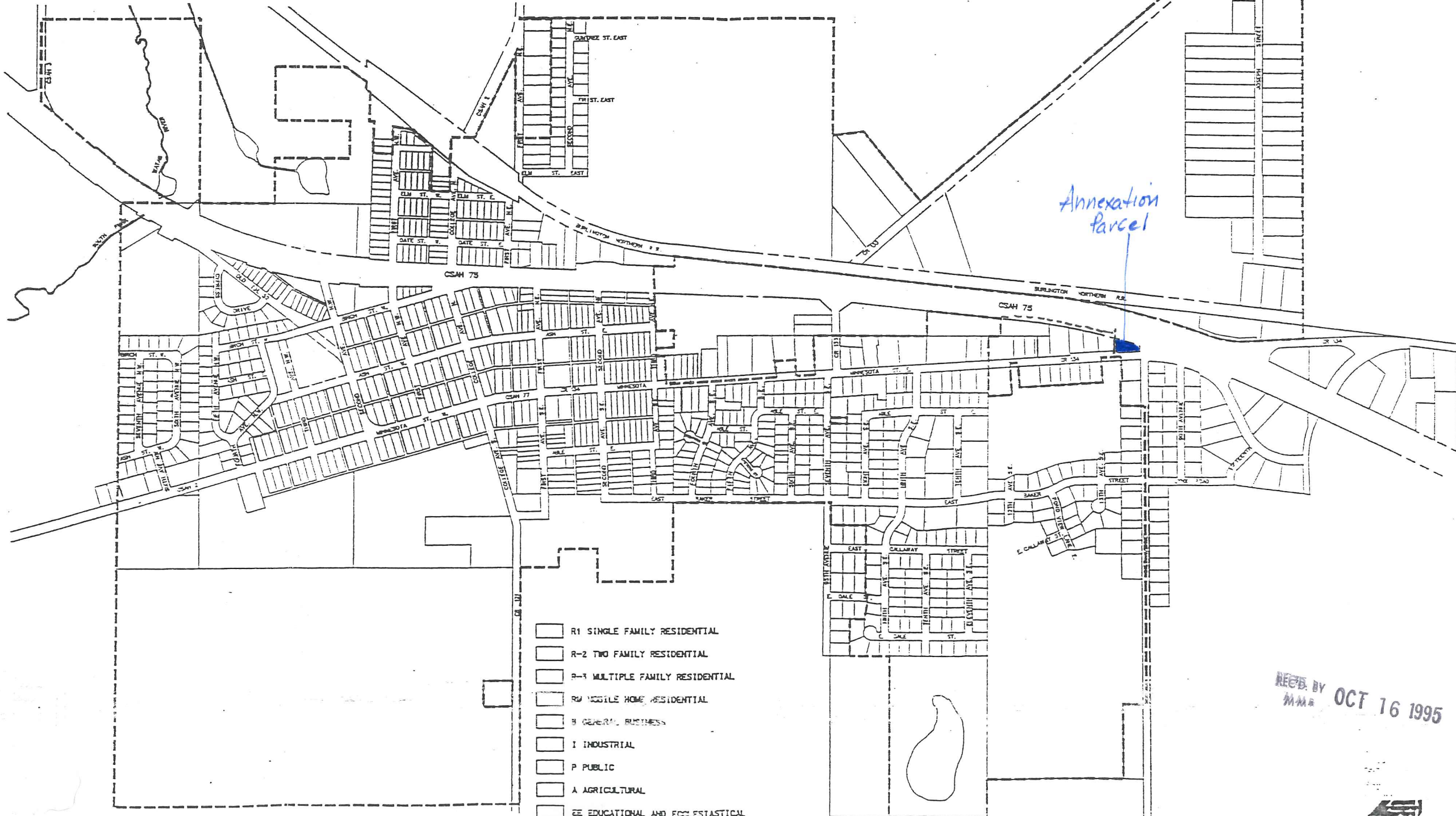

City of St. Joseph



Annexation Parcel

NEED BY
MMA OCT 16 1995

