

TOWN OF MAPLE LAKE RESOLUTION NO. 2004-2CITY OF MAPLE LAKE RESOLUTION
NO. 04 - _____JOINT RESOLUTION AND AGREEMENT FOR
ORDERLY ANNEXATION BETWEEN
TOWNSHIP AND THE CITY OF MAPLE LAKE, MINNESOTA

WHEREAS, the Maple Lake Township Board passed a resolution on 9-21-04, approving the annexation to the City of Maple Lake of certain land owned by the City of Maple Lake and legally described as follows:

See Attached Exhibit A

WHEREAS, the City Council of the City of Maple Lake agreed to the annexation of the above described parcel of land at its Sept, meeting; and

WHEREAS, the Maple Lake Township Board and the City Council for the City of Maple Lake have both determined that the annexation of a portion of the Township with the City is of mutual benefit to both parties and the residents there.

NOW, THEREFORE, BE IT RESOLVED by the Maple Lake Township Board and the City Council of the City of Maple Lake as follows:

1. **Designation of Merger Area.** Maple Lake Township ("Township") and the City of Maple Lake ("City") desire to designate, by joint resolution and agreement, the area encompassing the territory of the Township as described herein ("Annexed Parcel") subject to merger and orderly annexation under and pursuant to Minnesota Statutes Section 414.0325.
2. **Population of Merger Area.**
 - (a) The Township and the City state that the population of the annexed area is approximately 0 persons.
 - (b) The 2000 census results of the population of the City of Maple Lake was 1633 persons. Therefore, following the annexation, the estimated population of the City will increase by 0 persons.

3. **State Agency Jurisdiction.** Upon approval by the respective governing bodies of the Township and the City, this Joint Resolution and Agreement confers jurisdiction upon the office of Minnesota Planning to accomplish the orderly annexation in accordance with the terms of this Joint Resolution and Agreement.
4. **No Alterations of Boundaries.** City and Township mutually state that no alterations of the boundaries of the area designated herein for orderly annexation is appropriate.
5. **Property Taxes.** As the property is owned by the City and is tax exempt, the issue of property tax distribution need not be addressed.
6. **Authorization.** The appropriate officers of the City and the Township are hereby authorized to carry out the terms of this Joint Resolution and Agreement.
7. **Severability and Repealer.** Should any section of this Joint Resolution and Agreement be held by a court of competent jurisdiction to be unconstitutional or void, the remaining provisions will remain in full force and effect.
8. **Effective Date.** This Joint Resolution and Agreement is effective upon its adoption by the respective governing bodies of the Township and the City, as provided by law.
9. **Review and Comment by State Board.** The Township and the City agree that this Joint Resolution and Agreement sets forth all the conditions for the merger of the area designated herein for such merger and orderly annexation, and that no consideration by the office of Minnesota Planning is necessary. The office of Minnesota Planning may review, comment, but must, within 30 days of receipt of this Joint Resolution and Agreement, order merger and orderly annexation in accordance with its terms and conditions.

Adopted by the Maple Lake Township Board this 21 day of Sept, 2004.
2004.

MAPLE LAKE TOWNSHIP

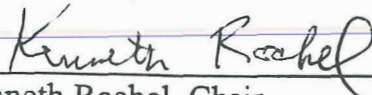
Kenneth Rachel, Chair

REC'D BY
MMB

OCT 18 2004

Attest:



Dick Hogan, Town Clerk

Adopted by the City Council for the City of Maple Lake this 21 day of
SEPTEMBER, 2004.

CITY OF MAPLE LAKE

By 
Michael D. Messina, Mayor

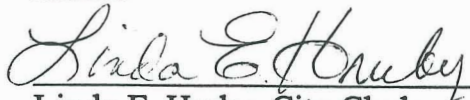
Attest:

Linda E. Hraby, City Clerk

RECD BY
MMB

OCT 18 2004

EXHIBIT A

All that part of the Northeast Quarter of the Northeast Quarter of Section 6, Township 120, Range 26, described as follows: Begin at the point of intersection of the East line of said Section 6, and the centerline of County Road as now traveled distant 25.7 feet South of the Northeast corner of said Section 6, thence S. 2°02' East along said East line of Section 6 distant 439.6 feet to the center of open ditch as now constructed, thence Northwesterly along the center of said ditch on the following described courses: North 84°44' West, 332.75 feet, North 38°51' West, 314.3 feet to the center of said County Road, thence Northeasterly along said center of County Road 539.9 feet more or less to the point of beginning.

REC'D BY
MMB

OCT 18 2004



The City of
Land

FERMAN AVE. N.W.

OF MAPLE LAKE

C.R. 37

AG

AG

I1

MAPLE LAKE
MUNICIPAL AIRPORT

R2

AG

HWY. 55

T-120-121-N MAPLE LAKE DIRECTORY

(Residents - Owners or Renters)

MAPLE LAKE

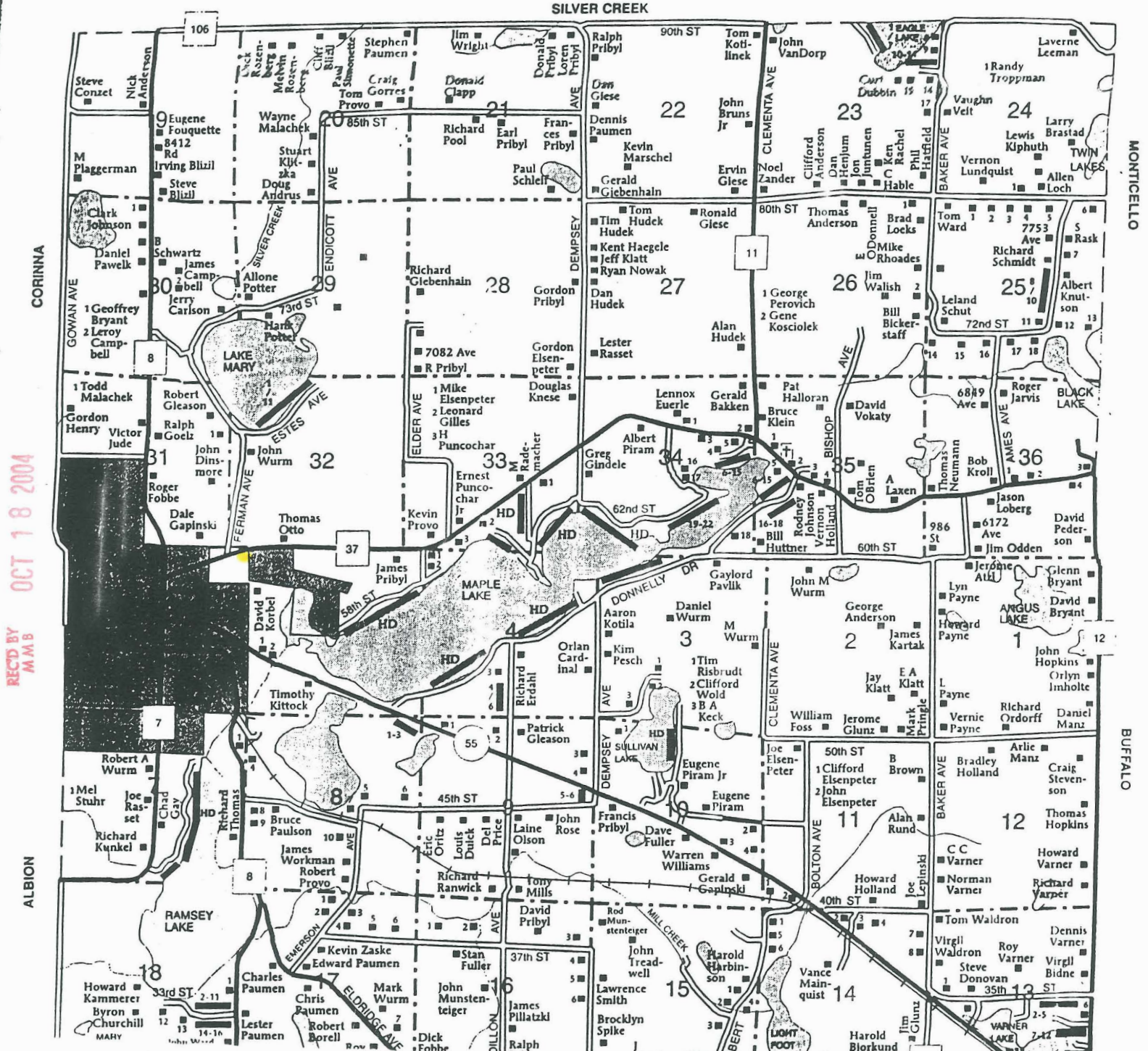

REC'D BY M.A.B. OCT 18 2004

ALBION

MONTICELLO

BUFFALO

CORINNA

ALBION